

30-025-27100

STATE OF NEW MEXICO  
ENERGY AND MINERALS DEPARTMENT

OIL CONSERVATION DIVISION  
P. O. BOX 2088  
SANTA FE, NEW MEXICO 87501

Form C-101  
Revised 10-1-78

NO. OF COPIES RECEIVED	
DISTRIBUTION	
SANTA FE	
FILE	
U.S.G.S.	
LAND OFFICE	
OPERATOR	

5A. Indicate Type of Lease  
STATE  FEE

5. State Oil & Gas Lease No.

APPLICATION FOR PERMIT TO DRILL, DEEPEN, OR PLUG BACK

1. Type of Work  
DRILL  DEEPEN  PLUG BACK

7. Unit Agreement Name

2. Type of Well  
OIL WELL  GAS WELL  OTHER   
SINGLE ZONE  MULTIPLE ZONE

8. Farm or Lease Name  
L. W. White "34"

3. Name of Operator  
Warrior, Inc.

9. Well No.  
2

4. Address of Operator  
P. O. Box 2018, Eunice, New Mexico 88231

10. Field and Pool, or Wildcat  
Eumont Yates-7River

5. Location of Well  
UNIT LETTER J LOCATED 1980 FEET FROM THE South LINE

Queen

1980 FEET FROM THE East LINE OF SEC. 34 TWP. 20S RGE. 36E NMP14

12. County  
Lea



6. Elevations (Show whether DF, RT, etc.)  
3575.4

19. Proposed Depth  
3800'

19A. Formation  
Queen

20. Rotary or C.T.  
Rotary

21A. Kind & Status Plug. Bond  
Blanket

21B. Drilling Contractor  
To be determined

22. Approx. Date Work will start  
December 9, 1980

PROPOSED CASING AND CEMENT PROGRAM

SIZE OF HOLE	SIZE OF CASING	WEIGHT PER FOOT	SETTING DEPTH	SACKS OF CEMENT	EST. TOP
11"	8 5/8"	24	350'	150	Circulate-Surf.
7 7/8"	5 1/2"	15.5	3800	750	Circulate-Surf.

1. A 11" surface hole will be drilled using fresh water mud.
2. A 7 7/8" production hole will be drilled to TD using 10# brine.
3. BOP stack will be set and tested before drilling production hole.

APPROVAL VALID  
FOR 90 DAYS UNLESS  
DRILLING COMMENCED,

EXPIRES 1/20/81

ABOVE SPACE DESCRIBE PROPOSED PROGRAM; IF PROPOSAL IS TO DEEPEN OR PLUG BACK, GIVE DATA ON PRESENT PRODUCTIVE ZONE AND PROPOSED NEW PRODUCTIVE ZONE. GIVE BLOWOUT PREVENTER PROGRAM, IF ANY.

I hereby certify that the information above is true and complete to the best of my knowledge and belief.

Signed [Signature] Title Consulting Engineer Date October 16, 1980

(This space for State Use)

APPROVED BY [Signature] TITLE [Signature] DATE 1980

CONDITIONS OF APPROVAL, IF ANY:

Prior to producing this well, approval must be obtained for the non-standard proration unit.

**NEW MEXICO OIL CONSERVATION COMMISSION  
WELL LOCATION AND ACREAGE DEDICATION PLAT**

Form C-102  
Supersedes C-128  
Effective 1-1-65

All distances must be from the outer boundaries of the Section

Operator <b>Warrior, Inc. <del>United Petro Search, Inc.</del></b>		Lease <b>L.W. White 34</b>		Well No. <b>2</b>
Grid Letter <b>J</b>	Section <b>34</b>	Township <b>20 South</b>	Range <b>36 East</b>	County <b>Lea</b>
Actual Footage Location of Well: <b>1980</b> feet from the <b>South</b> line and <b>1980</b> feet from the <b>East</b> line				
Ground Level Elev. <b>3575.4</b>	Producing Formation <b>Queen</b>	Pool <b>Eumont Yates Seven Rivers</b>	Dedicated Acreage: <b>160</b> Acres	

1. Outline the acreage dedicated to the subject well by colored pencil or hachure marks on the plat below.
2. If more than one lease is dedicated to the well, outline each and identify the ownership thereof (both as to working interest and royalty).
3. If more than one lease of different ownership is dedicated to the well, have the interests of all owners been consolidated by communitization, unitization, force-pooling, etc?

Yes  No If answer is "yes," type of consolidation \_\_\_\_\_

If answer is "no," list the Townships and tract descriptions which have actually been consolidated. (Use reverse side of this form if necessary.) \_\_\_\_\_

No allowable will be assigned to the well until all interests have been consolidated (by communitization, unitization, forced-pooling, or otherwise) or until a non-standard unit, eliminating such interests, has been approved by the Commission.

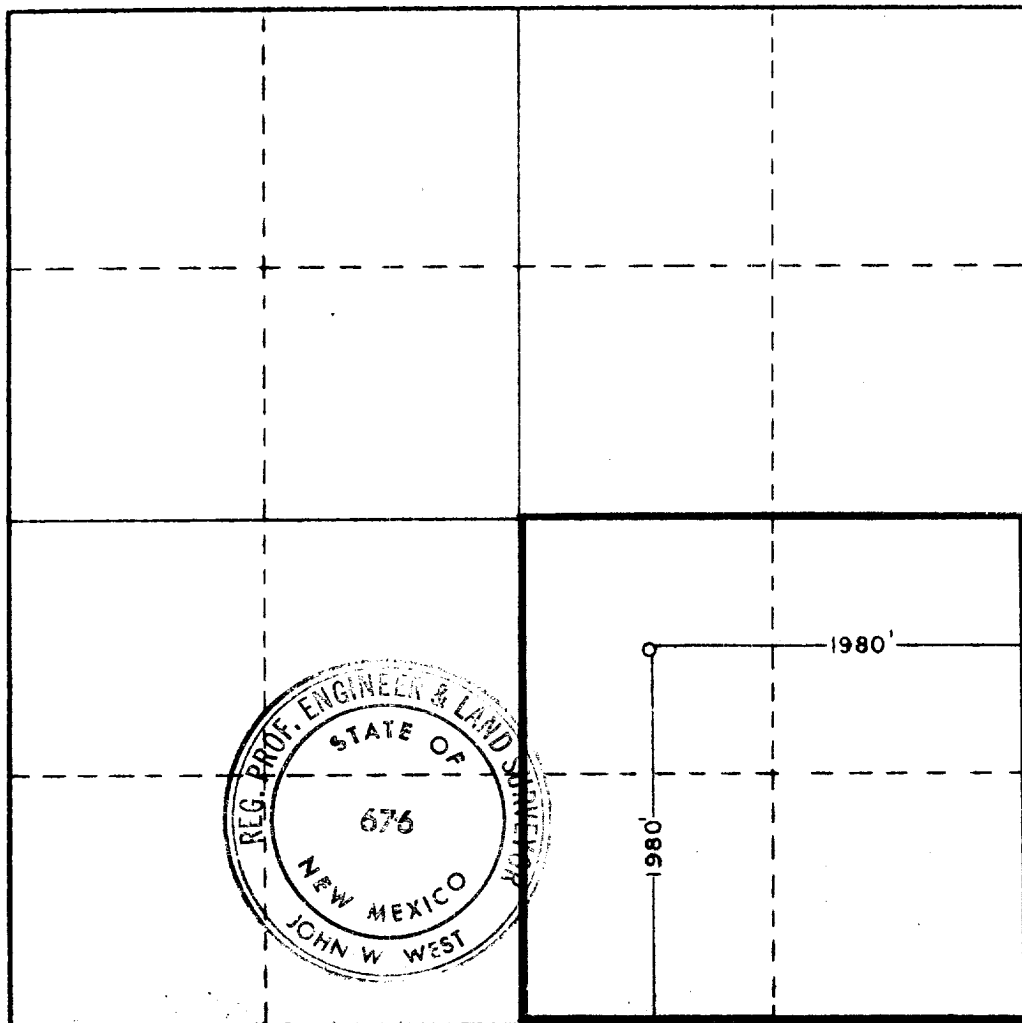

**CERTIFICATION**

I hereby certify that the information contained herein is true and complete to the best of my knowledge and belief.

*Mohammad Y. Merchant*

Name  
**Mohammad Y. Merchant**

Position  
**Consulting Engineer**

Company  
**Warrior, Inc.**

Date  
**October 16, 1980**

I hereby certify that the well location shown on this plat was plotted from field notes of actual surveys made by me or under my supervision, and that the same is true and correct to the best of my knowledge and belief.

Date Surveyed  
**10-11-80**

Registered Professional Engineer  
and/or Land Surveyor

*John W. West*  
Certificate No. **JOHN W. WEST 676**  
**PATRICK A. GONZALEZ 686**  
**RONALD J. EIDSON 5238**

