

N MEXICO OIL CONSERVATION COMMISS
WELL LOCATION AND ACREAGE DEDICATION PLAT

Form C-102
Supersedes C-128
Effective 1-1-65

All distances must be from the outer boundaries of the Section

Lessor Amoco Production Company			Lessee Best Gas Com.		Well No. 2
Tract Letter P	Section 23	Township 20 South	Range 35 East	County Lea County	
Actual Footage Location of Well: <div style="display: flex; justify-content: space-between; align-items: center;"> 840 feet from the South line and 660 feet from the East line </div>					
Ground Level Elev. 3670.9	Producing Formation Bone Springs	Pool Wildcat Bone Springs	Dedicated Acreage: 40 Acres		

1. Outline the acreage dedicated to the subject well by colored pencil or hachure marks on the plat below.
2. If more than one lease is dedicated to the well, outline each and identify the ownership thereof (both as to working interest and royalty).
3. If more than one lease of different ownership is dedicated to the well, have the interests of all owners been consolidated by communitization, unitization, force-pooling, etc?

Yes No If answer is "yes;" type of consolidation Communitization

If answer is "no," list the owners and tract descriptions which have actually been consolidated. (Use reverse side of this form if necessary.) _____

No allowable will be assigned to the well until all interests have been consolidated (by communitization, unitization, forced-pooling, or otherwise) or until a non-standard unit, eliminating such interests, has been approved by the Commission.

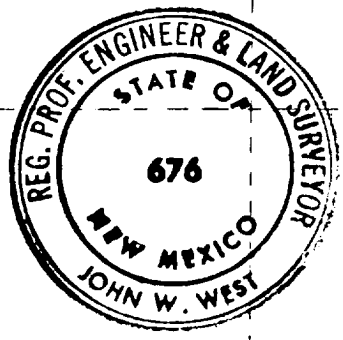
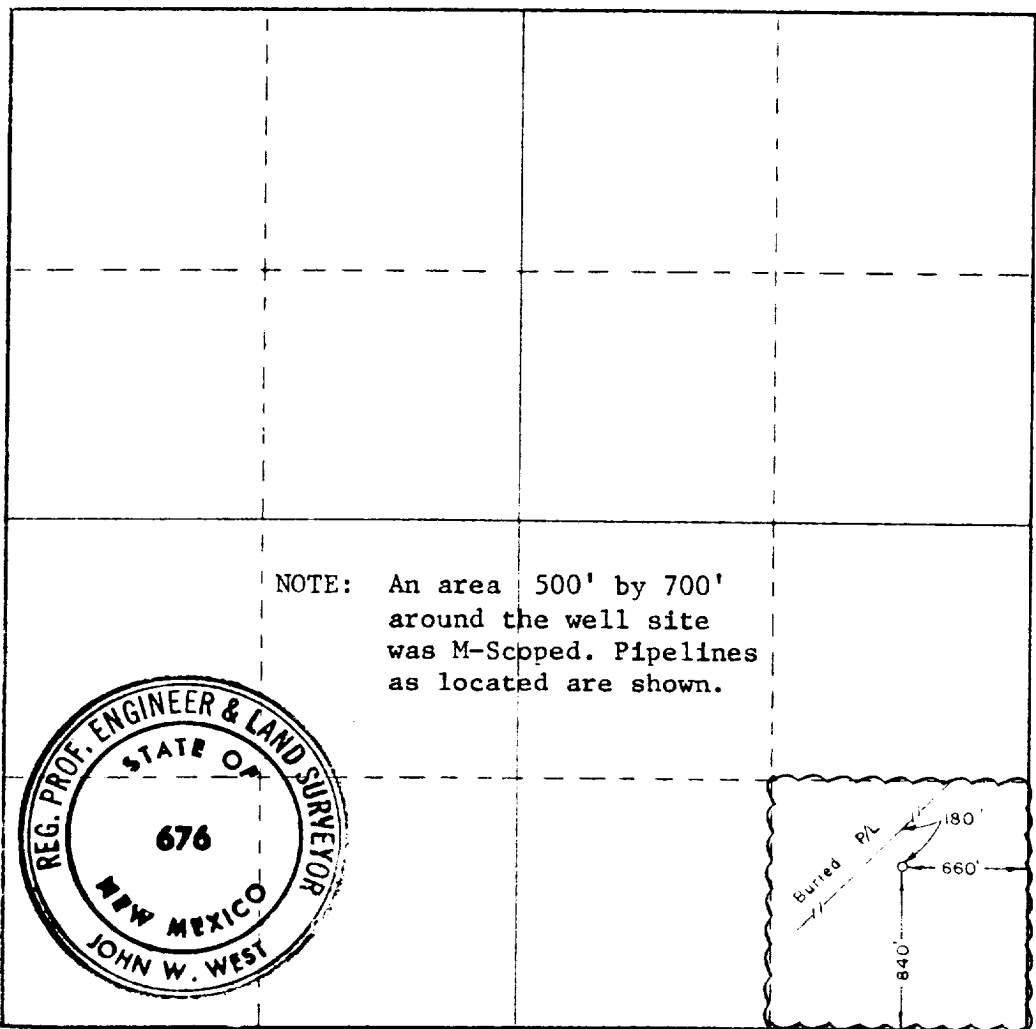

CERTIFICATION
<i>I hereby certify that the information contained herein is true and complete to the best of my knowledge and belief.</i>
Name <i>Cathy L. Jerman</i>
Position Asst. Admin. Analyst
Company Amoco Production Company
Date 12-14-83
<i>I hereby certify that the well location shown on this plat was plotted from field notes of actual surveys made by me or under my supervision, and that the same is true and correct to the best of my knowledge and belief.</i>
Date Surveyed June 18, 1983
Registered Professional Engineer and/or Land Surveyor <i>John W. West</i>
Certificate No. JOHN W. WEST, 676 RONALD J. EIDSON, 3239

