

NO. OF COPIES RECEIVED	
DISTRIBUTION	
SANTA FE	
FILE	
U.S.G.S.	
LAND OFFICE	
OPERATOR	

5A. Indicate Type of Lease

STATE ☒FEE ☐

5. State Oil & Gas Lease No.

A-1212-1

APPLICATION FOR PERMIT TO DRILL, DEEPEN, OR PLUG BACK

1a. Type of Work		7. Unit Agreement Name	
b. Type of Well DRILL <input checked="" type="checkbox"/> DEEPEN <input type="checkbox"/> PLUG BACK <input type="checkbox"/> OIL WELL <input type="checkbox"/> GAS WELL <input type="checkbox"/> OTHER Injection well SINGLE ZONE <input checked="" type="checkbox"/> MULTIPLE ZONE <input type="checkbox"/>		8. Farm or Lease Name South Hobbs (GSA) Unit	
2. Name of Operator AMOCO PRODUCTION COMPANY		9. Well No. 172	
3. Address of Operator P. O. Box 68, Hobbs, NM 88240		10. Field and Pool, or Wildcat Hobbs GSA	
4. Location of Well UNIT LETTER H LOCATED 1980 FEET FROM THE North LINE AND 635 FEET FROM THE East LINE OF SEC. 9 TWP. 19-S RGE 38-E NMPM		12. County Lea	
19. Proposed Depth 4500'		19A. Formation Grayburg San Andres	
20. Rotary or C.T. Rotary		21. Drilling Contractor Cactus Rig No. 54	
22. Approx. Date Work will start As soon as possible			
1. Elevations (Show whether DT, HI, etc.) 3600' GL		21A. Kind & Status Plug. bond Blanket-on-file	

PROPOSED CASING AND CEMENT PROGRAM

SIZE OF HOLE	SIZE OF CASING	WEIGHT PER FOOT	SETTING DEPTH	SACKS OF CEMENT	EST. TOP
12-1/4"	8-5/8"	24#	1600'	Circulate	Surface
7-7/8"	5-1/2"	15.5#	4500'	Circulate	Surface

Propose to drill and equip well in the Grayburg San Andres formation.
After reaching TD, logs will be run and evaluated.

* This is a replacement well for South Hobbs (GSA) Unit No. 75. The well will be left shut-in pending approval of Forms C-108, authorization to injection.

** Amended location due to buried pipeline.

Mud Program: 0 - 1600' Fresh water and native muds.
1600 - 4500' Brine with minimum properties for safe hole conditions.

BOP Diagram attached.

Q-6-NMOCD, H. 1-R. E. Ogden, HOU Rm. 21.150 1-F. J. Nash, HOU Rm. 4.206 1-CMH 1-Texaco 1-Sun
I-Petro Lewis R. Shell
N ABOVE SPACE DESCRIBE PROPOSED PROGRAM; IF PROPOSAL IS TO DEEPEN OR PLUG BACK, GIVE DATA ON PRESENT PRODUCTIVE ZONE AND PROPOSED NEW PRODUCTIVE ZONE. GIVE BLOWOUT PREVENTER PROGRAM, IF ANY.

hereby certify that the information above is true and complete to the best of my knowledge and belief.

Signed Charles M. Loring Title Administrative Analyst Date 2-10-84

(This space for)
Eddie W. Seay
Oil & Gas Inspector

FEB 10 1984

APPROVED BY _____ TITLE _____ DATE _____

CONDITIONS OF APPROVAL, IF ANY:

APPROVAL VALID FOR 180 DAYS
PERMIT EXPIRES 8/10/84
UNLESS DRILLING UNDERWAY

RECEIVED
FEB 10 1984
G.C.D.
HOBBS OFFICE

NEW MEXICO OIL CONSERVATION COMMISSION
WELL LOCATION AND ACREAGE DEDICATION PLAT

Form O-109
Supersedes O-108
Effective 1-1-83

All distances must be from the outer boundaries of the section

Operator AMOCO PRODUCTION CO.		Lease SOUTH HOBBS GRAYBURG SAN ANDRES UNIT		Acres 172
Well Letter H	Section 9	Township 19S	Range 38E	County LEA
Actual True Location of Well:				
1980	feet from the	NORTH	line and	635
feet from the				EAST
Ground Level Elev. 3600.0	Producing Formation Grayburg San Andres		Pool Hobbs GSA	Section 40

1. Outline the acreage dedicated to the subject well by colored pencil or hatchure marks on the plat below.
2. If more than one lease is dedicated to the well, outline each and identify the ownership thereof (both as to working interest and royalty).
3. If more than one lease of different ownership is dedicated to the well, have the interests of all owners been consolidated by communitization, unitization, force-pooling, etc?

☐ Yes ☒ No If answer is "yes," type of consolidation _____

If answer is "no," list the owners and tract descriptions which have actually been consolidated (on reverse side of this form if necessary.) _____

No allowable will be assigned to the well until all interests have been consolidated (by communitization, unitization, forced-pooling, or otherwise) or until a non-standard unit, eliminating such interests, has been approved by the Commission.

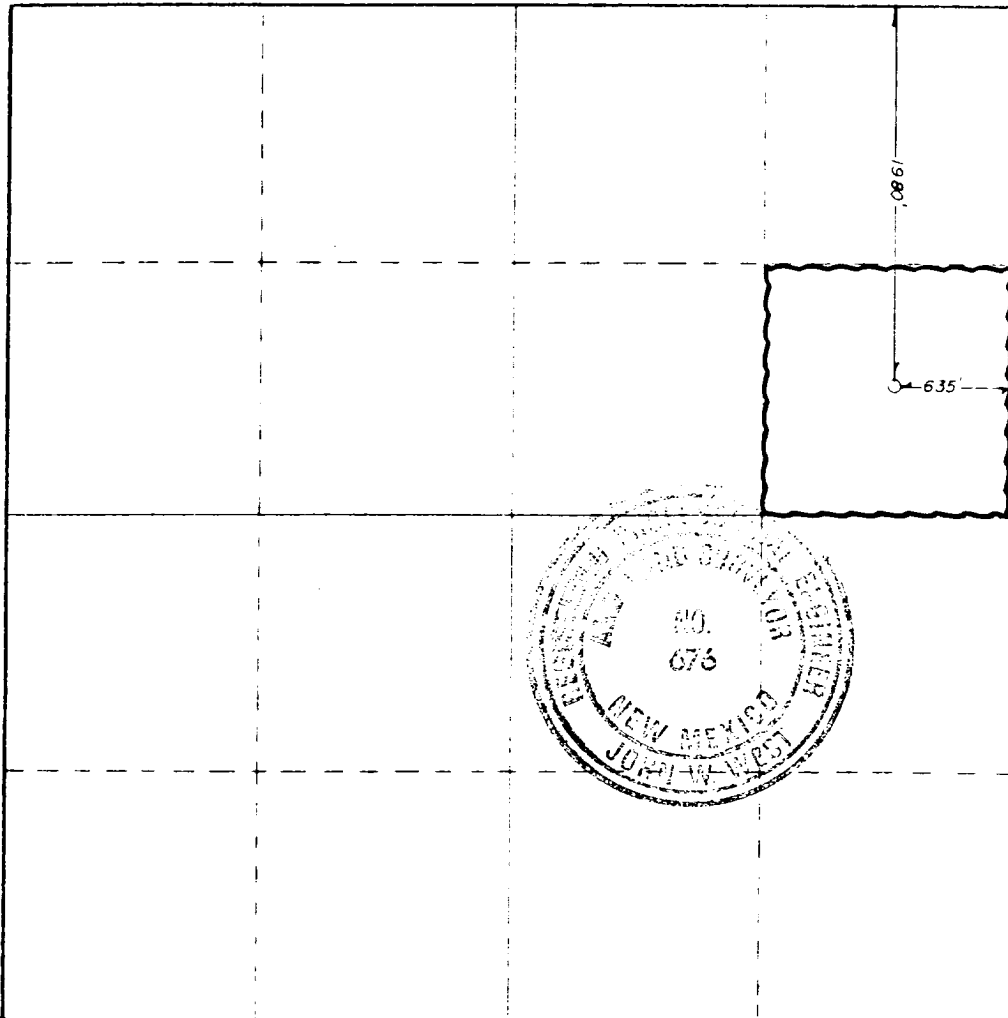

CERTIFICATION

I hereby certify that the information contained hereon is true and complete to the best of my knowledge and belief.

Charles M. Loring
Administrative Analyst

AMOCO PRODUCTION COMPANY

2-10-84

I hereby certify that the well location shown on this plat was plotted from field notes or actual surveys made by me or under my supervision, and that the same is true and correct to the best of my knowledge and belief.

2/9/84

John W. West
Certificate No. JOHN W. WEST, 676

RONALD E. EIDSON, 3239

330 660 990 1320 1650 1980 2310 2640 2970 3300 3630 3960 4290 4620 4950 5280 5610 5940 6270 6600 6930 7260 7590 7920 8250 8580 8910 9240 9570 9900

RECEIVED
FEB 10 1984
O.C.D.
HOBBS OFFICE

STANDARD 2000 PSI W.P. BOP STACK

1. Blow-out preventers may be manually operated.
2. All equipment must be in good condition, 2,000 psi W.P. (4,000 psi test) minimum.
3. Bell nipple above blow-out preventer shall be same size as casing being drilled through.
4. Kelly cock to be installed on kelly.
5. Full opening safety valve 2,000 psi w.p. (4,000 psi test) minimum must be available on rig floor at all times with proper connection or subs to fit any tool joint in string.
6. Spool or cross may be eliminated if connections are available in the lower part of the blow-out preventer body.
7. Double or space saver type preventers may be used in lieu of two single preventers.
8. BOP rams to be installed as follows:
 - Top preventer - Drill pipe or casing rams
 - Bottom preventer - Blind rams

*Amoco District Superintendent may reverse location of rams.
9. Extensions and hand wheels to be installed and braced at all times.
10. Manifold valves may be gate or plug metal to metal seal 2" minimum.

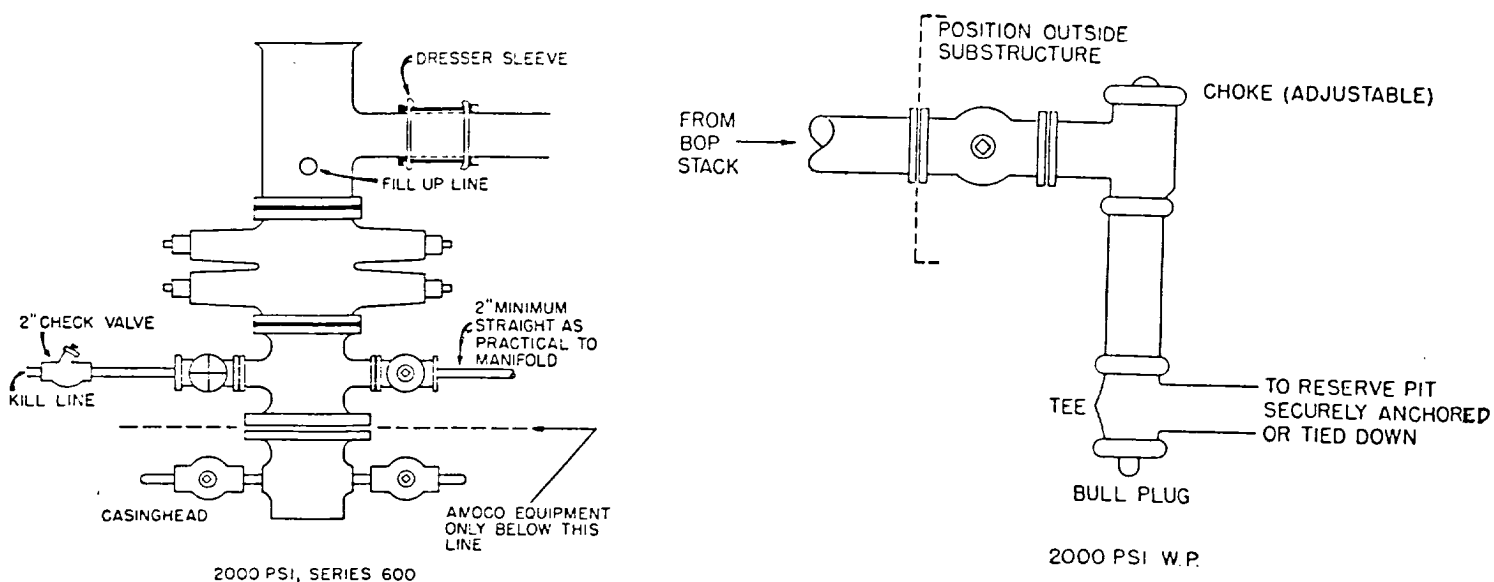

RECEIVED
FEB 10 1984
0-7
HQB-15 OFFICE