

Submit to Appropriate District Office  
State Lease - 4 copies  
Fee Lease - 3 copies

State of New Mexico  
Energy, Minerals and Natural Resources Department

Form C-102  
Revised 1-1-89

OIL CONSERVATION DIVISION

P.O. Box 2088

Santa Fe, New Mexico 87504-2088

RECEIVED

OCT 25 11 29 AM '90

DISTRICT I  
P.O. Box 1960, Hobbs, NM 88240

DISTRICT II  
P.O. Drawer DD, Aztec, NM 88210

DISTRICT III  
1000 Rio Buenos Rd., Aztec, NM 87410

WELL LOCATION AND ACREAGE DEDICATION PLAT

All Distances must be from the outer boundaries of the section

AREA NEAR BY  
RICE  
PERS

Operator <b>GRACE PETROLEUM CORP.</b>		Lease <b>Tonto Federal</b>		Well No. <b>1</b>
Unit Letter <b>H</b>	Section <b>10</b>	Township <b>20 South</b>	Range <b>33 East</b>	County <b>Lea</b>
Actual Footage Location of Well: <b>1903</b> feet from the <b>North</b> line and <b>702</b> feet from the <b>East</b> line				
Ground level Elev. <b>3574.0</b>	Producing Formation	Pool	Dedicated Acreage: <b>Acres</b>	

- Outline the acreage dedicated to the subject well by colored pencil or hatchure marks on the plat below.
- If more than one lease is dedicated to the well, outline each and identify the ownership thereof (both as to working interest and royalty).
- If more than one lease of different ownership is dedicated to the well, have the interest of all owners been consolidated by communitization, unitization, force-pooling, etc.?
  - Yes  No If answer is "yes" type of consolidation \_\_\_\_\_
 If answer is "no" list the owners and tract descriptions which have actually been consolidated. (Use reverse side of this form if necessary.)  
 No allowable will be assigned to the well until all interests have been consolidated (by communitization, unitization, forced-pooling, or otherwise) or until a non-standard unit, eliminating such interest, has been approved by the Division.

**OPERATOR CERTIFICATION**

I hereby certify that the information contained herein is true and complete to the best of my knowledge and belief.

Signature \_\_\_\_\_

Printed Name \_\_\_\_\_

Position \_\_\_\_\_

Company \_\_\_\_\_

Date \_\_\_\_\_

**SURVEYOR CERTIFICATION**

I hereby certify that the well location shown on this plat was plotted from field notes of actual surveys made by me or under my supervision, and that the same is true and correct to the best of my knowledge and belief.

Date Surveyed **October 17, 1990**

Signature & Seal of Professional Surveyor

*[Signature]*

Professional No. **JOHN W. WEST, 676**

**RONALD J. EDSON, 3239**

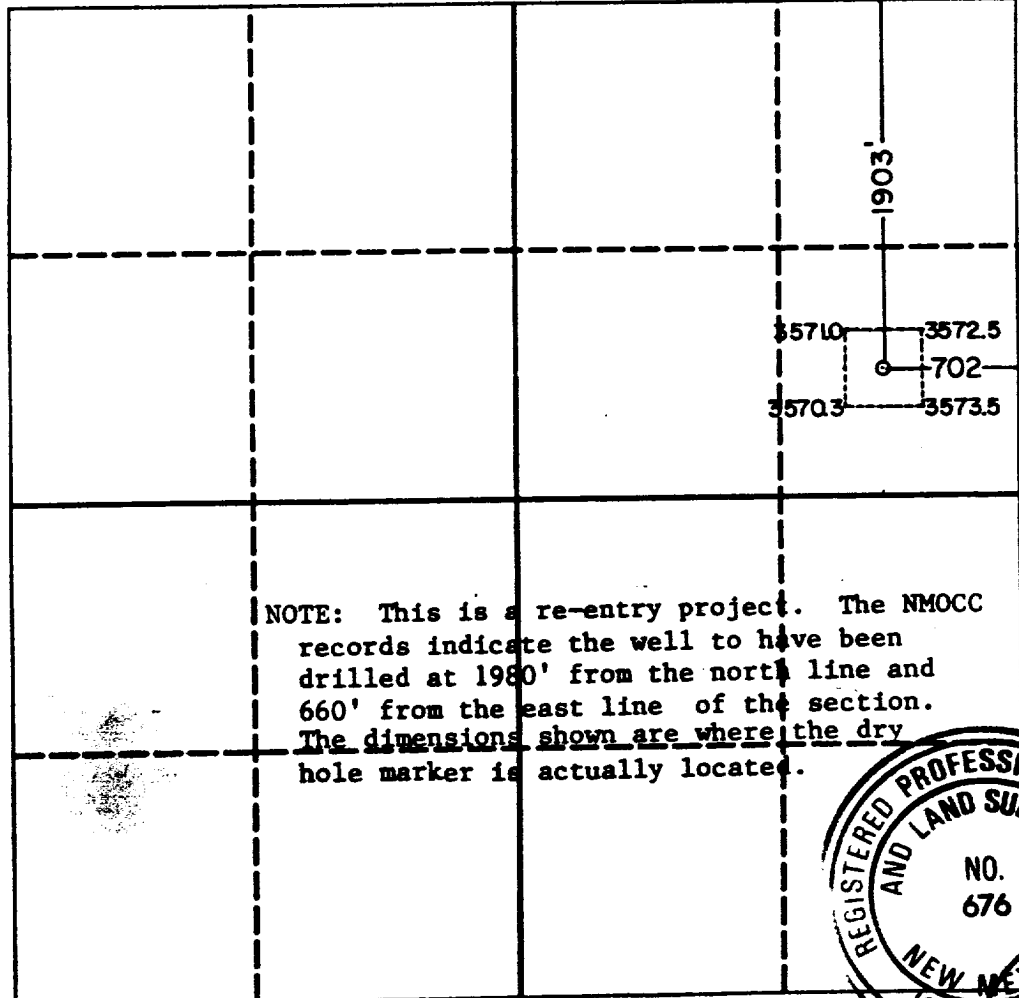

NOTE: This is a re-entry project. The NMOCC records indicate the well to have been drilled at 1980' from the north line and 660' from the east line of the section. The dimensions shown are where the dry hole marker is actually located.

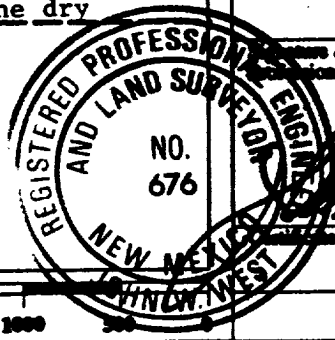

128830

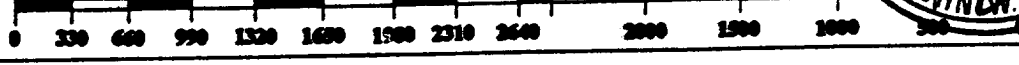

RECEIVED

NOV 02 1990

CCD  
HIGGS OFFICE