

District I  
 PO Box 1980, Hobbs, NM 88241-1980  
 District II  
 811 S. 1st Street, Artesia, NM 88210-2834  
 District III  
 1000 Rio Brazos Rd., Aztec, NM 87410  
 District IV  
 2040 South Pacheco, Santa Fe, NM 87505

State of New Mexico  
 Energy, Minerals & Natural Resources Department

**OIL CONSERVATION DIVISION**  
 2040 South Pacheco  
 Santa Fe, NM 87505

Form C-101  
 Revised October 18, 1994  
 Instructions on back  
 Submit to Appropriate District Office  
 State Lease - 6 Copies  
 Fee Lease - 5 Copies

AMENDED REPORT

**APPLICATION FOR PERMIT TO DRILL, RE-ENTER, DEEPEN, PLUGBACK, OR ADD A ZONE**

<sup>1</sup> Operator name and Address Chevron U.S.A. Inc. P.O. Box 1150 Midland, TX 79702		<sup>2</sup> OGRID Number 4323
<sup>4</sup> Property Code 18665	<sup>5</sup> Property Name MONUMENT 14 STATE	<sup>3</sup> API Number 30-0 30-025-33313
		<sup>6</sup> Well No. 2

<sup>7</sup> Surface Location

UL or lot no.	Section	Township	Range	Lot. Idn	Feet from the	North/South Line	Feet from the	East/West line	County
J	14	19S	36E		2227	SOUTH	2006	EAST	LEA

<sup>8</sup> Proposed Bottom Hole Location If Different From Surface

UL or lot no.	Section	Township	Range	Lot. Idn	Feet from the	North/South Line	Feet from the	East/West line	County
J	14	19S	36E		1897	SOUTH	2256	EAST	LEA

<sup>9</sup> Proposed Pool 1

MONUMENT; ABO, NORTH

<sup>10</sup> Proposed Pool 2

<sup>11</sup> Work Type Code SIDETRACK P	<sup>12</sup> Well Type Code 0	<sup>13</sup> Cable/Rotary	<sup>14</sup> Lease Type Code S	<sup>15</sup> Ground Level Elevation 3739'
<sup>16</sup> Multiple	<sup>17</sup> Proposed Depth 7489'	<sup>18</sup> Formation ABO	<sup>19</sup> Contractor	<sup>20</sup> Spud Date

<sup>21</sup> Proposed Casing and Cement Program

Hole Size	Casing Size	Casing weight/foot	Setting Depth	Sacks of Cement	Estimated TOC
7-7/8"	5-1/2"	15.5	7489'	800	

<sup>22</sup> Describe the proposed program. If this application is to DEEPEN or PLUG BACK give the data on the present productive zone and proposed new productive zone. Describe the blowout prevention program, if any. Use additional sheets if necessary

POH W/PROD EQPT. SET CIBP @ 7100', SPOT 10 SX CMT ON TOP. SPOT 20 SX CMT 6650'-6550'.  
 SPOT 20 SX CMT 5625'-5525'. CUT 5-1/2" CSG @ 4730'. POH W/CSG. SPOT 125 SX CMT @ 4830'.  
 KICK OFF CMT PLUG @ 4565'. DRILL TO 7489'. RETURN WELL TO PRODUCTION IN MONUMENT; ABO, NORTH.

Permit Expires 1 Year From Approval  
 Date Unless Drilling Underway

*Directional*

<sup>23</sup> I hereby certify that the information given above is true and complete to the best of my knowledge and belief. Signature: <i>J. K. Ripley</i>	<b>OIL CONSERVATION DIVISION</b>	
	Approved by: ORIGINAL SIGNED BY GARY WINK FIELD REP. II	Title:
Printed name: J. K. RIPLEY	Approval Date: <b>MAR 19 1999</b>	Expiration Date:
Title: TECHNICAL ASSISTANT		

2/8/99

(915)687-7148

5  
C  
5

DISTRICT I  
P.O. Box 1980, Hobbs, NM 88241-1980

State of New Mexico

Energy, Minerals and Natural Resources Department

Form C-102  
Revised February 10, 1994  
Submit to Appropriate District Office  
State Lease - 4 Copies  
Fee Lease - 3 Copies

DISTRICT II  
P.O. Drawer DD, Artesia, NM 88211-0719

DISTRICT III  
1000 Rio Brazos Rd., Asteo, NM 87410

DISTRICT IV  
P.O. BOX 2088, SANTA FE, N.M. 87504-2088

OIL CONSERVATION DIVISION

P.O. Box 2088  
Santa Fe, New Mexico 87504-2088

AMENDED REPORT

WELL LOCATION AND ACREAGE DEDICATION PLAT

API Number 30-025-33313	Pool Code 46980	Pool Name MONUMENT; ABO, NORTH
Property Code 18665	Property Name MONUMENT 14 STATE	Well Number 2
OGRID No. 4323	Operator Name CHEVRON U.S.A. INC.	Elevation 3739

Surface Location									
UL or lot No.	Section	Township	Range	Lot Idn	Feet from the	North/South line	Feet from the	East/West line	County
J	14	19 S	36 E		2227	SOUTH	2006	EAST	LEA

Bottom Hole Location If Different From Surface									
UL or lot No.	Section	Township	Range	Lot Idn	Feet from the	North/South line	Feet from the	East/West line	County
J	14	19 S	36 E		1897	SOUTH	2256	EAST	LEA

Dedicated Acres 40	Joint or Infill	Consolidation Code	Order No.
-----------------------	-----------------	--------------------	-----------

NO ALLOWABLE WILL BE ASSIGNED TO THIS COMPLETION UNTIL ALL INTERESTS HAVE BEEN CONSOLIDATED OR A NON-STANDARD UNIT HAS BEEN APPROVED BY THE DIVISION

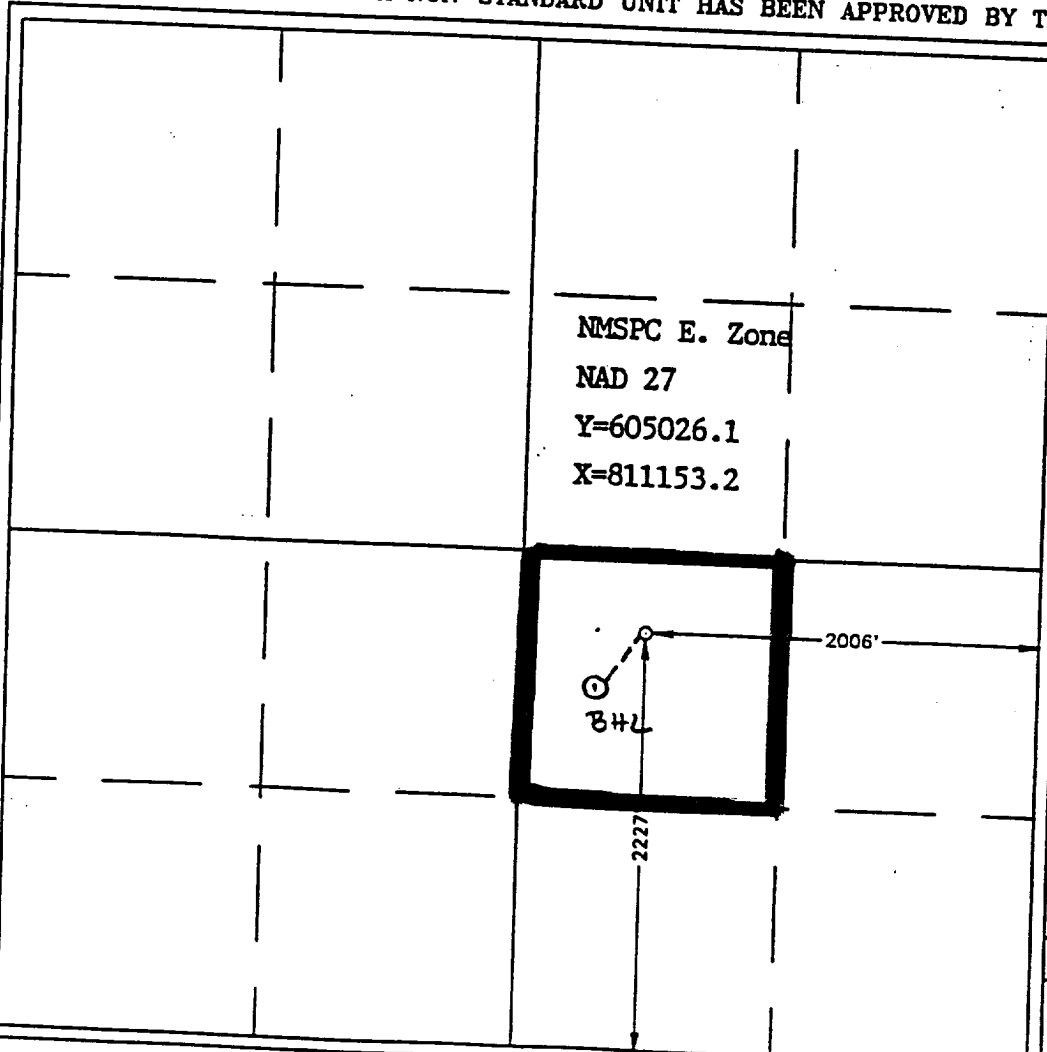

**OPERATOR CERTIFICATION**

I hereby certify that the information contained herein is true and complete to the best of my knowledge and belief.

*J. K. Ripley*  
Signature

J. K. RIPLEY  
Printed Name

T.A.  
Title

2/8/99  
Date

**SURVEYOR CERTIFICATION**

I hereby certify that the well location shown on this plat was plotted from field notes of actual surveys made by me or under my supervision, and that the same is true and correct to the best of my belief.

FEBRUARY 28, 1996

Date Surveyed \_\_\_\_\_ SJA

Signature of \_\_\_\_\_  
Professional Surveyor

*John W. West*  
Professional Surveyor

NEW MEXICO  
Professional Surveyor  
2-27-96

P.O. Num. 96-1130295

Certificate No. JOHN W. WEST 676  
RONALD J. EDSON 3239  
CARL RISSON 12641

DISTRICT I  
P.O. Box 1000, Sandoz, NM 88241-1000

State of New Mexico  
Energy, Minerals and Natural Resources Department

Form C-102  
Revised February 10, 1984  
Submit to Appropriate District Office  
State Lease - 4 Copies  
Fee Lease - 3 Copies

DISTRICT II  
P.O. Drawer 88, Artesia, NM 88211-0719

DISTRICT III  
1000 Rio Brazos Rd., Aztec, NM 87410

**OIL CONSERVATION DIVISION**  
P.O. Box 2088  
Santa Fe, New Mexico 87504-2088

DISTRICT IV  
P.O. Box 2000, SANTA FE, N.M. 87504-2000

AMENDED REPORT

**WELL LOCATION AND ACREAGE DEDICATION PLAT**

API Number	Pool Code	Pool Name
Property Code	Property Name MONUMENT 14 STATE	
OGRID No.	Operator Name CHEVRON U.S.A. INC.	
		Well Number 2
		Elevation 3739

**Surface Location**

UL or lot No.	Section	Township	Range	Lot Idn	Feet from the	North/South line	Feet from the	East/West line	County
J	14	19 S	36 E		2227	SOUTH	2006	EAST	LEA

**Bottom Hole Location If Different From Surface**

UL or lot No.	Section	Township	Range	Lot Idn	Feet from the	North/South line	Feet from the	East/West line	County
J	14	19 S	36 E		1897	SOUTH	2256	EAST	LEA

Dedicated Acres 40	Joint or Infill	Consolidation Code	Order No.
-----------------------	-----------------	--------------------	-----------

**NO ALLOWABLE WILL BE ASSIGNED TO THIS COMPLETION UNTIL ALL INTERESTS HAVE BEEN CONSOLIDATED OR A NON-STANDARD UNIT HAS BEEN APPROVED BY THE DIVISION**

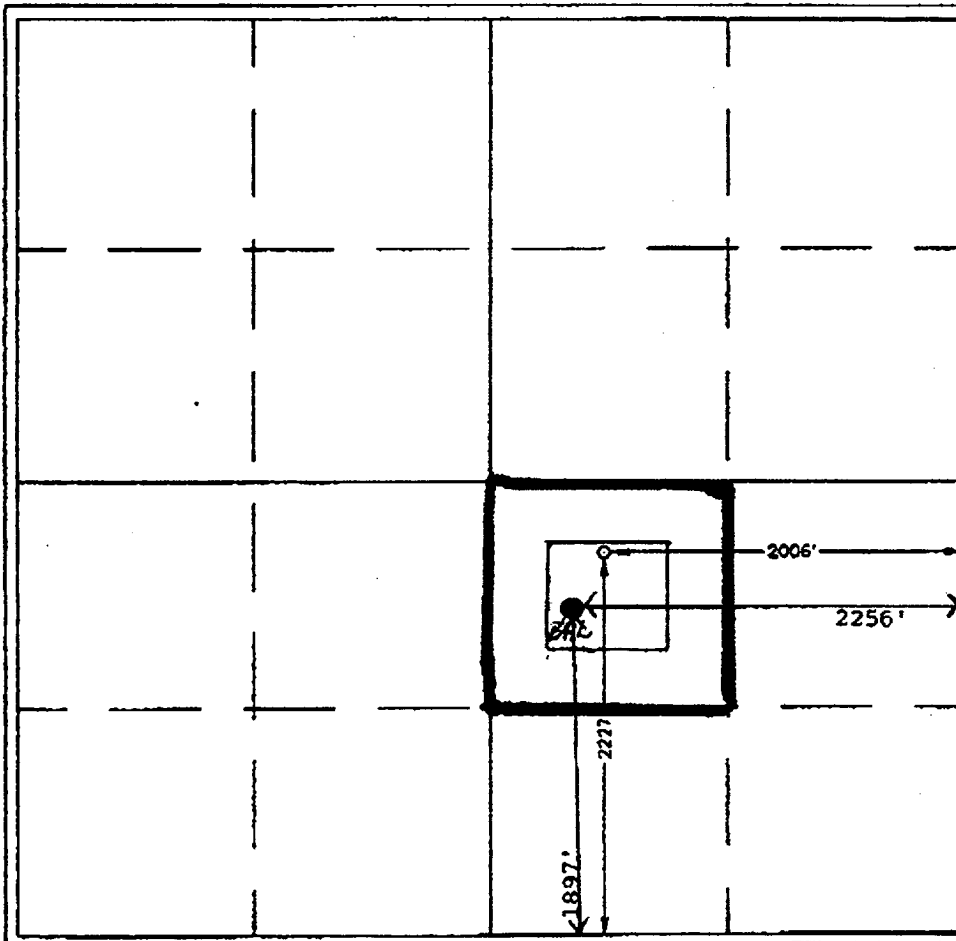

**OPERATOR CERTIFICATION**

I hereby certify that the information contained herein is true and complete to the best of my knowledge and belief.

*J. K. Ripley*  
Signature

J. K. Ripley  
Printed Name

T.A.  
Title

3/16/99  
Date

---

**SURVEYOR CERTIFICATION**

I hereby certify that the well location shown on this plat was plotted from field notes of actual surveys made by me or under my supervision and that the same is true and correct to the best of my belief.

FEBRUARY 28, 1996  
Date Surveyed

*John W. Edson*  
Signature & Seal of Professional Surveyor

NEW MEXICO  
J.W. Edson  
No. 96-15-0295

Certificate No. JOHN W. EDSON 676  
PROFESSIONAL SURVEYOR 3239  
NEW MEXICO 12841