

Instructions on back
Submit to Appropriate District Office
State Lease - 6 Copies
Fee Lease - 5 Copies

District I
PO Box 1980, Hobbs, NM 88241-1980
District II
811 S. 1st Street, Artesia, NM 88210-2834
District III
1000 Rio B. 200 Rd., Aztec, NM 87410
District IV
PO Box 2088, Santa Fe, NM 87504-2088

OIL CONSERVATION DIVISION
P.O. Box 2088
Santa Fe, NM 87504-2088

AMENDED REPORT

APPLICATION FOR PERMIT TO DRILL, RE-ENTER, DEEPEN, PLUGBACK, OR ADD A ZONE

¹ Operator name and Address Chevron U.S.A. Inc. P.O. Box 1150 Midland, TX 79702		² OGRID Number 4323
⁴ Property Code 20069	⁵ Property Name MONUMENT "13" STATE	³ API Number 30-0 25-34222
		⁶ Well Number 18

⁷ Surface Location

UL or lot no.	Section	Township	Range	Lot. Idn	Feet from the	North/South Line	Feet from the	East/West line	County
E	13	19S	36E		1739	NORTH	727	WEST	LEA

⁸ Proposed Bottom Hole Location If Different From Surface

UL or lot no.	Section	Township	Range	Lot. Idn	Feet from the	North/South Line	Feet from the	East/West line	County

⁹ Proposed Pool 1

¹⁰ Proposed Pool 2

MONUMENT; ABO, NORTH	46980	
----------------------	-------	--

¹¹ Work Type Code N	¹² Well Type Code O	¹³ Cable/Rotary ROTARY	¹⁴ Lease Type Code S	¹⁵ Ground Level Elevation 3741'
¹⁶ Multiple NO	¹⁷ Proposed Depth 8000'	¹⁸ Formations ABO	¹⁹ Contractor UNKNOWN	²⁰ Spud Date 1/17/98

²¹ Proposed Casing and Cement Program

Hole Size	Casing Size	Casing weight/foot	Setting Depth	Sacks of Cement	Estimated TOC
14-3/4"	11-3/4"	42	400'	275	SURFACE
11"	8-5/8"	24	2850'	800	SURFACE
7-7/8"	5-1/2"	15.5 & 17	7220'	850	4000'

²² Describe the proposed program. If this application is to DEEPEN or PLUG BACK give the data on the present productive zone and proposed new productive zone. Describe the blowout prevention program, if any. Use additional sheets if necessary

CHEVRON PROPOSES TO:
DRILL WITH BIT TO 400', RUN 11-3/4" CSG. CMT WITH CLASS "C" TO SURFACE. NU DIVERTER.
DRILL WITH BIT TO 2850', RUN 8-5/8" CSG. CMT WITH CLASS "C" TO SURFACE. NU & TEST BOP.
DRILL TO 7220', RUN 5-1/2" CSG. CMT WITH CLASS "C".

MUD PROGRAM: SURFACE HOLE: 0' - 400', FRESH WATER 8.4 PPG. INTERMEDIATE HOLE: 400' - 2850',
BRINE WATER 10.0 PPG. PRODUCTION HOLE: 2850' - TD, CUT BRINE WATER 8.8 PPG.

*****PLEASE EXPEDITE*****

²³ I hereby certify that the information given above is true and complete to the best of my knowledge and belief.

Signature: *J. K. Ripley*

Printed name: J. K. Ripley

Title: T. A.

Date: 12/4/97

Phone: (915) 687-7148

OIL CONSERVATION DIVISION	
Approved by:	ORIGINAL SIGNED BY
Title:	GARY WINK FIELD REP. II
Approval Date:	DEC 09 1997
Expiration Date:	
Conditions of Approval:	
Attached	<input type="checkbox"/>

R

DISTRICT I
P.O. Box 1980, Hobbs, NM 88241-1980

State of New Mexico

Energy, Minerals and Natural Resources Department

Form C-102
Revised February 10, 1994
Submit to Appropriate District Office
State Lease - 4 Copies
Fee Lease - 3 Copies

DISTRICT II
P.O. Drawer DD, Artesia, NM 88211-0719

DISTRICT III
1000 Rio Brazos Rd., Aztec, NM 87410

OIL CONSERVATION DIVISION

P.O. Box 2088

Santa Fe, New Mexico 87504-2088

DISTRICT IV
P.O. BOX 2088, SANTA FE, N.M. 87504-2088

AMENDED REPORT

WELL LOCATION AND ACREAGE DEDICATION PLAT

API Number 30-025-34222		Pool Code 46980	Pool Name MONUMENT; ABO, NORTH
Property Code 20069	Property Name MONUMENT "13" STATE		Well Number 18
OGRID No. 4323	Operator Name CHEVRON U.S.A. PRODUCTION COMPANY		Elevation 3727

Surface Location

UL or lot No.	Section	Township	Range	Lot Idn	Feet from the	North/South line	Feet from the	East/West line	County
E	13	19 S	36 E		1739	NORTH	727	WEST	LEA

Bottom Hole Location If Different From Surface

UL or lot No.	Section	Township	Range	Lot Idn	Feet from the	North/South line	Feet from the	East/West line	County

Dedicated Acres 40	Joint or Infill	Consolidation Code	Order No.
-----------------------	-----------------	--------------------	-----------

NO ALLOWABLE WILL BE ASSIGNED TO THIS COMPLETION UNTIL ALL INTERESTS HAVE BEEN CONSOLIDATED OR A NON-STANDARD UNIT HAS BEEN APPROVED BY THE DIVISION

	<p>OPERATOR CERTIFICATION</p> <p><i>I hereby certify the the information contained herein is true and complete to the best of my knowledge and belief.</i></p> <p><u>J. K. Ripley</u> Signature</p> <p>J. K. Ripley Printed Name</p> <p>T.A. Title</p> <p>12/4/97 Date</p>
	<p>SURVEYOR CERTIFICATION</p> <p><i>I hereby certify that the well location shown on this plat was plotted from field notes of actual surveys made by me or under my supervision, and that the same is true and correct to the best of my belief.</i></p> <p>NOVEMBER 11, 1997 Date Surveyed</p> <p>DMCC</p> <p>Signature & Seal of Professional Surveyor <u>Ronald S. Eidson</u> 11-20-97 97-11-1864</p> <p>Certificate No. JOHN W. WEST 676 RONALD S. EIDSON 3239 CARY EIDSON 12641</p>

VICINITY M P

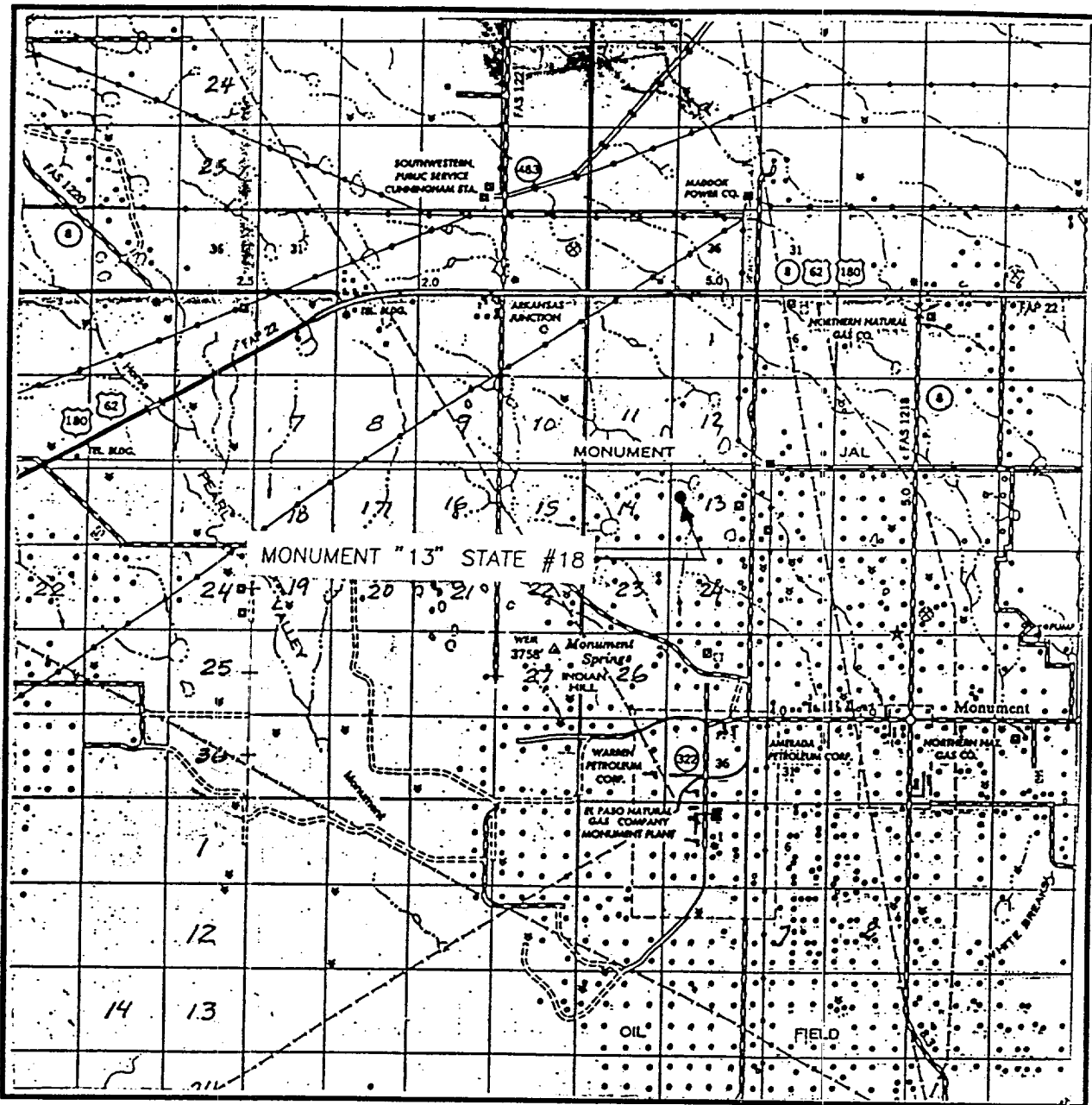

SCALE: 1" = 2 MILES

SEC. 13 TWP. 19-S RGE. 36-E
 SURVEY N.M.P.M.
 COUNTY LEA
 DESCRIPTION 1739' FNL & 727' FWL
 ELEVATION 3727
 OPERATOR CHEVRON U.S.A. PRODUCTION COMPANY
 LEASE MONUMENT "13" STATE

JOHN WEST ENGINEERING
HOBBS, NEW MEXICO
(505) 393-3117

LOCATION VERIFICATION MAP



SCALE: 1" = 2000'

CONTOUR INTERVAL:
MONUMENT NORTH - 10'
WITH 5' SUPPL.

SEC. 13 TWP. 19-S RGE. 36-E

SURVEY N.M.P.M.

COUNTY LEA

DESCRIPTION 1739' FNL & 727' FWL

ELEVATION 3727

OPERATOR CHEVRON U.S.A.
PRODUCTION COMPANY

LEASE MONUMENT "13" STATE

U.S.G.S. TOPOGRAPHIC MAP

MONUMENT NORTH, N.M.

JOHN WEST ENGINEERING
HOBBS, NEW MEXICO

(505) 393-3117

3/18/18