

District I  
PO Box 1930, Hobbs, NM 88241-1980

District II  
811 South First, Artesia, NM 88210

District III  
1000 Rio Brazos Rd., Aztec, NM 87410

District IV  
2040 South Pacheco, Santa Fe, NM 87505

**State of New Mexico**  
Energy, Minerals & Natural Resources Department

Form C-101  
Revised October 18, 1994  
Instructions on back  
Submit to Appropriate District Office  
State Lease - 6 Copies  
Fee Lease - 5 Copies

**OIL CONSERVATION DIVISION**  
2040 South Pacheco  
Santa Fe, NM 87505

AMENDED REPORT

**APPLICATION FOR PERMIT TO DRILL, RE-ENTER, DEEPEN, PLUGBACK, OR ADD A ZONE**

Operator Name and Address BTA OIL PRODUCERS 104 SOUTH PECOS MIDLAND, TX 79701		OGRID Number 003002
		API Number 30 - 025-34841
Property Code 002314	Property Name Gem, 8705 JV-P	Well No. 9

**Surface Location**

UL or lot no.	Section	Township	Range	Lot Idn	Feet from the	North/South line	Feet from the	East/West Line	County
A	2	20S	33E		330	North	990	East	Lea

**Proposed Bottom Hole Location If Different From Surface**

UL or lot no.	Section	Township	Range	Lot Idn	Feet from the	North/South line	Feet from the	East/West Line	County
Proposed Pool 1 Teas, Delaware Pool Code 96797					Proposed Pool 2 Teas, Bone Spring Pool Code # 58960				

Work Type Code N	Well Type Code O	Cable/Rotary R	Lease Type Code S	Ground Level Elevation 3580
Multiple No	Proposed Depth 10350	Formation Bone Spring	Contractor Patterson Drig Co., Rig #49	Spud Date 01-19-00

**Proposed Casing and Cement Program**

Hole Size	Casing Size	Casing weight/foot	Setting Depth	Sacks of Cement	Estimated TOC
17-1/2"	13-3/8"	54.5#	1,387'	1000 sx	Circ. to Surface
12-1/4"	9-5/8"	40#	3,250'	850 sx	Circ. to Surface
8-3/4"	5-1/2"	17#	10,350'	2065 sx	DV tool @ 3,719'

<sup>22</sup> Describe the proposed program. If this application is to DEEPEN or PLUG BACK give the data on the present productive zone and proposed new productive zone. Describe the blowout prevention program, if any. Use additional sheets if necessary.

BOP's on 13-3/8" csg and below: - 3,000 psi WP SRRA

Permit Expires 1 Year From Approval  
Date Unless Drilling Underway

AMENDED FOR POSSIBLE TEAS, BONE SPRING POOL COMPLETION

*Deepen*

<sup>23</sup> I hereby certify that the information given above is true and complete to the best of my knowledge and belief.

Signature: *Dorothy Houghton*

Printed name: DOROTHY HOUGHTON

Title: REGULATORY ADMINISTRATOR

Date: 01-18-00 Phone: 915/682-3753

**OIL CONSERVATION DIVISION**

Approved By: ORIGINAL SIGNED BY CHRIS WILLIAMS  
Title: DISTRICT I SUPERVISOR

Approval Date: *MAR 01 2000* Expiration Date:

Conditions of Approval Attached:

*WCV*

*SP MP*

RECEIVED  
FEB 2000  
MADE  
100

DISTRICT I  
P.O. Box 1060, Hobbs, NM 88241-1060

DISTRICT II  
P.O. Drawer 103, Artesia, NM 88211-0103

DISTRICT III  
1000 Rio Grande Ed., Artesia, NM 87410

DISTRICT IV  
P.O. Box 2088, Santa Fe, N.M. 87504-2088

State of New Mexico  
Energy, Minerals and Natural Resources Department

Form C-102  
Revised February 10, 1994  
Submit to Appropriate District Office  
State Lease - 4 Copies  
Fee Lease - 3 Copies

OIL CONSERVATION DIVISION  
P.O. Box 2088  
Santa Fe, New Mexico 87504-2088

AMENDED REPORT

WELL LOCATION AND ACREAGE DEDICATION PLAT

API Number 30-025-34841	Pool Code 58960	Pool Name Teas, Bone Spring
Property Code 002314	Property Name 8705 JV-P GEM	Well Number 9
OGMD No. 003002	Operator Name BTA OIL PRODUCERS	Elevation 3589

Surface Location

UL or lot No.	Section	Township	Range	Lot Idn	Feet from the	North/South line	Feet from the	East/West line	County
A	2	20 S	33 E		330	NORTH	990	EAST	LEA

Bottom Hole Location If Different From Surface

UL or lot No.	Section	Township	Range	Lot Idn	Feet from the	North/South line	Feet from the	East/West line	County

Dedicated Acres 39.28	Joint or Infill I	Consolidation Code	Order No.
--------------------------	----------------------	--------------------	-----------

NO ALLOWABLE WILL BE ASSIGNED TO THIS COMPLETION UNTIL ALL INTERESTS HAVE BEEN CONSOLIDATED OR A NON-STANDARD UNIT HAS BEEN APPROVED BY THE DIVISION

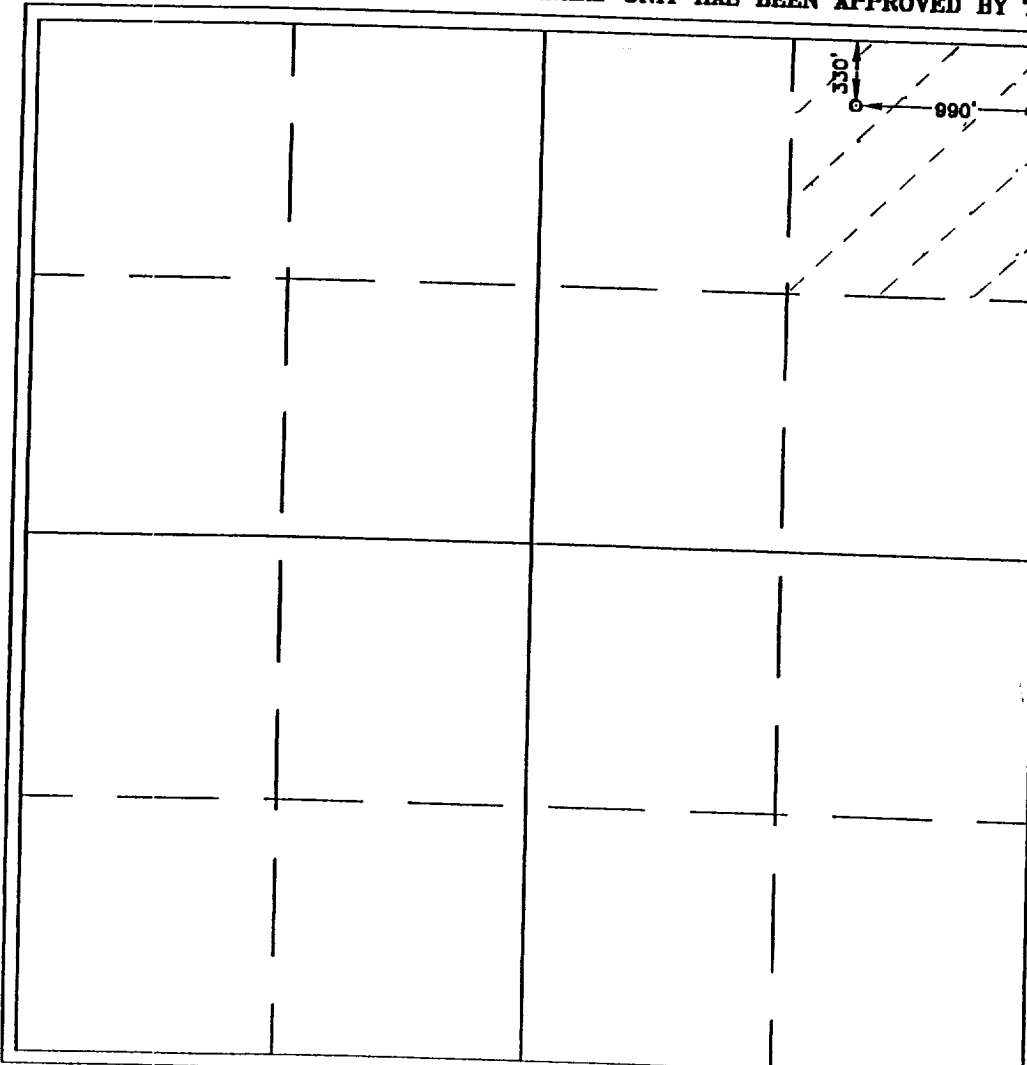

**OPERATOR CERTIFICATION**

I hereby certify that the information contained herein is true and complete to the best of my knowledge and belief.

*Dorothy Houghton*  
Signature

DOROTHY HOUGHTON  
Printed Name

Regulatory Administrator  
Title

12-29-99  
Date

---

**SURVEYOR CERTIFICATION**

I hereby certify that the well location shown on this plat was plotted from field notes of actual surveys made by me or under my supervision, and that the same is true and correct to the best of my belief.

DECEMBER 21, 1999  
Date Surveyed

LMP  
Signature

RONALD G. EDSON  
Professional Surveyor

99-11-1135  
Certificate No.

RONALD G. EDSON 3239  
GARY EDSON 12641  
MAGDON McDONALD 12185