

DISTRICT I  
P. O. Box 1980, Hobbs, NM 88240

DISTRICT II  
P. O. Drawer 00, Artesia, NM 88210

DISTRICT III  
1000 Rio Brazos Rd., Aztec, NM 87410

DISTRICT IV  
P. O. Box 2088, Santa Fe, NM 87504-2088

State of New Mexico  
Energy, Minerals and Natural Resources Department

Form C-102  
Revised February 10, 1994

OIL CONSERVATION DIVISION  
PO Box 2088  
Santa Fe, NM 87504-2088

Instructions on back

Submit to Appropriate District Office

State Lease-4 copies  
Fee Lease-3 copies

WELL LOCATION AND ACREAGE DEDICATION PLAT

AMENDED REPORT

1 API Number <b>30-025-35119</b>		2 Pool Code <b>1152</b>		3 Pool Name <b>Monument, Abo</b>	
Property Code <b>11059</b>		4 Property Name <b>J. R. Phillips</b>		5 Well Number <b>15</b>	
6 GRID No. <b>22351</b>		7 Operator Name <b>TEXACO EXPLORATION &amp; PRODUCTION, INC.</b>		8 Elevation <b>3565'</b>	
9 Surface Location					
10 UL or lot no. <b>C</b>	11 Section <b>6</b>	12 Township <b>20-S</b>	13 Range <b>37-E</b>	14 Lat Idn	15 Feet from the North/South line <b>660'</b> / <b>North</b>
				16 Feet from the East/West line <b>1865'</b>	17 County <b>Lea</b>
18 Bottom Hole Location If Different From Surface					
19 UL or lot no.	20 Section	21 Township	22 Range	23 Lat Idn	24 Feet from the North/South line
					25 Feet from the East/West line
26 Dedicated Acres <b>40.16</b>		27 Joint or Infill		28 Consolidation Code	
				29 Order No.	

NO ALLOWABLE WILL BE ASSIGNED TO THIS COMPLETION UNTIL ALL INTERESTS HAVE BEEN CONSOLIDATED OR A NON-STANDARD UNIT HAS BEEN APPROVED BY THE DIVISION.

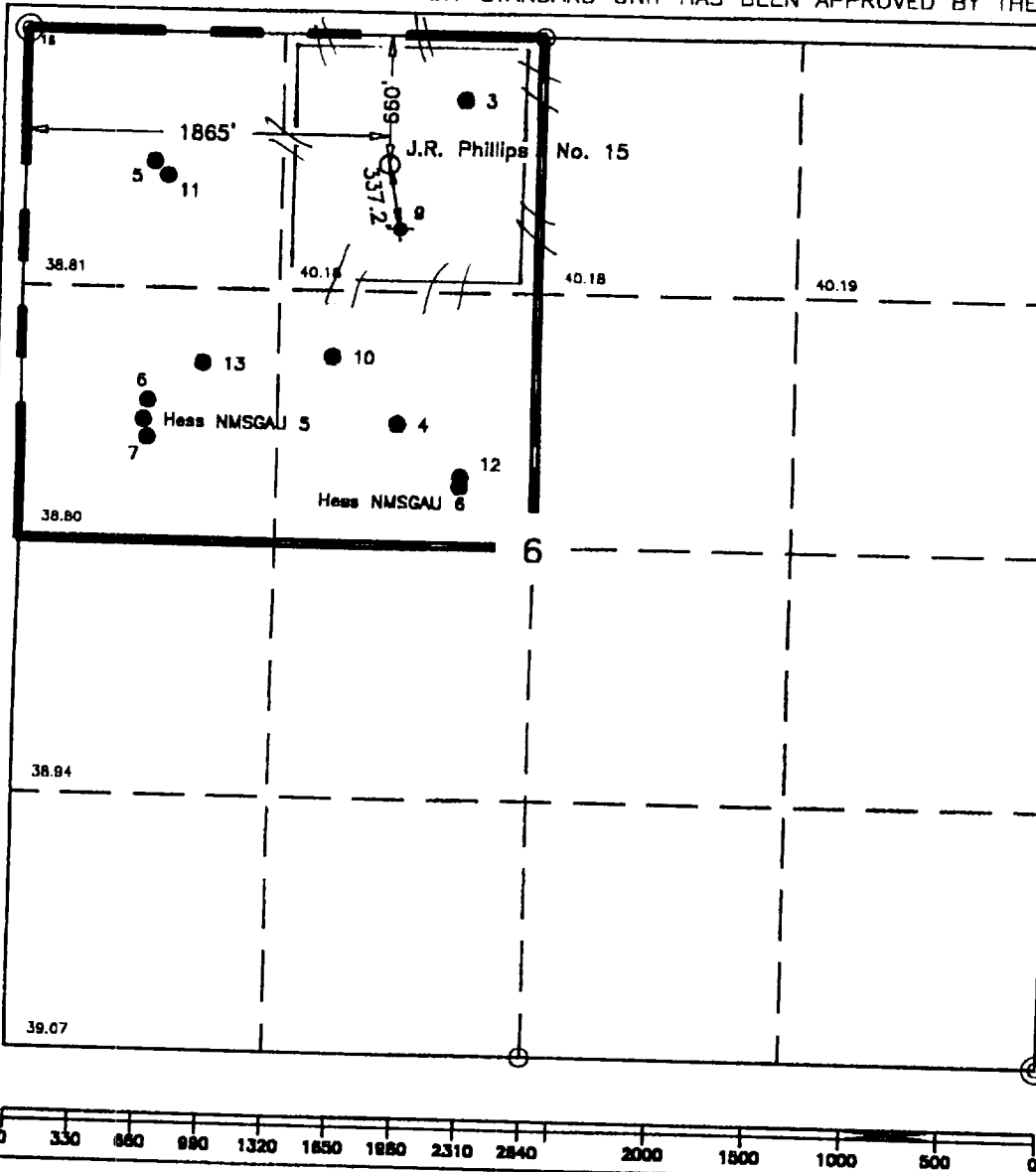

10 OPERATOR CERTIFICATION

I hereby certify that the information contained herein is true and complete to the best of my knowledge and belief.

Signature: *A. Phil Ryan*

Printed Name: **A. Phil Ryan**

Position: **Commissioner Coordinator**

Company: **Texaco Expl. & Prod. Inc.**

Date: **August 4, 2000**

11 SURVEYOR CERTIFICATION

I hereby certify that the well location shown on this plat was plotted from field notes of actual surveys made by me or under my supervision, and that the same is true and correct to the best of my knowledge and belief.

Date Surveyed: **August 2, 2000**

Signature & Seal of Professional Surveyor: *John S. Piper*

Certificate No.: **7254 John S. Piper**

Sheet

○ = Staked Location ● = Producing Well = Injection Well ◊ = Water Supply Well ⊕ = Plugged & Abandon Well  
 ⊕ = Found Section Corner, 2 or 3" Iron Pipe & GLO B.C. ○ = Found /4 Section Corner, 1" Iron Pipe & GLO B.C.

ADDITIONAL INFORMATION ON THE LOCATION

State Plane Coordinates			
Northing <b>586408.64 (1927=586346.55)</b>		Easting <b>861654.15 (1927=820472.060)</b>	
Latitude <b>32°36'28.013" (1927=32°36'27.573")</b>		Longitude <b>103°17'35.224" (1927=103°17'33.493")</b>	
Zone <b>North American Datum</b>		Combined Grid Factor <b>0.9998457</b>	Coordinate File <b>Monumt83.cr5</b>
East <b>1983</b>		Field Book	
Drawing File <b>Phil_15.dwg</b>		Lea County 20, Page 5	