

District I  
1625 N. French Dr., Hobbs, NM 88240  
District II  
811 South First, Artesia, NM 88210  
District III  
1000 Rio Brazos Road, Aztec, NM 87410  
District IV  
2040 South Pacheco, Santa Fe, NM 87505

State of New Mexico  
Energy Minerals and Natural Resources

Oil Conservation Division  
2040 South Pacheco  
Santa Fe, NM 87505

Form C-101  
Revised March 17, 1999

Submit to appropriate District Office  
State Lease - 6 Copies  
Fee Lease - 5 Copies

AMENDED REPORT

**APPLICATION FOR PERMIT TO DRILL, RE-ENTER, DEEPEN, PLUGBACK, OR ADD A ZONE**

<sup>1</sup> Operator Name and Address Matador Operating Company 8340 Meadow Road #150 Dallas, Texas 75231		<sup>2</sup> OGRID Number 014245
		<sup>3</sup> API Number 30-025-35548
<sup>3</sup> Property Code 27971	<sup>5</sup> Property Name Shelley State 35	<sup>6</sup> Well No. 2

<sup>7</sup> Surface Location

UL or lot no.	Section	Township	Range	Lot Idn	Feet from the	North/South line	Feet from the	East/West line	County
DF	35	19S	37E		2130	North	1980	West	Lea

<sup>8</sup> Proposed Bottom Hole Location If Different From Surface

UL or lot no.	Section	Township	Range	Lot Idn	Feet from the	North/South line	Feet from the	East/West line	County
<sup>9</sup> Proposed Pool 1 Monument (Tubb)					<sup>10</sup> Proposed Pool 2				

<sup>11</sup> Work Type Code N	<sup>12</sup> Well Type Code O	<sup>13</sup> Cable/Rotary R	<sup>14</sup> Lease Type Code S	<sup>15</sup> Ground Level Elevation 3593'
<sup>16</sup> Multiple N	<sup>17</sup> Proposed Depth 6900'	<sup>18</sup> Formation Drinkard	<sup>19</sup> Contractor Patterson Drlg.	<sup>20</sup> Spud Date 7/01/01

<sup>21</sup> Proposed Casing and Cement Program

Hole Size	Casing Size	Casing weight/foot	Setting Depth	Sacks of Cement	Estimated TOC
12-1/4"	8-5/8"	24#	1350'	450 sx	Circ. to surface
7-7/8"	4-1/2"	11.6#	6900'	600 sx	3000'

<sup>22</sup> Describe the proposed program. If this application is to DEEPEN or PLUG BACK, give the data on the present productive zone and proposed new productive zone. Describe the blowout prevention program, if any. Use additional sheets if necessary.

Drill 12-1/4" hole to top of Anhydrite @ ± 1350'. Run and cement 8-5/8" casing. Nipple up 11" 3M BOP assembly and test to 3000 psi. Drill 7-7/8" hole to 6900'. Evaluate to run 4-1/2" production casing.

Permit Expires 1 Year From Approval  
Date Unless Drilling Underway

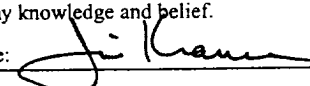
<sup>23</sup> I hereby certify that the information given above is true and complete to the best of my knowledge and belief.		<b>OIL CONSERVATION DIVISION</b>	
Signature: 		Approved by: ORIGINAL SIGNED BY CHRIS WILLIAMS	
Printed name: Jim Kramer		Title: DISTRICT I SUPERVISOR	
Title: Sr. Drilling Engineer		Approval Date:	Expiration Date:
Date: 05/08/01	Phone: 214 987-7128	Conditions of Approval: Attached <input type="checkbox"/>	



**DISTRICT I**  
P. O. Box 1980  
Hobbs, NM 88241-1980

State of New Mexico  
**Energy, Minerals, and Natural Resources Department**

Form C-102  
Revised 02-10-94

Instructions on back

**DISTRICT II**  
P. O. Drawer DD  
Artesia, NM 88211-0719

**OIL CONSERVATION DIVISION**  
P. O. Box 2088  
Santa Fe, New Mexico 87504-2088

Submit to the Appropriate  
District Office  
State Lease - 4 copies  
Fee Lease - 3 copies

**DISTRICT III**  
1000 Rio Brazos Rd.  
Aztec, NM 87410

AMENDED REPORT

**DISTRICT IV**  
P. O. Box 2088  
Santa Fe, NM 87507-2088

**WELL LOCATION AND ACREAGE DEDICATION PLAT**

1 API Number 30-025-35548		2 Pool Code 47090		3 Pool Name Monument (Tubb)	
4 Property Code 27971		5 Property Name SHELLEY STATE 35			6 Well Number 2
7 OGRID No. 014245		8 Operator Name MATADOR OPERATING COMPANY			9 Elevation 3593'

**\* SURFACE LOCATION**

UL or lot no.	Section	Township	Range	Lot Ida	Feet from the	North/South line	Feet from the	East/West line	County
F	35	19 SOUTH	37 EAST, N.M.P.M.		2130'	NORTH	1980'	WEST	LEA

**" BOTTOM HOLE LOCATION IF DIFFERENT FROM SURFACE**

UL or lot no.	Section	Township	Range	Lot Ida	Feet from the	North/South line	Feet from the	East/West line	County

12 Dedicated Acres 80	13 Joint or Infill	14 Consolidation Code	15 Order No.
--------------------------	--------------------	-----------------------	--------------

**NO ALLOWABLE WELL BE ASSIGNED TO THIS COMPLETION UNTIL ALL INTERESTS HAVE BEEN CONSOLIDATED OR A NON-STANDARD UNIT HAS BEEN APPROVED BY THE DIVISION**

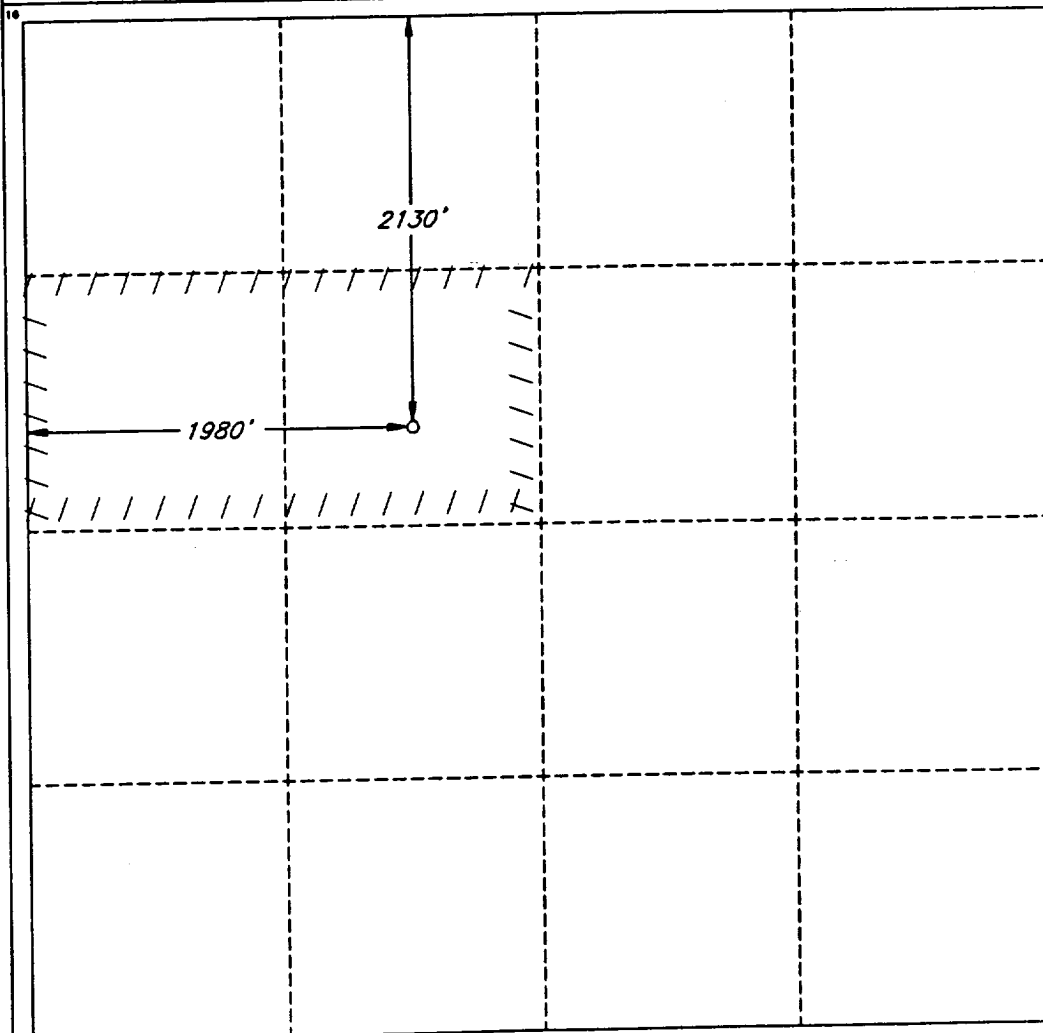

**OPERATOR CERTIFICATION**

*I hereby certify that the information contained herein is true and complete to the best of my knowledge and belief.*

Signature <i>Jim Kramer</i>
Printed Name Jim Kramer
Title Sr. Drilling Engineer
Date 5/2/01

**SURVEYOR CERTIFICATION**

*I hereby certify that the well location shown on this plat was plotted from field notes of actual surveys made by me or under my supervision, and that the same is true and correct to the best of my belief.*

Date of Survey MAY 2, 2001
Signature and Seal of Professional Surveyor <i>V. L. Bezner</i>
Certificate No. 5-4-01 V. L. BEZNER R.P.S. #7920
JOB #76219-170 SW / J.C.P.

New Mexico Oil Conservation Division  
C-102 Instructions

IF THIS IS AN AMENDED REPORT, CHECK THE BOX LABELED  
"AMENDED REPORT" AT THE TOP OF THIS DOCUMENT.

Surveyors shall use the latest United States government survey or dependent resurvey. Well locations will be in reference to the New Mexico Principal Meridian. If the land is not surveyed contact the appropriate OCD district office. Independent subdivision surveys will not be acceptable.

1. The OCD assigned API number for this well
2. The pool code for this (proposed) completion
3. The pool name for this (proposed) completion
4. The property code for this (proposed) completion
5. The property name (well name) for this (proposed) completion
6. The well number for this (proposed) completion
7. Operator's OGRID number
8. The operator's name
9. The ground level elevation of this well
10. The surveyed surface location of this well measured from the section lines NOTE: If the United States government survey designates a Lot Number for this location use that number in the "UL or lot no." box. Otherwise use the OCD unit letter.
11. Proposed bottom hole location. If this is a horizontal hole indicate the location of the end of the hole.
12. The calculated acreage dedicated to this completion to nearest hundredth of an acre
13. Put a Y if more than one completion will be sharing this same acreage or N if this is the only completion on this acreage
14. If more than one lease of different ownership has been dedicated to the well show the consolidation code from the following table:  
C Communitization  
U Unitization  
F Forced pooling  
O Other  
P Consolidation pending

NO ALLOWABLE WILL BE ASSIGNED TO THIS COMPLETION UNTIL ALL INTERESTS HAVE BEEN CONSOLIDATED OR A NON-STANDARD UNIT HAS BEEN APPROVED BY THE DMSION!

16. This grid represents a standard section. You may superimpose a non-standard section over this grid. Outline the dedicated acreage and the separate leases within that dedicated acreage. Show the well surface location and bottom hole location, if it is directionally drilled, with the dimensions from the section lines in the cardinal directions. (Note: A legal location is determined from the perpendicular distance to the edge of the tract.) If this is a high angle or horizontal hole show that portion of the well bore that is open within this pool.

Show all lots, lot numbers, and their respective acreage.

If more than one lease has been dedicated to this completion, outline each one and identify the ownership as to both working interest and royalty.

17. The signature, printed name, and title of the person authorized to make this report, and the date this document was signed.
18. The Registered surveyors certification. This section does not have to be completed if this form has been previously accepted by the OCD and is being filed for a change of pool or dedicated acreage.

15. Write in the OCD order(s) approving a non-standard location, non-standard spacing, or directional or horizontal drilling



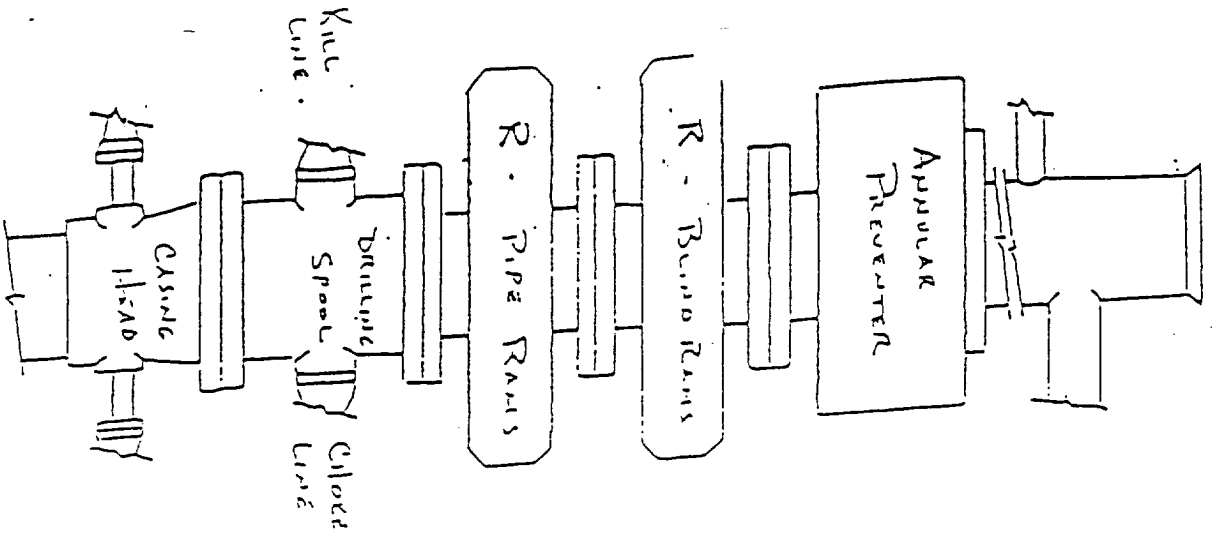

3000 PSI  
Working Pressure

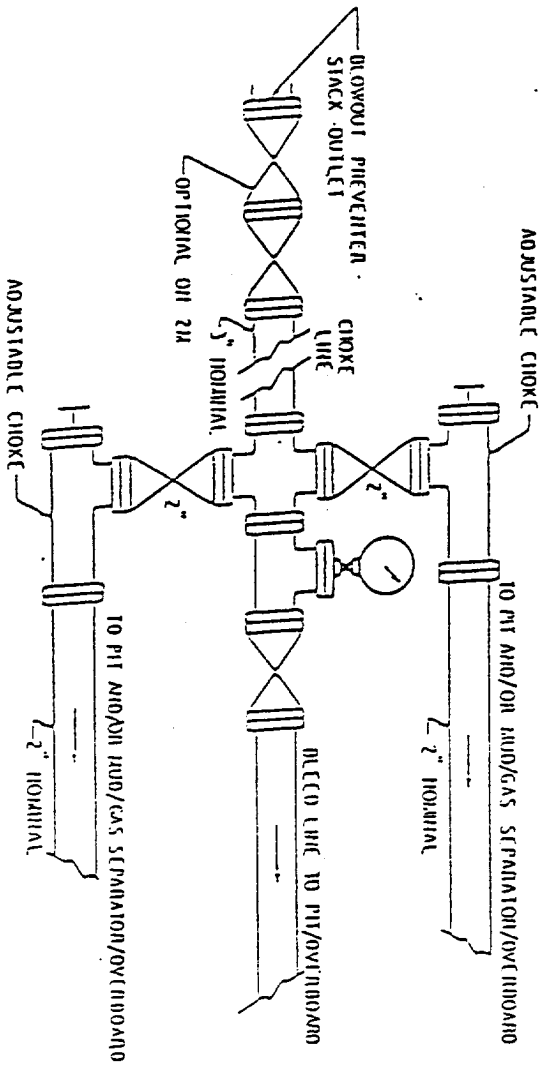

**MATADOR OPERATING COMPANY**  
**SHELLEY STATE 35 WELL #2**  
 2130' FNL & 1980' FWL  
 Sec 35, T19S, R37E  
 Lea County, New Mexico

**BLOWOUT PREVENTER**

