

District I
 1625 N. French Dr., Hobbs, NM 88240
 District II
 1301 W. Grand Avenue, Artesia, NM 88210
 District III
 1000 Rio Brazos Rd., Aztec, NM 87410
 District IV
 1220 S. St. Francis Dr., Santa Fe, NM 87505

Oil Conservation Division
 1220 South St. Francis Dr.
 Santa Fe, NM 87505

WELL API NO.
 30-025-35676

5. Indicate Type of Lease
 STATE FEE

State Oil & Gas Lease No.

WELL COMPLETION OR RECOMPLETION REPORT AND LOG

1a. Type of Well:
 OIL WELL GAS WELL DRY OTHER _____

b. Type of Completion:
 NEW WORK DEEPEN PLUG DIFF.
 WELL OVER BACK RESVR. OTHER

2. Name of Operator
 Matador Operating Company

3. Address of Operator
 310 W. Wall, Suite 906 Midland, TX 79701

7. Lease Name or Unit Agreement Name
 Laughlin

8. Well No.
 6

9. Pool name or Wildcat
 Monument; Tubb

4. Well Location
 Unit Letter F : 2310 Feet From The North Line and 1820 Feet From The West Line
 Section 4 Township 20S Range 37E NMPM Lea County

10. Date Spudded 12/28/01 11. Date T.D. Reached 01/08/02 12. Date Compl. (Ready to Prod.) 01/25/02 13. Elevations (DF& RKB, RT, GR, etc.) 3556 GR 14. Elev. Casinghead 3556 GR

15. Total Depth 6800 16. Plug Back T.D. 6758 17. If Multiple Compl. How Many Zones? _____ 18. Intervals Drilled By _____ Rotary Tools X Cable Tools _____

19. Producing Interval(s), of this completion - Top, Bottom, Name
6526 - 6600 Monument; Tubb 20. Was Directional Survey Made
No

21. Type Electric and Other Logs Run
Neutron/Density, DDL w/ mirco guard, Acoustic 22. Was Well Cored
No

23. CASING RECORD (Report all strings set in well)

| CASING SIZE | WEIGHT LB./FT. | DEPTH SET | HOLE SIZE | CEMENTING RECORD | AMOUNT PULLED |
|-------------|----------------|-----------|-----------|--|---------------|
| 8 5/8 | 24 | 1420 | 12 1/4 | 660 sx Class C | Circ |
| 4 1/2 | 11.6 | 6800 | 7 7/8 | 625 sx Super H & 730 sx Interfill C & 100 sx Class C | Circ |

| 24. LINER RECORD | | | | 25. TUBING RECORD | | | |
|------------------|-----|--------|--------------|-------------------|-------|-----------|------------|
| SIZE | TOP | BOTTOM | SACKS CEMENT | SCREEN | SIZE | DEPTH SET | PACKER SET |
| | | | | | 2 3/8 | 6694 | None |

26. Perforation record (interval, size, and number)
6526-30, 6564-68, 6596-6600 - 3 SPF

27. ACID, SHOT, FRACTURE, CEMENT, SQUEEZE, ETC.
 DEPTH INTERVAL AMOUNT AND KIND MATERIAL USED
6526-6600 Frac: 1000 gal 15% NEFE HCL
214026 lbs 20/40 sand & 134000 gals

28. PRODUCTION

Date First Production 01/25/02 Production Method (*Flowing, gas lift, pumping - Size and type pump*) Flowing Well Status (*Prod. or Shut-in*) Producing

| Date of Test | Hours Tested | Choke Size | Prod'n For Test Period | Oil - Bbl | Gas - MCF | Water - Bbl. | Gas - Oil Ratio |
|--------------|--------------|------------|------------------------|-----------|-----------|--------------|-----------------|
| 01/30/02 | 24 | 48/64 | | 56 | 401 | 70 | 7160 |

| Flow Tubing Press. | Casing Pressure | Calculated 24-Hour Rate | Oil - Bbl. | Gas - MCF | Water - Bbl. | Oil Gravity - API - (Corr.) |
|--------------------|-----------------|-------------------------|------------|-----------|--------------|-----------------------------|
| 100 | 560 | | | | | 36.7 |

29. Disposition of Gas (*Sold, used for fuel, vented, etc.*)
Sold Test Witnessed By Perry Wilbanks

30. List Attachments
C104, C103, Deviation Report, Logs, Plat

31. I hereby certify that the information shown on both sides of this form as true and complete to the best of my knowledge and belief

Signature Russ Mathis Printed Name Russ Mathis Title Production Manager Date 3/22/02

INSTRUCTIONS

This form is to be filed with the appropriate District Office of the Division not later than 20 days after the completion of any newly-drilled or deepened well. It shall be accompanied by one copy of all electrical and radio-activity logs run on the well and a summary of all special tests conducted, including drill stem tests. All depths reported shall be measured depths. In the case of directionally drilled wells, true vertical depths shall also be reported. For multiple completions, items 25 through 29 shall be reported for each zone. The form is to be filed in quintuplicate except on state land, where six copies are required. See Rule 1105.

INDICATE FORMATION TOPS IN CONFORMANCE WITH GEOGRAPHICAL SECTION OF STATE

Northwestern New Mexico

Southeastern New Mexico

OIL OR GAS SANDS OR ZONES

| | |
|------------------|-----------------------|
| T. Penn. "B" | T. Ojo Alamo |
| T. Penn. "C" | T. Kirtland-Fruitland |
| T. Penn. "D" | T. Pictured Cliffs |
| T. Leadville | T. Cliff House |
| T. Madison | T. Menefee |
| T. Eibert | T. Point Lookout |
| T. McCracken | T. Mancos |
| T. Ignacio Ozite | T. Gallup |
| T. Granite | Base Greenhorn |
| | T. Dakota |
| | T. Morrison |
| | T. Todillo |
| | T. Entrada |
| | T. Wingate |
| | T. Chinle |
| | T. Permian |
| | T. Penn. "A" |

| | |
|------------------|-------------------------|
| T. Canyon | T. Anhy |
| T. Strawn | T. Salt 1240 |
| T. Atoka | B. Salt |
| T. Miss | T. Yates 2607 |
| T. Devonian | T. 7 Rivers 2838 |
| T. Silurian | T. Queen 3483 |
| T. Montoya | T. Grayburg 3675 |
| T. Simpson | T. San Andres |
| T. McKee | T. Glorieta 5297 |
| T. Ellenburger | T. Paddock 5390 |
| T. Gr. Wash | T. Blinberry 5802 |
| T. Delaware Sand | T. Tubb 6395 |
| T. Bone Springs | T. Drinkard below 6700' |
| T. Abo | T. Wolfcamp |
| T. Penn | T. Cisco (Bough C) |

No. 1, from .6525 to .6602
 No. 2, from to
 No. 3, from to
 No. 4, from to

IMPORTANT WATER SANDS

Include data on rate of water inflow and elevation to which water rose in hole.

No. 1, from to feet
 No. 2, from to feet
 No. 3, from to feet

LITHOLOGY RECORD (Attach additional sheet if necessary)

| From | To | Thickness In Feet | Lithology |
|------|------|-------------------|-----------------|
| 0 | 1240 | 1240 | Red Beds |
| 1240 | 2607 | 1367 | Salt, Anhydrite |
| 2607 | 3483 | 876 | Anhydrite, Dol |
| 3483 | 3675 | 192 | Dol, Ss, Sh |
| 3675 | 5297 | 1622 | Dol, Ls |
| 5297 | 5390 | 93 | Dol, Ss, Sh |
| 5390 | 5734 | 344 | Dol |
| 5734 | 5802 | 68 | Dol, Sh |
| 5802 | 6395 | 593 | Dol |
| 6395 | 6580 | 185 | Dol, Ss, Sh |
| 6580 | 6800 | 220 | Dol |

ACT I
 O. Ex 1980
 Hobbs, NM 88241-1980

State of New Mexico
 Energy, Minerals, and Natural Resources Department

Form C-102
 Revised 02-10-94
 Instructions on back

DISTRICT II
 P. O. Drawer 00
 Artesia, NM 87211-0719

OIL CONSERVATION DIVISION
 P. O. Box 2088
 Santa Fe, New Mexico 87504-2088

Submit to the Appropriate
 District Office
 State Lease - 4 copies
 Fee Lease - 3 copies

DISTRICT III
 1000 Rio Brazos Rd.
 Aztec, NM 87410

AMENDED REPORT

DISTRICT IV
 P. O. Box 2088
 Santa Fe, NM 87507-2088

WELL LOCATION AND ACREAGE DEDICATION PLAT

| | | | | | | |
|------------------------------|--|---|--|-------------------------------|----------------------|--------------------|
| 1 API Number 30-025-35676 | | 2 Pool Code 47090 | | 3 Pool Name Monument; Tubb | | |
| 4 Property Code 25471 | | 5 Property Name LAUGHLIN | | | | 6 Well Number 6 |
| 7 OGRID No. 014245 | | 8 Operator Name MATAADOR OPERATING COMPANY | | | 9 Elevation 3558' | |

" SURFACE LOCATION

| UL or lot no. | Section | Township | Range | Lot Ida | Feet from the | North/South line | Feet from the | East/West line | County |
|---------------|---------|----------|-------------------|---------|---------------|------------------|---------------|----------------|--------|
| 7 | 4 | 20 SOUTH | 37 EAST, N.M.P.M. | | 2310' | NORTH | 1820' | WEST | LEA |

" BOTTOM HOLE LOCATION IF DIFFERENT FROM SURFACE

| UL or lot no. | Section | Township | Range | Lot Ida | Feet from the | North/South line | Feet from the | East/West line | County |
|---------------|---------|----------|-------|---------|---------------|------------------|---------------|----------------|--------|
| | | | | | | | | | |

| | | | |
|--------------------------|--------------------|-----------------------|--------------|
| 12 Dedicated Acres 80 | 13 Joint or Infill | 14 Consolidation Code | 15 Order No. |
|--------------------------|--------------------|-----------------------|--------------|

NO ALLOWABLE WELL BE ASSIGNED TO THIS COMPLETION UNTIL ALL INTERESTS HAVE BEEN CONSOLIDATED OR A NON-STANDARD UNIT HAS BEEN APPROVED BY THE DIVISION

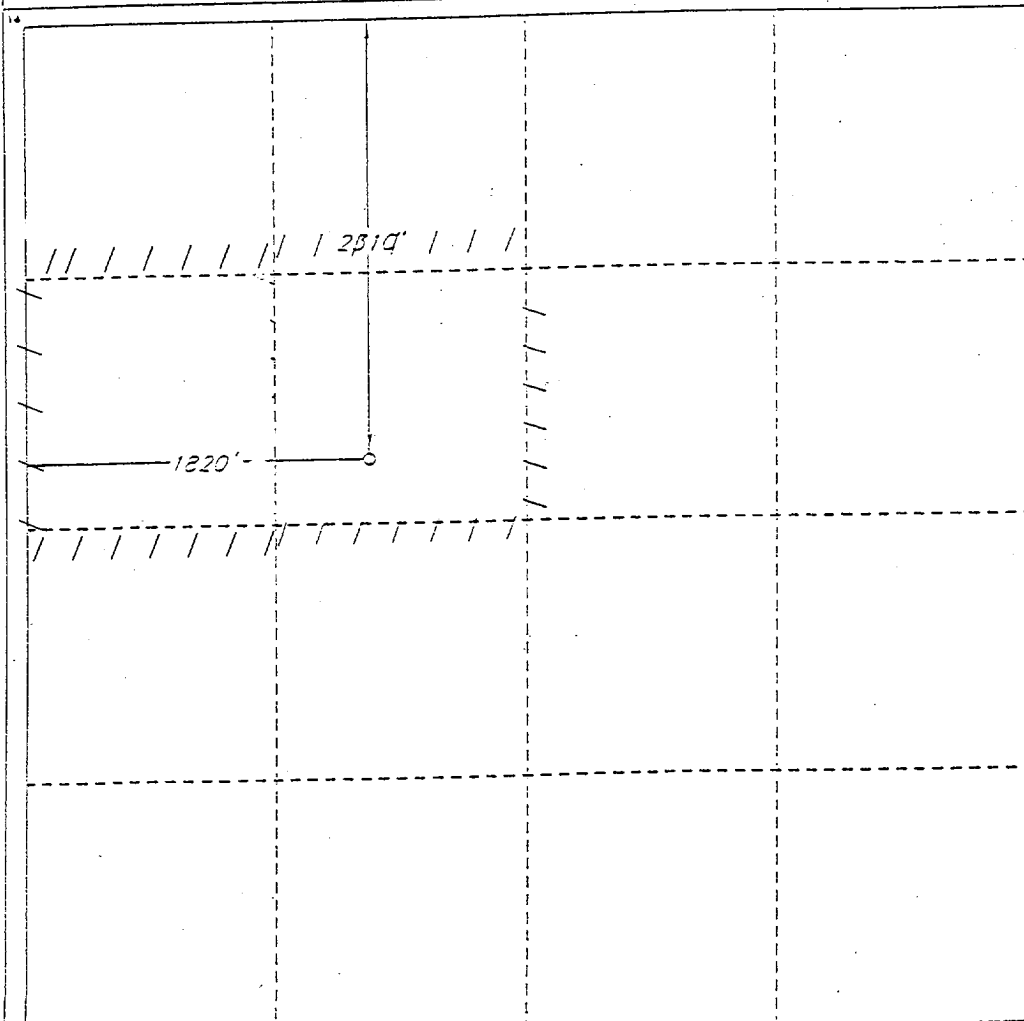

OPERATOR CERTIFICATION

I hereby certify that the information contained herein is true and complete to the best of my knowledge and belief.

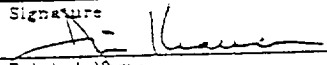
Signature

 Printed Name
 Jim Kramer
 Title
 Sr. Drilling Engineer
 Date
 10/3/01

SURVEYOR CERTIFICATION

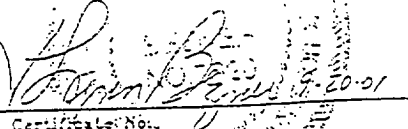
I hereby certify that the well location shown on this plat was plotted from field notes of actual surveys made by me or under my supervision, and that the same is true and correct to the best of my belief.

Date of Survey
 SEPTEMBER 19, 2001
 Signature and Seal of Professional Surveyor

 Certificate No.
 V. L. BEZNER R.P.S.#7920
 JOB #78577-77 USE / J.C.P.