

Submit to Appropriate  
District Office  
State Lease - 4 copies  
Fee Lease - 3 copies

State of New Mexico  
Energy, Minerals and Natural Resources Department

Form C-102  
Revised 1-1-89

**OIL CONSERVATION DIVISION**  
P.O. Box 2088  
Santa Fe, New Mexico 87504-2088

**DISTRICT I**  
P.O. Box 1980, Hobbs, NM 88240

**DISTRICT II**  
P.O. Drawer DD, Artesa, NM 88210

**DISTRICT III**  
1000 Rio Brazos Rd., Aztec, NM 87410

**WELL LOCATION AND ACREAGE DEDICATION PLAT**

All Distances must be from the outer boundaries of the section

Operator ARCO PERMIAN			Lease STATE 157-D			Well No. 15		
Unit Letter M	Section 12	Township T-22-S	Range R-36-E	County NMPM		LEA		
Actual Footage Location of Well:								
660 feet from the SOUTH line and			940 feet from the WEST line					
Ground level Elev. 3497'		Producing Formation YATES/7-RIVERS/QUEEN			Pool EUMONT GAS		Dedicated Acreage: 320 Acres	

- Outline the acreage dedicated to the subject well by colored pencil or hatchure marks on the plat below.
- If more than one lease is dedicated to the well, outline each and identify the ownership thereof (both as to working interest and royalty).
- If more than one lease of different ownership is dedicated to the well, have the interest of all owners been consolidated by communitization, unitization, force-pooling, etc.?  
 Yes     No    If answer is "yes" type of consolidation \_\_\_\_\_

If answer is "no" list the owners and tract descriptions which have actually been consolidated. (Use reverse side of this form if necessary.)

No allowable will be assigned to the well until all interests have been consolidated (by communitization, unitization, forced-pooling, or otherwise) or until a non-standard unit, eliminating such interest, has been approved by the Division.

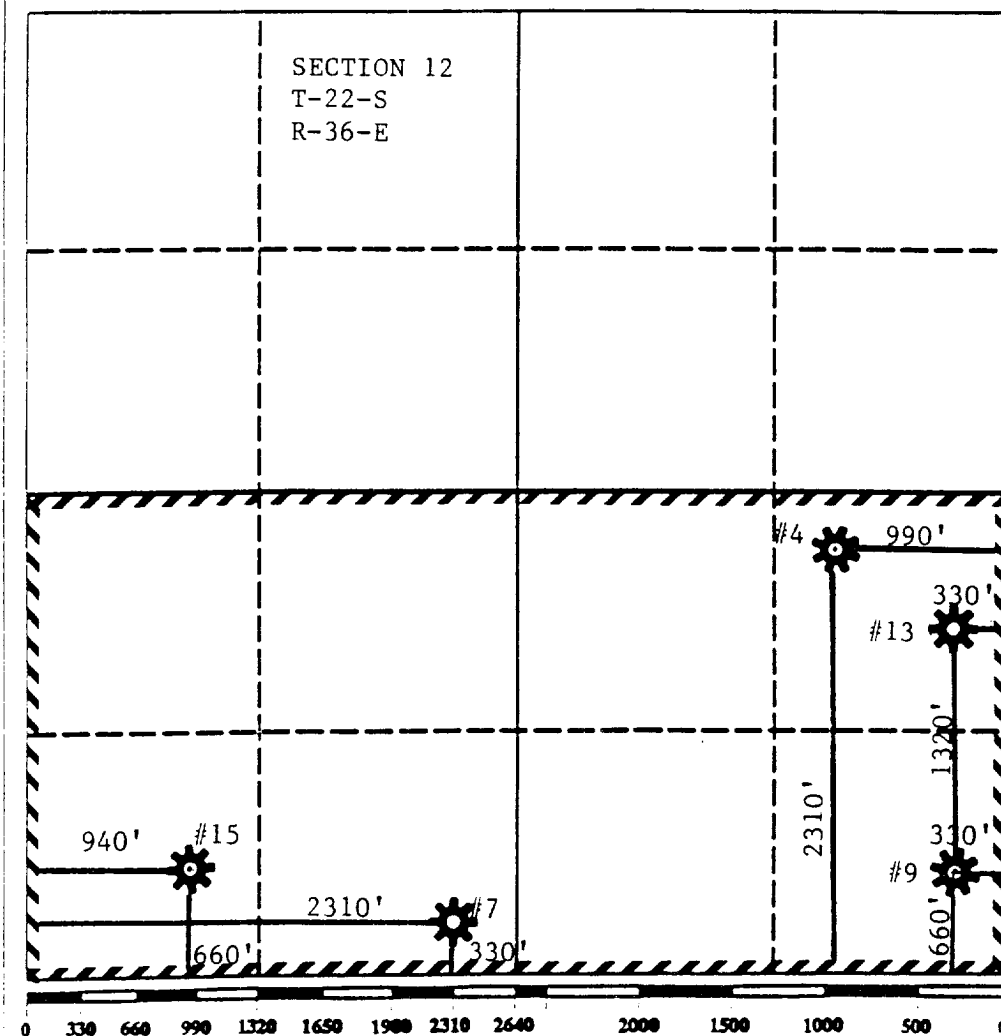

**OPERATOR CERTIFICATION**

I hereby certify that the information contained herein is true and complete to the best of my knowledge and belief.

Signature  
*Kathy E. Godfrey*  
Printed Name  
KATHY E. GODFREY

Position  
ENGINEERING TECHNICIAN

Company  
ARCO PERMIAN

Date  
12-05-94

**SURVEYOR CERTIFICATION**

I hereby certify that the well location shown on this plat was plotted from field notes of actual surveys made by me or under my supervision, and that the same is true and correct to the best of my knowledge and belief.

Date Surveyed

Signature & Seal of Professional Surveyor

Certificate No.

**RECEIVED**

11-17-73  
C. C. ROSS  
OFFICE

LEA Drinkard  
 ARCO OIL & GAS CO.  
 15 East State 157 "D"  
 Sec 12, T22S, R36E  
 660' FSL, 940' FWL of Sec  
 4 mi SW/Eunice

STATION  
 APR 30-025-2562  
 MSP  
 COORD  
 5-4-10 NM

2-20-80 5-3-80

9 5/8" at 1218' w/550 sx  
 5 1/2" at 6800' w/1360 sx  
 2 7/8" at 6716'

WELL	DATE	DEPTH	FORMATION	REMARKS

IP (Drinkard) Perf: 6619-83' @ 4 BOPD + 38 BW. Pot based  
 on 24 hr test. GOR 7000; BU 39.3

LINE Hondo #6

3497' GL, 3507' KB 6500' RC

1-27-80  
 (D-in) 1750'  
 2-17-80 Drlg 1750'  
 2-7-80 TL 6800' - 1000'  
 2-11-80 TD 6800' - 1000'  
 3-26-80 TD 6800' - FSD 6742'; Subg  
 Perf (Drinkard) @ 6619', 6622', 6624', 6635',  
 6644', 6655', 6657', 6660', 6662', 6667', 6670',  
 6672', 6681', 6686', 6688' w/1 SF.  
 Acc 1 (6619-83) 2000 gals (15%)  
 TD 6800' - FSD 6742'; SI/WOP  
 Prod (Soln-20) 17,250 gals + 40,250# sd  
 TD 6800'; FSD 6742'; Complete  
 Perf POP9: 2754', Seven Rivers 1992',  
 4000', Garberg 3747', San Andras  
 4000', Blinbry 5688',  
 4000', Drinkard 5615'  
 1000' RUN: 1111' CD, FDC  
 1-24-80 COMPLETE DOUBLE 5-4-10 NM  
 10 30-025

Submit to Appropriate District Office  
 State Lease - 4 copies  
 Fee Lease - 3 copies

State of New Mexico  
 Energy, Minerals and Natural Resources Department

Form C-102  
 Revised 1-1-89

OIL CONSERVATION DIVISION  
 P.O. Box 2088  
 Santa Fe, New Mexico 87504-2088

DISTRICT I  
 P.O. Box 1980, Hobbs, NM 88240

DISTRICT II  
 P.O. Drawer DD, Artesia, NM 88210

DISTRICT III  
 1000 Rio Brazos Rd., Aztec, NM 87410

WELL LOCATION AND ACREAGE DEDICATION PLAT

All Distances must be from the outer boundaries of the section

Operator ARCO OIL AND GAS COMPANY			Lease STATE 157-D		Well No. #15
Unit Letter M	Section 12	Township T-22S	Range R-36E	County NMPM LEA	
Actual Footage Location of Well:					
660 feet from the SOUTH line and		940 feet from the WEST line			
Ground level Elev. 3497'	Producing Formation YATES/QUEEN/7-RIVERS		Pool EUMONT GAS	Dedicated Acreage: 320 Acres	

- Outline the acreage dedicated to the subject well by colored pencil or hatchure marks on the plat below.
- If more than one lease is dedicated to the well, outline each and identify the ownership thereof (both as to working interest and royalty).
- If more than one lease of different ownership is dedicated to the well, have the interest of all owners been consolidated by communitization, unitization, force-pooling, etc.?
  - Yes  No If answer is "yes" type of consolidation \_\_\_\_\_
 If answer is "no" list the owners and tract descriptions which have actually been consolidated. (Use reverse side of this form if necessary.) \_\_\_\_\_  
 No allowable will be assigned to the well until all interests have been consolidated (by communitization, unitization, forced-pooling, or otherwise) or until a non-standard unit, eliminating such interest, has been approved by the Division.

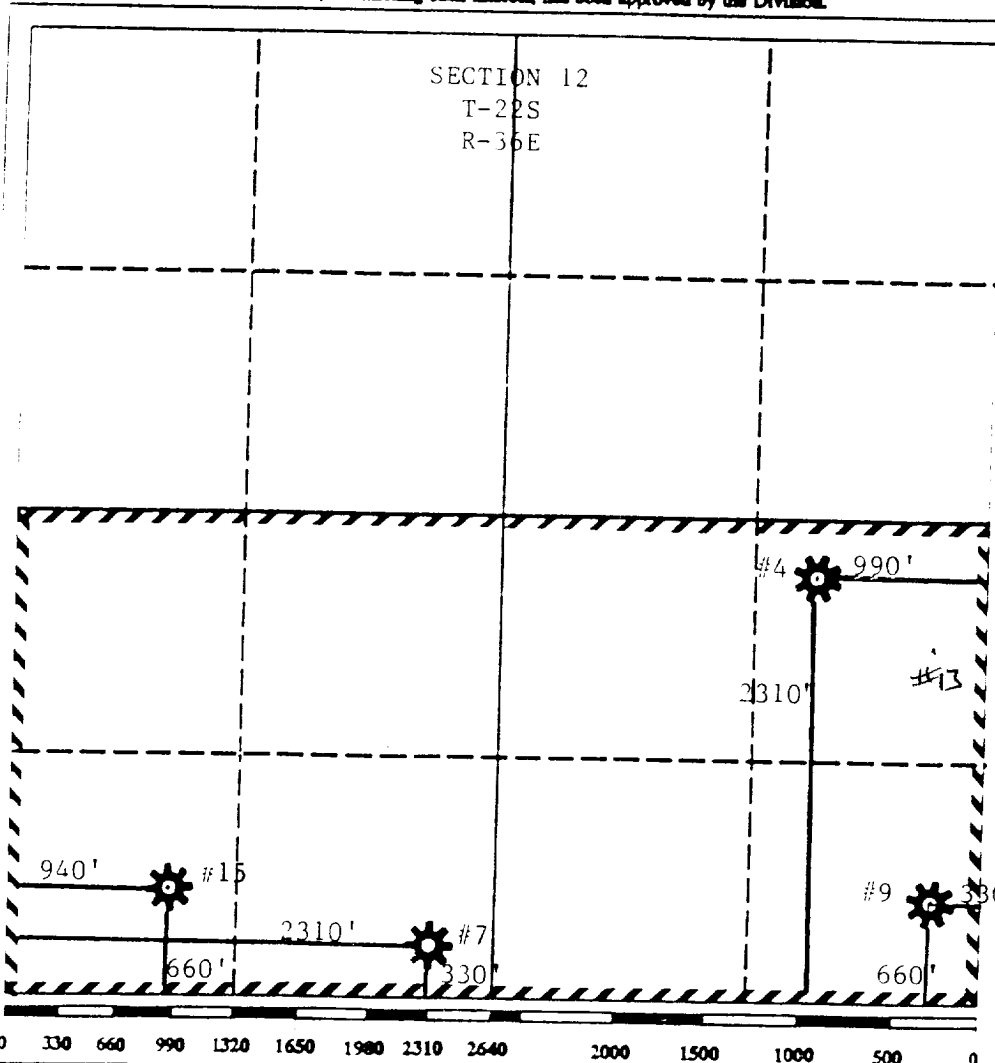

**OPERATOR CERTIFICATION**  
 I hereby certify that the information contained herein is true and complete to the best of my knowledge and belief.

Signature: E. E. Gilson  
 Printed Name: E. E. GILSON  
 Position: ENGINEERING TECHNICIAN  
 Company: ARCO OIL AND GAS COMPANY  
 Date: MARCH 22, 1993

**SURVEYOR CERTIFICATION**  
 I hereby certify that the well location shown on this plat was plotted from field notes of actual surveys made by me or under my supervision, and that the same is true and correct to the best of my knowledge and belief.

Date Surveyed: \_\_\_\_\_  
 Signature & Seal of Professional Surveyor: \_\_\_\_\_  
 Certificate No.: \_\_\_\_\_

ABL-3142 A(55) Section 12, T-22S, R-36E Eumont Gas

Submit to Appropriate  
District Office  
State Lease - 4 copies  
Fee Lease - 3 copies

State of New Mexico  
Energy, Minerals and Natural Resources Department

Form C-102  
Revised 1-1-89

OIL CONSERVATION DIVISION  
P.O. Box 2088  
Santa Fe, New Mexico 87504-2088

DISTRICT I  
P.O. Box 1980, Hobbs, NM 88240

DISTRICT II  
P.O. Drawer DD, Artesia, NM 88210

DISTRICT III  
1000 Rio Brazos Rd., Aztec, NM 87410

WELL LOCATION AND ACREAGE DEDICATION PLAT

All Distances must be from the outer boundaries of the section

Operator ARCO OIL AND GAS COMPANY		Lease STATE 157-D		Well No. 15
Unit Letter M	Section 12	Township T-22S	Range R-36E	County LEA
Actual Footage Location of Well: 660 feet from the SOUTH line and 940 feet from the WEST line				
Ground level Elev. 3497'	Producing Formation YATES/7-RIVERS/QUEEN	Pool EUMONT GAS	Dedicated Acreage: 320 Acres	

- Outline the acreage dedicated to the subject well by colored pencil or hatchure marks on the plat below.
- If more than one lease is dedicated to the well, outline each and identify the ownership thereof (both as to working interest and royalty).
- If more than one lease of different ownership is dedicated to the well, have the interest of all owners been consolidated by communitization, unitization, force-pooling, etc.?
  - Yes     No    If answer is "yes" type of consolidation \_\_\_\_\_
 If answer is "no" list the owners and tract descriptions which have actually been consolidated. (Use reverse side of this form if necessary.)  
 No allowable will be assigned to the well until all interests have been consolidated (by communitization, unitization, forced-pooling, or otherwise) or until a non-standard unit, eliminating such interest, has been approved by the Division.

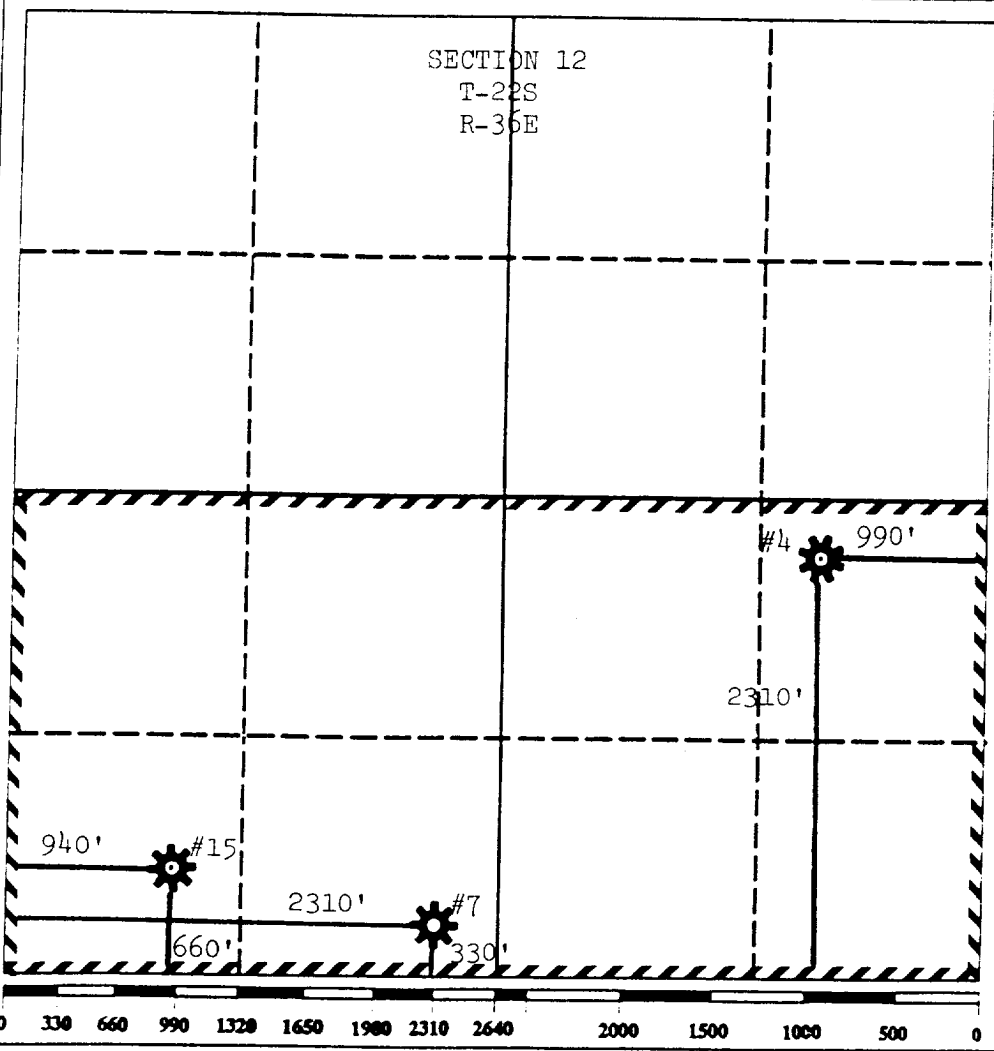

**OPERATOR CERTIFICATION**  
I hereby certify that the information contained herein is true and complete to the best of my knowledge and belief.

Signature  
EVELYN E. GILSON

Printed Name  
ENGINEERING TECHNICIAN

Position  
ARCO OIL AND GAS COMPANY

Company  
SEPTEMBER 24, 1992

Date

**SURVEYOR CERTIFICATION**  
I hereby certify that the well location shown on this plat was plotted from field notes of actual surveys made by me or under my supervision, and that the same is true and correct to the best of my knowledge and belief.

Date Surveyed

Signature & Seal of Professional Surveyor

Certificate No.