

District I  
 PC Box 1980, Hobbs, NM 88241-1980

District II  
 PC Drawer DD, Artesia, NM 88211-0719

District III  
 1000 Rio Brazos Rd. Aztec, NM 87410

District IV  
 PC Box 2088, Santa Fe, NM 87504-2088

State of New Mexico  
 Energy, Minerals & Natural Resources Department

OIL CONSERVATION DIVISION  
 PO Box 2088  
 Santa Fe, NM 87504-2088

Form C-102

Revised February 21, 1994  
 instructions on back

Submit to Appropriate District Office  
 State Lease - 4 Copies  
 Fee Lease - 3 Copies

AMENDED REPORT

WELL LOCATION AND ACREAGE DEDICATION PLAT

API Number 30-1225-35938		2 Pool Code 06660		3 Pool Name Blinebry Oil & Gas	
4 Property Code 13492		5 Property Name SEMU			6 Well Number # 167
7 OGRID No. 005073		8 Operator Name Conoco Inc., 10 Desta Drive, Ste. 100W, Midland, TX 79705-4500			9 Elevation 3519'

10 Surface Location

UL or ldn.	Section	Township	Range	Lot ldn	Feet from the	North/South line	Feet from the	East/West line	County
G	25	20S	37E		2250	North	1530	East	Lea

11 Bottom Hole Location If Different From Surface

UL or lot no.	Section	Township	Range	Lot ldn	Feet from the	North/South line	Feet from the	East/West line	County

12 Dedicated Acres 40	13 Joint or Infill	14 Consolidation Code	15 Order No. NSL-4413-A (50)
--------------------------	--------------------	-----------------------	---------------------------------

NO ALLOWABLE WILL BE ASSIGNED TO THIS COMPLETION UNTIL ALL INTERESTS HAVE BEEN CONSOLIDATED OR A NON-STANDARD UNIT HAS BEEN APPROVED BY THE DIVISION

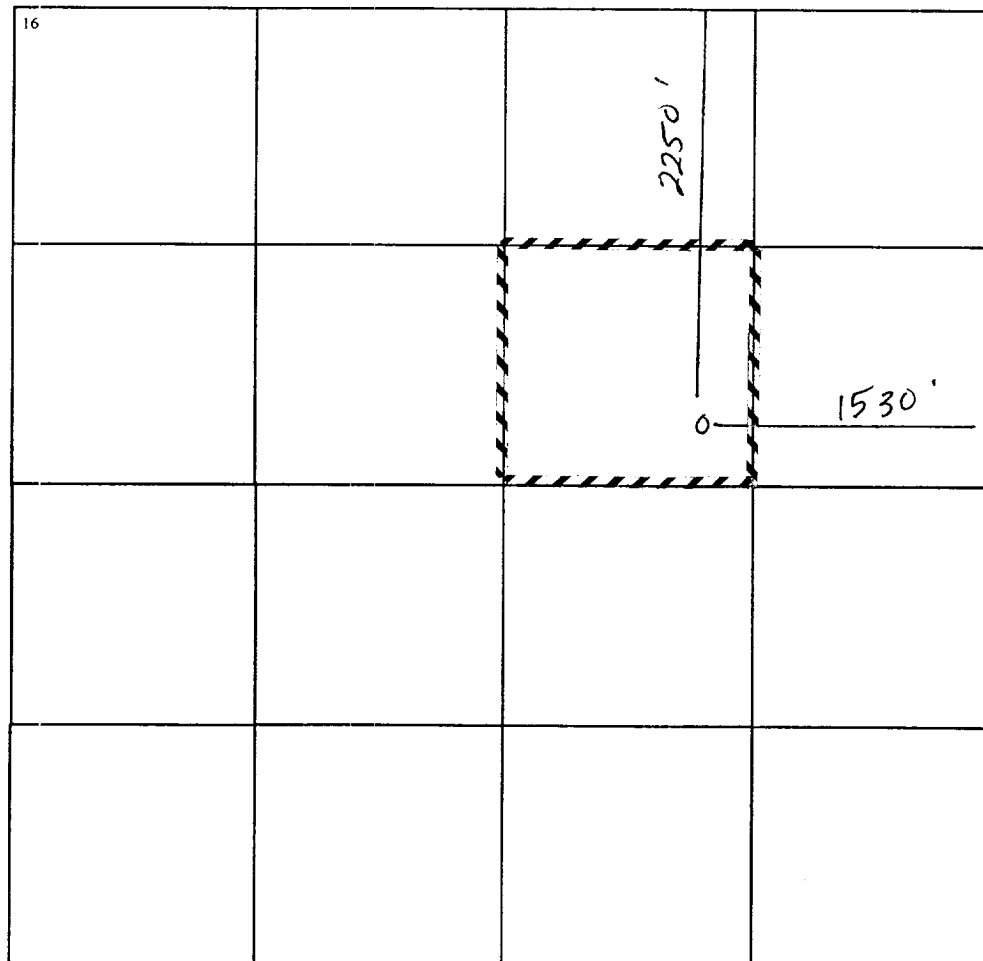

17 OPERATOR CERTIFICATION

I hereby certify that the information contained herein is true and complete to the best of my knowledge and belief.

*Kay Maddox*  
 Signature  
 Kay Maddox  
 Printed Name  
 Regulatory Agent  
 Title  
 May 16, 2002  
 Date

18 SURVEYOR CERTIFICATION

I hereby certify that the well location shown on this plat was plotted from field notes of actual surveys made by me or under my supervision, and that the same is true and correct to the best of my belief.

Date of Survey  
 Signature and Seal of Professional Surveyor:

Certificate Number