

NEW MEXICO OIL CONSERVATION COMMISSION

SANTA FE, NEW MEXICO

7-3-58

APPLICATION FOR DUAL COMPLETION

Field Name <b>Blanchery (oil) &amp; Driskard (gas)</b>		County <b>San Juan</b>	Date <b>7-2-58</b>
Operator <b>Atlantic Oil &amp; Refining Company</b>		Lease <b>New Mexico State "V"</b>	Well No. <b>1</b>
Location of Well	Unit <b>2</b>	Section <b>2</b>	Township <b>2 North</b>
		Range <b>37 East</b>	<b>1919</b>

1. Has the New Mexico Oil Conservation Commission heretofore authorized the dual completion of a well in these same pools or in the same zones within one mile of the subject well? YES  NO
2. If answer is yes, identify one such instance: Order No. **1-1234**; Operator, Lease, and Well No.: **Atlantic Oil & Gas Company's South 30-30 Well No. 1.**

3. The following facts are submitted:	Upper Zone	Lower Zone
a. Name of reservoir	<b>Blanchery</b>	<b>Driskard</b>
b. Top and Bottom of Pay Section (Perforations)	<b>3710-3715 &amp; 3710-3800</b>	<b>3825-3835 &amp; 3810-3850</b>
c. Type of production (Oil or Gas)	<b>Oil</b>	<b>Oil</b>
d. Method of Production (Flowing or Artificial Lift)	<b>Flowing</b>	<b>Flowing</b>

4. The following are attached. (Please mark YES or NO)
- a. Diagrammatic Sketch of the Dual Completion, showing all casing strings, including size and setting, top of cement, perforated intervals, tubing strings, including diameters and setting depth, location and type of packers and side door chokes, and such other information as may be pertinent.
  - b. Plat showing the location of all wells on applicant's lease, all offset wells on offset leases, and the names and addresses of operators of all leases offsetting applicant's lease.
  - c. Waivers consenting to such dual completion from each offset operator, or in lieu thereof, evidence that said offset operators have been furnished copies of the application.\*
  - d. Electrical log of the well or other acceptable log with tops and bottoms of producing zones and intervals of perforation indicated thereon. (If such log is not available at the time application is filed, it shall be submitted as provided by Rule 112-A.)

5. List all offset operators to the lease on which this well is located together with their correct mailing address.
- Continental Oil Company, Box 431, Midland, Texas**
  - Atlantic Oil & Gas Company, Box 247, Hobbs, New Mexico**
  - Telewater Oil Company, Box 1231, Midland, Texas**
  - Gulf Oil Corp., Box 1130, Midland, Texas**
  - New American Petroleum Corp., Box 1540, Midland, Texas**

6. Were all operators listed in Item 5 above notified and furnished a copy of this application? YES  NO  . If answer is yes, give date of such notification \_\_\_\_\_.

CERTIFICATE: I, the undersigned, state that I am the **Assistant Div. Mgr.** of the **Atlantic Oil & Refining Co.** (company), and that I am authorized by said company to make this report; and that this report was prepared under my supervision and direction and that the facts stated therein are true, correct and complete to the best of my knowledge.

\_\_\_\_\_  
Signature

\* Should waivers from all offset operators not accompany an application for administrative approval, the New Mexico Oil Conservation Commission will hold the application for a period of twenty (20) days from date of receipt by the Commission's Santa Fe office. If, after said twenty-day period, no protest nor request for hearing is received by the Santa Fe office, the application will then be processed.

NOTE: If the proposed dual completion will result in an unorthodox well location and/or a non-standard proration unit in either or both of the producing zones, then separate application for approval of the same should be filed simultaneously with this application.

# HUMBLE OIL & REFINING COMPANY

MIDLAND, TEXAS

August 29, 1958

New Mexico Oil Conservation Commission

Box 871

Santa Fe, New Mexico

Inre: Application for Dual Completion

New Mexico State "V" Well #1

Blinebry & Drinkard Fields

Lea County, New Mexico

Attention: Mr. A. L. Porter, Jr.

Gentlemen:

Humble Oil & Refining Company respectfully requests Administrative Approval for dual oil-oil completion in the subject fields. In support of this application we submit the following information.

1. The New Mexico State "V" No. 1 well is located 660' from the South and West lines of Section 10, T-21-S, R-37-E, Lea County, New Mexico.
2. The subject well was dually completed in July 1957. The Blinebry Zone was perforated and it was thought that gas production would result; however, the formation was oil bearing. The Drinkard Zone was completed as an oil producing formation and shut in. An allowable was assigned to the Blinebry Zone of the well and has been produced continuously.
3. We propose to dually complete the well by removing the existing 2" string of tubing and re-running parallel strings of  $1\frac{1}{2}$ " non-upset tubing. Sufficient flow area will be provided by the  $1\frac{1}{2}$ " tubing to produce both wells to depletion either by natural flow or artificial lift.
4. The dual completion of this well will be in the interest of conservation and the mechanics of the dual are feasible and practical.
5. Approval of the subject application will not cause waste nor impair correlative rights.
6. The production from each zone will be produced and stored separately and the well head connections will be labeled in such a manner that the producing formation can be easily determined.
7. The Oil Conservation Commission by Order No. R-1236 approved a similar installation for Aztec Oil and Gas Company for a dual oil-oil completion.

1958 SEP 2 AM 8 48  
MIDLAND OFFICE OGC

Hall  
ccc

CONFIDENTIAL

... ..  
... ..  
... ..

... ..  
... ..

... ..  
... ..

... ..  
... ..  
... ..  
... ..  
... ..

... ..  
... ..  
... ..  
... ..

... ..  
... ..

... ..  
... ..

... ..  
... ..  
... ..

... ..  
... ..  
... ..

August 29, 1958

SEP 2 AM 8 43

- 8. This application is further supported by a diagrammatic sketch, revised Form C-128 (Acreage Dedication Plat), Electric logs, unit plat showing all off-set operators, application for dual completion, and a copy of letter to all off-set operators.
- 9. All off-set operators were notified on August 29, 1958, by certified mail of Humble's application.

Should it not be possible to grant Administrative Approval for the subject application it would be appreciated if this matter could be set for An Examiner Hearing at your earliest open date.

I hereby certify that the information given above is true and correct to the best of my knowledge and belief.

Very truly yours,

*R. R. McCarty*

R. R. MCCARTY

Subscribed and sworn to before me this 29 day of August, 1958.

*Betty Ann Weathers*

Notary Public in and for Midland County, Texas.

Betty Ann Weathers

3. The first part of the paper is devoted to the study of the asymptotic behavior of the solutions of the system (1) as  $t \rightarrow \infty$ .

4. In the second part, we consider the problem of the stability of the solutions of the system (1) with respect to the initial conditions.

5. In the third part, we study the problem of the stability of the solutions of the system (1) with respect to the parameters.

6. In the fourth part, we consider the problem of the stability of the solutions of the system (1) with respect to the structure of the matrix  $A$ .

7. In the fifth part, we study the problem of the stability of the solutions of the system (1) with respect to the structure of the matrix  $B$ .

REFERENCES

1. A. A. Krasovskii, *Stability of Motion*, Moscow, 1959.

2. S. L. Sobolev, *Stability of Motion*, Moscow, 1970.

3. A. A. Krasovskii, *Stability of Motion*, Moscow, 1959.

NEW MEXICO OIL CONSERVATION COMMISS.

Well Location and Acreage Dedication Plat

Section A.

Date July 10, 1957

Operator Humble Oil & Refining Co Lease New Mexico State "Y"  
Well No. One Unit Letter "M" Section 10 Township 21-South Range 37-E NMPM  
Located 660 Feet From South Line, 660 Feet From West Line  
County Lea G. L. Elevation \_\_\_\_\_ Dedicated Acreage 40 Acres  
Name of Producing Formation Blinbry & Drinkard Oil Pool Blinbry-Drinkard

1. Is the Operator the only owner\* in the dedicated acreage outlined on the plat below?  
Yes X No \_\_\_\_\_.
2. If the answer to question one is "no," have the interests of all the owners been consolidated by communitization agreement or otherwise? Yes \_\_\_\_\_ No \_\_\_\_\_. If answer is "yes," Type of Consolidation \_\_\_\_\_
3. If the answer to question two is "no," list all the owners and their respective interests below:

67 5 49  
67 5 49  
67 5 49  
67 5 49

Owner

Land Description

<u>Owner</u>	<u>Land Description</u>

Section B

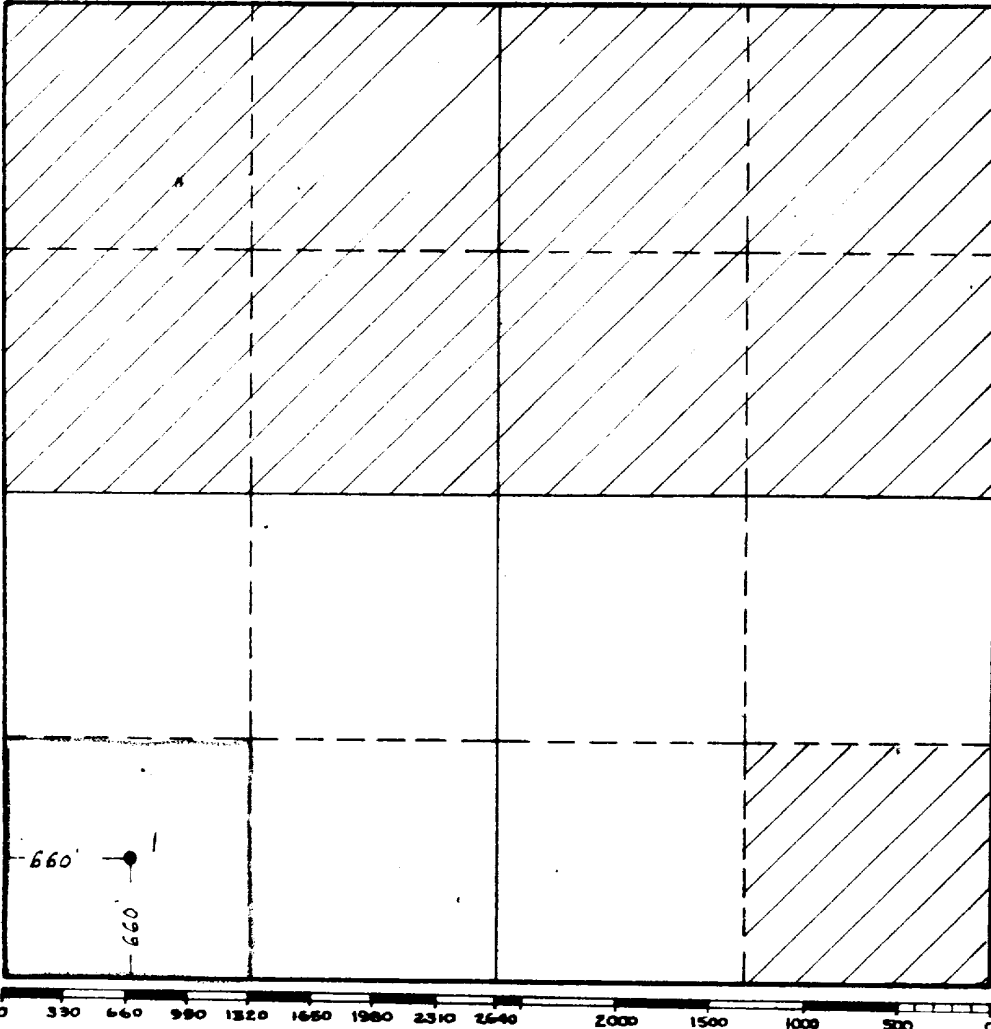

This is to certify that the information in Section A above is true and complete to the best of my knowledge and belief.

Humble Oil & Refining Co.  
(Operator)

Henry E. ...  
(Representative)  
Asst. Division Supt.  
Box 1600 Midland, Texas  
Address

This is to certify that the well location shown on the plat in Section B was plotted from field notes of actual surveys made by me or under my supervision and that the same is true and correct to the best of my knowledge and belief.

Date Surveyed \_\_\_\_\_

J. W. ...  
Registered Professional Engineer and/or Land Surveyor.

Certificate No. 1513  
the reverse side)  
File Number W-A 75.9

(See instructions for completing this form on Humble Use Number 37722)

1958 SEP 22 AM 8:43  
 1958 OFFICE OCC

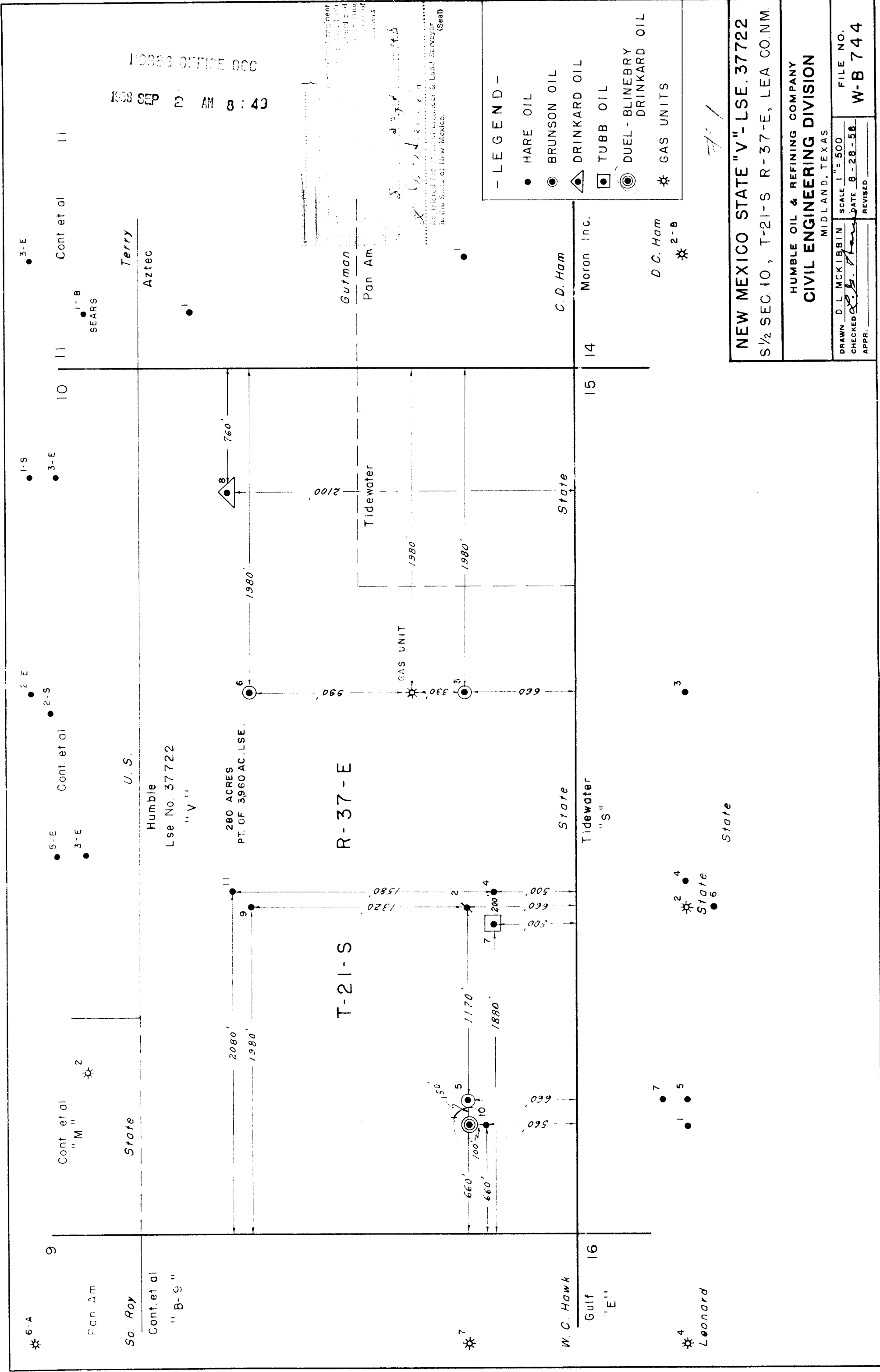

- LEGEND -  
 ● HARE OIL  
 ● BRUNSON OIL  
 ▲ DRINKARD OIL  
 □ TUBB OIL  
 ⊙ DUEL - BLINEBRY DRINKARD OIL  
 ☆ GAS UNITS

NEW MEXICO STATE "V"-LSE. 37722  
 S 1/2 SEC. 10, T-21-S R-37-E, LEA CO. NM.  
 HUMBLE OIL & REFINING COMPANY  
 CIVIL ENGINEERING DIVISION  
 MIDLAND, TEXAS  
 DRAWN D.L. MCKIBBIN SCALE 1" = 500'  
 CHECKED *[Signature]* DATE 8-28-58  
 APPR. *[Signature]* REVISED  
 FILE NO. W-B 744

DI. AMMATIC SKETCH OF DUAL COMPLET

Operator Humble Oil & Refining Company  
 Lease and Well No. N.V. State V-1  
 Fields Blinebry(Oil)and Drinkard

Exhibit No. \_\_\_\_\_

