

WELL LOCATION AND ACREAGE DEDICATION PLAT

SEE INSTRUCTIONS FOR COMPLETING THIS FORM ON THE REVERSE SIDE

NORRIS OFFICE 000

SECTION A

| | | | | | | | |
|--|---|-------------------------------|--|-------------------------------------|---------------------------------------|----------------------------|--|
| Operator Continental Oil Co. | | Lease Lockhart B-11 | | Date 1960 JAN 19 AM 10:30 | | File No. 15-TB-D | |
| Unit Letter J | Section 11 | Township 21 South | Range 37 East | County Lea County | | | |
| Actual Footage Location of Well: 1650 feet from the East line and 2310 feet from the South line | | | | | | | |
| Ground Level Elev. | Producing Formation Blinebry & Drinkard | | Pool Terry Blinebry & Drinkard | | Dedicated Acreage: 40 Acres | | |

1. Is the Operator the only owner in the dedicated acreage outlined on the plat below? YES XX NO ____ . ("Owner" means the person who has the right to drill into and to produce from any pool and to appropriate the production either for himself or for himself and another. (65-3-29 (e) NMSA 1935 Comp.)
2. If the answer to question one is "no," have the interests of all the owners been consolidated by communitization agreement or otherwise? YES ____ NO ____ . If answer is "yes," Type of Consolidation ____
3. If the answer to question two is "no," list all the owners and their respective interests below:

| Owner | Land Description |
|-------|------------------|
| | |
| | |

SECTION B

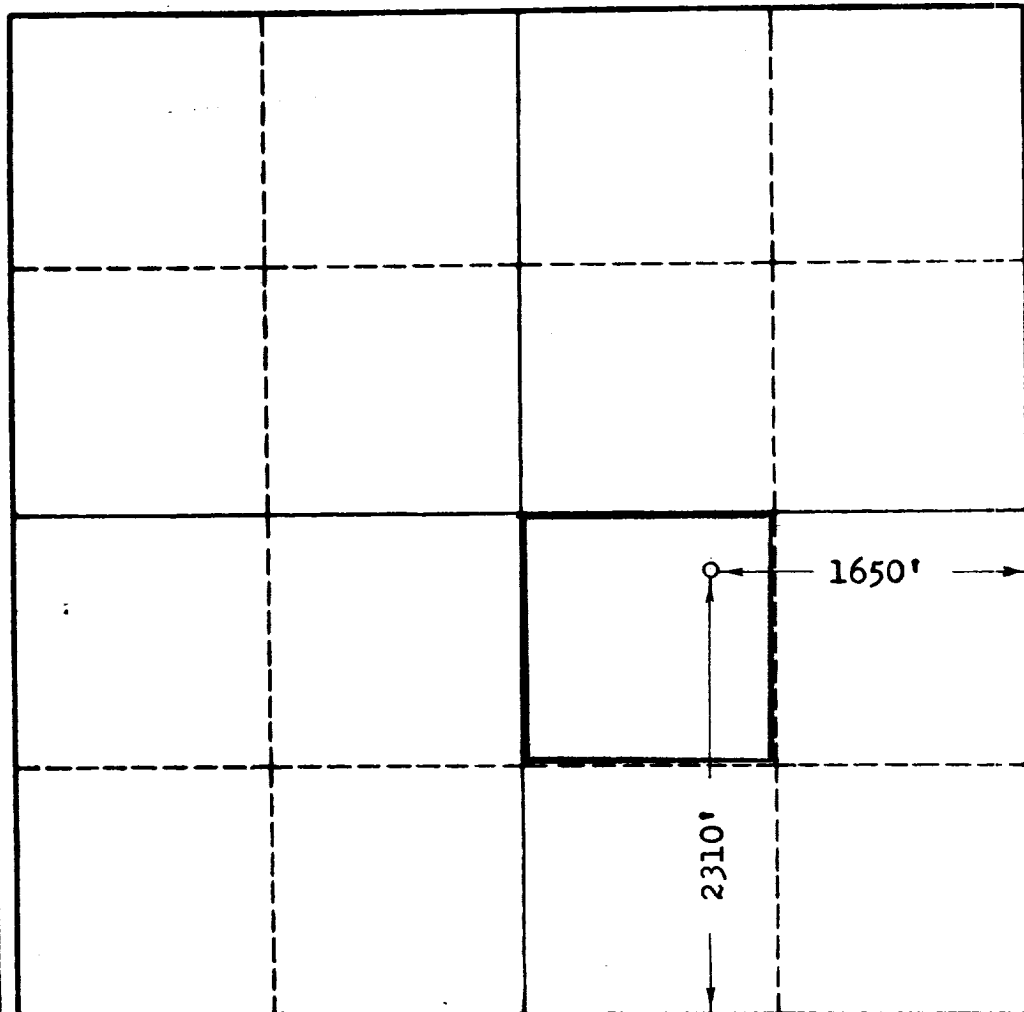

CERTIFICATION

I hereby certify that the information in SECTION A above is true and complete to the best of my knowledge and belief.

Name

J. R. Parker

Position

District Superintendent
Company
Continental Oil Company

Date

January 18, 1960

I hereby certify that the well location shown on the plat in SECTION B was plotted from field notes of actual surveys made by me or under my supervision, and that the same is true and correct to the best of my knowledge and belief.

Date Surveyed

1-5-60Registered Professional Engineer
and/or Land Surveyor, **JOHN W. WEST**

Certificate No.

N.M. - P.E. & L.S. NO. 676

0 330 660 990 1320 1650 1980 2310 2640 2000 1500 1000 500 0