

VICINITY MAP

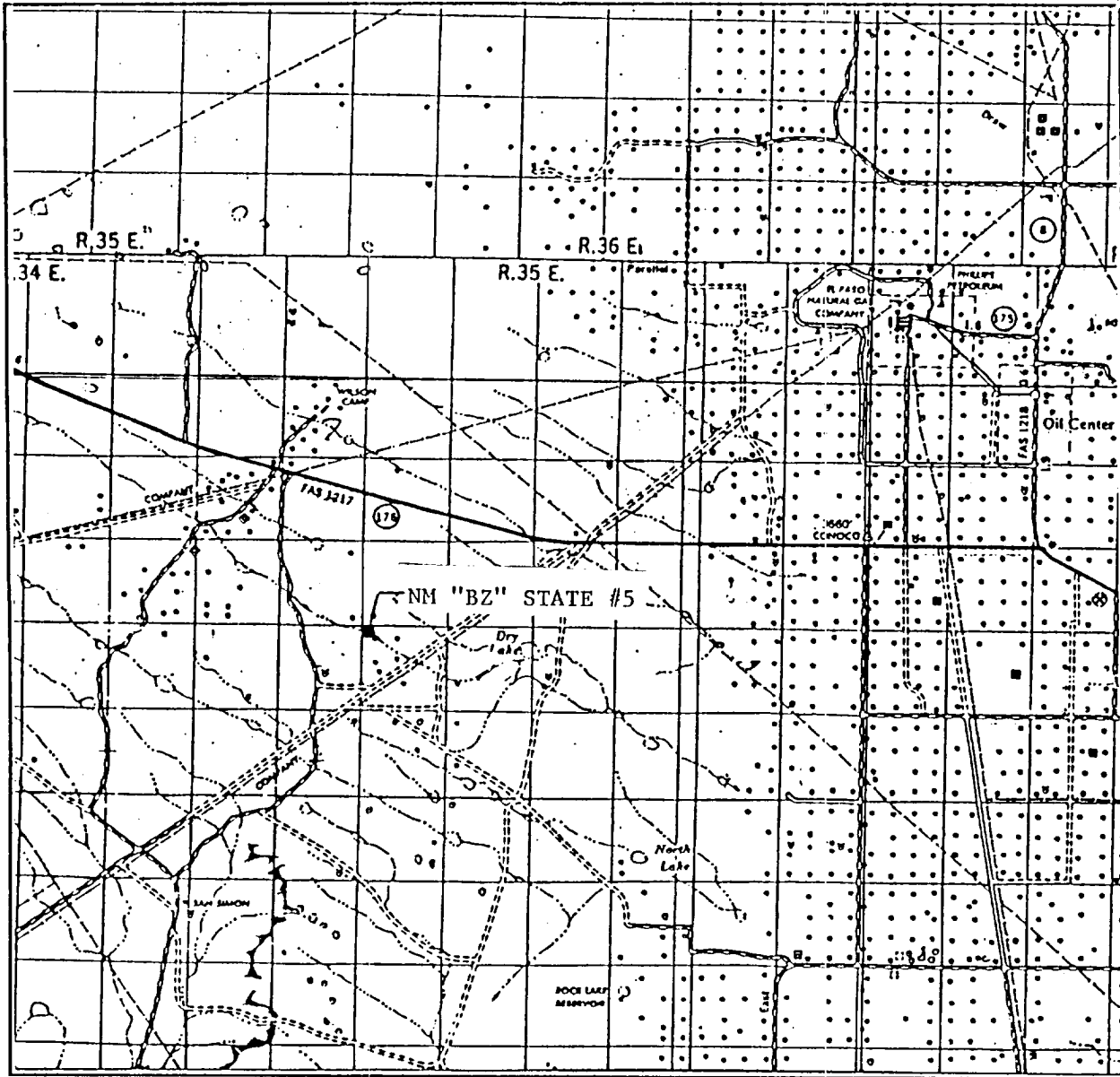

SCALE: 1" = 2 MILES

SEC. 29 TWP. 21S RGE. 35E

SURVEY N.H.P.M.

COUNTY LEA STATE N.M.

DESCRIPTION 40' FNL & 750' FVL

ELEVATION 3648.9'

OPERATOR BABER WELL SERVICING CO.

LEASE NM "BZ" STATE #5

JOHN WEST ENGINEERING
 HOBBS, NEW MEXICO
 (505) 393-3117