

## DISTRICT I

P.O. Box 1980, Hobbs, NM 88241-1980

## DISTRICT II

P.O. Box Drawer DD, Artesia, NM 88211-0719

## DISTRICT III

1000 Rio Brazos Rd., Aztec, NM 87410

## DISTRICT IV

P.O. Box 2088, Santa Fe, NM 87504-2088

## State of New Mexico

Energy, Minerals and Natural Resources Department

Form C-101

Revised February 10, 1994

Instructions on back

Submit to Appropriate District Office

State Lease - 6 Copies

Fee Lease - 5 Copies

☐ AMENDED REPORT

## OIL CONSERVATION DIVISION

P.O. Box 2088

Santa Fe, New Mexico 87504-2088

## APPLICATION FOR PERMIT TO DRILL, RE-ENTER, DEEPEN, PLUGBACK, OR ADD A ZONE

<sup>1</sup> Operator Name and Address TEXACO EXPLORATION & PRODUCTION INC. 205 E. Bender, HOBBS, NM 88240		<sup>2</sup> OGRID Number 022351
<sup>4</sup> Property Code 011114	<sup>5</sup> Property Name STICHER, E. A.	<sup>3</sup> API Number 30 025 10040
		<sup>6</sup> Well No. 3

<sup>7</sup> Surface Location

UI or lot no.	Section	Township	Range	Lot.Idn	Feet From The	North/South Line	Feet From The	East/West Line	County
K	4	22S	37E		1830	SOUTH	1830	WEST	LEA

<sup>8</sup> Proposed Bottom Hole Location If Different From Surface

UI or lot no.	Section	Township	Range	Lot.Idn	Feet From The	North/South Line	Feet From The	East/West Line	County
<sup>9</sup> Proposed Pool 1 Blinebry Oil & Gas					<sup>10</sup> Proposed Pool 2				

<sup>11</sup> Work Type Code P	<sup>12</sup> Well Type Code O	<sup>13</sup> Rotary or C.T. R	<sup>14</sup> Lease Type Code S	<sup>15</sup> Ground Level Elevation
<sup>16</sup> Multiple No	<sup>17</sup> Proposed Depth 6300'	<sup>18</sup> Formation Blinebry	<sup>19</sup> Contractor Pride	<sup>20</sup> Spud Date 12/2/96



<sup>21</sup> Proposed Casing and Cement Program

SIZE OF HOLE	SIZE OF CASING	WEIGHT PER FOOT	SETTING DEPTH	SACKS OF CEMENT	EST. TOP
17"	13-3/8"	44.5#	153'	150	Circ.
11-1/4"	9-5/8"	36#	2860'	1400	Circ.
8-1/4"	7"	23#	8030'	150	7100'

22 Describe the proposed program. If this application is to DEEPEN or PLUG BACK give the data on the present productive zone and proposed new productive zone. Describe the blowout prevention program, if any. Use additional sheets if necessary.

- 1) MIRU, TOH rods & pump. Install BOP, TOH prod equipment.
- 2) TIH & run logs, find TOC, run log. TIH w/CIBP set above Drinkard perms @ 6300'. Perforate Blinebry w/2jspf (5515'-5613') 112 holes.
- 3) TIH w/pkr & set @ 5475', acidize Blinebry perms 5515'-5613' w/3000 gals 15% NEFE HCL. Flow back. TOH w/tbg & pkr.
- 4) TIH w/frac pkr & set 5400' & test. Frac Blinebry perms w/35.5K gals 35# borate w/100k# 16/30 sand and tail w/40k 16/30 resin sand.
- 5) Flow back. TOH tbg & pkr. Clean out to 6300'. TIH w/tbg, pump, rods. Place on test.
- 6) After production has stabilized, obtain DHC permit to commingle Blinebry & Drinkard.

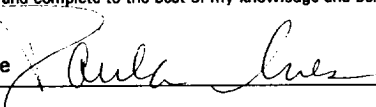
Permit Expires 1 Year From Approval Date Unless ~~During Underway~~  
Plugback

<sup>23</sup> I hereby certify that the rules and regulations of the Oil Conservation Division have been complied with and that the information given above is true and complete to the best of my knowledge and belief.		OIL CONSERVATION DIVISION	
Signature 			
Printed Name Paula S. Ives		Approved By:  DISTRICT ENGINEER	
Title Engineering Assistant		Title:	
Date 11/19/96		Approval Date: NOV 21 1996	Expiration Date:
Telephone 397-0432		Conditions of Approval: Attached <input type="checkbox"/>	

## DISTRICT I

P.O. Box 1980, Hobbs, NM 88241-1980

## DISTRICT II

P.O. Box Drawer DD, Artesia, NM 88211-0719

## DISTRICT III

1000 Rio Brazos Rd., Aztec, NM 87410

## DISTRICT IV

P.O. Box 2088, Santa Fe, NM 87504-2088

## State of New Mexico

Energy, Minerals and Natural Resources Department

Form C-102

Revised February 10, 1994

Instructions on back

Submit to Appropriate District Office

State Lease - 4 Copies

Fee Lease - 3 Copies

☐ AMENDED REPORT

## OIL CONSERVATION DIVISION

P.O. Box 2088

Santa Fe, New Mexico 87504-2088

## WELL LOCATION AND ACREAGE DEDICATION PLAT

<sup>1</sup> API Number 30 025 10040	<sup>2</sup> Pool Code 06660	<sup>3</sup> Pool Name Blinberry Oil & Gas
<sup>4</sup> Property Code 011114	<sup>5</sup> Property Name STICHER, E. A.	<sup>6</sup> Well No. 3
<sup>7</sup> OGRID Number 022351	<sup>8</sup> Operator Name TEXACO EXPLORATION & PRODUCTION INC.	<sup>9</sup> Elevation

<sup>10</sup> Surface Location

UI or lot no.	Section	Township	Range	Lot.Idn	Feet From The	North/South Line	Feet From The	East/West Line	County
K	4	22S	37E		1830	SOUTH	1830	WEST	LEA

<sup>11</sup> Bottom Hole Location If Different From Surface

UI or lot no.	Section	Township	Range	Lot.Idn	Feet From The	North/South Line	Feet From The	East/West Line	County
---------------	---------	----------	-------	---------	---------------	------------------	---------------	----------------	--------

<sup>12</sup> Dedicated Acres 40	<sup>13</sup> Joint or Infill No	<sup>14</sup> Consolidation Code	<sup>15</sup> Order No.
-------------------------------------	-------------------------------------	----------------------------------	-------------------------

NO ALLOWABLE WILL BE ASSIGNED TO THIS COMPLETION UNTIL ALL INTERESTS HAVE BEEN CONSOLIDATED  
OR A NON-STANDARD UNIT HAS BEEN APPROVED BY THE DIVISION

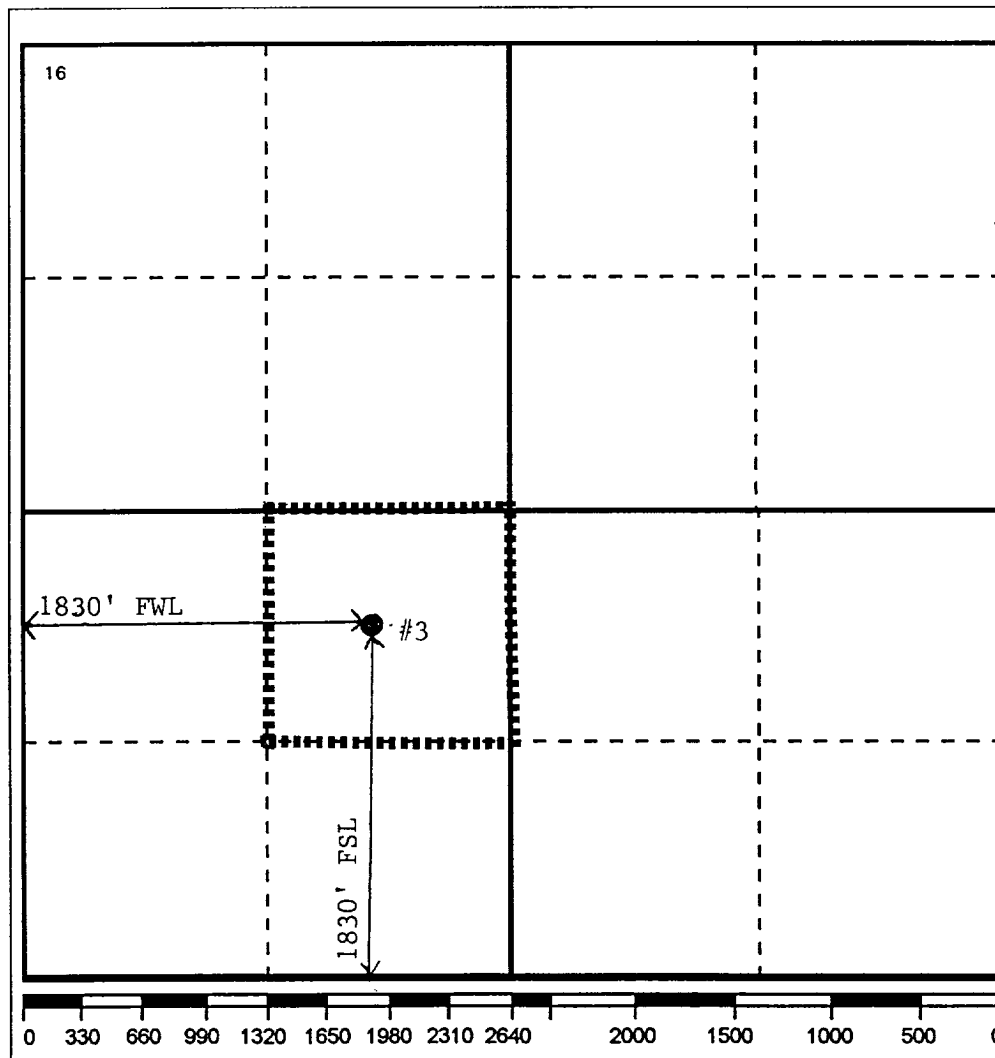
<sup>17</sup> OPERATOR CERTIFICATION

I hereby certify that the information contained herein is true and complete to the best of my knowledge and belief

Signature

*Paula S. Ives*

Printed Name

Paula S. Ives

Position

Engineering Assistant

Date

11/19/96

<sup>18</sup> SURVEYOR CERTIFICATION

I hereby certify that the well location shown on this plat was plotted from field notes of actual surveys made by me or under my supervision, and that the same is true and correct to the best of my knowledge and belief.

Date Surveyed

Signature & Seal of  
Professional Surveyor

Certificate No.