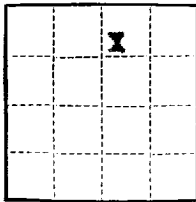

OCT 8 1962

COPY TO BUREAU Budget Bureau No. 42-R358.4.  
Form Approved.E. W. STANDLEY  
DISTRICT ENGINEER

(SUBMIT IN TRIPLICATE)

UNITED STATES  
DEPARTMENT OF THE INTERIOR  
GEOLOGICAL SURVEYLand Office **New Mexico**Lease No. **NM 033503**Unit **B**

1962 OCT 9 AM 7 30

## SUNDRY NOTICES AND REPORTS ON WELLS

NOTICE OF INTENTION TO DRILL		SUBSEQUENT REPORT OF WATER SHUT-OFF	
NOTICE OF INTENTION TO CHANGE PLANS	<input checked="" type="checkbox"/>	SUBSEQUENT REPORT OF SHOOTING OR ACIDIZING	
NOTICE OF INTENTION TO TEST WATER SHUT-OFF		SUBSEQUENT REPORT OF ALTERING CASING	
NOTICE OF INTENTION TO RE-DRILL OR REPAIR WELL		SUBSEQUENT REPORT OF RE-DRILLING OR REPAIR	
NOTICE OF INTENTION TO SHOOT OR ACIDIZE		SUBSEQUENT REPORT OF ABANDONMENT	
NOTICE OF INTENTION TO PULL OR ALTER CASING		SUPPLEMENTARY WELL HISTORY	
NOTICE OF INTENTION TO ABANDON WELL			

(INDICATE ABOVE BY CHECK MARK NATURE OF REPORT, NOTICE, OR OTHER DATA)

October 5, 1962

USA-Jennings NM 033503

Well No. 3 is located 660 ft. from N line and 1980 ft. from E line of sec. 14NW/4 NE/4 Sec. 14  
(1/4 Sec. and Sec. No.)24-S  
(Twp.)32-E  
(Range)RSPN  
(Meridian)Undesignated  
(Field)Lea  
(County or Subdivision)New Mexico  
(State or Territory)The elevation of ~~the surface~~ <sup>ground level</sup> above sea level is 3600 ft. Est.

## DETAILS OF WORK

(State names of and expected depths to objective sands; show sizes, weights, and lengths of proposed casings; indicate mudding jobs, cementing points, and all other important proposed work)

We propose to change the location of well #3 to the location shown above, and on attached plats, from that previously submitted of 990' PSL and 1650' PWL of Sec. 14.

I understand that this plan of work must receive approval in writing by the Geological Survey before operations may be commenced.

Company ~~TENNECO CORPORATION BY ITS MANAGING AGENT TENNECO OIL COMPANY~~Address P. O. Box 307Hobbs, New MexicoBy A.W. LangTitle District Production Superintendent

**NEW MEXICO OIL CONSERVATION COMMISSION**  
**WELL LOCATION AND ACREAGE DEDICATION PLAT**

FORM C-128  
 Revised 5/1/57

**SEE INSTRUCTIONS FOR COMPLETING THIS FORM ON THE REVERSE SIDE**

**SECTION A**

Operator <b>TENNECO OIL COMPANY</b>		Lease <b>USA JENNINGS NM033503</b>		Well No. <b>373</b>
Unit Letter <b>B</b>	Section <b>14</b>	Township <b>24 SOUTH</b>	Range <b>32 EAST</b>	County <b>LEA</b>
Actual Footage Location of Well: <b>660</b> feet from the <b>NORTH</b> line and <b>1980'</b> feet from the <b>EAST</b> line				
Ground Level Elev. <b>3600 Est.</b>	Producing Formation <b>Delaware Sand</b>	Pool <b>Undesignated</b>	Dedicated Acreage: <b>40</b> Acres	

1. Is the Operator the only owner in the dedicated acreage outlined on the plat below? YES ☒ NO ☐ . ("Owner" means the person who has the right to drill into and to produce from any pool and to appropriate the production either for himself or for himself and another. (65-3-29 (e) NMSA 1935 Comp.)
2. If the answer to question one is "no," have the interests of all the owners been consolidated by communitization agreement or otherwise? YES ☐ NO ☐ . If answer is "yes," Type of Consolidation \_\_\_\_\_
3. If the answer to question two is "no," list all the owners and their respective interests below:

Owner	Land Description

**SECTION B**

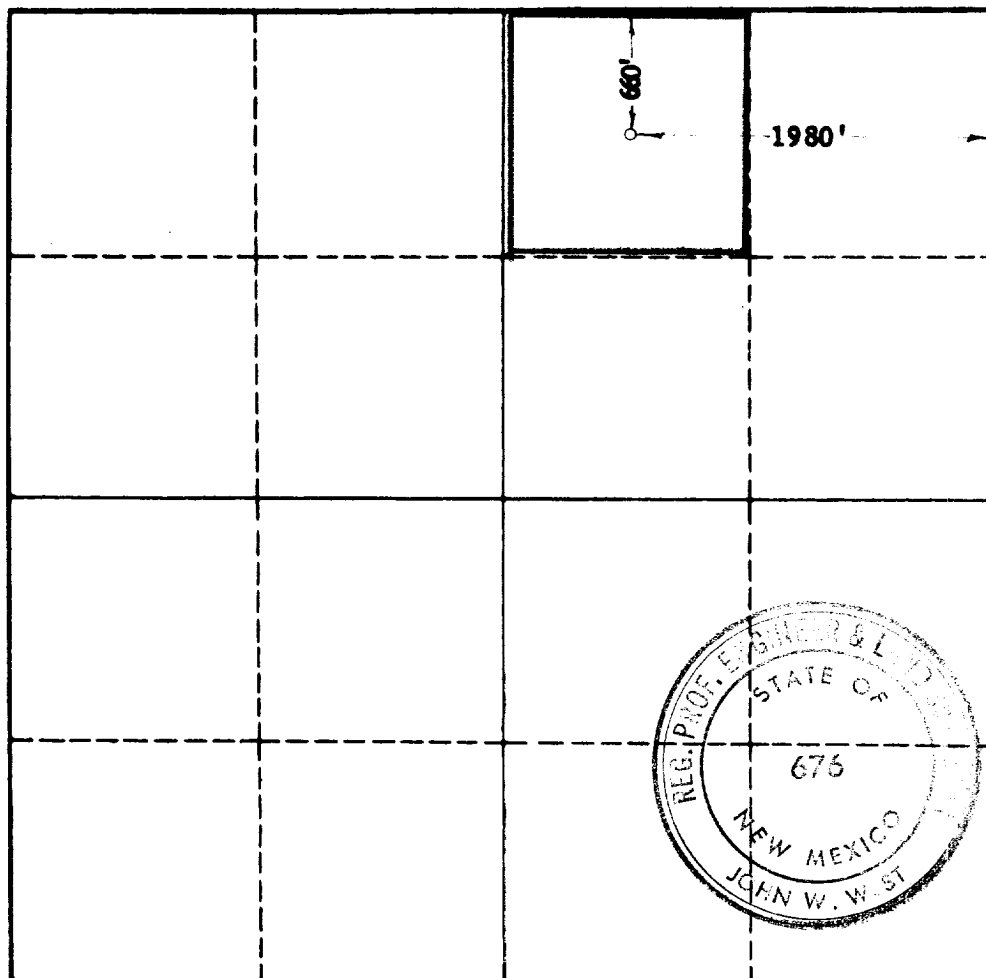

**CERTIFICATION**

I hereby certify that the information in SECTION A above is true and complete to the best of my knowledge and belief.

Name <i>A. V. Lang</i>
Position <b>District Production Supt.</b>
Company <b>Tenneco Oil Company</b>
Date <b>October 5, 1962</b>

I hereby certify that the well location shown on the plat in SECTION B was plotted from field notes of actual surveys made by me or under my supervision, and that the same is true and correct to the best of my knowledge and belief.

Date Surveyed <b>10-1-62</b>
Registered Professional Engineer and/or Land Surveyor, <b>JOHN W. WEST</b>
<i>John W. West</i>
Certificate No. <b>N. M. - P. E. &amp; L. S. NO. 676</b>

