

APPROVED

WAY TO C. C. C.

Budget Bureau No. 42-R358.4.  
Approval expires 12-31-60.Form 9-231a  
(Feb. 1961)

APR 24 1961

HOBBES

(SUBMIT IN TRIPLICATE)

Land Office

Lease No. 12 0197A

Unit

1			

E. W. STANDLEY  
DISTRICT ENGINEERUNITED STATES  
DEPARTMENT OF THE INTERIOR  
GEOLOGICAL SURVEY

## SUNDRY NOTICES AND REPORTS ON WELLS

NOTICE OF INTENTION TO DRILL		SUBSEQUENT REPORT OF WATER SHUT-OFF	
NOTICE OF INTENTION TO CHANGE PLANS		SUBSEQUENT REPORT OF SHOOTING OR ACIDIZING	
NOTICE OF INTENTION TO TEST WATER SHUT-OFF		SUBSEQUENT REPORT OF ALTERING CASING	
NOTICE OF INTENTION TO RE-DRILL OR REPAIR WELL		SUBSEQUENT REPORT OF RE-DRILLING OR REPAIR	
NOTICE OF INTENTION TO SHOOT OR ACIDIZE		SUBSEQUENT REPORT OF ABANDONMENT	
NOTICE OF INTENTION TO PULL OR ALTER CASING		SUPPLEMENTARY WELL HISTORY	
NOTICE OF INTENTION TO ABANDON WELL			

(INDICATE ABOVE BY CHECK MARK NATURE OF REPORT, NOTICE, OR OTHER DATA)

April 19, 1961

Gulf States Federal

Well No. 1 is located 640 ft. from  $\left\{ \begin{matrix} N \\ S \end{matrix} \right\}$  line and 2300 ft. from  $\left\{ \begin{matrix} E \\ W \end{matrix} \right\}$  line of sec. 3

1/4 Sec. and Sec. No.

Twp.

Range

Meridian

Wildcat

(Field)

Law

(County or Subdivision)

New Mexico

(State or Territory)

The elevation of the derrick floor above sea level is 3304 ft. Ground Level

## DETAILS OF WORK

(State names of and expected depths to objective sands; show sizes, weights, and lengths of proposed casings; indicate mudding jobs, cementing points, and all other important proposed work)

It is proposed to drill with rotary tools to the Delaware Sand at approximately 9600'.

Size	Weight	Length	Notes	Depth	Remarks
11"	9-5/8"	24'	New	400'	Circulate
7-7/8"	4-1/2"	9.25'	New	9600'	250

I understand that this plan of work must receive approval in writing by the Geological Survey before operations may be commenced.

Company Gulf Oil Corporation

Address P. O. Box 746

Kearney, Texas

ORIGINAL SIGNED  
BYBy W. W. WHITAKER  
W. W. Whitaker

Title Area Petroleum Engineer

APPROVED

APPROVED

APPROVED

NEW MEXICO OIL CONSERVATION COMMISSION  
WELL LOCATION AND ACREAGE DEDICATION PLAT

FORM C-128  
Revised 9/1/57

SEE INSTRUCTIONS FOR COMPLETING THIS FORM ON THE REVERSE SIDE

SECTION A

Operator GULF OIL CORP.		Lease Gulf States Federal		Well No. 7
Unit Letter C	Section 3	Township 26 SOUTH	Range 34 EAST	LEA
Actual Footage Location of Well: 660 feet from the NORTH line and 1980 feet from the WEST line				
Ground Level Elev. 3304.0	Producing Formation Delaware Sand	Pool #11000	Dedicated Acreage: 60 Acres	

1. Is the Operator the only owner in the dedicated acreage outlined on the plat below? YES ☒ NO ☐ ("Owner" means the person who has the right to drill into and to produce from any pool and to appropriate the production either for himself or for himself and another. (63-3-29 (e) NMSA 1955 Comp.)
2. If the answer to question one is "no," have the interests of all the owners been consolidated by communication agreement or otherwise? YES ☐ NO ☐ If answer is "yes," Type of Consolidation ☐
3. If the answer to question two is "no," list all the owners and their respective interests below:

Owner	Land Description
	APR 20 1961 U. S. GEOLOGICAL SURVEY HOBBS, NEW MEXICO

SECTION B

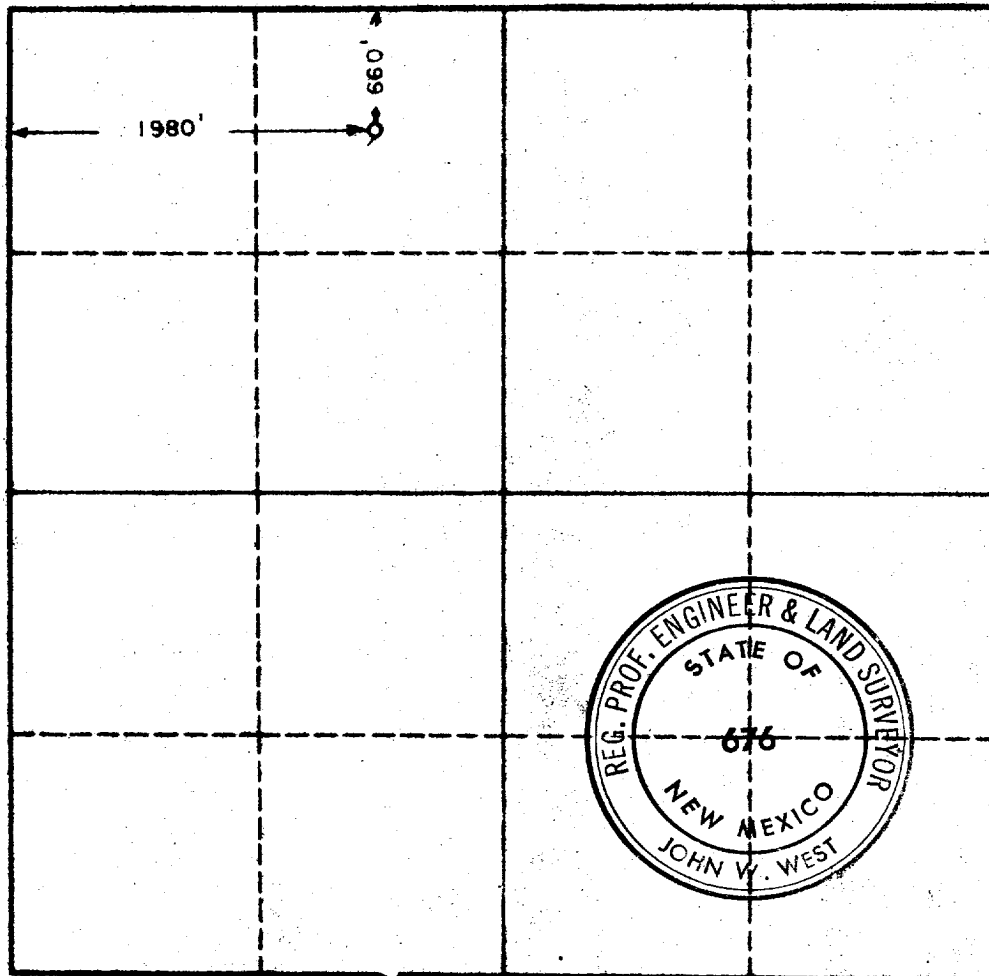

CERTIFICATION

I hereby certify that the information in SECTION A above is true and complete to the best of my knowledge and belief.

Name "Original Signed by"  
J. L. Pike

Position  
Area Prod. Manager  
Company  
Gulf Oil Corporation  
Date  
April 20, 1961

I hereby certify that the well location shown on the plat in SECTION B was plotted from field notes of actual surveys made by me or under my supervision, and that the same is true and correct to the best of my knowledge and belief.

Date Surveyed  
APRIL 11, 1961  
Registered Professional Engineer and/or Land Surveyor, JOHN W. WEST  
*John W. West*  
Certificate No.  
N. M. - P. E. & L. S. NO. 676

0 330 660 990 1320 1650 1980 2310 2640 2970 3300 3630 3960 4290 4620 4950 5280 5610 5940 6270 6600

