

UNITED STATES  
DEPARTMENT OF THE INTERIOR  
GEOLOGICAL SURVEY

30-085-27030

5. LEASE DESIGNATION AND SERIAL NO.

NM 13430

6. IF INDIAN, ALLOTTEE OR TRIBE NAME

7. UNIT AGREEMENT NAME

8. FARM OR LEASE NAME

Lea 21, 7406 JV-S

9. WELL NO.

4

10. FIELD AND POOL OR WHOLE CAT  
Comanche-State line

Tansil Yates

11. SEC., T., R., M., OR BLK.  
AND SURVEY OR AREASec. 21, Twp 26-S,  
Rge. 36-E

12. COUNTY OR PARISH 13. STATE

Lea New Mexico

## APPLICATION FOR PERMIT TO DRILL, DEEPEN, OR PLUG BACK

1a. TYPE OF WORK

DRILL ☒DEEPEN ☐PLUG BACK ☐

b. TYPE OF WELL

OIL  
WELL ☒GAS  
WELL ☐

OTHER

SINGLE  
ZONE ☒MULTIPLE  
ZONE ☐

2. NAME OF OPERATOR

BTA OIL PRODUCERS

3. ADDRESS OF OPERATOR

104 South Pecos Midland, Texas 79701

4. LOCATION OF WELL (Report location clearly and in accordance with any State requirements.\*)

At surface

660' FSL &amp; 1980' FEL

At proposed prod. zone

same

14. DISTANCE IN MILES AND DIRECTION FROM NEAREST TOWN OR POST OFFICE\*

5 miles Southwest From Jal, New Mexico

15. DISTANCE FROM PROPOSED\*

LOCATION TO NEAREST  
PROPERTY OR LEASE LINE, FT.  
(Also to nearest drlg. unit line, if any)

660'

16. NO. OF ACRES IN LEASE

320

17. NO. OF ACRES ASSIGNED  
TO THIS WELL

40

18. DISTANCE FROM PROPOSED LOCATION\*

TO NEAREST WELL, DRILLING, COMPLETED,  
OR APPLIED FOR, ON THIS LEASE, FT.

1320'

19. PROPOSED DEPTH

3660'

20. ROTARY OR CABLE TOOLS

Rotary

21. ELEVATIONS (Show whether DF, RT, GR, etc.)

2913' GR

22. APPROX. DATE WORK WILL START\*

August 25, 1980

23.

## PROPOSED CASING AND CEMENTING PROGRAM

SIZE OF HOLE	SIZE OF CASING	WEIGHT PER FOOT	SETTING DEPTH	QUANTITY OF CEMENT
12-1/4"	8-5/8"	24#	1400'	1000 sx CIRCULATE
7-7/8"	5-1/2"	15.5#	3660'	250 sx

See Attached BOP Diagram

RECEIVED

JUL 18 1980

U. S. GEOLOGICAL SURVEY  
HOBBS, NEW MEXICO

IN ABOVE SPACE DESCRIBE PROPOSED PROGRAM: If proposal is to deepen or plug back, give data on present productive zone and proposed new productive zone. If proposal is to drill or deepen directionally, give pertinent data on subsurface locations and measured and true vertical depths. Give blowout preventer program, if any.

24.

SIGNED

BOB K. NEWLAND

TITLE Regulatory Supervisor

DATE 7/11/80

(This space for Federal or State office use)

PERMIT NO.

APPROVAL DATE

APPROVED  
AS AMENDED

APPROVED BY

TITLE

DATE

CONDITIONS OF APPROVAL, IF ANY:

AUG 25 1980

DISTRICT SUPERVISOR

# WELL LOCATION AND ACREAGE DEDICATION PLAT

Form  
Supersedes C-128  
Effective 1-4-65

All distances must be from the outer boundaries of the section.

Operator <b>BTA OIL PRODUCERS</b>		Lease <b>7 406 JV-S LEA "21"</b>		Well No. <b>4</b>
Unit Letter <b>"O"</b>	Section <b>21</b>	Township <b>-26-S</b>	Range <b>-36-E</b>	County <b>LEA</b>
Actual Footage Location of Well: <b>660</b> feet from the <b>SOUTH</b> line and <b>1980</b> feet from the <b>EAST</b> line				
Ground Level Elev. <b>2913</b>	Producing Formation <b>TANSALL - YATES</b>	Pool <b>COMANCHE - STATE LINE</b>		Dedicated Acreage: <b>40</b> Acres

1. Outline the acreage dedicated to the subject well by colored pencil or hatchure marks on the plat below.
2. If more than one lease is dedicated to the well, outline each and identify the ownership thereof (both as to working interest and royalty).
3. If more than one lease of different ownership is dedicated to the well, have the interests of all owners been consolidated by communitization, unitization, force-pooling, etc?

☐ Yes ☐ No If answer is "yes," type of consolidation \_\_\_\_\_

If answer is "no," list the owners and tract descriptions which have actually been consolidated. (Use reverse side of this form if necessary.) \_\_\_\_\_

No allowable will be assigned to the well until all interests have been consolidated (by communitization, unitization, forced-pooling, or otherwise) or until a non-standard unit, eliminating such interests, has been approved by the Commission.

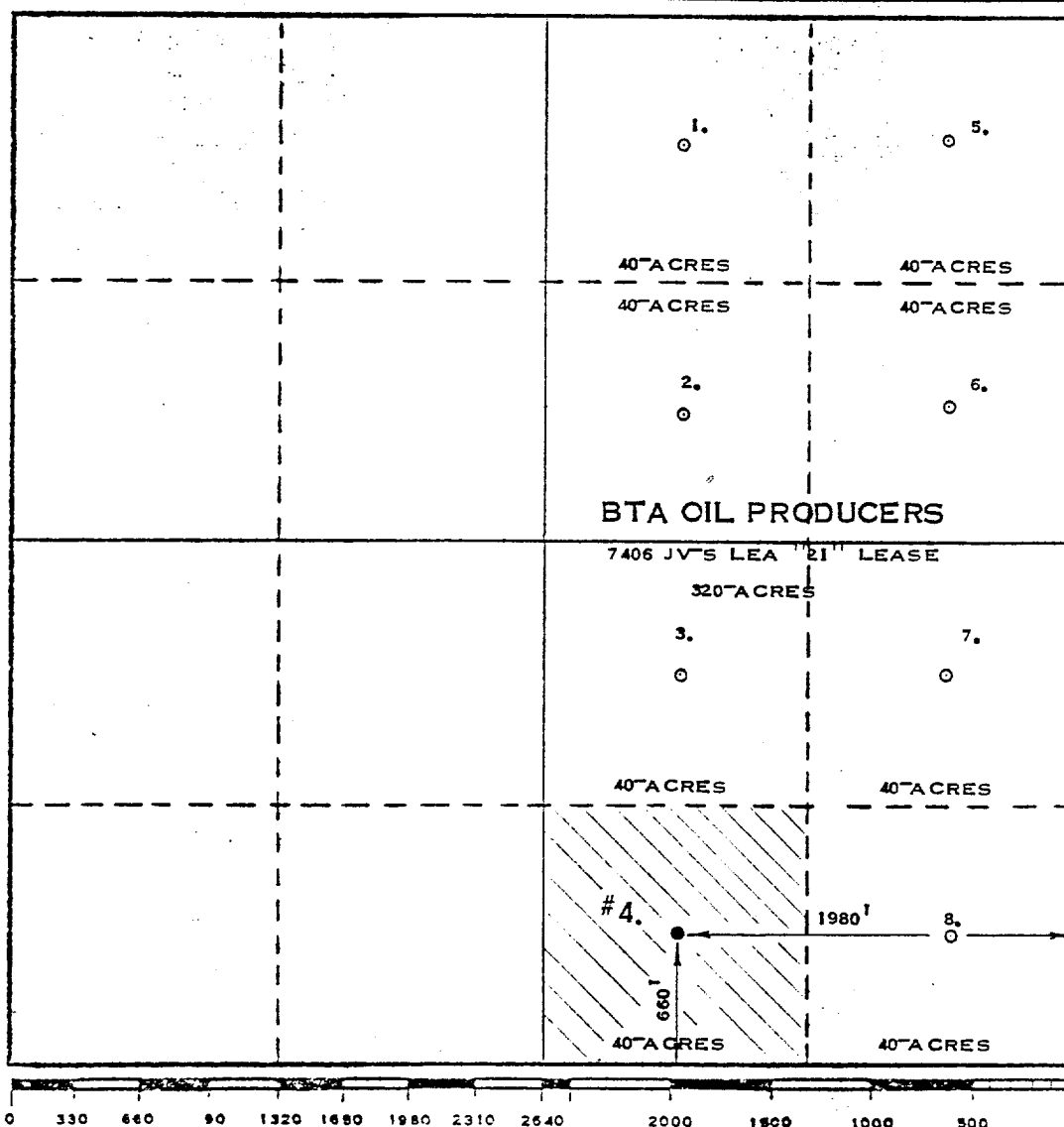

## CERTIFICATION

I hereby certify that the information contained herein is true and complete to the best of my knowledge and belief.

*Bob K. Newland*

Name  
**BOB K. NEWLAND**

Position  
**Regulatory Supervisor**

Company  
**BTA OIL PRODUCERS**

Date  
**July 11, 1980**

I hereby certify that the well location shown on this plat was plotted from field notes of actual surveys made by me or under my supervision, and that the same is true and correct to the best of my knowledge and belief.

Date Surveyed  
**APRIL 21, 1980**

Registered Professional Engineer  
and/or Land Surveyor

*Max A. Schumann Jr.*  
**MAX A. SCHUMANN JR. 1510**

Certificate No.

**1510**

ADDITIONAL INFORMATION  
7406 JV-S Lea "21" #4

1. Geologic name of the surface formation - Quaternary.
2. Estimated tops of important geologic markers - Anhydrite 2100',  
Yates 3160'.
3. Estimated depth at which oil is expected - 3160' Yates.
4. Proposed casing strings will be new pipe.
5. Additives to be used with the cement program are:
  - 8-1/2" - 700 sx - 6#/sx salt, 5#/sx gilsonite & 1/4#/sx flocele.  
300 sx - 2%/Ca Cl<sub>2</sub> & 1/4#/sx flocele.
  - 5-1/2" - 250 sx 50/50 Poz A w/0.3% CFR-2, 6#/sx salt, 5#/sx gilsonite  
& 1/4#/sx flocele.
6. BOP Test Procedures - Will hydrostatically test to rated working pressure when installed. Test periodically with rig pump.
7. Type and Characteristics of the circulating mediums:
  - Surface to 1400' - Fresh water spud mud with a 40 to 50 sec/1000 cc viscosity. Possible lost circulation; severe gravel and sand instability. Use multi mud paper to control seepage. If complete loss occurs, use cotton seed hulls and chip seal.
  - 1400' to TD - 9.0 to 9.6 ppg fresh water with FW gel to maintain 35 to 45 sec/1000 cc viscosity. Reduce the water loss to 10 cc or less @ 3100'. Salt gel may be required if salt stringers are encountered.
8. Logging Program - GR-CNL&FDC Surface Csg to TD.  
DLL or DIL Surface Csg to TD.
9. Anticipated abnormal pressures or temperatures - None, H<sub>2</sub>S - None.
10. Duration of drilling operation - 10 days.