



© Copyrighted Reproduction Prohibited

COUNTY LEA FIELD Jalmat STATE NM
 OPR CONOCO, INC. API 30-025-27155
 NO 8 LEASE Vaughn "A-14" MAP
 Sec 14, T24S, R36E CO-ORD
 2310 FNL, 660 FWL of Sec 9-2-24 NM
 8 mi NW/Jal SPD 6-24-81 CMP 8-19-81

CSC	WELL CLASS: INIT D FIN LSE. CODE			
	FORMATION	DATUM	FORMATION	DATUM
8 5/8-1146-620 sx				
5 1/2-3462-910 sx				
	TD 3462 (YTES)		PBD 3270	

IP (Yates) Perfs 3161-3253 F 7 BOPD. Pot based on 24 hr test thru 38/64 chk. GOR 51,429; gty (NR); CP 105; TP 46

CONTR Baker #54 OPRSELEV 3359 GL sub-s 10

F.R. 11-24-80
 PD 3460 RT (Yates)
 6-26-81 Drlg 850 redbed
 7-2-81 Drlg 2043 salt & anhy
 7-13-81 TD 3462; WOCU
 8-7-81 TD 3462; PBD 3270; SI
 Perf (Yates) @ 3161, 3162, 3174, 3177, 3192, 3207, 3211, 3214, 3216, 3243, 3249, 3253 w/1 SPI
 Acid (3161-3253) 1000 gals
 8-17-81 TD 3462; PBD 3270; Flwg
 Frac (3161-3253) 12,600 gals wtr + 5400 gals methanol + 18,000 gals CO₂ + 75,000# sd
 Flwd 7 BO + 449 MCFGPD in 24 hrs (3161-3253)
 8-20-81 TD 3462; PBD 3270; WOSP
 9-7-81 TD 3462; PBD 3270; Complete
 Rig Released 7-7-81
 9-12-81 COMPLETION ISSUED

9-2-24 NM
 IC 30-025-70568-80

Submit to Appropriate District Office
 State Lease - 4 copies
 Fee Lease - 3 copies

State of New Mexico
 Energy, Minerals and Natural Resources Department

Form C-102
 Revised 1-1-82

OIL CONSERVATION DIVISION

P.O. Box 2088
 Santa Fe, New Mexico 87504-2088

DISTRICT I
 P.O. Box 1980, Hobbs, NM 88240

DISTRICT II
 P.O. Drawer DD, Artesia, NM 88210

DISTRICT III
 1000 Rio Brazos Rd., Aztec, NM 87410

WELL LOCATION AND ACREAGE DEDICATION PLAT
 All Distances must be from the outer boundaries of the section

Operator Sidney Lanier		Lease Vaughn A-14		Well No. 8
Unit Letter E	Section 14	Township 24 S	Range 36 E	County Lea
Actual Footage Location of Well: 2310 feet from the North line and 660 feet from the West line				
Ground level Elev. 3355.3	Producing Formation Yates Seven Rivers	Pool Jalmat	Dedicated Acreage: 40 Acres	

- Outline the acreage dedicated to the subject well by colored pencil or hachure marks on the plat below.
- If more than one lease is dedicated to the well, outline each and identify the ownership thereof (both as to working interest and royalty).
- If more than one lease of different ownership is dedicated to the well, have the interest of all owners been consolidated by communitization, unitization, force-pooling, etc.?

Yes No If answer is "yes" type of consolidation _____

If answer is "no" list the owners and tract descriptions which have actually been consolidated. (Use reverse side of this form if necessary.) _____

No allowable will be assigned to the well until all interests have been consolidated (by communitization, unitization, forced-pooling, or otherwise) or until a non-standard unit, eliminating such interest, has been approved by the Division.

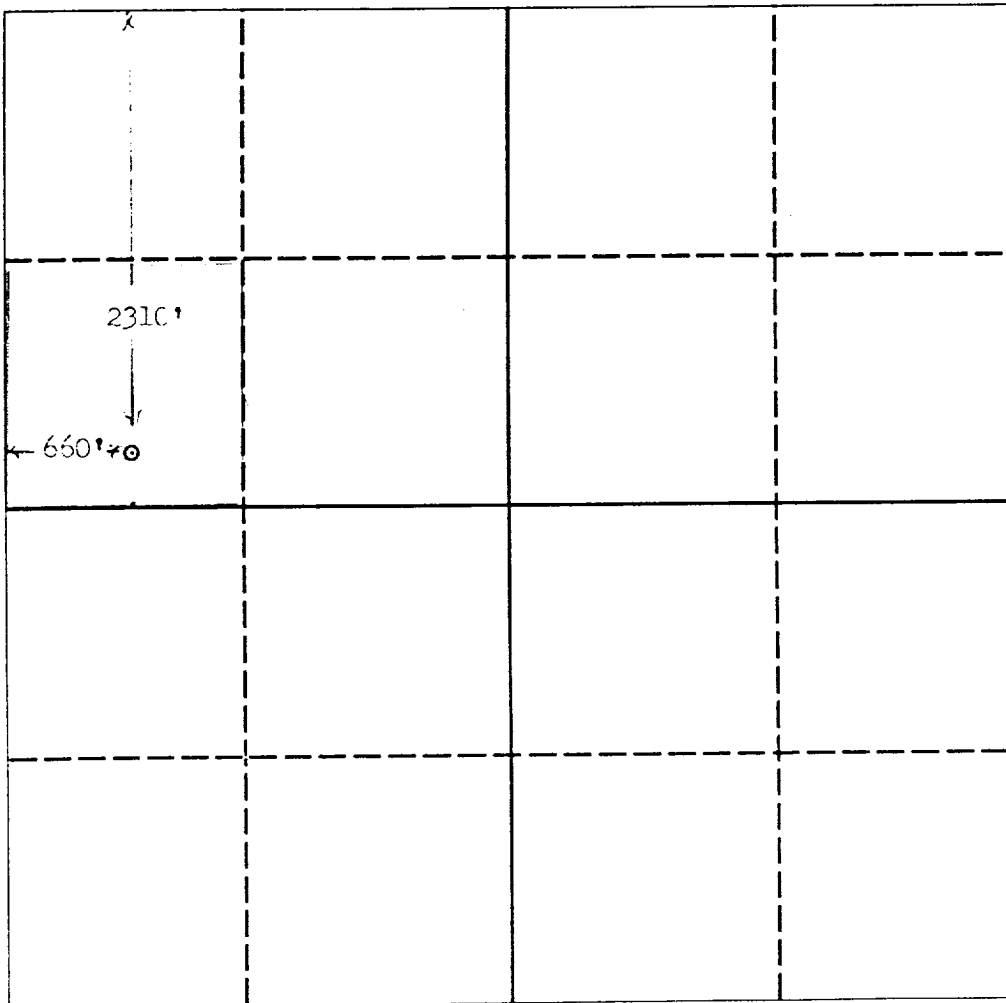

OPERATOR CERTIFICATION

I hereby certify that the information contained herein is true and complete to the best of my knowledge and belief.

Signature
Donna Holler

Printed Name
 Donna Holler

Position
 Agent

Company
 Sidney Lanier

Date
 8/19/93

SURVEYOR CERTIFICATION

I hereby certify that the well location shown on this plat was plotted from field notes of actual surveys made by me or under my supervision, and that the same is true and correct to the best of my knowledge and belief.

Date Surveyed

Signature & Seal of Professional Surveyor

Certificate No.

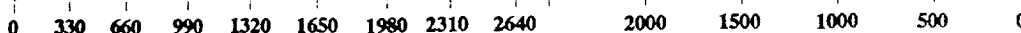

Submit to Appropriate
District Office
State Lease - 4 copies
Fee Lease - 3 copies

State of New Mexico
Energy, Minerals and Natural Resources Department

Form C-102
Revised 1-1-89

OIL CONSERVATION DIVISION

DISTRICT I
P.O. Box 1980, Hobbs, NM 88240

P.O. Box 2088
Santa Fe, New Mexico 87504-2088

DISTRICT II
P.O. Drawer DD, Artesia, NM 88210

DISTRICT III
1000 Rio Brazos Rd., Aztec, NM 87410

WELL LOCATION AND ACREAGE DEDICATION PLAT

All Distances must be from the outer boundaries of the section

Operator Conoco, Inc.		Lease Vaughn A-14		Well No. 8
Unit Letter E	Section 14	Township 24S	Range 36-E NMPM	County Lea
Actual Footage Location of Well: 2310 feet from the North line and 660 feet from the West line				
Ground level Elev. 3355.3	Producing Formation Yates	Pool Jalmat T-y-SR	Dedicated Acreage: 240 Acres	

- Outline the acreage dedicated to the subject well by colored pencil or hachure marks on the plat below.
- If more than one lease is dedicated to the well, outline each and identify the ownership thereof (both as to working interest and royalty).
- If more than one lease of different ownership is dedicated to the well, have the interest of all owners been consolidated by communitization, unitization, force-pooling, etc.?
 Yes No If answer is "yes" type of consolidation _____

If answer is "no" list the owners and tract descriptions which have actually been consolidated. (Use reverse side of this form if necessary.) _____

No allowable will be assigned to the well until all interests have been consolidated (by communitization, unitization, forced-pooling, or otherwise) or until a non-standard unit, eliminating such interest, has been approved by the Division.

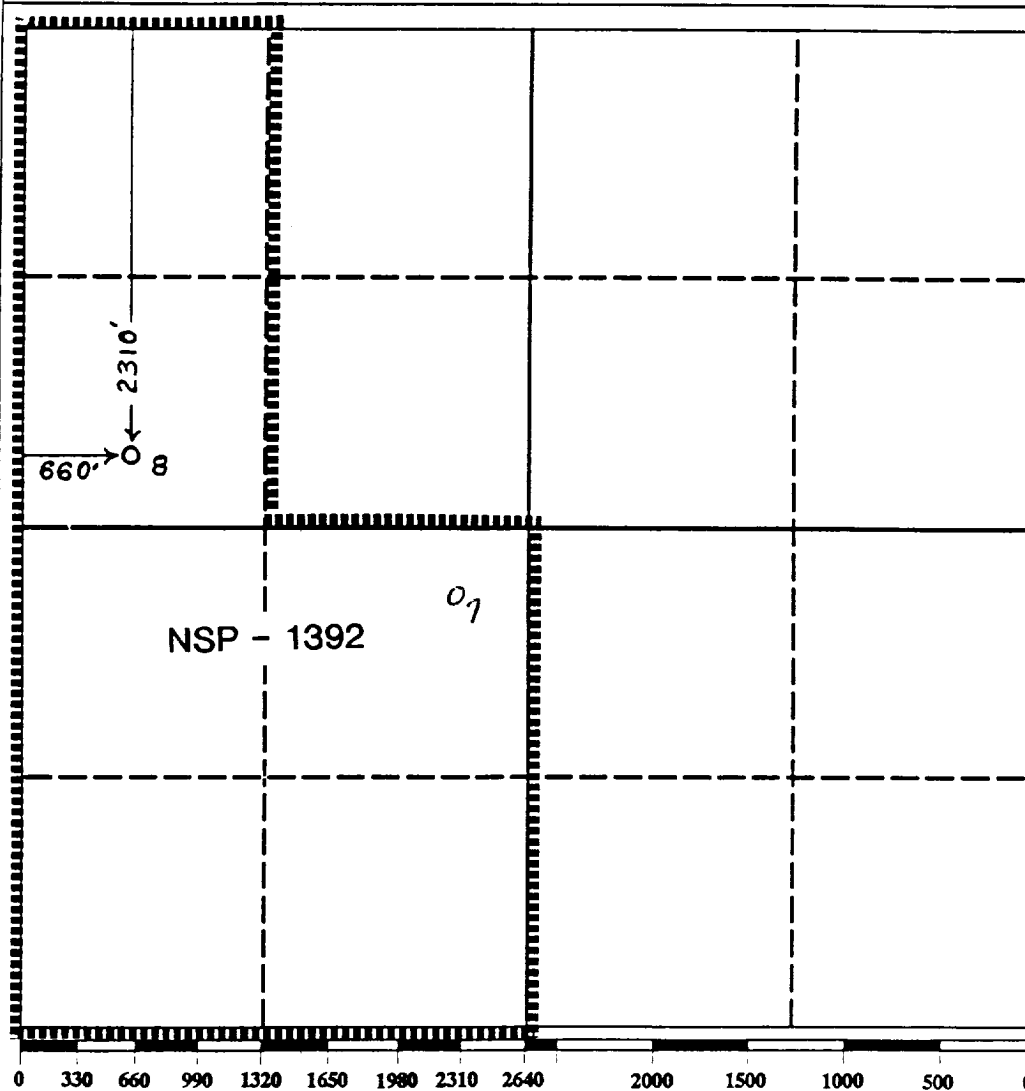

OPERATOR CERTIFICATION
I hereby certify that the information contained herein is true and complete to the best of my knowledge and belief.

Signature: *Jerry W. Hoover*
Printed Name: Jerry W. Hoover
Position: Sr. Conservation Coordinator
Company: Conoco, Inc.
Date: June 20, 1991

SURVEYOR CERTIFICATION
I hereby certify that the well location shown on this plat was plotted from field notes of actual surveys made by me or under my supervision, and that the same is true and correct to the best of my knowledge and belief.

Date Surveyed: _____
Signature & Seal of Professional Surveyor: _____
Certificate No.: _____

NSP 1392

Submit to Appropriate District Office
 State Lease - 4 copies
 Fee Lease - 3 copies

State of New Mexico
 Energy, Minerals and Natural Resources Department

Form C-102
 Revised 1-1-89

OIL CONSERVATION DIVISION

P.O. Box 2088
 Santa Fe, New Mexico 87504-2088

DISTRICT I
 P.O. Box 1980, Hobbs, NM 88240

DISTRICT II
 P.O. Drawer DD, Artesia, NM 88210

DISTRICT III
 1000 Rio Brazos Rd., Aztec, NM 87410

WELL LOCATION AND ACREAGE DEDICATION PLAT

All Distances must be from the outer boundaries of the section

Operator Conoco Inc.		Lease Vaughn A-14		Well No. 8
Unit Letter E	Section 14	Township 24-S	Range 36-E NMPM	County Lea
Actual Footage Location of Well: 2310 feet from the North line and 660 feet from the West line				
Ground level Elev. 3355.3	Producing Formation Yates	Pool Talmat	Dedicated Acreage: 40 Acres	

- Outline the acreage dedicated to the subject well by colored pencil or hachure marks on the plat below.
- If more than one lease is dedicated to the well, outline each and identify the ownership thereof (both as to working interest and royalty).
- If more than one lease of different ownership is dedicated to the well, have the interest of all owners been consolidated by communitization, unitization, force-pooling, etc.?
 Yes No If answer is "yes" type of consolidation _____
 If answer is "no" list the owners and tract descriptions which have actually been consolidated. (Use reverse side of this form if necessary). _____
 No allowable will be assigned to the well until all interests have been consolidated (by communitization, unitization, forced-pooling, or otherwise) or until a non-standard unit, eliminating such interest, has been approved by the Division.

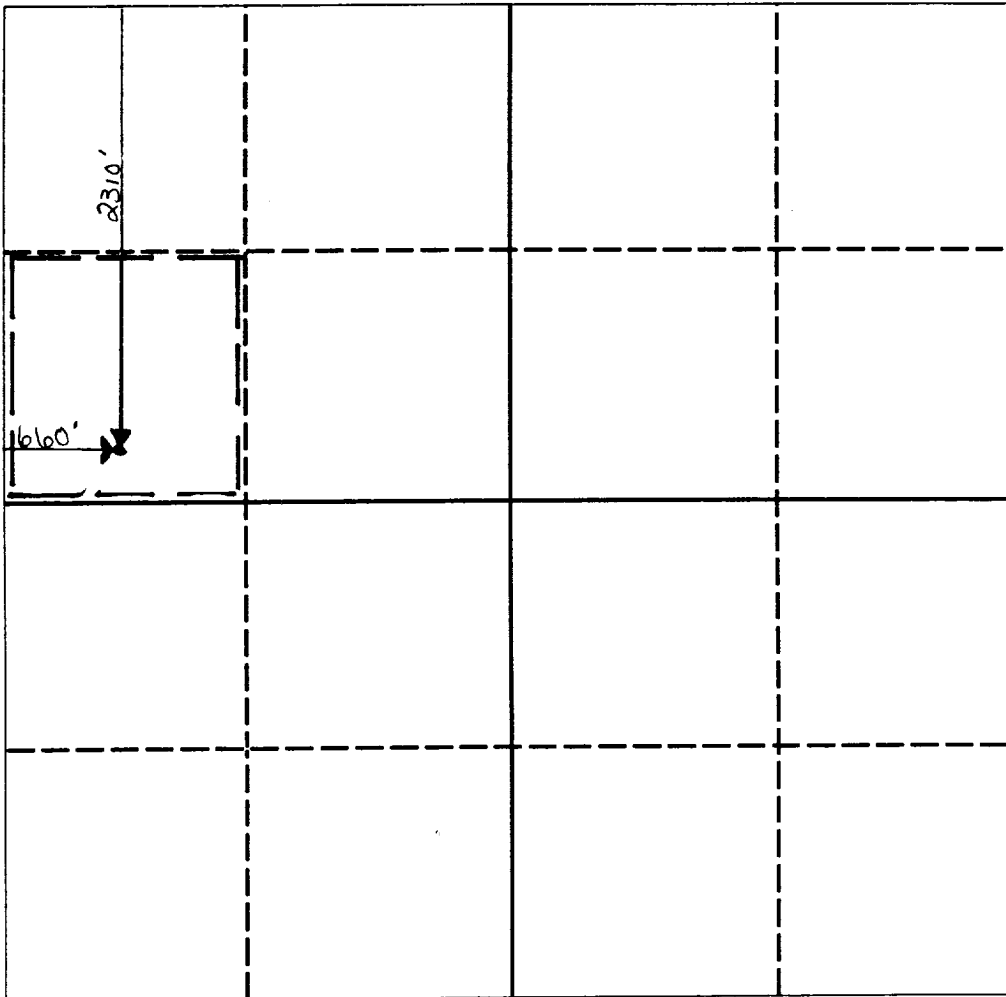

OPERATOR CERTIFICATION
 I hereby certify that the information contained herein is true and complete to the best of my knowledge and belief.

Signature
M. W. Simpson

Printed Name
W. W. Baker

Position
Adm. Supervisor

Company
Conoco Inc.

Date
5-19-89

SURVEYOR CERTIFICATION
 I hereby certify that the well location shown on this plat was plotted from field notes of actual surveys made by me or under my supervision, and that the same is true and correct to the best of my knowledge and belief.

Date Surveyed

Signature & Seal of Professional Surveyor

Certificate No.

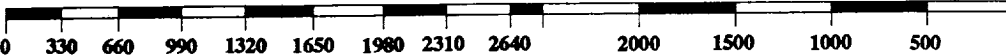

Reclassified to oil 7-1-89

NEW MEXICO OIL CONSERVATION COMMISSION
WELL LOCATION AND ACREAGE DEDICATION PLAT

Form C-102
Supersedes C-128
Effective 1-1-65

All distances must be from the outer boundaries of the Section.

Operator Conoco Inc.		Lease Vaughn A-14			Well No. 8
Section Letter E	Section 14	Township 24-S	Range 36-E	County Lea	
Actual Footage Location of Well: 2310 feet from the North line and 660 feet from the West line					
Ground Level Elev. 3355.3	Producing Formation Yates	Pool Jalmat		Dedicated Acreage: 240 Acres	

1. Outline the acreage dedicated to the subject well by colored pencil or hachure marks on the plat below.
2. If more than one lease is dedicated to the well, outline each and identify the ownership thereof (both as to working interest and royalty).
3. If more than one lease of different ownership is dedicated to the well, have the interests of all owners been consolidated by communitization, unitization, force-pooling, etc?

Yes No If answer is "yes," type of consolidation _____

If answer is "no," list the owners and tract descriptions which have actually been consolidated. (Use reverse side of this form if necessary.) _____

No allowable will be assigned to the well until all interests have been consolidated (by communitization, unitization, forced-pooling, or otherwise) or until a non-standard unit, eliminating such interests, has been approved by the Commission.

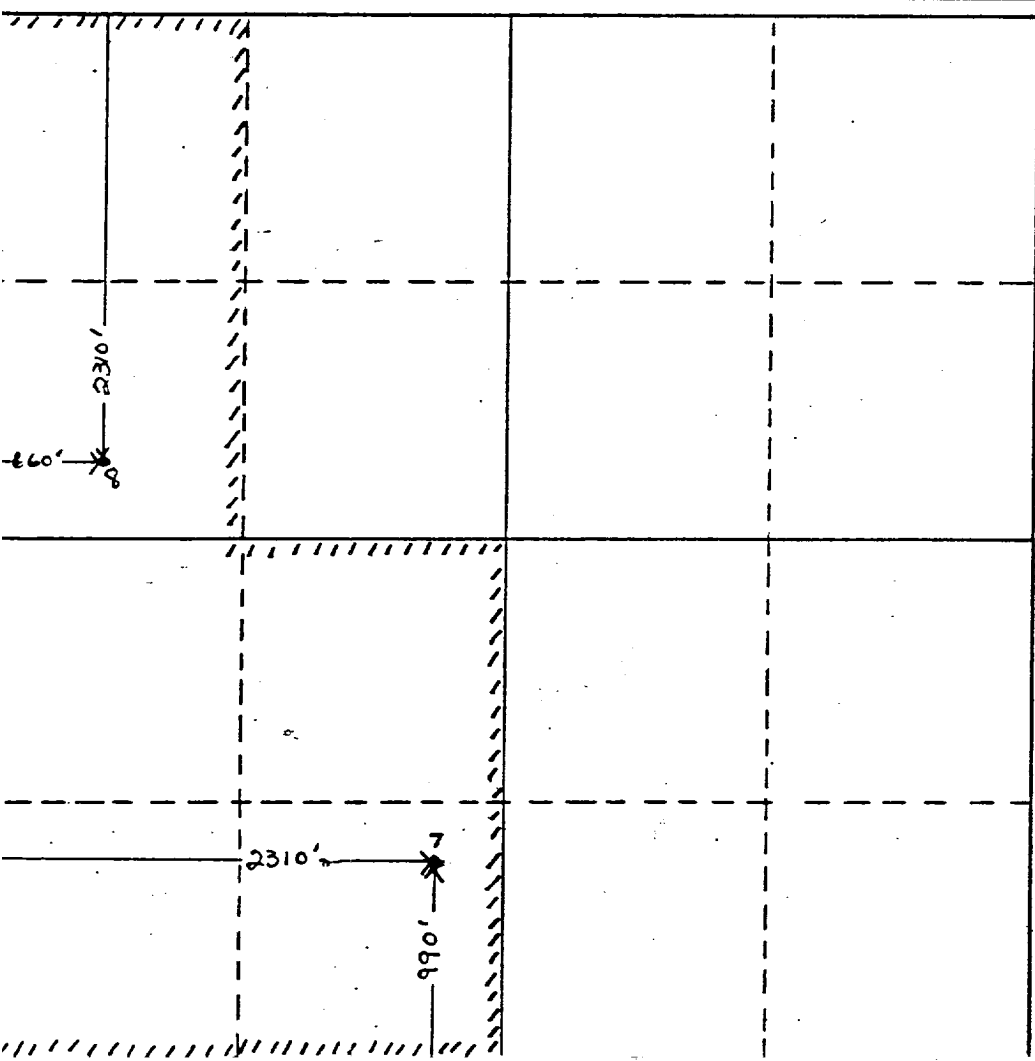

CERTIFICATION	
<i>I hereby certify that the information contained herein is true and complete to the best of my knowledge and belief.</i>	
Name	<i>David L. Lujan</i>
Position	Administrative Supervisor
Company	Conoco Inc.
Date	JUN 20 1983
<i>I hereby certify that the well location shown on this plat was plotted from field notes of actual surveys made by me or under my supervision, and that the same is true and correct to the best of my knowledge and belief.</i>	
Date Surveyed	
Registered Professional Engineer and/or Land Surveyor	