

DISTRICT I  
P.O. Box 1980, Hobbs, NM 88241-1980

State of New Mexico  
Energy, Minerals and Natural Resources Department

Form C-10J  
Revised February 10, 1999

DISTRICT II  
P.O. Box Drawer DD, Artesia, NM 88211-0719

# OIL CONSERVATION DIVISION

Instructions on back  
Submit to Appropriate District Office

DISTRICT III  
1000 Rio Brazos Rd., Aztec, NM 87410

P.O. Box 2088  
Santa Fe, New Mexico 87504-2088

State Lease - 6 Copie  
Fee Lease - 5 Copie

DISTRICT IV  
P.O. Box 2088, Santa Fe, NM 87504-2088

AMENDED REPORT

## APPLICATION FOR PERMIT TO DRILL, RE-ENTER, DEEPEN, PLUGBACK, OR ADD A ZONE

|  |  |   |
|--|--|---|
| <sup>1</sup> Operator Name and Address<br>TEXACO EXPLORATION & PRODUCTION INC.<br>205 E. Bender, HOBBS, NM 88240 |  | <sup>2</sup> OGRID Number<br>022351     |
| <sup>4</sup> Property Code<br>11060  | <sup>5</sup> Property Name<br>SIMS R. R. "A" | <sup>3</sup> API Number<br>30-025-35051 |
|  |  | <sup>6</sup> Well No.<br>9              |

| <sup>7</sup> Surface Location |         |          |       |         |               |                  |               |                |        |
|-------------------------------|---------|----------|-------|---------|---------------|------------------|---------------|----------------|--------|
| UI or lot no                  | Section | Township | Range | Lot.Idn | Feet From The | North/South Line | Feet From The | East/West Line | County |
| M                             | 4       | 23S      | 37E   |         | 330           | SOUTH            | 1010          | WEST           | LEA    |

| <sup>8</sup> Proposed Bottom Hole Location If Different From Surface |         |          |       |         |               |                  |               |                |        |
|--|---------|----------|-------|---------|---------------|------------------|---------------|----------------|--------|
| UI or lot no   | Section | Township | Range | Lot.Idn | Feet From The | North/South Line | Feet From The | East/West Line | County |
|  |         |          |       |         |               |                  |               |                |        |

|   |   |
|---|---|
| <sup>9</sup> Proposed Pool 1<br><i>North Teague</i> BLINEBRY/DRINKARD-ABO | <sup>10</sup> Proposed Pool 2<br><i>North Teague Lower Paddock Blinebry Assoc</i> |
|---|---|

|  |                                       |  |                                    |   |
|--|---------------------------------------|--|------------------------------------|---|
| <sup>11</sup> Work Type Code<br><i>A</i> | <sup>12</sup> WellType Code<br>O      | <sup>13</sup> Rotary or C.T.<br>ROTARY         | <sup>14</sup> Lease Type Code<br>S | <sup>15</sup> Ground Level Elevation<br>3323' |
| <sup>16</sup> Multiple<br>No             | <sup>17</sup> Proposed Depth<br>7420' | <sup>18</sup> Formation<br>BLINEBRY/DRNKRD/ABO | <sup>19</sup> Contractor           | <sup>20</sup> Spud Date<br>5/15/01            |

| <sup>21</sup> Proposed Casing and Cement Program |                |                 |               |                 |          |
|--|----------------|-----------------|---------------|-----------------|----------|
| SIZE OF HOLE                                     | SIZE OF CASING | WEIGHT PER FOOT | SETTING DEPTH | SACKS OF CEMENT | EST. TOP |
| 12 1/4"  | 8 5/8"         | 24#             | 1200'         | 670 SX          |          |
| 7 7/8"   | 5 1/2"         | 17#             | 7420'         | 1860 SX         |          |

<sup>22</sup> Describe the proposed program. If this application is to DEEPEN or PLUG BACK give the data on the present productive zone and proposed new productive zone. Describe the blowout prevention program, if any. Use additional sheets if necessary.

TEXACO INTENDS TO PERFORATE & FRACTURE TREAT THE BLINEBRY AND DOWNHOLE COMMINGLE WITH THE DRINKARD-ABO. PROCEDURE IS AS FOLLOWS:  
MIRU. INSTL BOP. TIH W/BIT & CSG SCRAPER & TAG BTM./ SET CIBP @ 6000'. PERF LOWER BLINEBRY FR 5760-5888. TIH W/PKR & SET @ 5710'. PUMP 2000 GALS 15% ACID. INSTL TREE SAVER ON WH. FRAC STIM PERFS 5760-5888 W/90,000# SAND. TIH W/CIBP & SET @ 5710. PERF FR 5580-5704. ACIDIZE PERFS 5580-5642' W/2000 GALS 15% HCL. FRAC STIM PERFS 5580-5704 W/90,000# SAND. TIH W/WS. TAG FOR SAND & CLEAN OUT TO PBTD OF 5660. DRILL OUT THE CIBP. TIH W/PROD EQPT & PLACE WELL ON PROD. SET SN @ 5925'. DETERMINE BLINEBRY PRODUCTION. AFTER PRODUCTION HAS STABILIZED, DRILL OUT CIBP & DHC THE BLINEBRY & DRINKARD-ABO.

|  |  |
|--|--|
| <sup>23</sup> I hereby certify that the rules and regulations of the Oil Conservation Division have been complied with and that the information given above is true and complete to the best of my knowledge and belief. | <p align="center"><b>OIL CONSERVATION DIVISION</b></p> <p>Approved By: <i>J. Denise Leake</i></p> <p>Title:</p> <p>Approval Date: <i>5/15/01</i> Expiration Date:</p> <p>Conditions of Approval:<br/>Attached <input type="checkbox"/></p> |
| Signature <i>J. Denise Leake</i>   |  |
| Printed Name J. Denise Leake   |  |
| Title Engineering Assistant  |  |
| Date 5/1/01 Telephone 397-0405   |  |

Permit Expires 1 Year From Approval Date Unless Drilling Underway Adding

DISTRICT I

P.O. Box 1980, Hobbs, NM 88241-1980

DISTRICT II

P.O. Box Drawer DD, Artesia, NM 88211-0719

DISTRICT III

1000 Rio Brazos Rd., Aztec, NM 87410

DISTRICT IV

P.O. Box 2088, Santa Fe, NM 87504-2088

State of New Mexico

Energy, Minerals and Natural Resources Department

Form C-10 **2**

Revised February 10, 1999

Instructions on back

Submit to Appropriate District Office

State Lease - 4 Copie

Fee Lease - 3 Copie

AMENDED REPORT

# OIL CONSERVATION DIVISION

P.O. Box 2088

Santa Fe, New Mexico 87504-2088

## WELL LOCATION AND ACREAGE DEDICATION PLAT

|   |  |  |
|---|--|--|
| <sup>1</sup> API Number<br>30-025-35051 | <sup>2</sup> Pool Code<br>96314                                    | <sup>3</sup> Pool Name<br>TEAGUE LOWER PADDOCK/BLINEBRY N. ASSOC |
| <sup>4</sup> Property Code<br>11060     | <sup>5</sup> Property Name<br>SIMS R. R. "A"                       | <sup>6</sup> Well No.<br>9                                       |
| <sup>7</sup> OGRID Number<br>022351     | <sup>8</sup> Operator Name<br>TEXACO EXPLORATION & PRODUCTION INC. | <sup>9</sup> Elevation<br>3323'                                  |

### <sup>10</sup> Surface Location

| Ul or lot no | Section | Township | Range | Lot.Idn | Feet From The | North/South Line | Feet From The | East/West Line | County |
|--------------|---------|----------|-------|---------|---------------|------------------|---------------|----------------|--------|
| M            | 4       | 23S      | 37E   |         | 330           | SOUTH            | 1010          | WEST           | LEA    |

### <sup>11</sup> Bottom Hole Location If Different From Surface

| Ul or lot no | Section | Township | Range | Lot.Idn | Feet From The | North/South Line | Feet From The | East/West Line | County |
|--------------|---------|----------|-------|---------|---------------|------------------|---------------|----------------|--------|
|              |         |          |       |         |               |                  |               |                |        |

|                                    |                                     |                                  |                         |
|------------------------------------|-------------------------------------|----------------------------------|-------------------------|
| <sup>12</sup> Dedicated Acre<br>40 | <sup>13</sup> Joint or Infill<br>No | <sup>14</sup> Consolidation Code | <sup>15</sup> Order No. |
|------------------------------------|-------------------------------------|----------------------------------|-------------------------|

NO ALLOWABLE WILL BE ASSIGNED TO THIS COMPLETION UNTIL ALL INTERESTS HAVE BEEN CONSOLIDATED OR A NON-STANDARD UNIT HAS BEEN APPROVED BY THE DIVISION

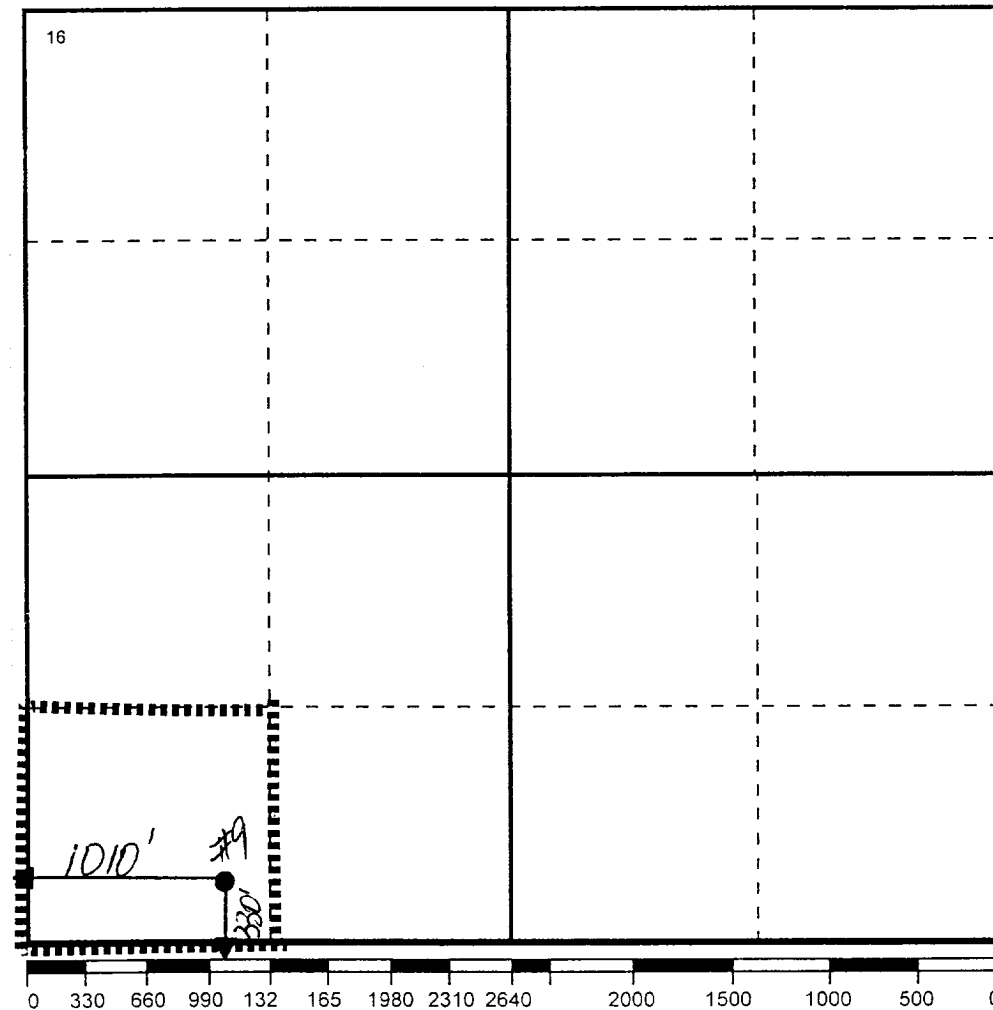

**17 OPERATOR CERTIFICATION**  
I hereby certify that the information contained herein is true and complete to the best of my knowledge and belief.

Signature: *J. Denise Leake*  
Printed Name: J. Denise Leake  
Position: Engineering Assistant  
Date: 5/1/01

**18 SURVEYOR CERTIFICATION**  
I hereby certify that the well location shown on this plat was plotted from field notes of actual surveys made by me or under my supervision, and that the same is true and correct to the best of my knowledge and belief.

Date Surveyed:  
Signature & Seal of Professional Surveyor:  
Certificate No.:

DISTRICT I

P.O. Box 1980, Hobbs, NM 88241-1980

DISTRICT II

P.O. Box Drawer DD, Artesia, NM 88211-0719

DISTRICT III

1000 Rio Brazos Rd., Aztec, NM 87410

DISTRICT IV

P.O. Box 2088, Santa Fe, NM 87504-2088

State of New Mexico  
Energy, Minerals and Natural Resources Department

# OIL CONSERVATION DIVISION

P.O. Box 2088  
Santa Fe, New Mexico 87504-2088

Form C-102

Revised February 10, 199

Instructions on back  
Submit to Appropriate District Office  
State Lease - 4 Copie  
Fee Lease - 3 Copie  
AMENDED REPORT

## WELL LOCATION AND ACREAGE DEDICATION PLAT

|   |  |   |
|---|--|---|
| <sup>1</sup> API Number<br>30-025-35051 | <sup>2</sup> Pool Code<br>96313                                    | <sup>3</sup> Pool Name<br>TEAGUE DRINKARD-ABO NORTH |
| <sup>4</sup> Property Code<br>11060     | <sup>5</sup> Property Name<br>SIMS R. R. "A"                       | <sup>6</sup> Well No.<br>9                          |
| <sup>7</sup> OGRID Number<br>022351     | <sup>8</sup> Operator Name<br>TEXACO EXPLORATION & PRODUCTION INC. | <sup>9</sup> Elevation<br>3323'                     |

### <sup>10</sup> Surface Location

| Ul or lot no | Section | Township | Range | Lot.Idn | Feet From The | North/South Line | Feet From The | East/West Line | County |
|--------------|---------|----------|-------|---------|---------------|------------------|---------------|----------------|--------|
| M            | 4       | 23S      | 37E   |         | 330           | SOUTH            | 1010          | WEST           | LEA    |

### <sup>11</sup> Bottom Hole Location If Different From Surface

| Ul or lot no | Section | Township | Range | Lot.Idn | Feet From The | North/South Line | Feet From The | East/West Line | County |
|--------------|---------|----------|-------|---------|---------------|------------------|---------------|----------------|--------|
|              |         |          |       |         |               |                  |               |                |        |

|                                    |                                     |                                  |                         |
|------------------------------------|-------------------------------------|----------------------------------|-------------------------|
| <sup>12</sup> Dedicated Acre<br>40 | <sup>13</sup> Joint or Infill<br>No | <sup>14</sup> Consolidation Code | <sup>15</sup> Order No. |
|------------------------------------|-------------------------------------|----------------------------------|-------------------------|

NO ALLOWABLE WILL BE ASSIGNED TO THIS COMPLETION UNTIL ALL INTERESTS HAVE BEEN CONSOLIDATED OR A NON-STANDARD UNIT HAS BEEN APPROVED BY THE DIVISION

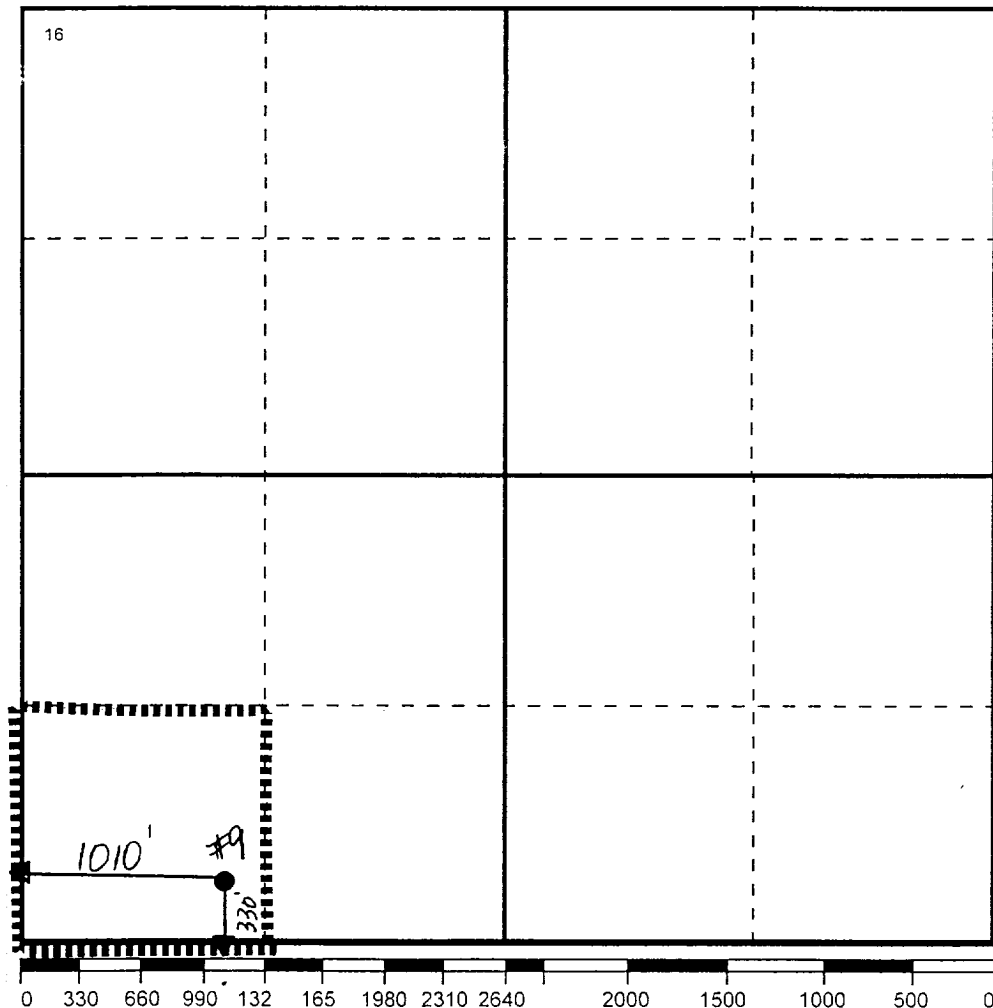

**17 OPERATOR CERTIFICATION**  
I hereby certify that the information contained herein is true and complete to the best of my knowledge and belief

Signature: *J. Denise Leake*  
Printed Name: J. Denise Leake  
Position: Engineering Assistant  
Date: 5/1/01

**18 SURVEYOR CERTIFICATION**  
I hereby certify that the well location shown on this plat was plotted from field notes of actual surveys made by me or under my supervision, and that the same is true and correct to the best of my knowledge and belief.

Date Surveyed:  
Signature & Seal of Professional Surveyor:  
Certificate No.: