

## NOTICE OF INTENTION TO DRILL

Notice must be given to the Oil Conservation Commission or its proper agent and approval obtained before drilling begins. If changes in the proposed plan are considered advisable, a copy of this notice showing such changes will be returned to the sender. Submit this notice in triplicate. One copy will be returned following approval. See additional instructions in Rules and Regulations of the Commission.

Jal, New Mexico

November 15, 1950

Place

Date

OIL CONSERVATION COMMISSION,  
Santa Fe, New Mexico,

Gentlemen:

You are hereby notified that it is our intention to commence the drilling of a well to be known as \_\_\_\_\_

R. OlsenJenkinsWell No. 1in C W/2 SW SW

Operator

Lease

of Sec. 29, T 25 S, R 37 E, N. M., P. M., Cooper-Jal Field, Lea County.

N

The well is 660 feet (N.) (S.) of the South line and 330 feet (E.) (W.) of the West line of Sec. 29-25S-37E

(Give location from section or other legal subdivision lines. Cross out wrong directions.)

If state land the oil and gas lease is No. \_\_\_\_\_ Assignment No. \_\_\_\_\_

If patented land the owner is Carrie L. Jenkins

Address Amarillo, Texas

If government land the permittee is \_\_\_\_\_

Address \_\_\_\_\_

The lessee is R. Olsen

Address Drawer "Z" Jal, New Mexico

AREA 640 ACRES

LOCATE WELL CORRECTLY

We propose to drill well with drilling equipment as follows: 0 - 300'

Cable Rig - Rotary Tools 300' - to T.D.

The status of a bond for this well in conformance with Rule 39 of the General Rules and Regulations of the Commission is as follows: Blanket Bond

We propose to use the following strings of casing and to land or cement them as indicated:

Size of Hole	Size of Casing	Weight Per Foot	New or Second Hand	Depth	Landed or Cemented	Sacks Cement
<u>12"</u>	<u>8-5/8"</u>	<u>24#</u>	<u>New</u>	<u>300</u>	<u>Cemented</u>	<u>150</u>
<u>7-7/8"</u>	<u>5-1/2"</u>	<u>15#</u>	<u>New</u>	<u>3200'</u>	<u>Cemented</u> <u>2-Stage</u>	<u>400 - 200 at shoe</u> <u>200 thru 2-stage</u> <u>tool set at approx.</u> <u>1200'</u>

If changes in the above plan become advisable we will notify you before cementing or landing casing. We estimate that the first productive oil or gas sand should occur at a depth of about 2500 feet.

Additional information:

NOV 24 1950

Approved \_\_\_\_\_, 19\_\_\_\_

except as follows:

Sincerely yours,

R. OLSEN

Operator

By Henry WatsonPosition Geological Engineer

Send communications regarding well to

Name R. OlsenAddress Drawer "Z" Jal, New Mexico

OIL CONSERVATION COMMISSION,

By Ray YunkerlyTitle Oil & Gas Inspector

WELL LOCATION SURVEY PLAT.

COMPANY R. OLSEN  
LEASE JENKINS  
WELL NO. 1

RECEIVED

NOV 20 1950

RECEIVED  
NOV 20 1950

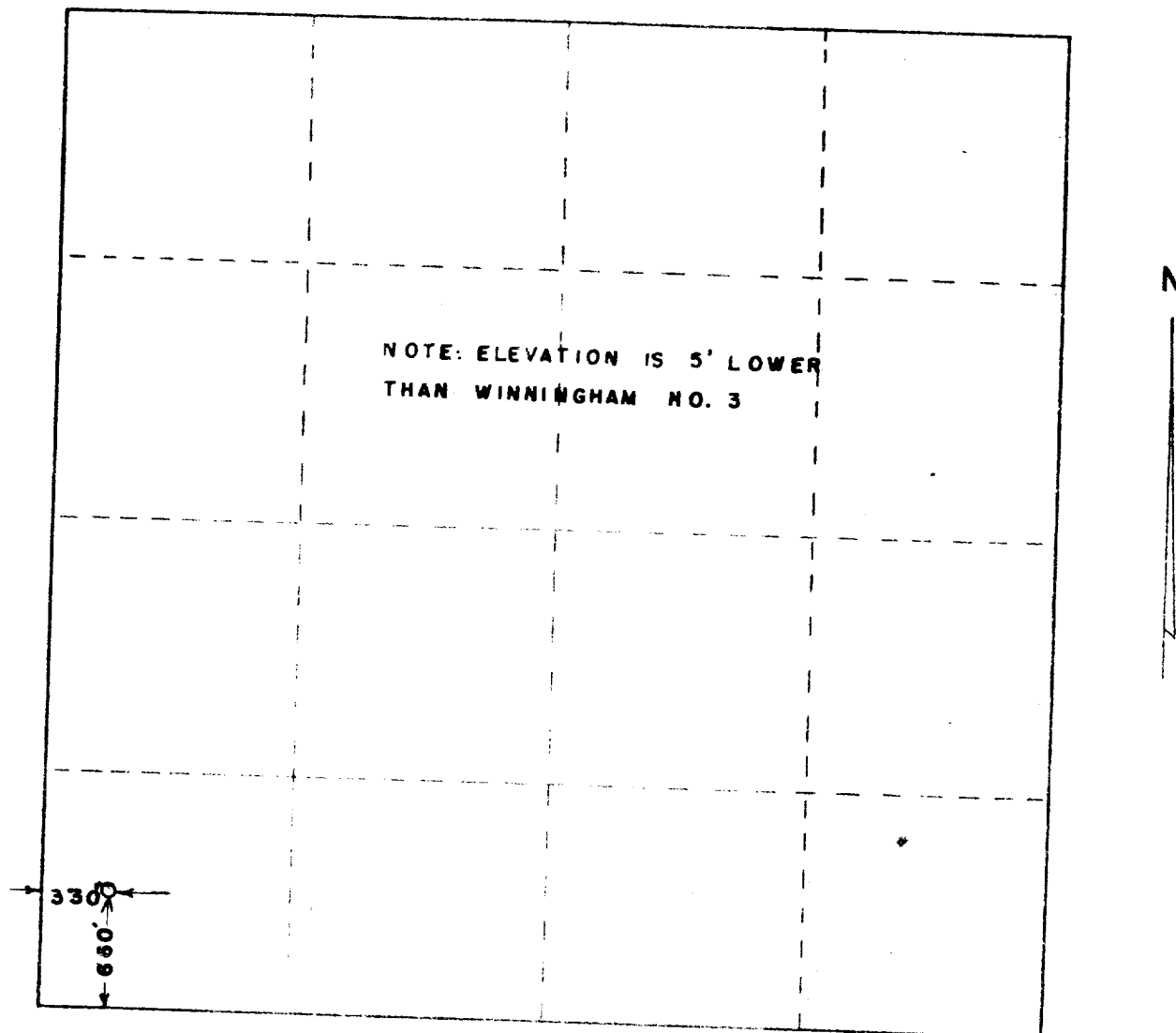

SEC. 29 TWP. 25 S. RGE. 37 E. N.M.P.M.

I CERTIFY THAT THIS SURVEY WAS MADE UNDER  
MY DIRECTION, AND THAT THE PLAT IS CORRECT  
TO THE BEST OF MY KNOWLEDGE.

*John W. West*  
NEW MEXICO LICENSE NO. 676

WELL LOCATION SURVEY PLAT.

COMPANY R. OLSEN

LEASE JENKINS

WELL NO. 1

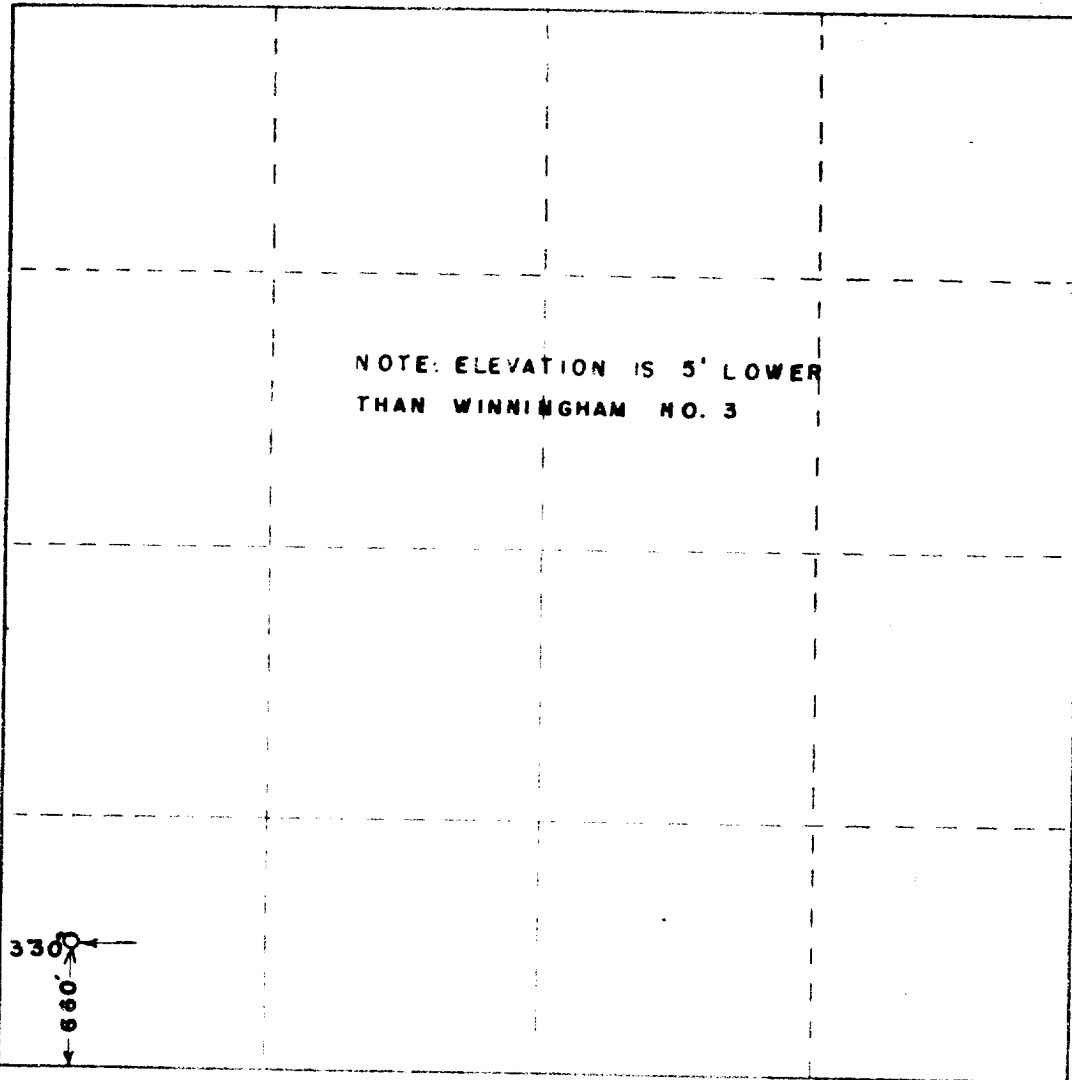

SEC. 29 TWP. 25 S. RGE. 37 E. N.M.P.M.

I CERTIFY THAT THIS SURVEY WAS MADE UNDER  
MY DIRECTION, AND THAT THE PLAT IS CORRECT  
TO THE BEST OF MY KNOWLEDGE.

*John W West*  
NEW MEXICO LICENSE NO. 676

RECEIVED

NOV 21 1950

JAL OFFICE