



IN REPLY REFER TO:

UNITED STATES  
DEPARTMENT OF THE INTERIOR

GEOLOGICAL SURVEY

P. O. Box 1138, El Paso  
Holt, New Mexico

December 12, 1956

Chenier Oil & Gas Company  
P. O. Box 1470  
Midland, Texas

Re: Lease Las Cruces 067263

Gentlemen:

Receipt is acknowledged of "Notice of Intention to Drill" dated December 3, 1956, covering your well No. 20 McClure on the subject leasehold in the SW NE 1/4 sec. 19, T. 24 S., R. 33 E., N.M.P.M., Dollard-Drinkard Pool, Lea County, New Mexico.

Your proposed work is approved subject to compliance with the provisions of the "Oil and Gas Operating Regulations" revised May 25, 1942, copy of which will be furnished you on request, and subject to the following conditions:

1. Drilling operations as authorized are subject to the attached sheet (revised February 1955) for general conditions of approval.
2. Either circulate cement to surface on 3-5/8" casing or isolate the salt section by use of a two-stage cementing process with cement being circulated to surface on second stage.

Very truly yours,

L. A. DuPont  
District Engineer

UNITED STATES  
DEPARTMENT OF THE INTERIOR  
GEOLOGICAL SURVEY

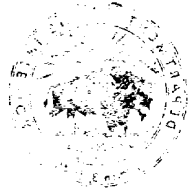

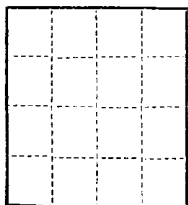

(SUBMIT IN TRIPLICATE)

UNITED STATES  
DEPARTMENT OF THE INTERIOR  
GEOLOGICAL SURVEY

Office Los Angeles  
Lease No. 067968  
Unit J. E. McClure

SUNDRY NOTICES AND REPORTS ON WELLS

NOTICE OF INTENTION TO DRILL.....	<input checked="" type="checkbox"/>	SUBSEQUENT REPORT OF WATER SHUT-OFF.....	
NOTICE OF INTENTION TO CHANGE PLANS.....		SUBSEQUENT REPORT OF SHOOTING OR ACIDIZING.....	
NOTICE OF INTENTION TO TEST WATER SHUT-OFF.....		SUBSEQUENT REPORT OF ALTERING CASING.....	
NOTICE OF INTENTION TO RE-DRILL OR REPAIR WELL.....		SUBSEQUENT REPORT OF RE-DRILLING OR REPAIR.....	
NOTICE OF INTENTION TO SHOOT OR ACIDIZE.....		SUBSEQUENT REPORT OF ABANDONMENT.....	
NOTICE OF INTENTION TO PULL OR ALTER CASING.....		SUPPLEMENTARY WELL HISTORY.....	
NOTICE OF INTENTION TO ABANDON WELL.....			

(INDICATE ABOVE BY CHECK MARK NATURE OF REPORT, NOTICE, OR OTHER DATA)

December 6, 1954

Well No. 20 is located 2310 ft. from [N] line and 230 ft. from [E] line of sec. 19

N1/4 of Sec 19 (1/4 Sec. and Sec. No.) S14 (Twp.) 30E (Range) N1/4 (Meridian)

Rollinsville, Trinidad (Field) Los (County or Subdivision) New Mexico (State or Territory)

The elevation of the derrick floor above sea level is ..... ft.

DETAILS OF WORK

(State names of and expected depths to objective sands; show sizes, weights, and lengths of proposed casings; indicate mudding jobs, cementing points, and all other important proposed work)

SINCLAIR OIL & GAS COMPANY - WELL NO. 20 - J. E. MCCLURE

<u>3-5/8" O</u>	<u>2 1/2 x 32 #</u>	<u>3250'</u>	<u>800 sacks</u>
<u>5-1/2" O</u>	<u>2 1/2, 15 x 17 #</u>	<u>6950'</u>	<u>550 sacks</u>

Propose to drill well to approximately 6950' to test the Abo formation 6800' to 7000'

ILLEGIBLE

I understand that this plan of work must receive approval in writing by the Geological Survey before operations may be commenced.

Company SINCLAIR OIL & GAS COMPANY

Address P. O. Box 1470

Midland, Texas

By [Signature]

Title R. L. Brown  
Div. Chief, Prod. Dept.

NEW MEXICO  
CONSERVATION COMMISSION

Form C-128

Well Location and/or Gas Proration Plat

HOBBS OFFICE OCC

Date 12/10/56

Operator SINCLAIR OIL & GAS COMPANY

Lease J. H. McClure

1956 DEC 14 PM 2:59

Well No. 20 Section 19 Township 24 S Range 38 E NMPS

Located 2310 Feet From North Line, 2310 Feet From East Line

Lea County, New Mexico. G. L. Elevation

Name of Producing Formation Pool Dedicated Acreage

(Note: All distances must be from outer boundaries of Section)

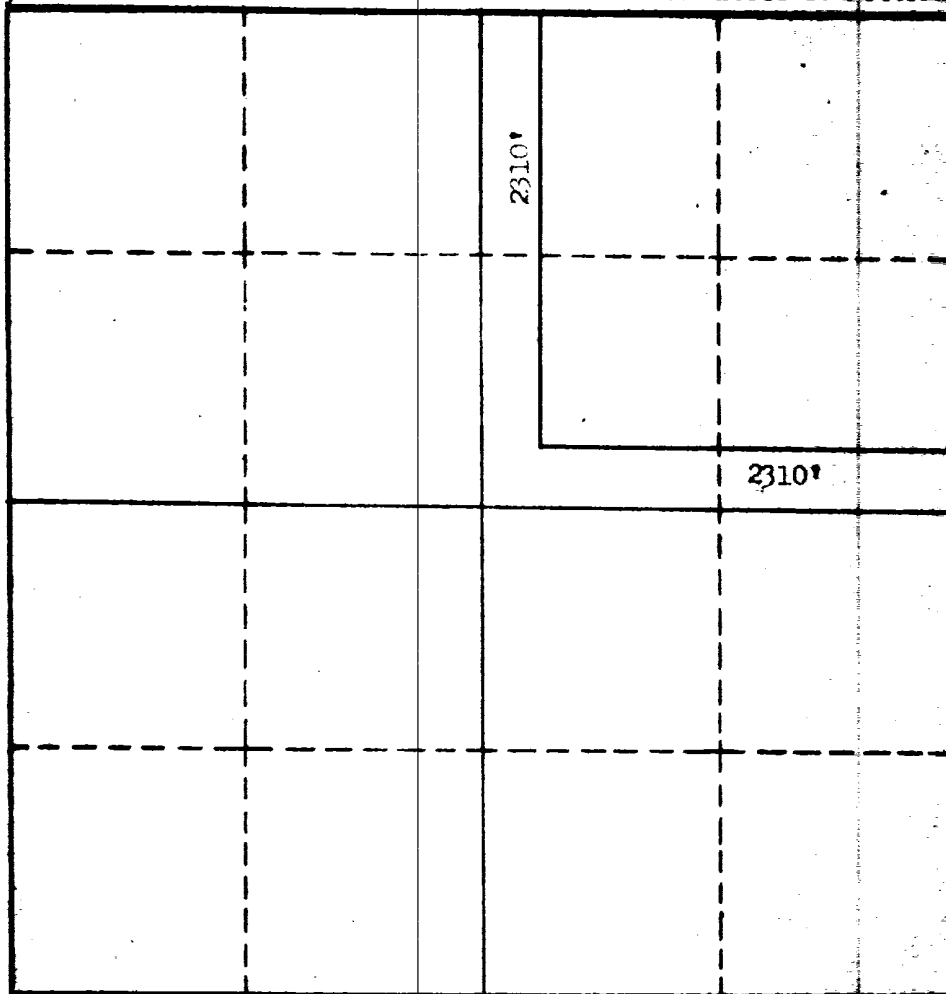

NOTE

This section of form is to be used for gas wells only.



1. Is this Well a Dual Comp. ? Yes No

2. If the answer to Question 1 is yes, are there any other dually completed wells within the dedicated acreage ? Yes No

Name C. J. Conner  
Position District Engineer  
Representing Sinclair Oil & Gas Company  
Address 520 East Broadway - Hobbs, New Mexico

This is to certify that the above plat was prepared from field notes of actual survey made by me or under my supervision and that the same are true and correct to the best of my knowledge and belief.

Date Surveyed 12/10/56

Registered Professional Land Surveyor