

NUMBER OF COPIES RECEIVED	
DISTRIBUTION	
SANTA FE	
FILE	
U.S.G.S.	
LAND OFFICE	
TRANSPORTER	OIL
	GAS
PROBATION OFFICE	
OPERATOR	

NEW MEXICO OIL CONSERVATION COMMISSION
Santa Fe, New Mexico

Form G-101
 Revised (12/1/55)

NOTICE OF INTENTION TO DRILL

Notice must be given to the District Office of the Oil Conservation Commission and approval obtained before drilling or recompletion begins. If changes in the proposed plan are considered advisable, a copy of this notice showing such changes will be returned to the sender. Submit this notice in **QUINTUPLICATE**. One copy will be returned following approval. See additional instructions in Rules and Regulations of the Commission. **If State Land submit 6 Copies Attach Form G-128 in triplicate to first 3 copies of form G-101**

3612 West Wall, Midland, Texas
 (Place)

April 1, 1965
 (Date)

OIL CONSERVATION COMMISSION
 SANTA FE, NEW MEXICO

Gentlemen:

You are hereby notified that it is our intention to commence the Drilling of a well to be known as
McFarland Corporation

(Company or Operator)

Continental State

(Lease)

Well No. 1, in B The well is
 (Unit)

located 1980 feet from the East line and 860 feet from the
North line of Section 5, T. 24-S, R. 38-E, NMPM.

(GIVE LOCATION FROM SECTION LINE) Wildcat Pool, Lea County

If State Land the Oil and Gas Lease is No. D 2657

If patented land the owner is _____

Address _____

We propose to drill well with drilling equipment as follows: Rotary

The status of plugging bond is Blanket bond Approved

Drilling Contractor B. L. McFarland, Inc.

We intend to complete this well in the San Andres formation at an approximate depth of 4200 feet.

CASING PROGRAM

We propose to use the following strings of Casing and to cement them as indicated:

Size of Hole	Size of Casing	Weight per Foot	New or Second Hand	Depth	Sacks Cement
15"	11 3/4"	42#	New	400	Circ.
11"	8 5/8"	24#	New	4100	300

If changes in the above plans become advisable we will notify you immediately.

ADDITIONAL INFORMATION (If recompletion give full details of proposed plan of work.)

Approved _____, 19____
 Except as follows:

OIL CONSERVATION COMMISSION

By _____

Sincerely yours,

McFarland Corporation

(Company or Operator)

By Richard T. Robinson

Position Vice President

Send Communications regarding well to

Name McFarland Corporation

Address 3612 West Wall, Midland, Texas

NEW MEXICO OIL CONSERVATION COMMISSION
WELL LOCATION AND ACREAGE DEDICATION PLAT

FORM C-128
 Revised 5/1/57

SEE INSTRUCTIONS FOR COMPLETING THIS FORM ON THE REVERSE SIDE

SECTION A

Operator McFARLAND CORPORATION		Lease CONTINENTAL STATE		Well No. 1
Unit Letter B	Section 5	Township 24 SOUTH	Range 38 EAST	County LEA
Actual Footage Location of Well: 860 feet from the NORTH line and 1980 feet from the EAST line				
Ground Level Elev. 3293.0	Producing Formation San Andres	Pool Wildcat	Dedicated Acreage: 40 Acres	

1. Is the Operator the only owner in the dedicated acreage outlined on the plat below? YES NO ____ . ("Owner" means the person who has the right to drill into and to produce from any pool and to appropriate the production either for himself or for himself and another. (63-3-29 (e) NMSA 1935 Comp.)
2. If the answer to question one is "no," have the interests of all the owners been consolidated by communitization agreement or otherwise? YES ____ NO ____ . If answer is "yes," Type of Consolidation ____
3. If the answer to question two is "no," list all the owners and their respective interests below:

Owner	Land Description

SECTION B

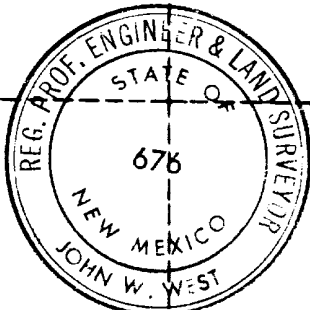
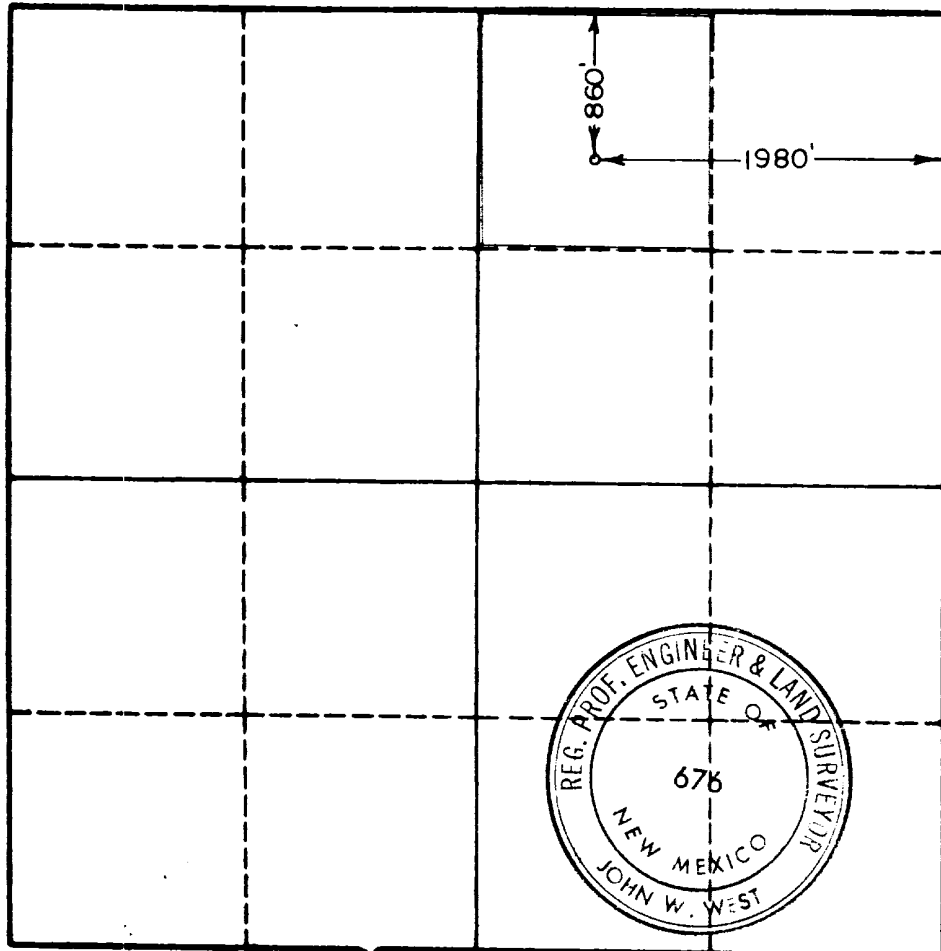

CERTIFICATION

I hereby certify that the information in SECTION A above is true and complete to the best of my knowledge and belief.

Richard L. Robinson
 Name
Richard L. Robinson
 Position
Vice President
 Company
McFarland Corporation
 Date
April 2, 1965

I hereby certify that the well location shown on the plat in SECTION B was plotted from field notes of actual surveys made by me or under my supervision, and that the same is true and correct to the best of my knowledge and belief.

Date Surveyed
MARCH 30, 1965
 Registered Professional Engineer and/or Land Surveyor, **JOHN W. WEST**
John W. West
 Certificate No.
N. M. - P. E. & L. S. NO. 676

