

NO. OF COPIES RECEIVED		
DISTRIBUTION		
SANTA FE		
FILE		
U.S.G.S.		
LAND OFFICE		
OPERATOR		

NEW MEXICO OIL CONSERVATION COMMISSION

Form C-101
Revised 1-1-65

5A. Indicate Type of Lease
STATE FEE

5. State Oil & Gas Lease No.

APPLICATION FOR PERMIT TO DRILL, DEEPEN, OR PLUG BACK

1a. Type of Work			7. Unit Agreement Name Langlie Mattix Woolworth		
b. Type of Well DRILL <input checked="" type="checkbox"/> DEEPEN <input type="checkbox"/> PLUG BACK <input type="checkbox"/> OIL WELL <input type="checkbox"/> GAS WELL <input type="checkbox"/> OTHER Injection SINGLE ZONE <input type="checkbox"/> MULTIPLE ZONE <input type="checkbox"/>			Unit		
2. Name of Operator Amerada Division, Amerada Hess Corporation			8. Farm or Lease Name		
3. Address of Operator P.O. Box 591, Midland, Texas 79701			9. Well No. 003		
4. Location of Well UNIT LETTER N LOCATED 1650 FEET FROM THE West LINE AND 330 FEET FROM THE South LINE OF SEC. 33 TWP. 24S RGE. 37E NMPM			10. Field and Pool, or Wildcat Langlie Mattix		
19. Proposed Depth 3735'			19A. Formation Langlie Mattix		20. Rotary or C.T. Rotary
21. Elevations (Show whether DP, RT, etc.)	21A. Kind & Status Plug. Bond Blanket	21B. Drilling Contractor Leatherwood Drlg. Co.	22. Approx. Date Work will start unknown		

23.

PROPOSED CASING AND CEMENT PROGRAM

SIZE OF HOLE	SIZE OF CASING	WEIGHT PER FOOT	SETTING DEPTH	SACKS OF CEMENT	EST. TOP
9-7/8"	7-5/8"	24#	760'	400	Circ.
6-3/4"	4-1/2"	9.5#	3735'	350	2700'

NOTICE IS NOTIFIED
OCCURRING 7/8"

APPROVAL VALID
FOR 30 DAYS UNLESS
RENEWED OR COMMENCED,

Jan. 3, 1971

IN ABOVE SPACE DESCRIBE PROPOSED PROGRAM: IF PROPOSAL IS TO DEEPEN OR PLUG BACK, GIVE DATA ON PRESENT PRODUCTIVE ZONE AND PROPOSED NEW PRODUCTIVE ZONE, GIVE BLOWOUT PREVENTER PROGRAM, IF ANY.

I hereby certify that the information above is true and complete to the best of my knowledge and belief.

Signed B. D. Sims Title Regional Manager Date 10-2-70

(This space for State Use)

APPROVED BY John W. Runyan TITLE Geologist DATE 10 5 1970

CONDITIONS OF APPROVAL, IF ANY:

NEW MEXICO OIL CONSERVATION COMMISSION
WELL LOCATION AND ACREAGE DEDICATION PLAT

Form C-102
Supersedes C-128
Effective 1-1-65

All distances must be from the outer boundaries of the Section.

Operator AMERADA DIVISION AMERADA HESS CORP.		Lease Langlie Mattix Woodworth Unit		Well No. 003
Unit Letter N	Section 33	Township 24 SOUTH	Range 37 EAST	County LEA
Actual Footage Location of Well: 1650 feet from the WEST line and 330 feet from the SOUTH line				
Ground Level Elev.	Producing Formation Langlie Mattix	Pool Langlie Mattix	Dedicated Acreage: Acres	

1. Outline the acreage dedicated to the subject well by colored pencil or hachure marks on the plat below.
2. If more than one lease is dedicated to the well, outline each and identify the ownership thereof (both as to working interest and royalty).
3. If more than one lease of different ownership is dedicated to the well, have the interests of all owners been consolidated by communitization, unitization, force-pooling, etc?

Yes No If answer is "yes," type of consolidation **Unitization**

If answer is "no," list the owners and tract descriptions which have actually been consolidated. (Use reverse side of this form if necessary.) _____

No allowable will be assigned to the well until all interests have been consolidated (by communitization, unitization, forced-pooling, or otherwise) or until a non-standard unit, eliminating such interests, has been approved by the Commission.

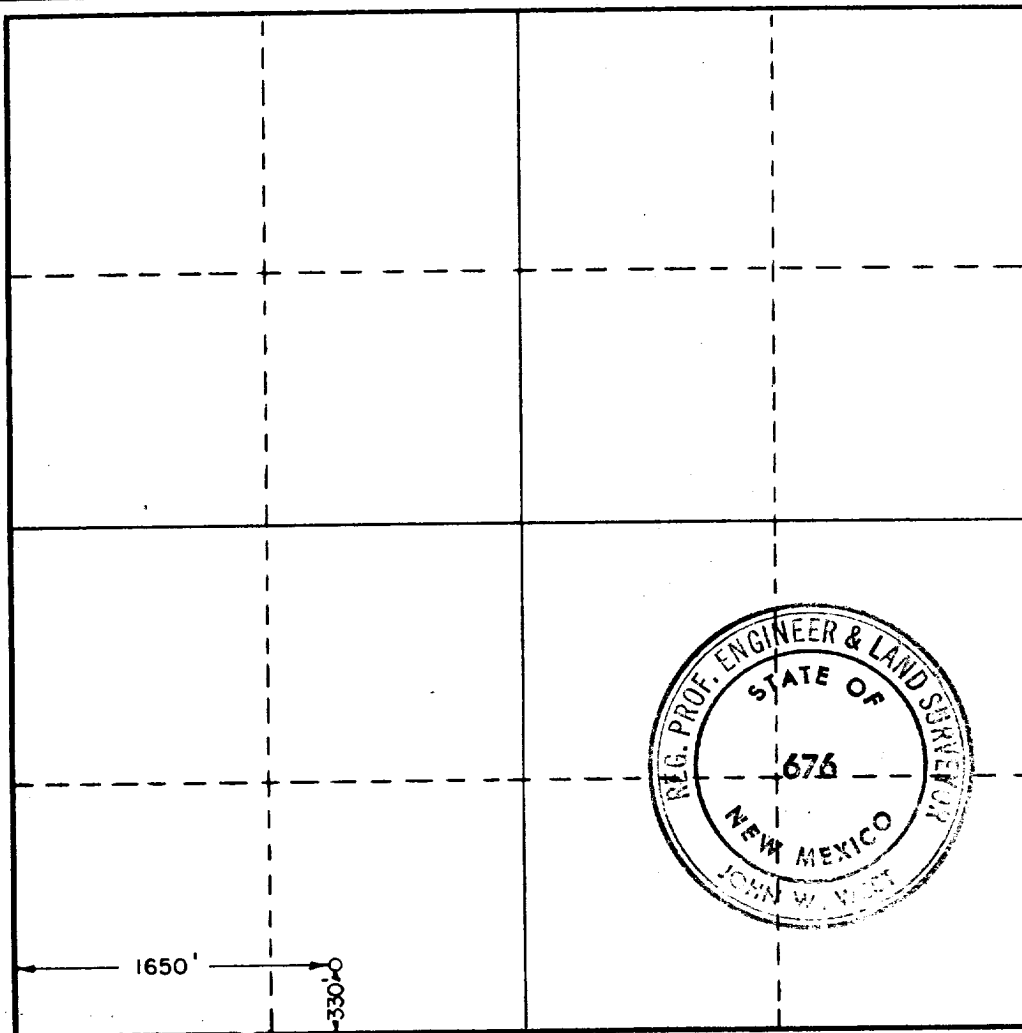

CERTIFICATION

I hereby certify that the information contained herein is true and complete to the best of my knowledge and belief.

Name
B. J. Ding

Position
**Regional Manager
Amerada Division
Amerada Hess Corp.**

Date
10-2-70

I hereby certify that the well location shown on this plat was plotted from field notes of actual surveys made by me or under my supervision, and that the same is true and correct to the best of my knowledge and belief.

Date Surveyed
SEPT. 15, 1970

Registered Professional Engineer and/or Land Surveyor
John W. West

Certificate No.
676

173

RECEIVED

APR 1961

OIL CONSERVATION COM. WASH. D.C.