

30-025-27616

UNITED STATES
DEPARTMENT OF THE INTERIOR
GEOLOGICAL SURVEY

APPLICATION FOR PERMIT TO DRILL, DEEPEN, OR PLUG BACK

1a. TYPE OF WORK
 DRILL DEEPEN PLUG BACK

b. TYPE OF WELL
 OIL WELL GAS WELL OTHER SINGLE ZONE MULTIPLE ZONE

2. NAME OF OPERATOR
 THE SUPERIOR OIL COMPANY

3. ADDRESS OF OPERATOR
 P.O. Box 4500 The Woodlands, Texas 77380

4. LOCATION OF WELL (Report location clearly and in accordance with any State requirements.*)
 At surface 1980' FNL & 660' FEL of Sec. 22
 At proposed prod. zone
 As above.

14. DISTANCE IN MILES AND DIRECTION FROM NEAREST TOWN OR POST OFFICE*
 28 miles Southeast of Loving, New Mexico

15. DISTANCE FROM PROPOSED* LOCATION TO NEAREST PROPERTY OR LEASE LINE, FT. (Also to nearest drlg. unit line, if any)
 660' 660'

16. NO. OF ACRES IN LEASE
 160

17. NO. OF ACRES ASSIGNED TO THIS WELL
 320 (East 1/2 Sec. 22)

18. DISTANCE FROM PROPOSED LOCATION* TO NEAREST WELL, DRILLING, COMPLETED, OR APPLIED FOR, ON THIS LEASE, FT.
 First Well 16,000'

19. PROPOSED DEPTH
 16,000'

20. ROTARY OR CABLE TOOLS
 Rotary

21. ELEVATIONS (Show whether DF, RT, GR, etc.)
 3409' G.L.

22. APPROX. DATE WORK WILL START*
 November 1, 1981

5. LEASE DESIGNATION AND SERIAL NO.
 NM-16354

6. IF INDIAN, ALLOTTEE OR TRIBE NAME

7. UNIT AGREEMENT NAME

8. FARM OR LEASE NAME
 Paduca Federal Com

9. WELL NO.
 1

10. FIELD AND POOL, OR WILDCAT
 Wildcat

11. SEC., T., R., M., OR BLK. AND SURVEY OR AREA
 Sec. 22, T25S-R32E

12. COUNTY OR PARISH 13. STATE
 Lea New Mexico

23. PROPOSED CASING AND CEMENTING PROGRAM

SIZE OF HOLE	SIZE OF CASING	WEIGHT PER FOOT	SETTING DEPTH	QUANTITY OF CEMENT
	30"	310#	CIRCULATE 40'	Redi-Mix
26"	20"	94# K-55	CIRCULATE 650'	1500 sx class "C"
17-1/2"	13-3/8"	68# k-55/S-80	CIRCULATE 1,000'	1800 sx class "C" & Lite
12-1/4"	9-5/8"	47# S-95	12,400'	800 sx class "H"
8-1/2"	7-5/8"	39# S-95	12,050-13,850	150 sx Class "H" & Poz.
6-1/2"	5"	23.2# N-80	13,500-TD	250 sx Class "H" & Poz.

SEE ATTACHED 10 POINT DRILLING PROGRAM
 13 POINT SURFACE USE PROGRAM
 ARCHAEOLOGICAL SURVEY

THE GAS IS NOT DEDICATED.

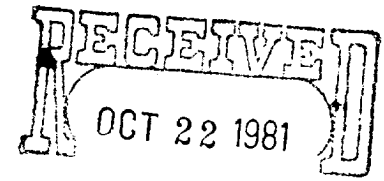

OIL & GAS
 U.S. GEOLOGICAL SURVEY
 ROSWELL, NEW MEXICO

IN ABOVE SPACE DESCRIBE PROPOSED PROGRAM: If proposal is to deepen or plug back, give data on present productive zone and proposed new productive zone. If proposal is to drill or deepen directionally, give pertinent data on subsurface locations and measured and true vertical depths. Give blowout preventer program if any.

24. SIGNED G. Bannantine TITLE Reg. Group Mgr. DATE 10-20-81

(This space for Federal or State office use)

APPROVED

PERMIT NO. 30-025-27616 APPROVAL DATE _____
 (Sgd.) GEORGE H. STEWART

APPROVED BY _____ DATE _____
 CONDITIONS OF APPROVAL: _____

FOR
 JAMES A. OLLIHAM
 DISTRICT SUPERVISOR

NEW MEXICO OIL CONSERVATION COMMISSION
WELL LOCATION AND ACREAGE DEDICATION PLAT

Form C-102
Supersedes C-128
Effective 1-1-65

All distances must be from the outer boundaries of the Section.

Operator THE SUPERIOR OIL CO.		Lease PADUCA FED. COM.		Well No. 1
Unit Letter H	Section 22	Township 25 SOUTH	Range 32 EAST	County LEA
Actual Footage Location of Well: 660 feet from the EAST line and 1980 feet from the NORTH line				
Ground Level Elev. 3408.6	Producing Formation Morrow	Pool Wildcat	Dedicated Acreage: 320 Acres	

- Outline the acreage dedicated to the subject well by colored pencil or hachure marks on the plat below.
- If more than one lease is dedicated to the well, outline each and identify the ownership thereof (both as to working interest and royalty).
- If more than one lease of different ownership is dedicated to the well, have the interests of all owners been consolidated by communitization, unitization, force-pooling, etc?

Acreage will be communitized if

 Yes No If answer is "yes," type of consolidation Production is established.

If answer is "no," list the owners and tract descriptions which have actually been consolidated. (Use reverse side of this form if necessary.) _____

No allowable will be assigned to the well until all interests have been consolidated (by communitization, unitization, forced-pooling, or otherwise) or until a non-standard unit, eliminating such interests, has been approved by the Commission.

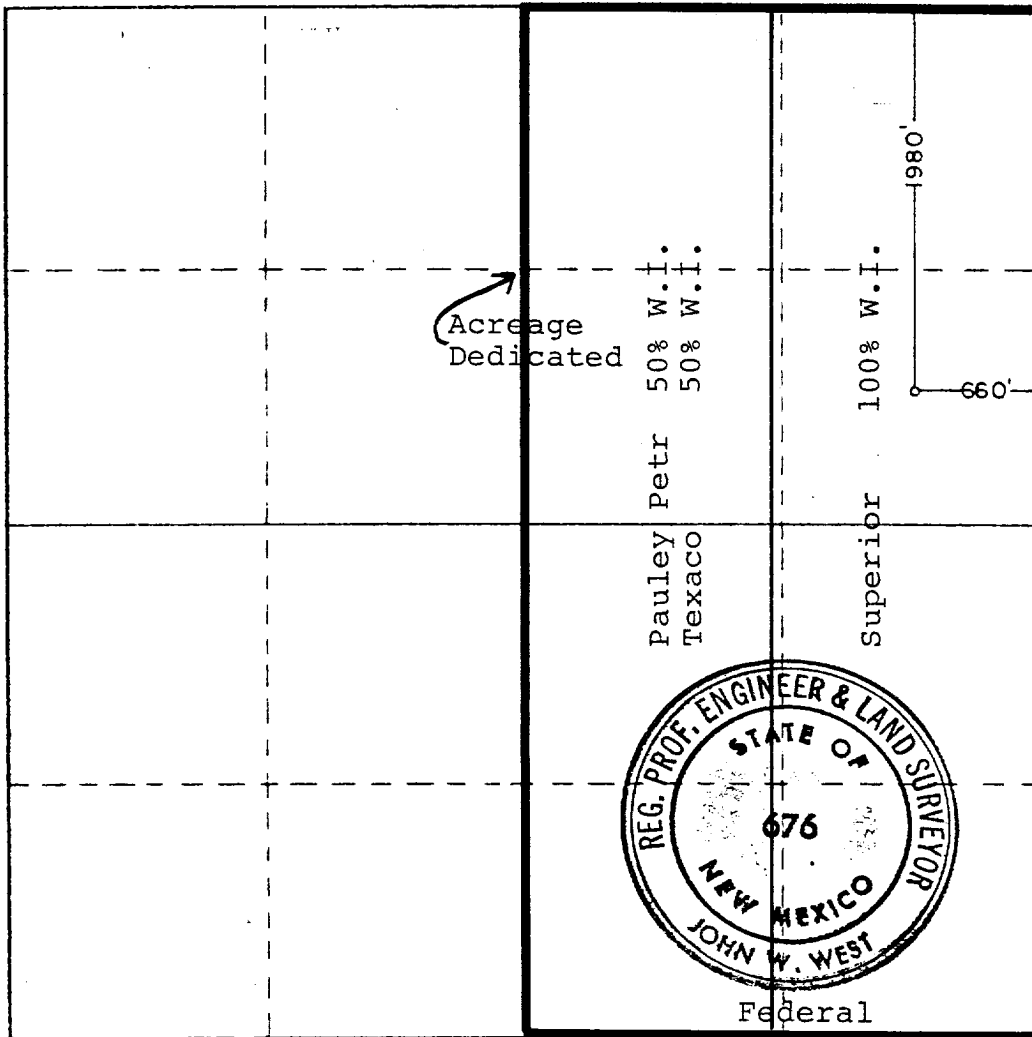

CERTIFICATION

I hereby certify that the information contained herein is true and complete to the best of my knowledge and belief.

G. Bannantine

Name
G. Bannantine
Position
Regulatory Group Manager
Company
The Superior Oil Co.

Date
October 19, 1981

I hereby certify that the well location shown on this plat was plotted from field notes of actual surveys made by me or under my supervision, and that the same is true and correct to the best of my knowledge and belief.

Date Surveyed
10-6-81

Registered Professional Engineer and/or Land Surveyor
John W. West

Certificate No **JOHN W. WEST 676**
PATRICK A. ROMERO 6863
Ronald J. Eidson 3239

DOUBLE PREVENTER OPTION

(6)

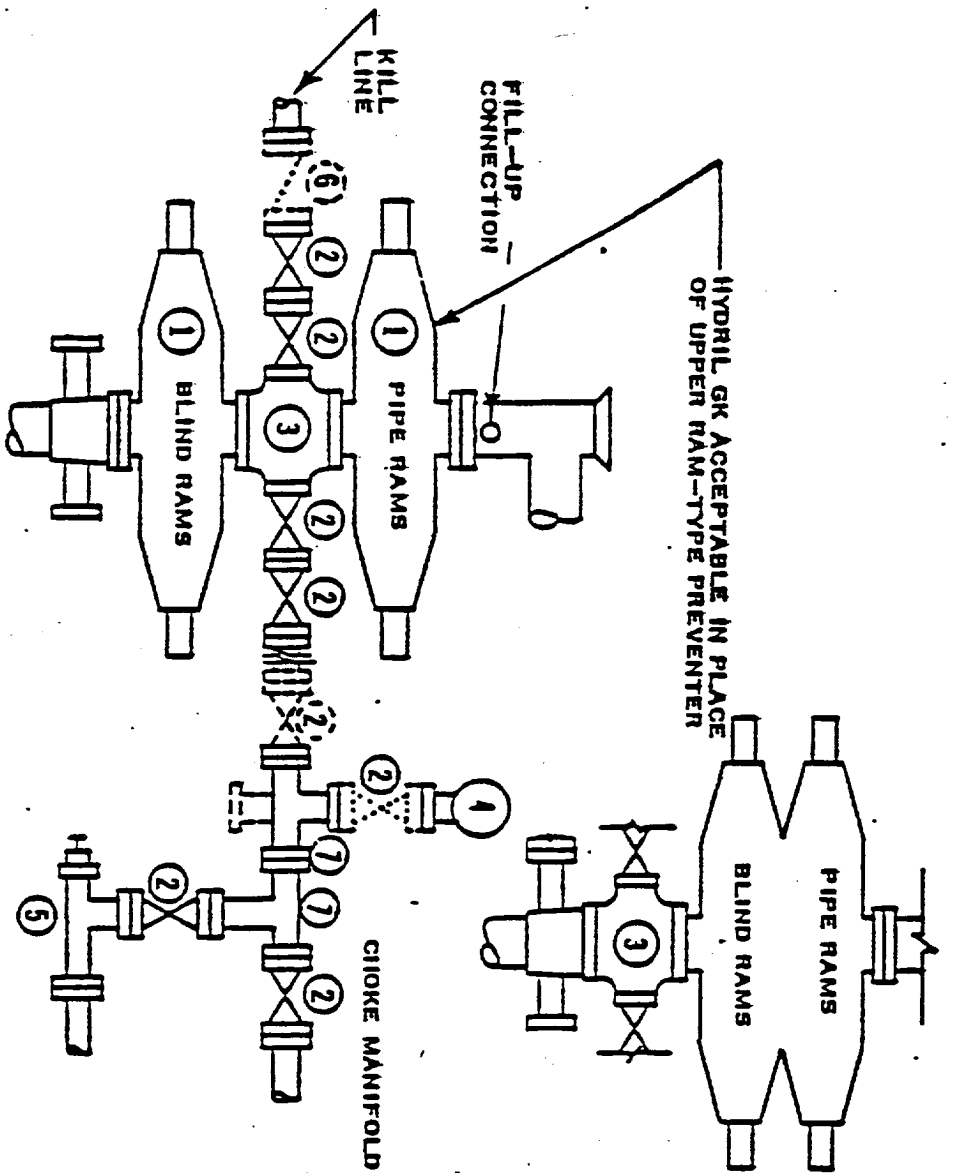

- ① SERIES 900 RAM-TYPE BOP
- ② 2" SERIES 900 VALVE
- ③ SERIES 900 DRILLING SPOOL
- ④ 2" MUD PRESSURE GAUGE
- ⑤ 2" SERIES 900 CHOKER
- ⑥ 2" SERIES 900 CHECK VALVE
- ⑦ 2" SERIES 900 STEEL TEE

NOTES:

- 1. 3000 PSI WP CLAMP HUBS MAY BE SUBSTITUTED FOR FLANGES
- 2. VALVES MAY BE EITHER HAND OR POWER OPERATED BUT, IF POWER OPERATED, THE VALVES FLANGED TO THE BOP RUN MUST BE CAPABLE OF BEING OPENED AND CLOSED MANUALLY OR CLOSE ON POWER FAILURE AND BE CAPABLE OF BEING OPENED MANUALLY

.....OPTIONAL EQUIPMENT

3000 PSI WORKING PRESSURE
 BLOWOUT PREVENTER HOOK-UP
 (SERIES 900 FLANGES OR BETTER)

..... OPTIONAL EQUIPMENT

DOUBLE PREVENTER OPTION

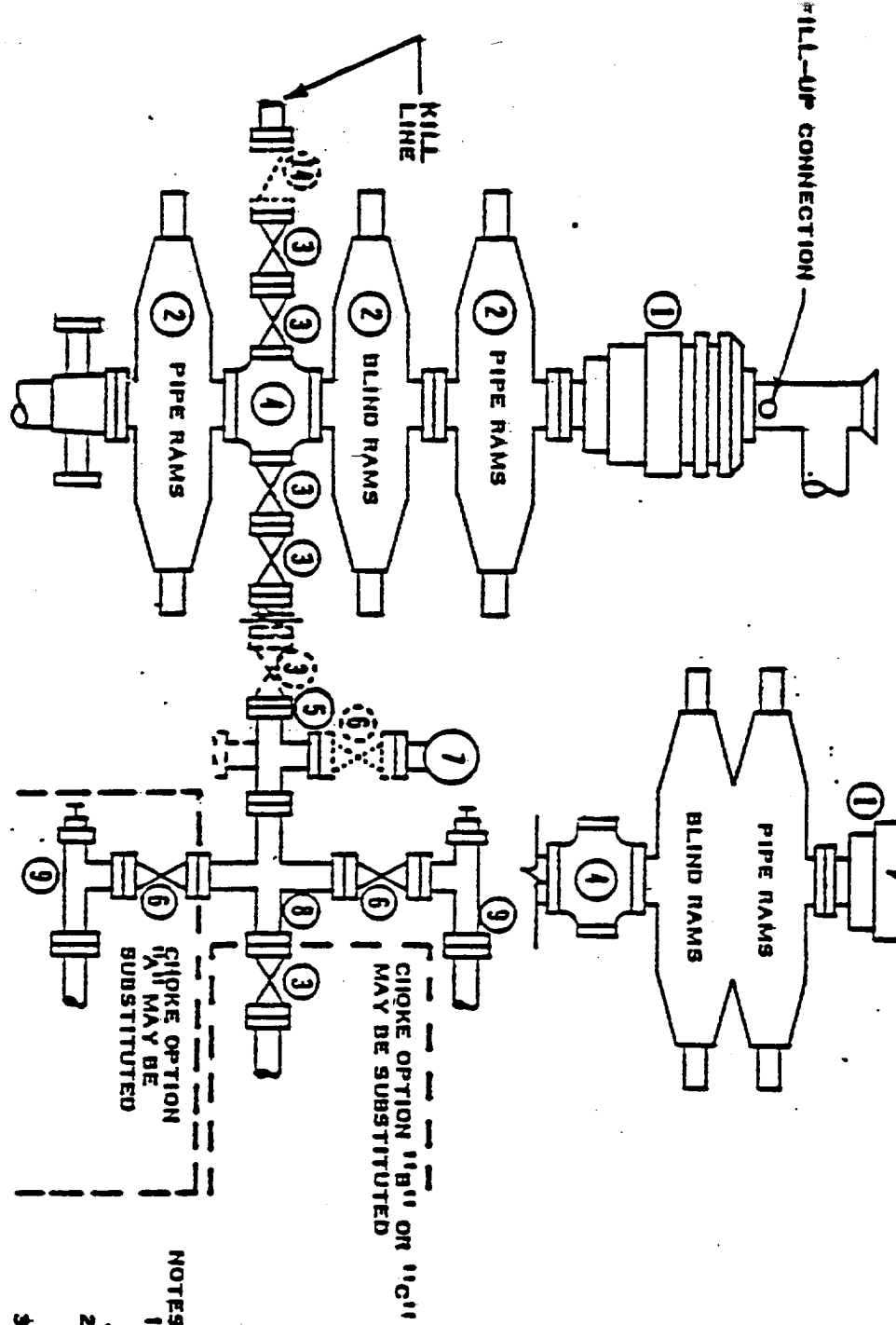

- ① 1 SER., 1800 HYDRIL GK
- ② 2 SER., 1800 RAM-TYPE BOP (8)
- ③ 3" SER., 1500 VALVE
- ④ 1 SER., 1800 DRILLING SPOOL
- ⑤ 3" SER., 1500 X 2" SER., 1500 STEEL TEE
- ⑥ 2" SER., 1500 VALVE
- ⑦ 2" MUD PRESSURE GUAGE
- ⑧ 3" SER., 1500 X 2" SER., 1500 STEEL CROSS
- ⑨ 2" SER., 1500 ADJ., CHIOKE
- ⑩ 2" SER., 1500 ADJ., CHIOKE ON 2" SER., 1500 RISER VALVE ON SIDE OUTLET OF 2" SER., 1500 STEEL TEE
- ⑪ ADAPTER, 2" SER., 1500 X 10,000 LB WP FLANGE MATING ⑬ INLET
- ⑫ 10,000 LB WP REMOTE CHIOKE
- ⑬ HYDRAULIC CHIOKE, 2500 LB WP OR BETTER
- ⑭ 3" SER., 1500 CHECK VALVE

NOTES

1. 5000 PSI WP OR BETTER CLAMP HUBS MAY BE SUBSTITUTED FOR FLANGES
2. ONE ADJUSTABLE CHIOKE MAY BE REPLACED WITH A POSITIVE CHIOKE
3. VALVES MAY BE EITHER HAND OR POWER, OPERATED BUT, IF POWER OPERATED, THE VALVES FLANGED TO THE BOP RUN MUST BE CAPABLE OF BEING OPENED AND CLOSED MANUALLY OR CLOSE ON POWER FAILURE AND BE CAPABLE OF BEING OPENED MANUALLY

5000 PSI WORKING PRESSURE
BLOWOUT PREVENTER HOOK-UP
(SERIES 1500 FLANGES OR BETTER)

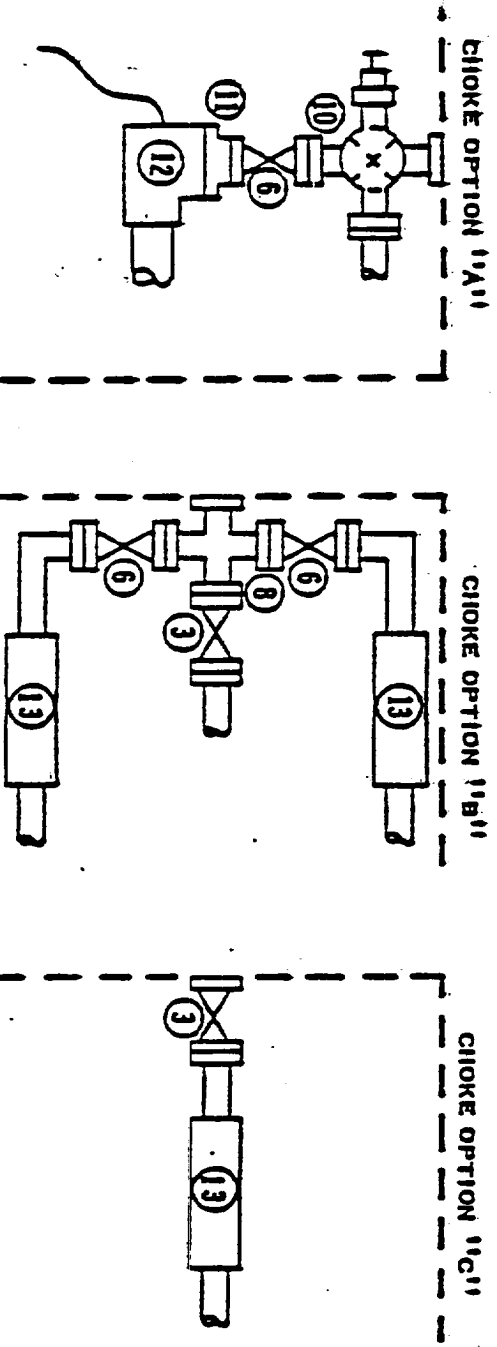

..... OPTIONAL EQUIPMENT

DOUBLE PREVENTER OPTION

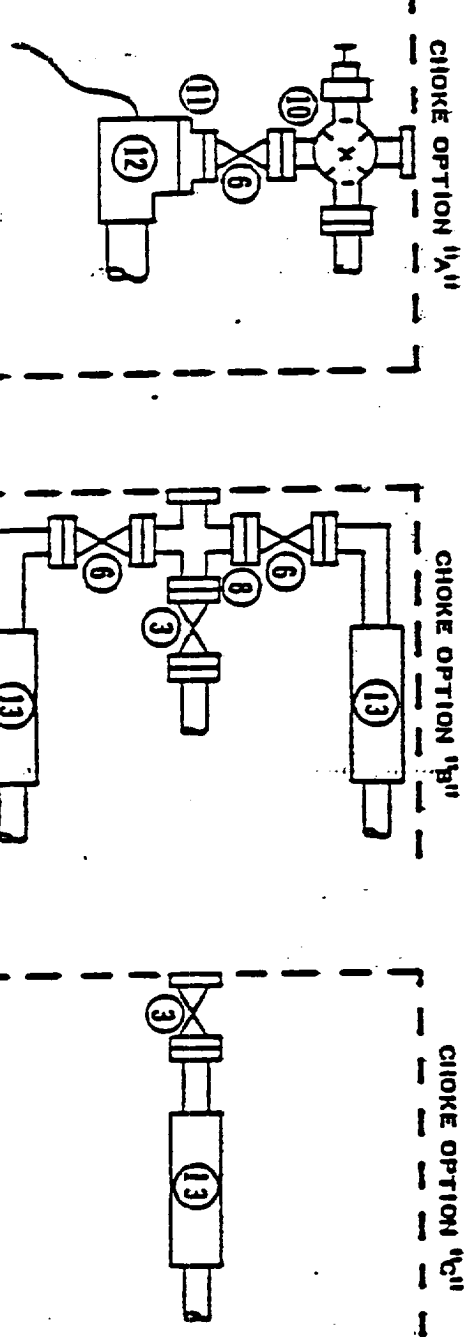
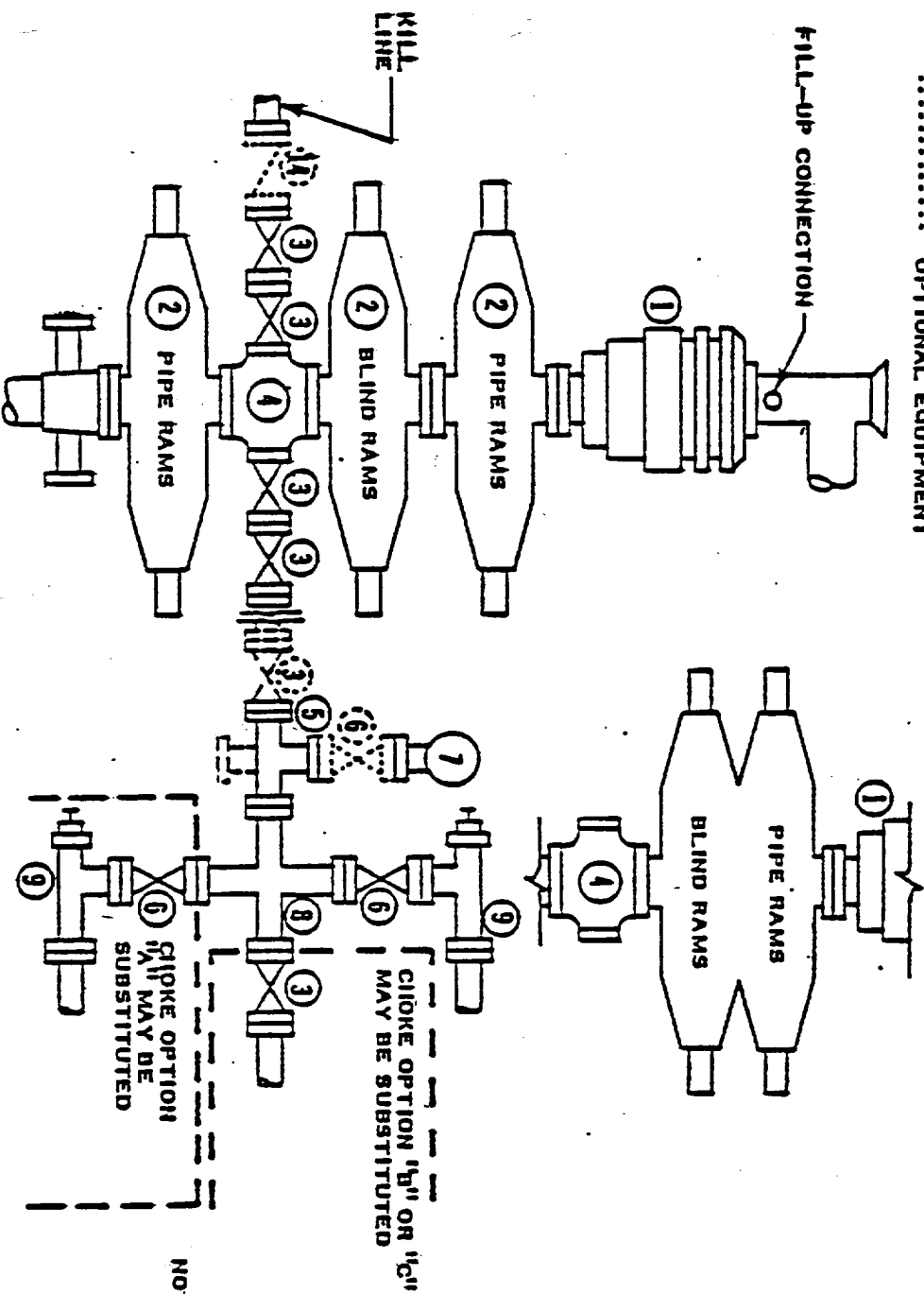

① HYDRIL GK 10,000 LB WP 6 BX (9)

② RAM-TYPE BOP, 10,000 LB WP 6 BX

③ 3 1/16" 10,000 LB WP 6 BX VALVE

④ DRILLING SPOOL, 10,000 LB WP 6 BX

⑤ STEEL TEE, 3 1/16" X 2 1/16" 10,000 LB WP 6 BX

⑥ 2 1/16" 10,000 LB WP 6 BX VALVE

⑦ MUD PRESSURE GAUGE

⑧ STEEL CROSS, 3 1/16 X 2 1/16 10,000 LB WP 6 BX

⑨ ADJ. CHOKE 2 1/16" 10,000 LB WP 6 BX

⑩ 2 1/16 ADJ. CHOKE ON 2 1/16 RISER VALVE ON SIDE OUTLET OF 2 1/16 STEEL TEE, ALL 10,000 LB WP 6 BX

⑪ ADAPTER 2 1/16 X FLANGE MATHING INLET OF ⑫, 10,000 LB WP 6 BX

⑫ 10,000 LB WP REMOTE CHOKE

⑬ HYDRAULIC CHOKE, 2500 LB WP OR BETTER

⑭ CHECK VALVE, 3 1/16" 10,000 LB WP 6 BX

NOTES:

1. 10,000 PSI WP OR BETTER CLAMP HUBS MAY BE SUBSTITUTED FOR FLANGES
2. ONE ADJUSTABLE CHOKE MAY BE REPLACED WITH A POSITIVE CHOKE
3. VALVES MAY BE EITHER HAND OR POWER OPERATED BUT, IF POWER OPERATED, THE VALVES FLANGED TO THE BOP RUN MUST BE CAPABLE OF BEING OPENED AND CLOSED MANUALLY OR CLOSE ON POWER FAILURE AND BE CAPABLE OF BEING OPENED MANUALLY

10,000 PSI WORKING PRESSURE BLOWOUT PREVENTER HOOK-UP FLANGES OR BETTER

RECEIVED

OCT 27 1984

173

OIL CONSERVATION DIV