

NEW MEXICO OIL CONSERVATION COMMISSION
Well Location and Acreage Dedication Plat

Section A.

Date 1-10-59

Operator Ohio Oil Co. Lease Federal McGrail
Well No. 2 Unit Letter C Section 20 Township 8 South Range 37 East NMFM
Located 1930 Feet From West Line, 660 Feet From North Line
County Roosevelt G. L. Elevation 4043.2 Dedicated Acreage 40 Acres
Name of Producing Formation Bough "C" Pool Undesignated

1. Is the Operator the only owner* in the dedicated acreage outlined on the plat below?
Yes X No .
2. If the answer to question one is "no," have the interests of all the owners been consolidated by communitization agreement or otherwise? Yes No . If answer is "yes," Type of Consolidation
3. If the answer to question two is "no," list all the owners and their respective interests below:

Owner

Land Description

RECEIVED

JAN 16 1959

U. S. GEOLOGICAL SURVEY
HOBBS, NEW MEXICO

Section B

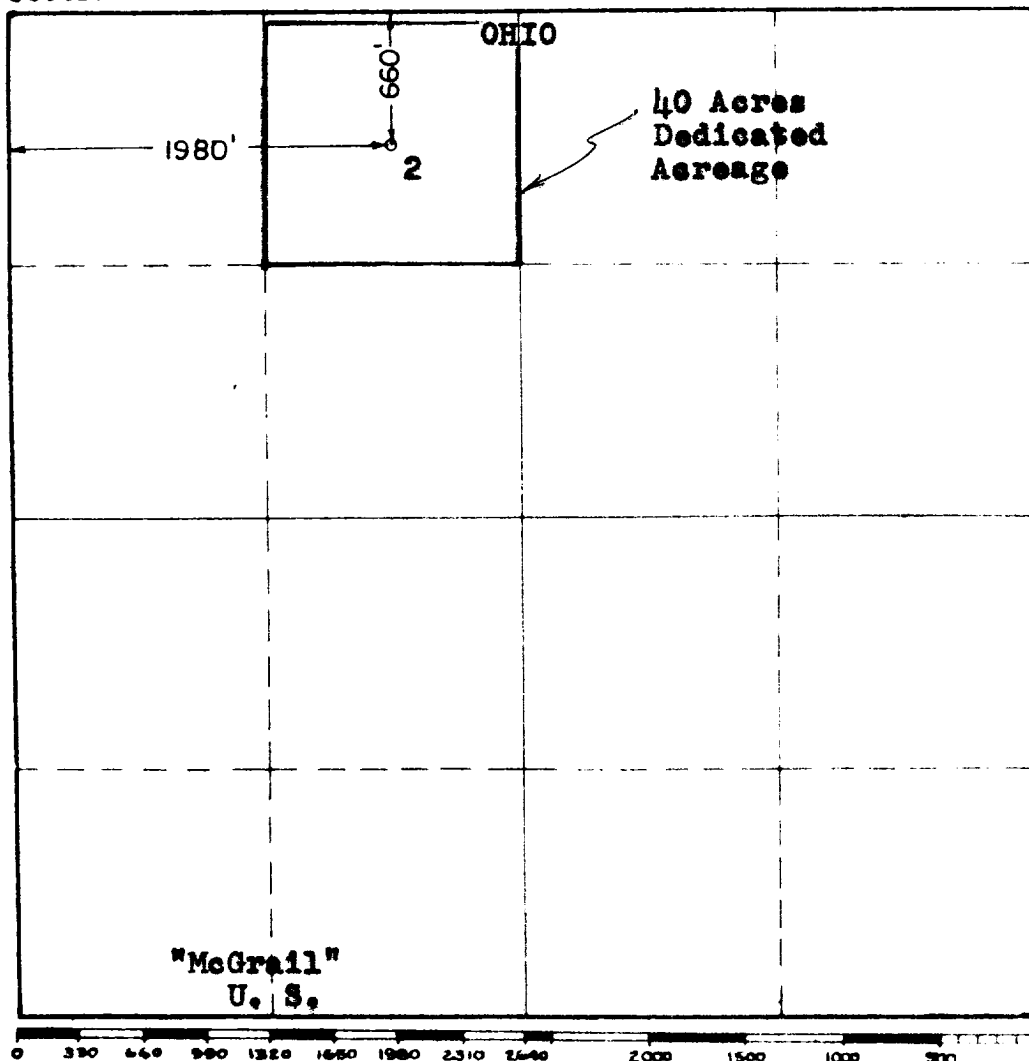

This is to certify that the information in Section A above is true and complete to the best of my knowledge and belief.

The Ohio Oil Company
(Operator)

Thomas C. Helt
(Representative)

Box 2107, Hobbs, N. M.
Address

This is to certify that the well location shown on the plat in Section B was plotted from field notes of actual surveys made by me or under my supervision and that the same is true and correct to the best of my knowledge and belief.

Date Surveyed 1-9-59

John W. West
Registered Professional
Engineer and/or Land Surveyor.

Certificate No. 676

(See instructions for completing this form on the reverse side)