

Intent ☐ As Drilled ☒

OCD - HOBBS
04/28/2020
RECEIVED

API #
30-025-46282

Operator Name:
MATADOR PRODUCTION COMPANY

Property Name:
LEO THORSNESS 13 24 33 AR

Well Number
135H

Kick Off Point (KOP)

UL D	Section 13	Township 24S	Range 33E	Lot 4	Feet 222	From N/S N	Feet 330	From E/W E	County LEA
Latitude N 32.2242389					Longitude W 103.5313972				NAD 83

First Take Point (FTP)

UL D	Section 13	Township 24S	Range 33E	Lot 4	Feet 402	From N/S N	Feet 339	From E/W E	County LEA
Latitude N 32.2237427					Longitude W 103.5314271				NAD 83

Last Take Point (LTP)

UL M	Section 13	Township 24S	Range 33E	Lot 13	Feet 183	From N/S S	Feet 323	From E/W E	County LE
Latitude N 32.2108600					Longitude W 103.5313673				NAD 83

Is this well the defining well for the Horizontal Spacing Unit? ☐

Is this well an infill well? ☐

If infill is yes please provide API if available, Operator Name and well number for Defining well for Horizontal Spacing Unit.

API #

Operator Name:

Property Name:

Well Number

KZ 06/29/2018

District I
1625 N French Dr., Hobbs, NM 88240
Phone: (575) 393-6161 Fax: (575) 393-0720
District II
811 S. First St., Artesia, NM 88210
Phone: (575) 748-1283 Fax: (575) 748-9720
District III
1000 Rio Brazos Road, Aztec, NM 87410
Phone: (505) 334-6178 Fax: (505) 334-6170
District IV
1220 S. St. Francis Dr., Santa Fe, NM 87505
Phone: (505) 476-3460 Fax: (505) 476-3462

State of New Mexico
Energy, Minerals & Natural Resources
Department
OIL CONSERVATION DIVISION
1220 South St. Francis Dr.
Santa Fe, NM 87505

FORM C-102
Revised August 1, 2011
Submit one copy to appropriate
District Office

OCB - HOBBS
04/28/2020
RECEIVED

☐ AMENDED REPORT

WELL LOCATION AND ACREAGE DEDICATION PLAT

¹ API Number 30-025-46282		² Pool Code 96434		³ Pool Name Red Hills; Bone Spring, North	
⁴ Property Code 326014		⁵ Property Name LEO THORSNESS 13-24S-33E AR			⁶ Well Number 135H
⁷ GRID No. 228937		⁸ Operator Name MATADOR PRODUCTION COMPANY			⁹ Elevation 3602'

¹⁰Surface Location

UL or lot no.	Section	Township	Range	Lot Idn	Feet from the	North/South line	Feet from the	East/West line	County
A	14	24-S	33-E	-	569'	NORTH	35'	EAST	LEA

UL or lot no.	Section	Township	Range	Lot Idn	Feet from the	North/South line	Feet from the	East/West line	County
M	13	24-S	33-E	-	49'	SOUTH	1000'	WEST	LEA

¹² Dedicated Acres 160	¹³ Joint or Infill	¹⁴ Consolidation Code	¹⁵ Order No.
--------------------------------------	-------------------------------	----------------------------------	-------------------------

No allowable will be assigned to this completion until all interests have been consolidated or a non-standard unit has been approved by the division.

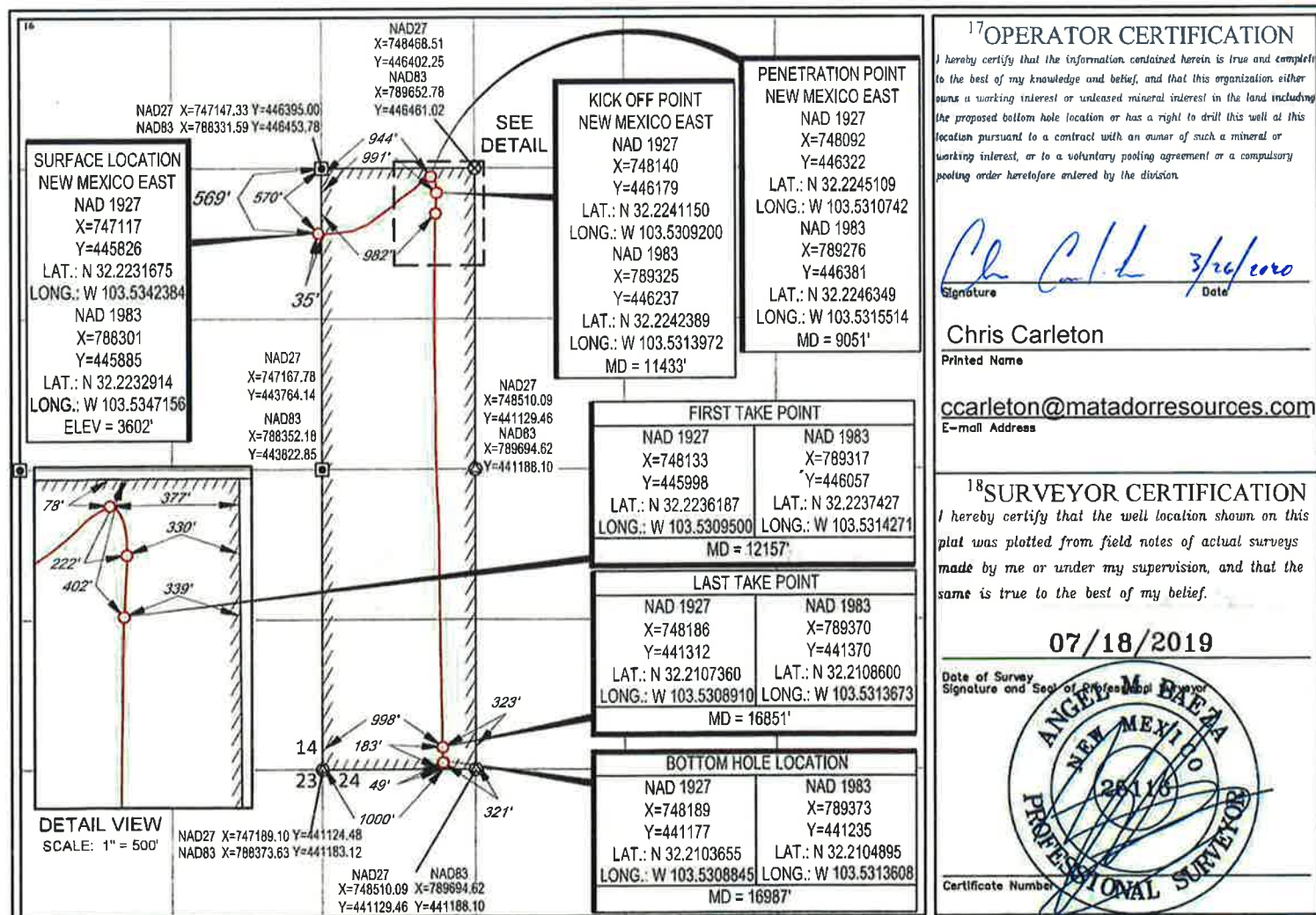

Submit 1 Copy To Appropriate District Office
District I - (575) 393-6161
1625 N. French Dr., Hobbs, NM 88240
District II - (575) 748-1283
811 S. First St., Artesia, NM 88210
District III - (505) 334-6178
1000 Rio Brazos Rd., Aztec, NM 87410
District IV - (505) 476-3460
1220 S. St. Francis Dr., Santa Fe, NM 87505

State of New Mexico
Energy, Minerals and Natural Resources

OIL CONSERVATION DIVISION
1220 South St. Francis Dr.
Santa Fe, NM 87505

Form C-103
Revised July 18, 2013

SUNDRY NOTICES AND REPORTS ON WELLS (DO NOT USE THIS FORM FOR PROPOSALS TO DRILL OR TO DEEPEN OR PLUG BACK TO A DIFFERENT RESERVOIR. USE "APPLICATION FOR PERMIT" (FORM C-101) FOR SUCH PROPOSALS.)		WELL API NO. 30-025-46282
1. Type of Well: Oil Well <input checked="" type="checkbox"/> Gas Well <input type="checkbox"/> Other <input type="checkbox"/>		5. Indicate Type of Lease STATE <input type="checkbox"/> FEE <input checked="" type="checkbox"/>
2. Name of Operator MATADOR PRODUCTION COMPANY		6. State Oil & Gas Lease No.
3. Address of Operator 5400 LBJ FREEWAY, STE 1500, DALLAS, TX 75240		7. Lease Name or Unit Agreement Name LEO THORSNESS 13 24 33 AR
4. Well Location Unit Letter <u>A</u> : <u>569</u> feet from the <u>S</u> line and <u>35</u> feet from the <u>E</u> line Section <u>14</u> Township <u>24S</u> Range <u>33E</u> NMPM County <u>LEA</u>		8. Well Number <u>135H</u>
11. Elevation (Show whether DR, RKB, RT, GR, etc.) 3602' GR		9. OGRID Number 228937
		10. Pool name or Wildcat RED HILLS; BONE SPRING, NORTH

12. Check Appropriate Box to Indicate Nature of Notice, Report or Other Data

NOTICE OF INTENTION TO:		SUBSEQUENT REPORT OF:	
PERFORM REMEDIAL WORK <input type="checkbox"/>	PLUG AND ABANDON <input type="checkbox"/>	REMEDIAL WORK <input type="checkbox"/>	ALTERING CASING <input type="checkbox"/>
TEMPORARILY ABANDON <input type="checkbox"/>	CHANGE PLANS <input type="checkbox"/>	COMMENCE DRILLING OPNS. <input type="checkbox"/>	P AND A <input type="checkbox"/>
PULL OR ALTER CASING <input type="checkbox"/>	MULTIPLE COMPL <input type="checkbox"/>	CASING/CEMENT JOB <input type="checkbox"/>	
DOWNHOLE COMMINGLE <input type="checkbox"/>			
CLOSED-LOOP SYSTEM <input type="checkbox"/>			
OTHER: <input type="checkbox"/>		OTHER: <u>Drilling Sundry</u> <input checked="" type="checkbox"/>	

13. Describe proposed or completed operations. (Clearly state all pertinent details, and give pertinent dates, including estimated date of starting any proposed work). SEE RULE 19.15.7.14 NMAC. For Multiple Completions: Attach wellbore diagram of proposed completion or recompletion.

Please see attached.

Spud Date:

08/24/19

Rig Release Date:

09/11/19

I hereby certify that the information above is true and complete to the best of my knowledge and belief.

SIGNATURE

Ava Monroe

TITLE Sr Regulatory Analyst

DATE

04/28/20

Type or print name Ava Monroe

E-mail address: amonroe@matadorresources.com

PHONE: 972-371-5218

For State Use Only

APPROVED BY:

PM

TITLE

LM

DATE

04/28/2020

Conditions of Approval (if any):

DRILLING SUNDRY – LEO THORSNESS 13 24 33 AR 135H 30-025-46282

SPUD: 08/24/19 RR: 09/11/19 TD REACHED 09/06/19 TVD/MD: 12073'/16987'; PBD 16970' REACHED 09/06/19

08/24/19: Spud well. Drill ahead.

08/25/19: Hole sz 17.5; Surface casing: MU shoe, 1 jt, FC, break circ, and run total 31 jts of 13 3/8" x 54.50# x J-55 x BTC csg. set @ 1377'. Pump 20 bbls spacer, lead cmt, 945 sks (319 bbl) @ 12.9 ppg, yield 1.89, water 9.99 gps. Tail cmt 410 sks (99.5 bbl) @ 14.8 ppg, yield 1.36, water 6.3 gps. Shut down, drop top plug, displace w/ 206 bbls water, bump plug w/ 1020 psi 500 over bleed off got 1.0 bbls back. Floats held. (240 bbls cmt back to surface). RD Halliburton. WOC 18.0 hrs.

08/26/19: Test surface csg t/ 910 psi for 30 min. Held. Good test. Drill ahead.

08/28/19: Hole sz 12.25; Intermediate casing: MU 2 jt shoe track, break circ. run total 120 jts of 9 5/8" x 40# x J-55 x BTC csg. Set @ 5307'. Pump 20 bbl gel spacer. Lead cmt 1215 sks (411 bbl.) @ 12.9 ppg yield 1.9, water 10.01 gal/sk. Tail cmt 520 sks (125 bbl) @ 14.8 ppg yield 1.35, water 6.25 gal/sk. shut down drop top plug, displaces w/ 395 bbl water bumped plug w/ 2200 psi 500 over, hold for 5 mins, bleed off 3 bbls back, floats held (bumped plug @ 22:13) Got 220 bbl cmt to surface. WOC 11.5 hrs. RD Halliburton.

08/29/19: Test casing to 1320 PSI. Held for 30 min. Good test. Drill ahead.

09/10/19: Hole sz 8.75. Production casing: MU shoe (1.80') 2 jts csg (94.68') FC (1.50'), Marker jt (18.58') NOV burst sub (2.0') 1 jt csg (46.94') #2 Burst sub (2.0') 1 jt csg (43.35') #3 Burst sub. Run 113 jts 5 1/2 DWC/C-IS csg (5303.63') 1 marker jt (23.33') 1 jt of csg (47.24') 2nd marker jt (21.89') Run 130 jts 5 1/2 DWC/C-IS csg t/16970' (set depth). Pump 60 bbl. Tuned spacer @ 10.5 ppg Lead cmt: 715 sks (353 bbl) @ 11.0 ppg. yield 2.77, water 16.37gps. Tail cmt: 1650 sks. (423 bbl) @ 13.2 ppg yield 1.44, water 7.25 gps shut down, wash lines, drop top plug, displaces w/ 374 bbl KCL water (1st 20 bbl sugar) bumped plug 500 psi over @ 2800 psi held 5 min bleed off got 4 bbl back, floats held, lost returns at 290 bbls of displacement. Final pressure 2200 psi @ 3 bpm. WOC to achieve 100 psi compressive strength.

09/11/19: Install night cap; well secured. Drilling RR @ 04:00 hrs.

12/20/19: Opened well to perform production casing integrity test to 5950 psi for 30 min. Dropped 134 psi. Good test.

Submit 1 Copy To Appropriate District Office

District I – (575) 393-6161
1625 N. French Dr., Hobbs, NM 88240
District II – (575) 748-1283
811 S. First St., Artesia, NM 88210
District III – (505) 334-6178
1000 Rio Brazos Rd., Aztec, NM 87410
District IV – (505) 476-3460
1220 S. St. Francis Dr., Santa Fe, NM 87505

State of New Mexico
Energy, Minerals and Natural Resources

OIL CONSERVATION DIVISION
1220 South St. Francis Dr.
Santa Fe, NM 87505

Form C-103
Revised July 18, 2013

WELL API NO. 30-025-46282
5. Indicate Type of Lease STATE <input type="checkbox"/> FEE <input checked="" type="checkbox"/>
6. State Oil & Gas Lease No.
7. Lease Name or Unit Agreement Name LEO THORSNESS 13 24 33 AR
8. Well Number 135H
9. OGRID Number 228937
10. Pool name or Wildcat RED HILLS; BONE SPRING, NORTH

SUNDRY NOTICES AND REPORTS ON WELLS
(DO NOT USE THIS FORM FOR PROPOSALS TO DRILL OR TO DEEPEN OR PLUG BACK TO A DIFFERENT RESERVOIR. USE "APPLICATION FOR PERMIT" (FORM C-101) FOR SUCH PROPOSALS.)

1. Type of Well: Oil Well ☒ Gas Well ☐ Other

2. Name of Operator
MATADOR PRODUCTION COMPANY

3. Address of Operator
5400 LBJ FREEWAY, STE 1500, DALLAS, TX 75240

4. Well Location
Unit Letter A : 569 feet from the S line and 35 feet from the E line
Section 14 Township 24S Range 33E NMPM County LEA

11. Elevation (Show whether DR, RKB, RT, GR, etc.)
3602' GR

12. Check Appropriate Box to Indicate Nature of Notice, Report or Other Data

NOTICE OF INTENTION TO:

PERFORM REMEDIAL WORK ☐ PLUG AND ABANDON ☐
TEMPORARILY ABANDON ☐ CHANGE PLANS ☐
PULL OR ALTER CASING ☐ MULTIPLE COMPL ☐
DOWNHOLE COMMINGLE ☐
CLOSED-LOOP SYSTEM ☐
OTHER: ☐

SUBSEQUENT REPORT OF:

REMEDIAL WORK ☐ ALTERING CASING ☐
COMMENCE DRILLING OPNS. ☐ P AND A ☐
CASING/CEMENT JOB ☐
OTHER: Perforate, fracture treat, produce ☒

13. Describe proposed or completed operations. (Clearly state all pertinent details, and give pertinent dates, including estimated date of starting any proposed work). SEE RULE 19.15.7.14 NMAC. For Multiple Completions: Attach wellbore diagram of proposed completion or recompletion. TVD/MD:12073'/16987'

12/20/19 Open well to test casing for 30 min to 5950 psi. Drop 134 psi. Good test. WSI awaiting frac ops.
01/07/20 Perforate and fracture treat Bone Spring formation 12157' - 16851' w/12,229,360 lbs sand in 25 stages.
01/24/20 Well secured and SI awaiting drillout.
03/03/20 Milling plugs 24 - 1. Well secured and SI awaiting flowback.
03/08/20 Flowback ops begin.
03/09/20 Well begins to produce.

*Requesting tubing exception to delay installation in order for well to clean up after fracture treatment and pressure to subside in order to safely install tubing.

Spud Date:

08/24/19

Rig Release Date:

09/11/19

I hereby certify that the information above is true and complete to the best of my knowledge and belief.

SIGNATURE Ava Monroe TITLE Sr Regulatory Analyst DATE 4/23/20

Type or print name Ava Monroe E-mail address: amonroe@matadorresources.com PHONE: 972-371-5218

For State Use Only

APPROVED BY: Patricia Martinez TITLE LM DATE 04/28/2020

Conditions of Approval (if any):

Submit To Appropriate District Office Two Copies District I 1625 N. French Dr., Hobbs, NM 88240 District II 811 S. First St., Artesia, NM 88210 District III 1000 Rio Brazos Rd., Aztec, NM 87410 District IV 1220 S. St. Francis Dr., Santa Fe, NM 87505	State of New Mexico Energy, Minerals and Natural Resources Oil Conservation Division 1220 South St. Francis Dr. Santa Fe, NM 87505	Form C-105 Revised April 3, 2017 1. WELL API NO. 30-025-46282 2. Type of Lease <input type="checkbox"/> STATE <input checked="" type="checkbox"/> FEE <input type="checkbox"/> FED/INDIAN 3. State Oil & Gas Lease No.								
WELL COMPLETION OR RECOMPLETION REPORT AND LOG										
4. Reason for filing: <input checked="" type="checkbox"/> COMPLETION REPORT (Fill in boxes #1 through #31 for State and Fee wells only) <input type="checkbox"/> C-144 CLOSURE ATTACHMENT (Fill in boxes #1 through #9, #15 Date Rig Released and #32 and/or #33; attach this and the plat to the C-144 closure report in accordance with 19.15.17.13.K NMAC)		5. Lease Name or Unit Agreement Name LEO THORSNESS 13 24 33 AR 6. Well Number: 135H								
OCD - HOBBS 04/28/2020 RECEIVED										
7. Type of Completion: <input checked="" type="checkbox"/> NEW WELL <input type="checkbox"/> WORKOVER <input type="checkbox"/> DEEPENING <input type="checkbox"/> PLUGBACK <input type="checkbox"/> DIFFERENT RESERVOIR <input type="checkbox"/> OTHER		9. OGRID 228937								
8. Name of Operator MATADOR PRODUCTION COMPANY 10. Address of Operator 5400 LBJ FREEWAY, STE 1500, DALLAS TX 75240		11. Pool name or Wildcat RED HILLS; BONE SPRING, NORTH (96434)								
12. Location	Unit Ltr	Section	Township	Range	Lot	Feet from the	N/S Line	Feet from the	E/W Line	County
Surface:	A	14	24S	33E		569	S	35	E	LEA
BH:	M	14	24S	33E		49	S	1000	W	LEA
13. Date Spudded 08/24/19	14. Date T.D. Reached 09/06/19	15. Date Rig Released 09/11/19		16. Date Completed (Ready to Produce) 03/09/20		17. Elevations (DF and RKB, RT, GR, etc.) 3602' GR				
18. Total Measured Depth of Well 12073'/16987'		19. Plug Back Measured Depth 16970'		20. Was Directional Survey Made? Y		21. Type Electric and Other Logs Run GAMMA				
22. Producing Interval(s), of this completion - Top, Bottom, Name 12157' - 16851' Bone Spring							*Cement in hole 16987' - 16970'			
23. CASING RECORD (Report all strings set in well)										
CASING SIZE		WEIGHT LB./FT.		DEPTH SET		HOLE SIZE		CEMENTING RECORD		AMOUNT PULLED
SURF: 13.375		J55 54.5#		1377'		17.5		1355 1.36 C		0
INT: 9.625		J55 40.0#		5307'		12.25		1735 1.35 C		0
PROD: 5.5		P110 20.0#		16970'		8.75		2665 1.44 H		0
24. LINER RECORD										
SIZE	TOP	BOTTOM	SACKS CEMENT	SCREEN		25. TUBING RECORD				
N/A						SIZE DEPTH SET PACKER SET				
26. Perforation record (interval, size, and number) 12157' - 16851'; 25 stages, 8 clusters per; 8 holes per @ 0.40"						27. ACID, SHOT, FRACTURE, CEMENT, SQUEEZE, ETC. DEPTH INTERVAL AMOUNT AND KIND MATERIAL USED 12157' - 16851' 12,229,360 lbs sand; fracture treat.				
28. PRODUCTION										
Date First Production 03/09/20		Production Method (Flowing, gas lift, pumping - Size and type pump) FLOWING				Well Status (Prod. or Shut-in) PROD.				
Date of Test 03/15/20	Hours Tested 24	Choke Size 40/64	Prod'n For Test Period	Oil - Bbl 1268	Gas - MCF 2924	Water - Bbl. 4794	Gas - Oil Ratio 2306			
Flow Tubing Press. ---	Casing Pressure 1640	Calculated 24-Hour Rate	Oil - Bbl. 1268	Gas - MCF 2924	Water - Bbl. 4794	Oil Gravity - API - (Corr.) 45.84				
29. Disposition of Gas (Sold, used for fuel, vented, etc.) SOLD							30. Test Witnessed By Daniel Garza			
31. List Attachments DS, C-102 & PLAT, LOG										
32. If a temporary pit was used at the well, attach a plat with the location of the temporary pit.							33. Rig Release Date:			
34. If an on-site burial was used at the well, report the exact location of the on-site burial:										
Latitude Longitude NAD83										
I hereby certify that the information shown on both sides of this form is true and complete to the best of my knowledge and belief										
Signature 		Printed Name Ava Monroe		Title Sr. Regulatory Analyst		Date 04/28/20				
E-mail Address amonroe@matadorresources.com										

INSTRUCTIONS

This form is to be filed with the appropriate District Office of the Division not later than 20 days after the completion of any newly-drilled or deepened well and not later than 60 days after completion of closure. When submitted as a completion report, this shall be accompanied by one copy of all electrical and radio-activity logs run on the well and a summary of all special tests conducted, including drill stem tests. All depths reported shall be measured depths. In the case of directionally drilled wells, true vertical depths shall also be reported. For multiple completions, items 11, 12 and 26-31 shall be reported for each zone.

INDICATE FORMATION TOPS IN CONFORMANCE WITH GEOGRAPHICAL SECTION OF STATE

Southeastern New Mexico		Northwestern New Mexico	
T. Anhy	T. Canyon	T. Ojo Alamo	T. Penn A"
T. Salt 1799/1800	T. Strawn	T. Kirtland	T. Penn. "B"
B. Salt 5144/5172	T. Atoka	T. Fruitland	T. Penn. "C"
T. Yates	T. Miss	T. Pictured Cliffs	T. Penn. "D"
T. 7 Rivers	T. Devonian	T. Cliff House	T. Leadville
T. Queen	T. Silurian	T. Menefee	T. Madison
T. Grayburg	T. Montoya	T. Point Lookout	T. Elbert
T. San Andres	T. Simpson	T. Mancos	T. McCracken
T. Glorieta	T. McKee	T. Gallup	T. Ignacio Otzte
T. Paddock	T. Ellenburger	Base Greenhorn	T. Granite
T. Blinébry	T. Gr. Wash	T. Dakota	
T. Tubb	T. Delaware Sand 5182/5210	T. Morrison	
T. Drinkard	T. Bone Springs 8994/9051	T. Todilto	
T. Abo	T.	T. Entrada	
T. Wolfcamp	T.	T. Wingate	
T. Penn	T.	T. Chinle	
T. Cisco (Bough C)	T.	T. Permian	

OIL OR GAS SANDS OR ZONES

No. 1, from.....to.....
No. 2, from.....to.....

No. 3, from.....to.....
No. 4, from.....to.....

IMPORTANT WATER SANDS

Include data on rate of water inflow and elevation to which water rose in hole.

No. 1, from.....to.....feet.....

No. 2, from.....to.....feet.....

No. 3, from.....to.....feet.....

LITHOLOGY RECORD (Attach additional sheet if necessary)

From	To	Thickness In Feet	Lithology

District I
1625 N. French Dr., Hobbs, NM 88240
District II
811 S. First St., Artesia, NM 88210
District III
1000 Rio Brazos Rd., Aztec, NM 87410
District IV
1220 S. St. Francis Dr., Santa Fe, NM 87505

State of New Mexico
Energy, Minerals & Natural Resources

Form C-104
Revised August 1, 2011

Oil Conservation Division
1220 South St. Francis Dr.
Santa Fe, NM 87505

Submit one copy to appropriate District Office

☐ AMENDED REPORT

I. REQUEST FOR ALLOWABLE AND AUTHORIZATION TO TRANSPORT

¹ Operator name and Address MATADOR PRODUCTION COMPANY 5400 LBJ FREEWAY STE 1500, DALLAS, TX 75240		² OGRID Number 228937
		³ Reason for Filing Code/ Effective Date NW
⁴ API Number 30 - 0 25-46282	⁵ Pool Name RED HILLS; BONE SPRING, NORTH	⁶ Pool Code 96434
⁷ Property Code 326014	⁸ Property Name LEO THORSNESS 13 24 33 AR	⁹ Well Number 135H

OCD - HOBBS
04/28/2020
RECEIVED

Kz

II. ¹⁰ Surface Location

Ul or lot no.	Section	Township	Range	Lot Idn	Feet from the	North/South Line	Feet from the	East/West line	County
A	14	24S	33E		569	N	35	E	LEA

¹¹ Bottom Hole Location

UL or lot no.	Section	Township	Range	Lot Idn	Feet from the	North/South line	Feet from the	East/West line	County
M	13	24S	33E		49	S	1,000	W	LEA

¹² Lse Code P	¹³ Producing Method Code F	¹⁴ Gas Connection Date 03/09/20	¹⁵ C-129 Permit Number	¹⁶ C-129 Effective Date	¹⁷ C-129 Expiration Date
-----------------------------	------------------------------------------	-----------------------------------------------	-----------------------------------	------------------------------------	-------------------------------------

III. Oil and Gas Transporters

¹⁸ Transporter OGRID	¹⁹ Transporter Name and Address	²⁰ O/G/W
248440	Western Refining, L.P. 123 West Mills Avenue, El Paso, TX 79901	O
371960	Lucid Energy Delaware, LLC 3100 McKinnon St., #800, Dallas, TX 75201	G

IV. Well Completion Data *Cement in hole 16987' - 16970'

²¹ Spud Date 08/24/19	²² Ready Date 03/09/20	²³ TD 12073'/16987'	²⁴ PBTB 16970'	²⁵ Perforations 12157' - 16851'	²⁶ DHC, MC ---
²⁷ Hole Size		²⁸ Casing & Tubing Size	²⁹ Depth Set		³⁰ Sacks Cement
Surf: 17.5		13.375 J55 54.5#	1377'		1355 1.36 C
Int: 12.25		9.625 J55 40.0#	5307'		1735 1.35 C
Prod:8.75		5.5 P110 20.0#	16970'		2665 1.44 H

V. Well Test Data

³¹ Date New Oil 03/09/20	³² Gas Delivery Date 03/09/20	³³ Test Date 03/15/20	³⁴ Test Length 24 hrs	³⁵ Tbg. Pressure ---	³⁶ Csg. Pressure 1640
³⁷ Choke Size 40/64	³⁸ Oil 1268	³⁹ Water 4794	⁴⁰ Gas 2924		⁴¹ Test Method Flowing

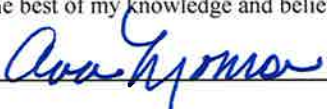
⁴² I hereby certify that the rules of the Oil Conservation Division have been complied with and that the information given above is true and complete to the best of my knowledge and belief. Signature: 		OIL CONSERVATION DIVISION	
Printed name: Ava Monroe		Approved by: Patricia Martinez	
Title: Sr. Regulatory Analyst		Title: LM	
E-mail Address: amonroe@matadorresources.com		Approval Date: 05/11/2020	
Date: 4/28/20	Phone: 972-371-5218		