

LEASE NAME & WELL NO.: DAUNTLESS 7 FED COM 715H
SECTION 7 TWP 25-S RGE 33-E SURVEY N.M.P.M.
COUNTY LEA STATE NM ELEVATION 3492'
DESCRIPTION 250' FSL & 629' FWL

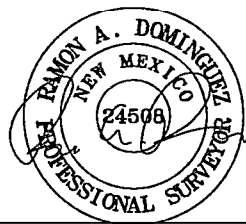

ecog resources, inc.



Ramon A. Dominguez, P.S. No. 24508
AUGUST 27, 2020

DAUNTLESS 7 FED COM 715H AS-COMPLETED	REVISION:	NOTES:
DATE: 08/27/20		1. ORIGINAL DOCUMENT SIZE: 8.5" X 14"
FILE: AD_DAUNTLESS_7_FED_COM_715H		2. ALL BEARINGS, DISTANCES, AND COORDINATE VALUES CONTAINED HEREIN ARE GRID BASED UPON THE NEW MEXICO COORDINATE SYSTEM, EAST ZONE, U.S. SURVEY FEET, NORTH AMERICAN DATUM 1983.
DRAWN BY: GJU		3. THIS WELL LOCATION SHOWN HEREON HAS BEEN SURVEYED ON THE GROUND UNDER MY SUPERVISION AND PREPARED ACCORDING TO THE EVIDENCE FOUND AT THE TIME OF SURVEY, AND DATA PROVIDED BY EOG RESOURCES, INC. THIS CERTIFICATION IS MADE AND LIMITED TO THOSE PERSONS OR ENTITIES SHOWN ON THE FACE OF THIS PLAT AND IS NON-TRANSFERABLE. THIS SURVEY IS CERTIFIED FOR THIS TRANSACTION ONLY.
SHEET: 1 OF 1		

Intent ☐ As Drilled ☐ XXXAPI #
30-025-46622Operator Name:
EOG RESOURCES, INCProperty Name:
DAUNTLESS 7 FEDERALWell Number
715H

Kick Off Point (KOP)

UL M	Section 7	Township 25S	Range 33E	Lot	Feet 45	From N/S SOUTH	Feet 947	From E/W WEST	County LEA
Latitude 32.1379838					Longitude 103.6168295			NAD 1983	

First Take Point (FTP)

UL M	Section 7	Township 25S	Range 33E	Lot	Feet 393	From N/S SOUTH	Feet 954	From E/W WEST	County LEA
Latitude 32.1389408					Longitude 103.6168052			NAD 1983	

Last Take Point (LTP)

UL D	Section 6	Township 25S	Range 33E	Lot	Feet 136	From N/S NORTH	Feet 960	From E/W WEST	County LEA
Latitude 32.1665154					Longitude 103.6167287			NAD 1983	

Is this well the defining well for the Horizontal Spacing Unit?

☐ NO

Is this well an infill well?

☐ YES

If infill is yes please provide API if available, Operator Name and well number for Defining well for Horizontal Spacing Unit.

API #
30-025-46619Operator Name:
EOG RESOURCES, INCProperty Name:
DAUNTLESS 7 FEDERALWell Number
#742H

KZ



EOG Resources - Midland

Lea County, NM (NAD 83 NME)

Dauntless 7 Fed

#715H

OH

Design: OH

Midland PVA

25 January, 2020



Midland PVA

Company:	EOG Resources - Midland	Local Co-ordinate Reference:	Well #715H
Project:	Lea County, NM (NAD 83 NME)	TVD Reference:	KB = 25 @ 3516.0usft
Site:	Dauntless 7 Fed	MD Reference:	KB = 25 @ 3516.0usft
Well:	#715H	North Reference:	Grid
Wellbore:	OH	Survey Calculation Method:	Minimum Curvature
Design:	OH	Database:	EDM

Project:	Lea County, NM (NAD 83 NME)		
Map System:	US State Plane 1983	System Datum:	Mean Sea Level
Geo Datum:	North American Datum 1983		
Map Zone:	New Mexico Eastern Zone		

Site:	Dauntless 7 Fed		
Site Position:		Northing:	414,874.00 usft
From:	Map	Easting:	762,795.00 usft
Position Uncertainty:	0.0 usft	Slot Radius:	13-3/16 "
		Latitude:	32° 8' 18.763 N
		Longitude:	103° 37' 4.285 W
		Grid Convergence:	0.38 "

Well	#715H					
Well Position	+N-S	0.0 usft	Northing:	414,874.00 usft	Latitude:	32° 8' 18.763 N
	+E-W	0.0 usft	Easting:	762,795.00 usft	Longitude:	103° 37' 4.285 W
Position Uncertainty	0.0 usft	Wellhead Elevation:	usft	Ground Level:	3,491.0 usft	

Wellbore:	OH				
Magnetics	Model Name	Sample Date	Declination (°)	Dip Angle (°)	Field Strength (nT)
	IGRF2015	2/1/2020	6.68	59.94	47,612.27632961

Design:	OH				
Audit Notes:					
Version:	1.0	Phase:	ACTUAL	Tie On Depth:	0.0
Vertical Section:	Depth From (TVD) (usft)	+N-S (usft)	+E-W (usft)	Direction (°)	
	0.0	0.0	0.0	1.75	

Survey Program	Date	1/25/2020		
From (usft)	To (usft)	Survey (Wellbore)	Tool Name	Description
225.0	22,598.0	Driltech MWD (OH)	EOG MWD+IFR1	MWD + IFR1



Midland PVA

Company: EOG Resources - Midland
 Project: Lea County, NM (NAD 83 NME)
 Site: Dauntless 7 Fed
 Well: #715H
 Wellbore: OH
 Design: OH

Local Co-ordinate Reference: Well #715H
 TVD Reference: KB = 25 @ 3516.0usft
 MD Reference: KB = 25 @ 3516.0usft
 North Reference: Grid
 Survey Calculation Method: Minimum Curvature
 Database: EDM

MD (usft)	Inc (°)	Azi (azimuth) (°)	TVD (usft)	N/S (usft)	E/W (usft)	DLeg (°/100usft)	Build (°/100usft)	Turn (°/100usft)	High to Plan (usft)	Right to Plan (usft)
0.0	0.00	0.00	0.0	0.0	0.0	0.00	0.00	0.00	0.0	0.0
225.0	0.79	352.30	225.0	1.5	-0.2	0.35	0.35	0.00	-1.6	0.0
314.0	0.79	293.07	314.0	2.4	-0.9	0.88	0.00	-66.55	-1.7	-1.9
402.0	0.97	286.30	402.0	2.8	-2.1	0.24	0.20	-7.69	-2.8	-2.1
492.0	1.06	287.18	492.0	3.3	-3.7	0.10	0.10	0.98	-4.5	-2.1
580.0	1.06	293.68	579.9	3.9	-5.2	0.14	0.00	7.39	-6.3	-1.5
677.0	1.14	291.92	676.9	4.6	-6.9	0.09	0.08	-1.81	-8.1	-1.7
772.0	1.23	285.59	771.9	5.2	-8.8	0.17	0.09	-6.66	-9.8	-2.7
866.0	1.23	282.34	865.9	5.7	-10.7	0.07	0.00	-3.46	-11.7	-3.3
960.0	1.23	273.20	959.9	6.0	-12.7	0.21	0.00	-9.72	-13.0	-5.2
1,053.0	1.49	278.12	1,052.8	6.2	-14.9	0.31	0.28	5.29	-15.6	-4.0
1,123.0	1.76	283.57	1,122.8	6.6	-16.8	0.44	0.39	7.79	-17.9	-2.4
1,242.0	1.85	283.57	1,241.8	7.5	-20.5	0.08	0.08	0.00	-21.7	-2.4
1,336.0	1.85	287.18	1,335.7	8.3	-23.4	0.12	0.00	3.84	-24.8	-1.0
1,431.0	1.93	147.52	1,430.7	7.4	-24.0	3.73	0.08	-147.01	19.1	-16.3
1,525.0	4.31	126.16	1,524.5	3.9	-20.3	2.78	2.53	-22.72	18.8	-8.8
1,620.0	3.96	126.69	1,619.3	-0.1	-14.8	0.37	-0.37	0.56	14.2	-9.3
1,714.0	6.60	109.20	1,712.9	-3.8	-7.1	3.26	2.81	-18.61	13.2	-4.7
1,809.0	6.33	107.62	1,807.3	-7.2	3.1	0.34	-0.28	-1.66	11.1	-2.9
1,904.0	6.42	106.56	1,901.7	-10.3	13.1	0.16	0.09	-1.12	10.3	-0.7
1,999.0	6.51	104.98	1,996.1	-13.2	23.4	0.21	0.09	-1.66	9.2	1.8
2,093.0	6.24	104.89	2,089.5	-15.9	33.5	0.29	-0.29	-0.10	8.3	4.1
2,188.0	6.07	103.40	2,184.0	-18.4	43.4	0.25	-0.18	-1.57	7.6	6.8
2,283.0	5.89	102.78	2,278.4	-20.7	53.0	0.20	-0.19	-0.65	7.2	9.5
2,377.0	5.80	99.00	2,372.0	-22.5	62.4	0.42	-0.10	-4.02	6.3	12.9
2,472.0	6.42	109.90	2,466.4	-25.0	72.2	1.38	0.65	11.47	8.4	13.9
2,567.0	6.42	108.85	2,560.8	-28.5	82.2	0.12	0.00	-1.11	7.3	15.6



Midland PVA

Company:	EOG Resources - Midland	Local Co-ordinate Reference:	Well #715H
Project:	Lea County, NM (NAD 83 NME)	TVD Reference:	KB = 25 @ 3516.0usft
Site:	Dauntless 7 Fed	MD Reference:	KB = 25 @ 3516.0usft
Well:	#715H	North Reference:	Grid
Wellbore:	OH	Survey Calculation Method:	Minimum Curvature
Design:	OH	Database:	EDM

Survey											
MD (usft)	Inc (°)	Azi (azimuth) (°)	TVD (usft)	N/S (usft)	E/W (usft)	DLeg (°/100usft)	Build (°/100usft)	Turn (°/100usft)	High to Plan (usft)	Right to Plan (usft)	
2,662.0	6.24	107.00	2,655.2	-31.8	92.1	0.29	-0.19	-1.95	6.0	17.7	
2,757.0	6.24	105.95	2,749.7	-34.7	102.0	0.12	0.00	-1.11	5.0	19.9	
2,852.0	7.65	120.62	2,844.0	-39.3	112.5	2.37	1.48	15.44	8.5	18.9	
2,947.0	7.56	118.34	2,938.2	-45.5	123.4	0.33	-0.09	-2.40	5.0	19.0	
3,042.0	7.21	116.23	3,032.4	-51.1	134.2	0.47	-0.37	-2.22	2.0	19.4	
3,137.0	7.39	114.12	3,126.6	-56.3	145.2	0.34	0.19	-2.22	-0.9	20.0	
3,232.0	7.30	112.98	3,220.8	-61.1	156.3	0.18	-0.09	-1.20	-3.5	20.8	
3,327.0	7.03	111.66	3,315.1	-65.6	167.3	0.33	-0.28	-1.39	-6.0	21.8	
3,421.0	6.86	110.25	3,408.4	-69.7	177.9	0.26	-0.18	-1.50	-8.2	22.9	
3,516.0	6.42	109.73	3,502.8	-73.4	188.2	0.47	-0.46	-0.55	-9.6	24.3	
3,611.0	7.03	130.20	3,597.1	-79.0	197.6	2.59	0.64	21.55	-1.6	25.9	
3,706.0	6.60	130.82	3,691.4	-86.3	206.2	0.46	-0.45	0.65	-2.9	23.9	
3,801.0	6.24	128.27	3,785.8	-93.1	214.4	0.48	-0.38	-2.68	-4.8	21.8	
3,895.0	6.33	114.30	3,879.3	-98.4	223.1	1.63	0.10	-14.86	-10.3	19.5	
3,990.0	5.63	114.82	3,973.8	-102.5	232.1	0.74	-0.74	0.55	-10.1	20.3	
4,085.0	4.92	111.31	4,068.4	-105.9	240.2	0.82	-0.75	-3.69	-10.2	20.6	
4,180.0	4.22	109.20	4,163.1	-108.5	247.2	0.76	-0.74	-2.22	-8.7	21.7	
4,274.0	5.19	118.87	4,256.7	-111.7	254.2	1.33	1.03	10.29	-2.8	23.4	
4,369.0	6.33	118.07	4,351.3	-116.3	262.6	1.20	1.20	-0.84	-2.7	23.4	
4,464.0	6.07	117.81	4,445.7	-121.1	271.7	0.28	-0.27	-0.27	-3.2	23.5	
4,559.0	6.60	120.71	4,540.1	-126.2	280.8	0.65	0.56	3.05	-2.6	23.5	
4,654.0	7.65	124.32	4,634.4	-132.6	290.7	1.20	1.11	3.80	-3.0	22.9	
4,748.0	8.62	126.16	4,727.4	-140.3	301.6	1.07	1.03	1.96	-5.9	21.9	
4,843.0	7.56	125.11	4,821.5	-148.0	312.5	1.13	-1.12	-1.11	-9.8	20.6	
4,938.0	6.42	125.46	4,915.8	-154.7	321.9	1.20	-1.20	0.37	-11.4	19.5	
5,033.0	5.45	124.84	5,010.3	-160.4	329.9	1.02	-1.02	-0.65	-11.5	18.2	
5,128.0	5.28	124.84	5,104.9	-165.5	337.2	0.18	-0.18	0.00	-10.6	17.1	



Midland PVA

Company: EOG Resources - Midland
 Project: Lea County, NM (NAD 83 NME)
 Site: Dauntless 7 Fed
 Well: #715H
 Wellbore: OH
 Design: OH

Local Co-ordinate Reference: Well #715H
 TVD Reference: KB = 25 @ 3516.0usft
 MD Reference: KB = 25 @ 3516.0usft
 North Reference: Grid
 Survey Calculation Method: Minimum Curvature
 Database: EDM

MD (usft)	Inc (°)	Azi (azimuth) (°)	TVD (usft)	N/S (usft)	E/W (usft)	DLeg (°/100usft)	Build (°/100usft)	Turn (°/100usft)	High to Plan (usft)	Right to Plan (usft)
5,223.0	2.20	121.85	5,199.7	-168.9	342.4	3.25	-3.24	-3.15	-7.7	15.7
5,318.0	4.57	119.83	5,294.5	-171.8	347.2	2.50	2.49	-2.13	-3.9	15.2
5,413.0	4.31	117.64	5,389.2	-175.3	353.6	0.33	-0.27	-2.31	-1.9	15.0
5,507.0	3.96	115.88	5,482.9	-178.4	359.7	0.40	-0.37	-1.87	0.1	15.3
5,602.0	3.96	115.97	5,577.7	-181.2	365.6	0.01	0.00	0.09	0.0	15.6
5,697.0	3.69	116.14	5,672.5	-184.0	371.3	0.28	-0.28	0.18	-3.1	15.7
5,792.0	3.52	115.44	5,767.3	-186.6	376.7	0.18	-0.18	-0.74	-8.8	15.7
5,886.0	2.02	116.23	5,861.2	-188.6	380.7	1.60	-1.60	0.84	-13.1	15.8
5,981.0	1.32	112.19	5,956.2	-189.7	383.3	0.75	-0.74	-4.25	-16.9	14.8
6,076.0	1.23	108.85	6,051.1	-190.5	385.2	0.12	-0.09	-3.52	-19.9	13.7
6,171.0	1.06	110.25	6,146.1	-191.1	387.0	0.18	-0.18	1.47	-21.4	14.2
6,265.0	1.06	114.38	6,240.1	-191.8	388.6	0.08	0.00	4.39	-22.1	15.8
6,360.0	1.06	112.01	6,335.1	-192.5	390.2	0.05	0.00	-2.49	-24.5	14.8
6,455.0	0.97	99.88	6,430.1	-192.9	391.9	0.24	-0.09	-12.77	-28.7	9.1
6,550.0	0.97	95.57	6,525.1	-193.1	393.4	0.08	0.00	-4.54	-30.9	6.9
6,645.0	0.79	97.68	6,620.1	-193.3	394.9	0.19	-0.19	2.22	-32.1	8.1
6,834.0	0.44	115.88	6,809.0	-193.8	396.8	0.21	-0.19	9.63	-29.9	18.1
6,929.0	0.26	138.90	6,904.0	-194.1	397.3	0.24	-0.19	24.23	-21.0	28.5
7,023.0	0.18	143.48	6,998.0	-194.4	397.5	0.09	-0.09	4.87	-19.1	30.1
7,118.0	0.09	187.77	7,093.0	-194.6	397.6	0.14	-0.09	46.62	7.2	35.0
7,308.0	0.44	261.16	7,283.0	-194.9	396.9	0.22	0.18	38.63	34.8	3.2
7,403.0	0.53	264.13	7,378.0	-195.0	396.1	0.10	0.09	3.13	34.1	1.5
7,543.3	0.71	245.04	7,518.4	-195.4	394.6	0.20	0.13	-13.60	30.3	12.3
Brushy Top(DL 7 Fed #715H)										
7,592.0	0.79	240.68	7,567.0	-195.7	394.1	0.20	0.16	-8.97	28.6	14.6
7,687.0	0.70	239.54	7,662.0	-196.3	393.0	0.10	-0.09	-1.20	27.1	15.1
7,782.0	0.79	236.55	7,757.0	-197.0	392.0	0.10	0.09	-3.15	25.0	16.5



Midland PVA

Company:	EOG Resources - Midland	Local Co-ordinate Reference:	Well #715H
Project:	Lea County, NM (NAD 83 NME)	TVD Reference:	KB = 25 @ 3516.0usft
Site:	Dauntless 7 Fed	MD Reference:	KB = 25 @ 3516.0usft
Well:	#715H	North Reference:	Grid
Wellbore:	OH	Survey Calculation Method:	Minimum Curvature
Design:	OH	Database:	EDM

Survey											
MD (usft)	Inc (°)	Azi (azimuth) (°)	TVD (usft)	N/S (usft)	E/W (usft)	DLeg (°/100usft)	Build (°/100usft)	Turn (°/100usft)	High to Plan (usft)	Right to Plan (usft)	
7,877.0	0.88	237.69	7,852.0	-197.7	390.8	0.10	0.09	1.20	24.0		16.0
7,972.0	0.88	249.65	7,947.0	-198.3	389.5	0.19	0.00	12.59	25.3		10.8
8,067.0	1.14	72.37	8,042.0	-198.3	389.7	2.13	0.27	-186.61	-26.0		-9.6
8,162.0	1.06	246.66	8,137.0	-198.4	389.8	2.31	-0.08	183.46	25.0		12.3
8,257.0	0.79	250.00	8,232.0	-198.9	388.4	0.29	-0.28	3.52	24.1		10.9
8,446.0	0.79	240.33	8,420.9	-200.0	386.0	0.07	0.00	-5.12	19.4		14.5
8,541.0	0.97	244.11	8,515.9	-200.7	384.7	0.20	0.19	3.98	18.8		13.3
8,636.0	1.14	242.88	8,610.9	-201.5	383.2	0.18	0.18	-1.29	16.8		13.7
8,731.0	1.23	242.88	8,705.9	-202.4	381.4	0.09	0.09	0.00	14.8		13.7
8,825.0	1.32	240.15	8,799.9	-203.4	379.6	0.12	0.10	-2.90	12.1		14.3
8,920.0	1.23	244.20	8,894.8	-204.4	377.7	0.13	-0.09	4.26	10.9		13.5
9,015.0	1.23	240.68	8,989.8	-205.3	375.9	0.08	0.00	-3.71	8.0		14.1
9,109.0	0.97	235.15	9,083.8	-206.3	374.4	0.30	-0.28	-5.88	4.9		14.7
9,204.0	1.14	243.76	9,178.8	-207.1	372.9	0.24	0.18	9.06	5.3		13.9
9,299.0	1.14	252.99	9,273.8	-207.8	371.1	0.19	0.00	9.72	5.5		13.0
9,394.0	0.97	239.89	9,368.8	-208.5	369.5	0.31	-0.18	-13.79	0.7		13.7
9,489.0	1.06	260.02	9,463.7	-209.1	368.0	0.38	0.09	21.19	3.8		12.9
9,574.0	1.23	262.92	9,548.7	-209.3	366.3	0.21	0.20	3.41	2.7		12.8
9,669.0	0.62	310.82	9,643.7	-209.1	364.9	0.98	-0.64	50.42	10.1		7.3
9,764.0	0.88	321.10	9,738.7	-208.2	364.0	0.31	0.27	10.82	10.0		5.5
9,858.0	1.14	327.34	9,832.7	-206.9	363.1	0.30	0.28	6.64	8.9		4.4
9,953.0	1.14	334.37	9,927.7	-205.2	362.2	0.15	0.00	7.40	7.5		3.4
10,048.0	0.62	1.00	10,022.7	-203.9	361.8	0.68	-0.55	28.03	6.9		0.1
10,143.0	0.70	329.72	10,117.7	-202.8	361.5	0.38	0.08	-32.93	4.8		3.4
10,237.0	1.23	313.28	10,211.6	-201.6	360.4	0.63	0.56	-17.49	2.1		4.5
10,332.0	0.79	297.20	10,306.6	-200.7	359.1	0.55	-0.46	-16.93	-0.9		4.6
10,427.0	0.53	276.72	10,401.6	-200.3	358.1	0.37	-0.27	-21.56	-3.5		3.7



Midland PVA

Company: EOG Resources - Midland
Project: Lea County, NM (NAD 83 NME)
Site: Dainless 7 Fed
Well: #715H
Wellbore: OH
Design: OH

Local Co-ordinate Reference:
Well #715H
KB = 25 @ 3516.0usft
KB = 25 @ 3516.0usft
Grid
Minimum Curvature
EDM

Survey Calculation Method:
North Reference:
MID Reference:
TVD Reference:
Database:

Survey										
MD	Inc	Azi (azimuth)	TVD	N/S	EW	Dleg	Build	Turn	High to Plan	Right to Plan
(usft)	(°)		(usft)		(usft)	(°/100usft)	(°/100usft)	(°/100usft)	(usft)	(usft)
10,522.0	0.88	278.83	10,496.6	-200.1	356.9	0.37	0.37	2.22	-4.5	3.9
10,617.0	0.88	276.72	10,591.6	-199.9	356.5	0.03	0.00	-2.22	-6.1	3.7
10,712.0	0.53	277.95	10,686.6	-199.8	354.3	0.37	-0.37	1.29	-7.2	3.8
10,806.0	0.62	261.95	10,780.6	-199.8	353.4	0.19	0.10	-17.02	-8.9	1.6
10,901.0	1.76	287.18	10,875.6	-199.4	351.5	1.29	1.20	26.56	-9.3	5.4
10,996.0	2.46	301.24	10,970.5	-198.0	348.4	0.91	0.74	14.80	-11.2	7.9
11,091.0	1.85	307.74	11,065.4	-196.0	345.4	0.69	-0.64	6.84	-13.8	9.3
11,186.0	1.49	300.62	11,160.4	-194.4	343.1	0.44	-0.38	-7.49	-17.6	7.4
11,281.0	2.37	277.68	11,255.3	-193.5	340.1	1.22	0.93	-24.15	-22.1	-0.5
11,375.0	3.43	264.85	11,349.2	-193.5	335.4	1.32	1.13	-13.65	-26.2	-5.9
11,470.0	2.73	251.76	11,444.1	-194.5	330.4	1.04	-0.74	-13.78	-29.2	-12.3
11,600.0	2.11	228.11	11,633.9	-199.2	323.5	0.61	-0.33	-12.45	-29.4	-24.8
11,798.0	2.02	208.49	11,771.8	-202.1	320.5	0.56	-0.07	-15.67	-23.0	-34.8
11,869.0	1.83	321.37	11,842.8	-202.3	319.3	4.58	-0.26	161.80	-22.5	36.7
KOP, MD:11869.0', TVD:11842.8', N/S:-202.3', EW:319.3', INC:1.83										
11,993.0	2.81	334.11	11,966.8	-201.5	318.8	4.58	4.07	53.10	-14.8	40.9
11,988.0	13.72	358.46	11,960.7	-188.1	317.5	11.81	11.48	25.63	-1.0	44.5
12,002.0	15.92	1.97	12,051.6	-164.1	317.6	2.53	2.34	3.73	4.9	44.1
12,135.9	21.02	356.58	12,102.7	-147.0	317.3	9.97	9.47	-10.00	7.6	45.0
FTP Crossing, MD:12135.9', TVD:12102.7', N/S:-147.0', EW:317.3', INC:21.02										
12,176.0	24.89	353.97	12,139.6	-131.4	316.0	9.97	9.65	-6.51	11.4	47.0
12,271.0	46.69	1.44	12,216.2	-76.3	314.7	23.37	22.95	7.66	21.9	46.3
12,298.1	49.49	2.21	12,234.3	-56.2	315.4	10.56	10.35	2.85	21.2	45.4
FTP(DL 7 Fed #715H)										
12,366.0	56.54	3.90	12,275.1	-2.0	318.3	10.56	10.38	2.48	19.7	42.0
12,480.0	64.28	0.92	12,321.5	79.6	321.6	8.68	8.23	-3.17	18.8	38.9
12,555.0	74.04	3.90	12,355.3	168.2	325.4	10.68	10.27	3.14	23.2	34.4

Company:	EOG Resources - Midland
Project:	Lea County, NM (NAD 83 NME)
Site:	Dauntless 7 Fed
Well:	#715H
Wellbore:	OH
Design:	OH
Local Co-ordinate Reference:	
Well #715H	
KB = 25 @ 3516.0ust	
Gnd	
Minimum Curvature	
EDM	
Database:	
Survey Calculation Method:	
North Reference:	
MD Reference:	
TVD Reference:	

MD	Inc	Azi (azimuth)	TVD	N/S	EW	Dleg	Buld	Turn	High to Plan	Right to Plan
(ust)	(°)	(°)	(ust)	(ust)	(ust)	(°/100ust)	(°/100ust)	(°/100ust)	(ust)	(ust)
12,589.0	81.51	3.96	12,362.5	201.3	227.7	21.97	21.97	21.97	0.18	23.7
12,659.0	89.43	4.22	12,368.0	270.8	332.7	11.32	11.31	11.31	0.37	22.7
12,754.0	89.25	1.59	12,369.1	365.7	337.5	2.77	-0.19	-2.77	23.3	21.8
12,849.0	92.77	1.50	12,367.4	460.6	340.1	3.71	3.71	3.71	-0.09	21.1
12,944.0	92.86	0.00	12,362.8	555.5	341.3	1.58	0.09	-1.58	16.1	17.1
13,039.0	92.86	2.20	12,358.0	650.4	343.1	2.31	0.00	2.32	10.9	14.8
13,133.0	89.96	2.20	12,355.7	744.3	346.7	3.09	-3.09	8.2	8.2	10.7
13,228.0	91.19	1.50	12,354.8	839.2	349.8	1.49	-0.74	6.8	6.8	7.2
13,323.0	88.81	0.18	12,354.8	934.2	351.2	2.86	-2.51	6.4	6.4	5.4
13,417.0	91.19	0.53	12,354.8	1,028.2	351.8	2.56	2.53	0.37	6.0	4.3
13,478.4	88.91	0.59	12,354.7	1,089.6	352.4	3.71	-3.71	0.09	5.7	3.4
13,512.0	87.67	0.62	12,355.7	1,123.1	352.7	3.71	-3.71	0.09	6.6	2.9
13,607.0	85.74	359.74	12,361.2	1,218.0	353.0	2.23	-2.03	-0.93	11.7	2.2
13,702.0	85.47	0.44	12,368.4	1,312.7	353.2	0.79	-0.28	0.74	18.7	1.6
13,797.0	89.87	1.06	12,372.3	1,407.6	354.4	4.68	4.63	0.65	22.3	-0.1
13,892.0	91.63	1.15	12,371.1	1,502.6	356.2	1.86	1.85	0.09	20.7	-2.4
13,986.0	89.69	359.74	12,370.0	1,596.5	357.0	2.55	-2.06	-1.50	19.3	-3.6
14,081.0	88.81	358.60	12,371.2	1,691.5	355.6	1.52	-0.93	-1.20	20.3	-2.7
14,176.0	88.99	357.10	12,373.0	1,786.4	352.0	1.59	0.19	-1.58	21.8	0.4
14,271.0	89.60	357.90	12,374.2	1,881.3	347.9	1.06	0.64	0.84	22.6	4.1
14,365.0	92.59	358.25	12,372.4	1,975.3	344.7	3.20	3.18	0.37	20.5	6.8
14,460.0	92.95	356.58	12,367.8	2,070.1	340.5	1.80	0.38	-1.76	15.7	10.6
14,555.0	91.63	357.19	12,364.0	2,164.8	335.3	1.53	-1.39	0.64	11.6	15.3
14,650.0	92.68	0.80	12,360.5	2,259.7	333.6	3.95	1.11	3.80	7.7	16.6
14,744.0	87.58	1.50	12,360.2	2,353.7	335.5	5.48	-5.43	0.74	7.2	14.2
14,839.0	87.93	2.91	12,364.0	2,448.5	339.2	1.53	0.37	1.48	10.6	10.1

TOT#(DL Fed #715H)



Midland PVA

Company:	EOG Resources - Midland	Local Co-ordinate Reference:	Well #715H
Project:	Lea County, NM (NAD 83 NME)	TVD Reference:	KB = 25 @ 3516.0usft
Site:	Dauntless 7 Fed	MD Reference:	KB = 25 @ 3516.0usft
Well:	#715H	North Reference:	Grid
Wellbore:	OH	Survey Calculation Method:	Minimum Curvature
Design:	OH	Database:	EDM

Survey											
MD (usft)	Inc (°)	Azi (azimuth) (°)	TVD (usft)	N/S (usft)	E/W (usft)	DLeg (°/100usft)	Build (°/100usft)	Turn (°/100usft)	High to Plan (usft)	Right to Plan (usft)	
14,934.0	83.80	2.03	12,370.8	2,543.2	343.3	4.44	-4.35	-0.93	17.1	5.6	
15,028.0	86.88	2.38	12,378.4	2,636.8	346.9	3.30	3.28	0.37	24.4	1.5	
15,123.0	89.69	1.15	12,381.3	2,731.7	349.8	3.23	2.96	-1.29	27.0	-1.9	
15,218.0	89.34	1.94	12,382.1	2,826.6	352.3	0.91	-0.37	0.83	27.5	-4.9	
15,313.0	92.07	2.84	12,380.9	2,921.6	356.1	2.97	2.87	0.74	26.0	-9.1	
15,407.0	91.89	359.83	12,377.7	3,015.5	358.2	2.99	-0.19	-2.99	22.5	-11.6	
15,502.0	89.43	359.92	12,376.6	3,110.5	358.0	2.59	-2.59	0.09	21.1	-11.8	
15,597.0	89.52	359.57	12,377.4	3,205.5	357.5	0.38	0.09	-0.37	21.6	-11.9	
15,691.0	89.25	0.44	12,378.5	3,299.4	357.5	0.97	-0.29	0.93	22.3	-12.3	
15,786.0	89.87	0.36	12,379.2	3,394.4	358.2	0.66	0.65	-0.08	22.7	-13.5	
15,881.0	90.13	0.18	12,379.2	3,489.4	358.7	0.33	0.27	-0.19	22.4	-14.4	
15,975.0	90.48	0.36	12,378.7	3,583.4	359.1	0.42	0.37	0.19	21.6	-15.3	
16,069.0	90.84	0.71	12,377.6	3,677.4	360.0	0.53	0.38	0.37	20.2	-16.6	
16,164.0	90.40	359.21	12,376.6	3,772.4	359.9	1.65	-0.46	-1.58	18.9	-17.0	
16,259.0	90.40	358.69	12,375.9	3,867.4	358.2	0.55	0.00	-0.55	17.9	-15.7	
16,353.0	91.28	357.98	12,374.5	3,961.3	355.4	1.20	0.94	-0.76	16.3	-13.4	
16,448.0	89.08	357.81	12,374.2	4,056.3	352.0	2.32	-2.32	-0.18	15.7	-10.4	
16,543.0	88.55	356.84	12,376.2	4,151.2	347.5	1.16	-0.56	-1.02	17.3	-6.4	
16,638.0	89.08	356.93	12,378.2	4,246.0	342.4	0.57	0.56	0.09	19.0	-1.7	
16,732.0	89.52	357.10	12,379.3	4,339.9	337.5	0.50	0.47	0.18	19.8	2.7	
16,827.0	89.96	357.02	12,379.7	4,434.7	332.6	0.47	0.46	-0.08	19.9	7.2	
16,923.0	90.66	358.69	12,379.2	4,530.7	329.0	1.89	0.73	1.74	19.1	10.3	
17,018.0	91.36	358.42	12,377.6	4,625.6	326.6	0.79	0.74	-0.28	17.1	12.2	
17,113.0	88.55	357.72	12,377.6	4,720.5	323.4	3.05	-2.96	-0.74	16.9	15.0	
17,208.0	88.99	357.37	12,379.7	4,815.4	319.3	0.59	0.46	-0.37	18.6	18.6	
17,302.0	89.96	359.21	12,380.5	4,909.4	316.5	2.21	1.03	1.96	19.2	20.9	
17,397.0	87.49	356.14	12,382.6	5,004.3	312.7	4.15	-2.60	-3.23	21.0	24.4	



Midland PVA

Company: EOG Resources - Midland
 Project: Lea County, NM (NAD 83 NME)
 Site: Dauntless 7 Fed
 Well: #715H
 Wellbore: OH
 Design: OH

Local Co-ordinate Reference: Well #715H
 TVD Reference: KB = 25 @ 3516.0usft
 MD Reference: KB = 25 @ 3516.0usft
 North Reference: Grid
 Survey Calculation Method: Minimum Curvature
 Database: EDM

Survey												
MD (usft)	Inc (°)	Azi (azimuth) (°)	TVD (usft)	N/S (usft)	E/W (usft)	DLeg (°/100usft)	Build (°/100usft)	Turn (°/100usft)	High to Plan (usft)	Right to Plan (usft)		
17,492.0	87.05	357.90	12,387.2	5,099.0	307.7	1.91	-0.46	1.85	25.2	28.9		
17,587.0	89.69	359.30	12,389.9	5,193.9	305.4	3.15	2.78	1.47	27.6	30.7		
17,681.0	90.84	1.15	12,389.4	5,287.9	305.8	2.32	1.22	1.97	26.9	29.9		
17,776.0	92.33	2.11	12,386.8	5,382.9	308.5	1.87	1.57	1.01	23.9	26.7		
17,871.0	89.60	1.41	12,385.2	5,477.8	311.4	2.97	-2.87	-0.74	22.0	23.3		
17,965.0	89.25	0.36	12,386.2	5,571.8	312.9	1.18	-0.37	-1.12	22.7	21.4		
18,061.0	92.86	2.11	12,384.4	5,667.7	314.9	4.18	3.76	1.82	20.6	18.9		
18,156.0	88.81	0.53	12,383.0	5,762.7	317.1	4.58	-4.26	-1.66	18.9	16.3		
18,250.0	85.47	359.04	12,387.7	5,856.5	316.8	3.89	-3.55	-1.59	23.3	16.2		
18,345.0	88.90	1.15	12,392.4	5,951.4	316.9	4.24	3.61	2.22	27.7	15.5		
18,440.0	88.29	1.15	12,394.7	6,046.3	318.8	0.64	-0.64	0.00	29.7	13.2		
18,526.0	90.22	1.68	12,395.8	6,132.3	321.0	2.33	2.24	0.62	30.5	10.6		
18,621.0	89.87	359.48	12,395.7	6,227.3	321.9	2.34	-0.37	-2.32	30.1	9.2		
18,716.0	90.75	0.10	12,395.2	6,322.3	321.6	1.13	0.93	0.65	29.3	9.1		
18,810.0	91.89	1.15	12,393.0	6,416.3	322.6	1.65	1.21	1.12	26.8	7.6		
18,905.0	90.04	359.92	12,391.4	6,511.2	323.5	2.34	-1.95	-1.29	24.9	6.3		
18,999.0	88.90	359.48	12,392.3	6,605.2	323.0	1.30	-1.21	-0.47	25.5	6.3		
19,094.0	87.58	358.78	12,395.2	6,700.2	321.5	1.57	-1.39	-0.74	28.1	7.3		
19,189.0	88.64	358.43	12,398.4	6,795.1	319.2	1.17	1.12	-0.37	30.9	9.2		
19,283.0	89.16	358.60	12,400.2	6,889.0	316.8	0.58	0.55	0.18	32.4	11.2		
19,378.0	89.43	359.13	12,401.3	6,984.0	314.9	0.63	0.28	0.56	33.3	12.6		
19,473.0	91.19	359.92	12,400.8	7,079.0	314.1	2.03	1.85	0.83	32.5	12.9		
19,567.0	90.40	359.65	12,399.5	7,173.0	313.8	0.89	-0.84	-0.29	30.9	12.8		
19,662.0	89.43	359.92	12,399.7	7,268.0	313.4	1.06	-1.02	0.28	30.7	12.7		
19,676.8	89.36	359.73	12,399.8	7,282.8	313.4	1.37	-0.46	-1.29	30.8	12.7		
TGT#2(DL 7 Fed #715H)												
19,757.0	88.99	358.69	12,401.0	7,363.0	312.3	1.37	-0.46	-1.29	31.4	13.4		



Midland PVA

Company:	EOG Resources - Midland	Local Co-ordinate Reference:	Well #715H
Project:	Lea County, NM (NAD 83 NME)	TVD Reference:	KB = 25 @ 3516.0usft
Site:	Dauntless 7 Fed	MD Reference:	KB = 25 @ 3516.0usft
Well:	#715H	North Reference:	Grid
Wellbore:	OH	Survey Calculation Method:	Minimum Curvature
Design:	OH	Database:	EDM

MD (usft)	Inc (°)	Azi (azimuth) (°)	TVD (usft)	N/S (usft)	E/W (usft)	DLeg (°/100usft)	Build (°/100usft)	Turn (°/100usft)	High to Plan (usft)	Right to Plan (usft)
19,851.0	91.28	359.56	12,400.8	7,457.0	310.8	2.61	2.44	0.93	30.5	14.4
19,946.0	91.98	1.23	12,398.0	7,551.9	311.5	1.91	0.74	1.76	27.0	13.3
20,041.0	93.30	359.74	12,393.7	7,646.8	312.3	2.09	1.39	-1.57	21.9	12.0
20,136.0	91.63	358.87	12,389.6	7,741.7	311.1	1.98	-1.76	-0.92	17.2	12.7
20,230.0	89.25	357.37	12,388.9	7,835.6	308.1	2.99	-2.53	-1.60	15.7	15.4
20,325.0	87.85	357.02	12,391.3	7,930.5	303.4	1.52	-1.47	-0.37	17.4	19.6
20,420.0	85.30	356.76	12,396.9	8,025.2	298.3	2.70	-2.68	-0.27	22.3	24.3
20,515.0	88.72	1.23	12,401.9	8,120.0	296.6	5.92	3.60	4.71	26.6	25.4
20,610.0	89.87	1.50	12,403.1	8,215.0	298.9	1.24	1.21	0.28	27.1	22.7
20,705.0	90.40	1.67	12,402.8	8,309.9	301.5	0.59	0.56	0.18	26.1	19.6
20,799.0	89.43	1.94	12,403.0	8,403.9	304.5	1.07	-1.03	0.29	25.6	16.2
20,894.0	89.34	1.32	12,404.0	8,498.8	307.2	0.66	-0.09	-0.65	25.9	13.0
20,989.0	88.55	359.39	12,405.8	8,593.8	307.8	2.19	-0.83	-2.03	26.9	12.0
21,084.0	89.25	358.95	12,407.6	8,688.8	306.4	0.87	0.74	-0.46	28.0	12.9
21,179.0	91.54	358.33	12,406.9	8,783.7	304.1	2.50	2.41	-0.65	26.6	14.7
21,273.0	87.41	357.37	12,407.8	8,877.6	300.6	4.51	-4.39	-1.02	26.8	17.8
21,368.0	88.55	359.48	12,411.1	8,972.5	298.0	2.52	1.20	2.22	29.4	19.9
21,463.0	90.13	359.74	12,412.2	9,067.5	297.3	1.69	1.66	0.27	29.8	20.1
21,557.0	91.10	359.92	12,411.2	9,161.5	297.1	1.05	1.03	0.19	28.1	20.0
21,652.0	90.57	1.85	12,409.8	9,256.5	298.5	2.11	-0.56	2.03	26.0	18.0
21,746.0	90.66	1.85	12,408.8	9,350.4	301.6	0.10	0.10	0.00	24.3	14.5
21,841.0	90.92	1.41	12,407.5	9,445.4	304.3	0.54	0.27	-0.46	22.2	11.4
21,936.0	88.72	359.83	12,407.8	9,540.4	305.3	2.85	-2.32	-1.66	21.8	9.9
22,031.0	89.08	359.92	12,409.6	9,635.4	305.1	0.39	0.38	0.09	22.9	9.7
22,126.0	90.75	358.60	12,409.8	9,730.4	303.9	2.24	1.76	-1.39	22.3	10.4
22,220.0	88.02	357.72	12,410.8	9,824.3	300.8	3.05	-2.90	-0.94	22.6	13.0
22,314.0	86.17	357.10	12,415.6	9,918.1	296.6	2.08	-1.97	-0.66	26.7	16.8



Midland PVA

Company: EOG Resources - Midland
Project: Lea County, NM (NAD 83 NME)
Site: Dauntless 7 Fed
Well: #715H
Wellbore: OH
Design: OH

Local Co-ordinate Reference: Well #715H
TVD Reference: KB = 25 @ 3516.0usft
MD Reference: KB = 25 @ 3516.0usft
North Reference: Grid
Survey Calculation Method: Minimum Curvature
Database: EDM

MD (usft)	Inc (")	Azi (azimuth) (")	TVD (usft)	N/S (usft)	E/W (usft)	DLeg (°/100usft)	Build (°/100usft)	Turn (°/100usft)	High to Plan (usft)	Right to Plan (usft)
22,409.0	89.69	357.37	12,419.0	10,012.9	292.0	3.72	3.71	0.28	29.4	20.9
22,504.0	90.40	355.87	12,418.9	10,107.7	286.4	1.75	0.75	-1.58	28.7	26.0
Last MWD Survey (MD=22504.0')										
22,598.0	90.40	355.87	12,418.3	10,201.5	279.7	0.00	0.00	0.00	27.3	32.3
Projection to Bit (MD=22598.0') - PBHL(DL 7 Fed #715H)										

Design Annotations				
Measured Depth (usft)	Vertical Depth (usft)	Local Coordinates		Comment
		+N/-S (usft)	+E/-W (usft)	
11,869.0	11,842.8	-202.3	319.3	KOP, MD:11869.0', TVD:11842.8', N/S:-202.3', E/W:319.3', INC:1.83
12,135.9	12,102.7	-147.0	317.3	FTP Crossing, MD:12135.9', TVD:12102.7', N/S:-147.0', E/W:317.3', INC:21.02
22,504.0	12,418.9	10,107.7	286.4	Last MWD Survey (MD=22504.0')
22,598.0	12,418.3	10,201.5	279.7	Projection to Bit (MD=22598.0')

Checked By: _____ Approved By: _____ Date: _____

I certify this survey to be true and correct to the best of my belief and knowledge.

Signed Kay Maddox Date 10/01/2020



Lea County, NM (NAD 83 NME)

Dauntless 7 Fed #715H

Plan #1

PROJECT DETAILS: Lea County, NM (NAD 83 NME)

Geodetic System: US State Plane 1983
Datum: North American Datum 1983
Ellipsoid: GRS 1980
Zone: New Mexico Eastern Zone
System Datum: Mean Sea Level

WELL DETAILS: #715H

KB = 25 @ 3516.0ush 3491.0
Northing 414874.00 Easting 762795.00 Latitude 32° 8' 18.763 N Longitude 103° 37' 4.285 W

Azimuths to Grid North
True North: -0.38°
Magnetic North: 6.30°

Magnetic Field
Strength: 47612.3nT
Dip Angle: 59.54°
Date: 2/1/2020
Model: IGRF2015



To convert a Magnetic Direction to a Grid Direction, Add 6.30°
To convert a True Direction to a Grid Direction, Subtract 0.38°

SECTION DETAILS

Sec	MD	Inc	Azi	TVD	+N-S	+E-W	Dleg	TFace	VSec	Target
1	0.0	0.00	0.00	0.0	0.0	0.0	0.00	0.00	0.0	
2	1500.0	0.00	0.00	1500.0	0.0	0.0	0.00	0.00	0.0	
3	1799.8	6.00	118.55	1799.2	-7.5	13.8	2.00	118.55	-7.1	
4	5445.2	6.00	118.55	5424.8	-189.5	348.2	0.00	0.00	-178.8	
5	5745.0	0.00	0.00	5724.0	-197.0	362.0	2.00	180.00	-185.8	
6	11889.0	0.00	0.00	11868.0	-197.0	362.0	0.00	0.00	-185.8	
7	12637.0	89.75	359.72	12345.5	278.4	359.7	12.00	359.72	289.2	
8	13448.2	89.75	359.72	12349.0	1089.6	355.8	0.00	0.00	1100.0	TGT#1(DL 7 Fed #715H)
9	13451.4	89.82	359.72	12349.0	1092.9	355.8	2.00	0.00	1103.2	TGT#2(DL 7 Fed #715H)
10	19642.1	89.82	359.72	12369.0	7283.4	326.1	0.00	0.00	7290.0	
11	19654.5	89.57	359.72	12369.1	7295.8	326.0	2.00	-179.78	7302.3	
12	22562.8	89.57	359.72	12391.0	10204.0	312.0	0.00	0.00	10208.8	PBHL(DL 7 Fed #715H)

CASING DETAILS

No casing data is available

WELLBORE TARGET DETAILS (MAP COORDINATES)

Name	TVD	+N-S	+E-W	Northing	Easting
Bushy Top(DL 7 Fed #715H)	7518.0	-197.0	352.0	414877.00	763187.00
FTP(DL 7 Fed #715H)	12346.0	-147.0	362.0	414727.00	763157.00
TGT#1(DL 7 Fed #715H)	12349.0	1089.6	355.0	415953.00	763150.82
TGT#2(DL 7 Fed #715H)	12349.0	7283.4	326.1	422187.00	763121.07
PBHL(DL 7 Fed #715H)	12391.0	10204.0	312.0	425078.00	763107.00

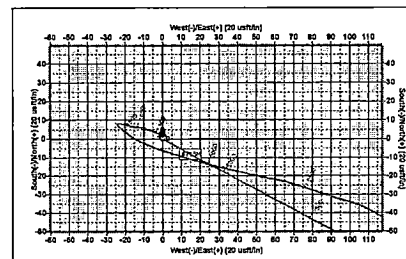
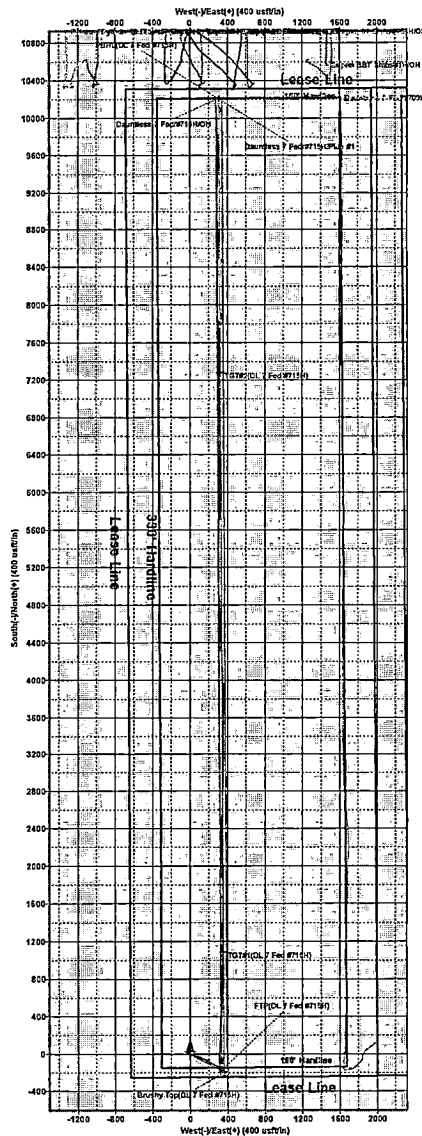
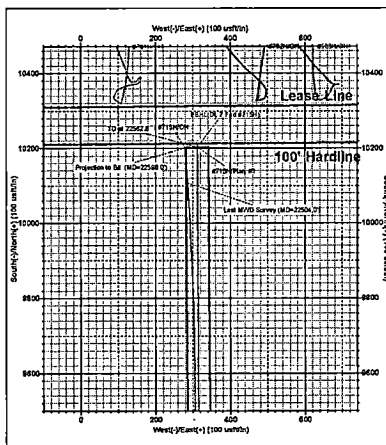
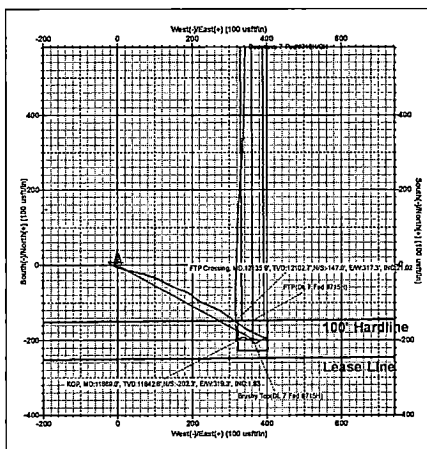

KOR MD11188.0, TVD11848.0, NS-202.7, EW313.7, INC1.83

FTP Crossing, MD13155.0, TVD13102.7, NS-142.5, EW313.7, INC2.02

Line MWD Survey (MD=2504.7)

Projection to BH (MD=2504.7)

Projection to BH (MD=2504.7)

Projection to BH (MD=2504.7)

Projection to BH (MD=2504.7)

Projection to BH (MD=2504.7)

Projection to BH (MD=2504.7)

Projection to BH (MD=2504.7)

Projection to BH (MD=2504.7)

Projection to BH (MD=2504.7)

Projection to BH (MD=2504.7)

Projection to BH (MD=2504.7)

Projection to BH (MD=2504.7)

Projection to BH (MD=2504.7)

Projection to BH (MD=2504.7)

Projection to BH (MD=2504.7)

Projection to BH (MD=2504.7)

Projection to BH (MD=2504.7)

Projection to BH (MD=2504.7)

Projection to BH (MD=2504.7)

Projection to BH (MD=2504.7)

Projection to BH (MD=2504.7)

Projection to BH (MD=2504.7)

Projection to BH (MD=2504.7)

Projection to BH (MD=2504.7)

Projection to BH (MD=2504.7)

Projection to BH (MD=2504.7)

Projection to BH (MD=2504.7)

Projection to BH (MD=2504.7)

Projection to BH (MD=2504.7)

Projection to BH (MD=2504.7)

Projection to BH (MD=2504.7)

Projection to BH (MD=2504.7)

Projection to BH (MD=2504.7)

Projection to BH (MD=2504.7)

Projection to BH (MD=2504.7)

Projection to BH (MD=2504.7)

Projection to BH (MD=2504.7)

Projection to BH (MD=2504.7)

Projection to BH (MD=2504.7)

Projection to BH (MD=2504.7)

Projection to BH (MD=2504.7)

Projection to BH (MD=2504.7)

Projection to BH (MD=2504.7)

Projection to BH (MD=2504.7)

Projection to BH (MD=2504.7)

Projection to BH (MD=2504.7)

Projection to BH (MD=2504.7)

Projection to BH (MD=2504.7)

Projection to BH (MD=2504.7)

Projection to BH (MD=2504.7)

Projection to BH (MD=2504.7)