

AUG 31 2012

DISTRICT I  
1625 N. French Dr., Hobbs, NM 88240  
Phone (575) 393-6161 Fax: (575) 393-0720

DISTRICT II  
811 S. First St., Artesia, NM 88210  
Phone (575) 748-1283 Fax: (575) 748-9720

DISTRICT III  
1000 Rio Brazos Rd., Aztec, NM 87410  
Phone (505) 334-6178 Fax: (505) 334-6170

DISTRICT IV  
1220 S. St. Francis Dr., Santa Fe, NM 87505  
Phone (505) 476-3460 Fax: (505) 476-3462

State of New Mexico  
Energy, Minerals and Natural Resources Department

Form C-102  
Revised August 1, 2011

Submit one copy to appropriate  
District Office

RECEIVED

OIL CONSERVATION DIVISION  
1220 South St. Francis Dr.  
Santa Fe, New Mexico 87505

WELL LOCATION AND ACREAGE DEDICATION PLAT

AMENDED REPORT

API Number <b>30-025-40738</b>		Pool Code <b>62160</b>	Pool Name <b>Vacuum Glorieta</b>
Property Code <b>31257</b>	Property Name <b>VACUUM GLORIETA EAST UNIT</b>		Well Number <b>19-34</b>
OGRID No. <b>217817</b>	Operator Name <b>CONOCO PHILLIPS</b>		Elevation <b>3967'</b>

Surface Location

UL or lot No.	Section	Township	Range	Lot Idn	Feet from the	North/South line	Feet from the	East/West line	County
K	32	17 S	35 E		2150	SOUTH	2233	WEST	LEA

Bottom Hole Location If Different From Surface

UL or lot No.	Section	Township	Range	Lot Idn	Feet from the	North/South line	Feet from the	East/West line	County

Dedicated Acres <b>40</b>	Joint or Infill	Consolidation Code	Order No.
------------------------------	-----------------	--------------------	-----------

NO ALLOWABLE WILL BE ASSIGNED TO THIS COMPLETION UNTIL ALL INTERESTS HAVE BEEN CONSOLIDATED OR A NON-STANDARD UNIT HAS BEEN APPROVED BY THE DIVISION

<p><b>SURFACE LOCATION</b> Lat - N 32°47'24.32" Long - W 103°28'52.34" NMSPC- N 652220.940 E 803200.355 (NAD-83) Lat - N 32°47'23.87" Long - W 103°28'50.56" NMSPC- N 652156.048 E 762021.359 (NAD-27)</p>	<p><b>OPERATOR CERTIFICATION</b> I hereby certify that the information contained herein is true and complete to the best of my knowledge and belief, and that this organization either owns a working interest or unleased mineral interest in the land including the proposed bottom hole location or has a right to drill this well at this location pursuant to a contract with an owner of such a mineral or working interest, or to a voluntary pooling agreement or a compulsory pooling order heretofore entered by the division.</p> <p><i>Susan B. Maunder</i> 8/29/12 Signature Date Susan B. Maunder Printed Name Susan.B.maunder@conocophillips.com Email Address</p>
	<p><b>SURVEYOR CERTIFICATION</b> I hereby certify that the well location shown on this plat was plotted from field notes of actual surveys made by me or under my supervision, and that the same is true and correct to the best of my belief.</p> <p><b>GARY L. JONES</b> Date Surveyed Signature &amp; Seal of Professional Surveyor</p> <p>Certificate No. Gary L. Jones 7977 BASIN SURVEYS 26933</p>

SEP 04 2012

SECTION 32, TOWNSHIP 17 SOUTH, RANGE 35 EAST, N.M.P.M.,  
LEA COUNTY, WELL PAD VACINITY, NEW MEXICO.

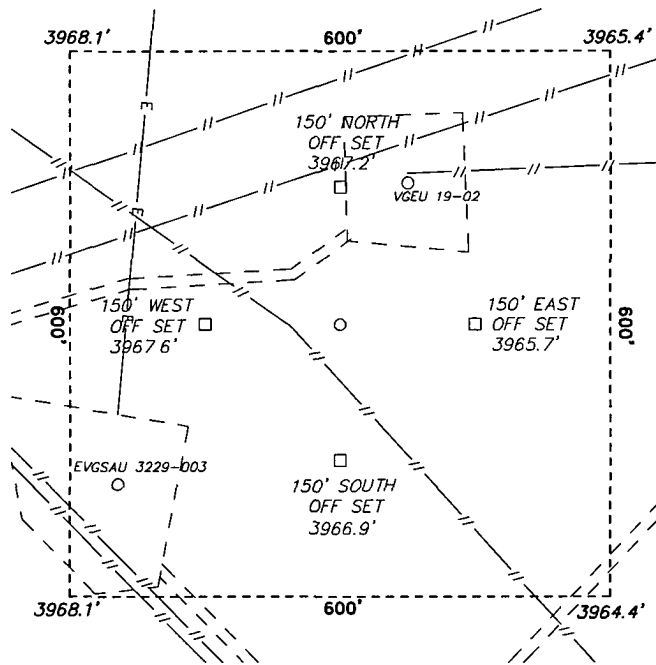

**CONOCO PHILLIPS**  
**VACUUM GLORIETA EAST UNIT #19-34**  
**ELEV. - 3967'**  
 Lat - N 32°47'24.32"  
 Long - W 103°28'52.34"  
 NMSPCE- N 652220.940  
 E 803200.355  
 (NAD-83)  
 Lat - N 32°47'23.87"  
 Long - W 103°28'50.56"  
 NMSPCE- N 652156.048  
 E 762021.359  
 (NAD-27)

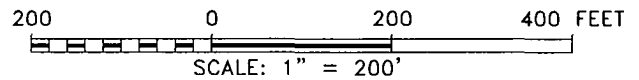

**ConocoPhillips**

REF: VACUUM GLORIETA EAST UNIT #19-34 / WELL PAD VACINITY  
 THE VACUUM GLORIETA EAST UNIT #19-34 LOCATED 2150'  
 FROM THE SOUTH LINE AND 2233' FROM THE WEST LINE OF  
 SECTION 32, TOWNSHIP 17 SOUTH, RANGE 35 EAST,  
 N.M.P.M., LEA COUNTY, NEW MEXICO.

**BASIN SURVEYS** P.O. BOX 1786-HOBBS, NEW MEXICO

W.O. Number: 26933 Drawn By: J. SMALL

Date: 07-16-2012 Disk: JMS 26933

Survey Date: 07-13-2012

Sheet 2

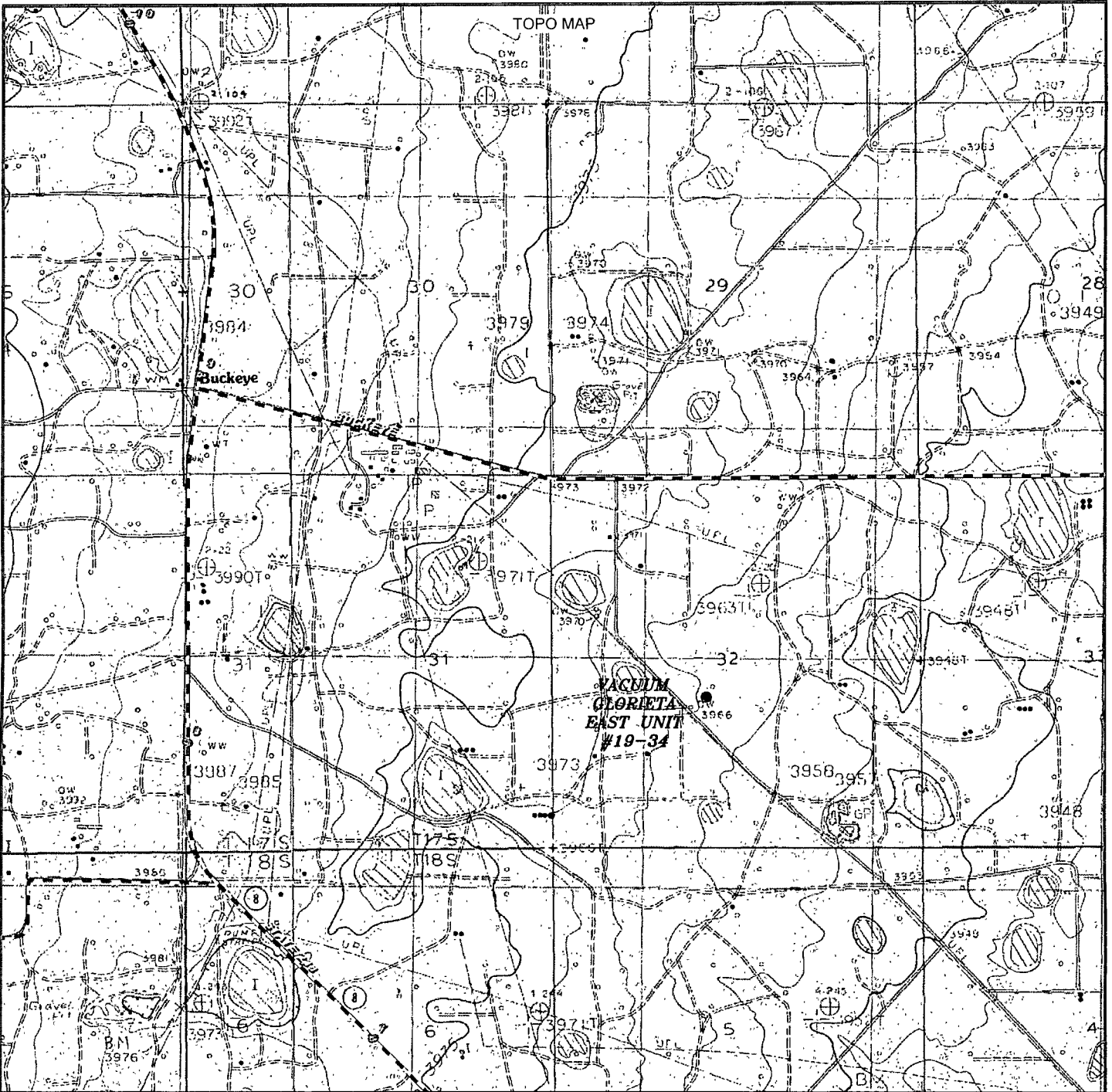

**VACUUM GLORIETA EAST UNIT #19-34**  
 Located 2150' FSL and 2233' FWL  
 Section 32, Township 17 South, Range 35 East,  
 N.M.P.M., Lea County, New Mexico.

**basin surveys**  
 focused on excellence  
 in the oilfield

P.O. Box 1786  
 1120 N. West County Rd.  
 Hobbs, New Mexico 88241  
 (575) 393-7316 - Office  
 (575) 392-2206 - Fax  
 basinsurveys.com

W.O. Number: JMS 26933
Survey Date: 07-13-2012
Scale: 1" = 2000'
Date: 07-16-2012

**ConocoPhillips**

Sheet 3