

District I
1625 N. French Dr., Hobbs, NM 88240
District II
1301 W. Grand Avenue, Artesia, NM 88210
District III
1000 Rio Brazos Road, Aztec, NM 87410
District IV
1220 S. St. Francis Dr., Santa Fe, NM 87505

State of New Mexico
Energy Minerals and Natural Resources

Form C-144
June 1, 2004

Oil Conservation Division
1220 South St. Francis Dr.
Santa Fe, NM 87505

For drilling and production facilities, submit to appropriate NMOCD District Office.
For downstream facilities, submit to Santa Fe office

Pit or Below-Grade Tank Registration or Closure

Is pit or below-grade tank covered by a "general plan"? Yes ☒ No ☐

Type of action: Registration of a pit or below-grade tank ☐ Closure of a pit or below-grade tank ☒

Operator: Yates Petroleum Company Telephone: 505-748-4500 e-mail address: mikes@ypc.com

Address: 105 South 4th Street, Artesia, N.M. 88210

Facility or well name: Orbison State Unit 1 API #: 30-025-36816 U/L or Qtr/Qtr H Sec 14 T 12S R 34E

County: Lea Latitude: 33.28101 Longitude: 103.47524 NAD: 1927 ☐ 1983 ☒

Surface Owner: Federal ☐ State ☐ Private ☒ Indian ☐

Pit

Type: Drilling ☒ Production ☐ Disposal ☐

Work over ☐ Emergency ☐

Lined ☒ Unlined ☐

Liner type: Synthetic ☒ Thickness 12 mil Clay ☐

Pit Volume 12,000 bbl

Below-grade tank

Volume: _____ bbl Type of fluid: _____

Construction material: _____

Double-walled, with leak detection? Yes ☐ If not, explain why not. _____

Depth to ground water (vertical distance from bottom of pit to seasonal high water elevation of ground water.)

Less than 50 feet
50 feet or more, but less than 100 feet
100 feet or more

Wellhead protection area: (Less than 200 feet from a private domestic water source, or less than 1000 feet from all other water sources.)

Yes
No

Distance to surface water: (horizontal distance to all wetlands, playas, irrigation canals, ditches, and perennial and ephemeral watercourses.)

Less than 200 feet
200 feet or more, but less than 1000 feet
1000 feet or more

Ranking Score (Total Points)

40 points

If this is a pit closure: (1) Attach a diagram of the facility showing the pit's relationship to other equipment and tanks. (2) Indicate disposal location: (check the onsite box if you are burying in place) onsite ☒ offsite ☐ If offsite, name of facility NA (3) Attach a general description of remedial action taken including remediation start date and end date. (4)

Groundwater encountered: No ☐ Yes ☐ If yes, show depth below ground surface _____ ft. and attach sample results.

(5) Attach soil sample results and a diagram of sample locations and excavations.

Additional Comments: Closure work plan for drilling pit. An encapsulation trench will be constructed and lined with 12 mil synthetic liner next to existing drilling pit. The drilling pit contents will be excavated and emplaced into the encapsulation trench using a mixture of two to one pit material and Class H bulk cement or CKD. The emulsion of pit material and cement will be mixed using a track hoe and water added if needed. After completion of solidifying pit material in cement and pit contents have set in place for a minimum of 24 hours, the encapsulation trench will then be capped using a 20 mil synthetic liner and backfilled to grade using a minimum of 3' of like material and clean soil. A one call and 48 hour notification to OCD will be made before pit closure action begins. Beginning pit closure date: N/A. Ending pit closure date: N/A

I hereby certify that the information above is true and complete to the best of my knowledge and belief. I further certify that the above-described pit or below-grade tank has been/will be constructed or closed according to NMOCD guidelines ☐, a general permit X, or an (attached) alternative OCD-approved plan ☐.

Date: 06/17/2005

Printed Name/Title _____

Signature _____

Your certification and NMOCD approval of this application/closure does not relieve the operator of liability should the contents of the pit or tank contaminate ground water or otherwise endanger public health or the environment. Nor does it relieve the operator of its responsibility for compliance with any other federal, state, or local laws and/or regulations.

Approval: _____

Printed Name/Title GARY W. WINK / STAFF MGR

Signature Gary W. Wink

Date: 6/22/05

USGS SEO TWN 09S-15S CHAVES LEA GW

ORBISON STATE UNIT 1

30.025.36816

	F	G	H	I	J	K	L
3	COUNTY	SOURCE	USGS SITE NUM.	QTY	SITE LOCATION	DATE	LEVEL
900	LEA	SEO		1	12S.34E.14.14		43.00
901	LEA	SEO		1	12S.34E.14.242422	1991-01-15	48.25
902	LEA	SEO		1	12S.34E.14.32		47.00
903	LEA	SEO		1	12S.34E.14.43322	1990-12-19	37.87
904	LEA	SEO		1	12S.34E.14.443222	1961-02-01	34.00

New Mexico Office of the State Engineer
Well Reports and Downloads

ORBISON STATE UNIT 1

Township: 12S Range: 34E Sections: 14

NAD27 X: Y: Zone: Search Radius:

County: Basin: Number: Suffix:

Owner Name: (First) (Last) ☐ Non-Domestic ☐ Domestic
☒ All

Well / Surface Data Report

Avg Depth to Water Report

Water Column Report

Clear Form

WATERS Menu

Help

AVERAGE DEPTH OF WATER REPORT 06/17/2005

Bsn	Tws	Rng	Sec	Zone	X	Y	Wells	(Depth Water in Feet)		
								Min	Max	Avg
L	12S	34E	14				2	43	47	45

Record Count: 2

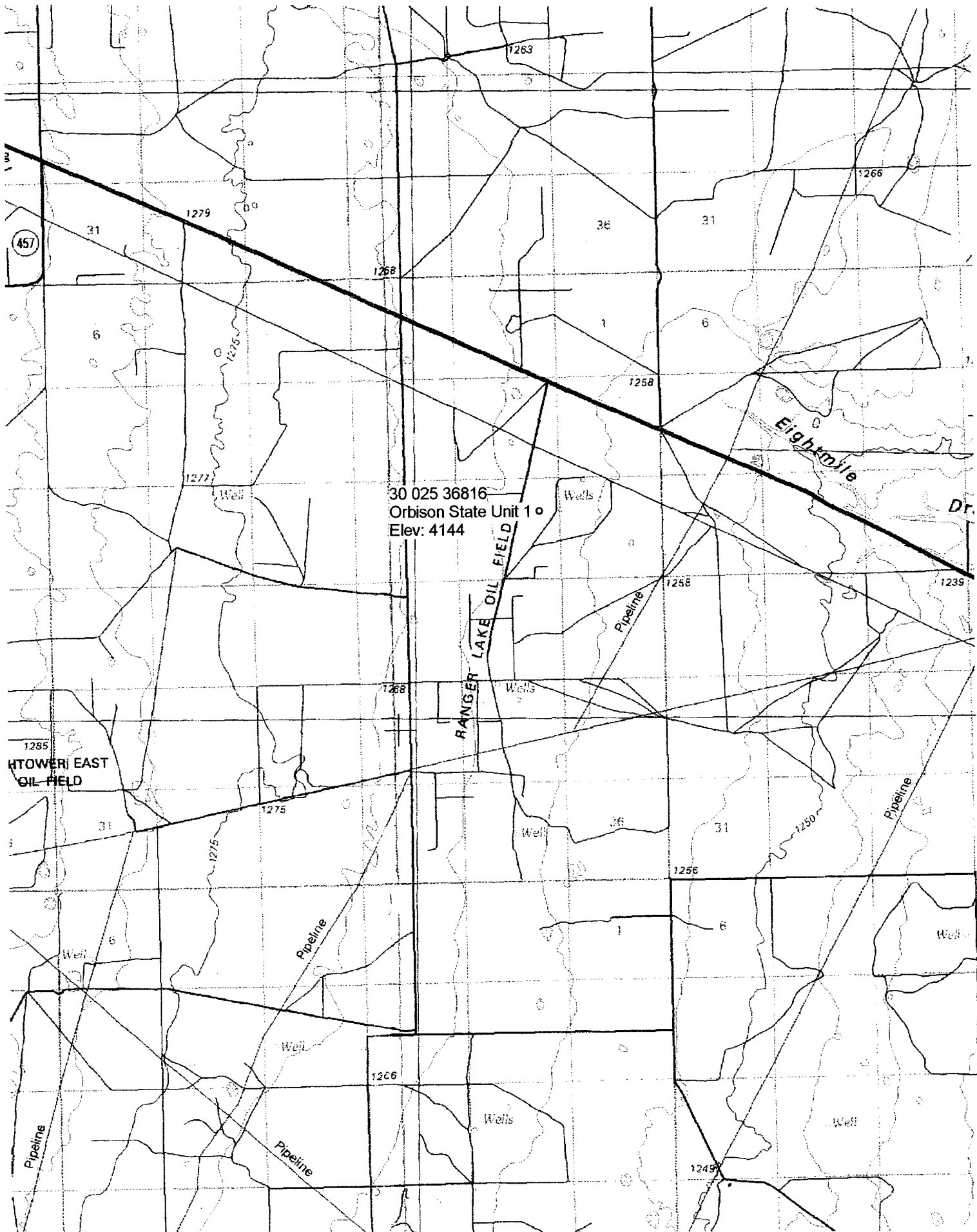

30 025 36816
Orbison State Unit 1 •
Elev: 4144

RANGER LAKE OIL FIELD

TOWER EAST OIL FIELD

Eightmile

Dr.

Pipeline

Pipeline

Pipeline

Pipeline

Pipeline

