

DISTRICT I
1625 N. French Dr., Hobbs, NM 88240
DISTRICT II
1301 W. Grand Avenue, Artesia, NM 88210
DISTRICT III
1000 Rio Brazos Rd., Aztec, NM 87410
DISTRICT IV
1220 S. St. Francis Dr., Santa Fe, NM 87505

State of New Mexico
Energy, Minerals and Natural Resources Department

Form C-102
Revised July 16, 2010

Submit one copy to appropriate
District Office

OIL CONSERVATION DIVISION

1220 South St. Francis Dr.
Santa Fe, New Mexico 87505

WELL LOCATION AND ACREAGE DEDICATION PLAT

☐ AMENDED REPORT

API Number 30025-40346	Pool Code 90403 97994	Pool Name WC-025 B-06 Bone Spring Wildcat
Property Code 38948	Property Name CASCADE "29" FEDERAL	Well Number 1H
OGRID No. 162683	Operator Name CIMAREX ENERGY CO. OF COLORADO	Elevation 3423'

Surface Location

UL or lot No. D	Section 29	Township 25 S	Range 33 E	Lot Idn	Feet from the 330	North/South line NORTH	Feet from the 350	East/West line WEST	County LEA
--------------------	---------------	------------------	---------------	---------	----------------------	---------------------------	----------------------	------------------------	---------------

Bottom Hole Location If Different From Surface

UL or lot No. M	Section 29	Township 25 S	Range 33 E	Lot Idn	Feet from the 4923'	North/South line N SOUTH	Feet from the 438	East/West line WEST	County LEA
--------------------	---------------	------------------	---------------	---------	------------------------	-----------------------------	----------------------	------------------------	---------------

Dedicated Acres 160	Joint or Infill	Consolidation Code	Order No. NSL Pending
------------------------	-----------------	--------------------	--------------------------

NO ALLOWABLE WILL BE ASSIGNED TO THIS COMPLETION UNTIL ALL INTERESTS HAVE BEEN CONSOLIDATED
OR A NON-STANDARD UNIT HAS BEEN APPROVED BY THE DIVISION

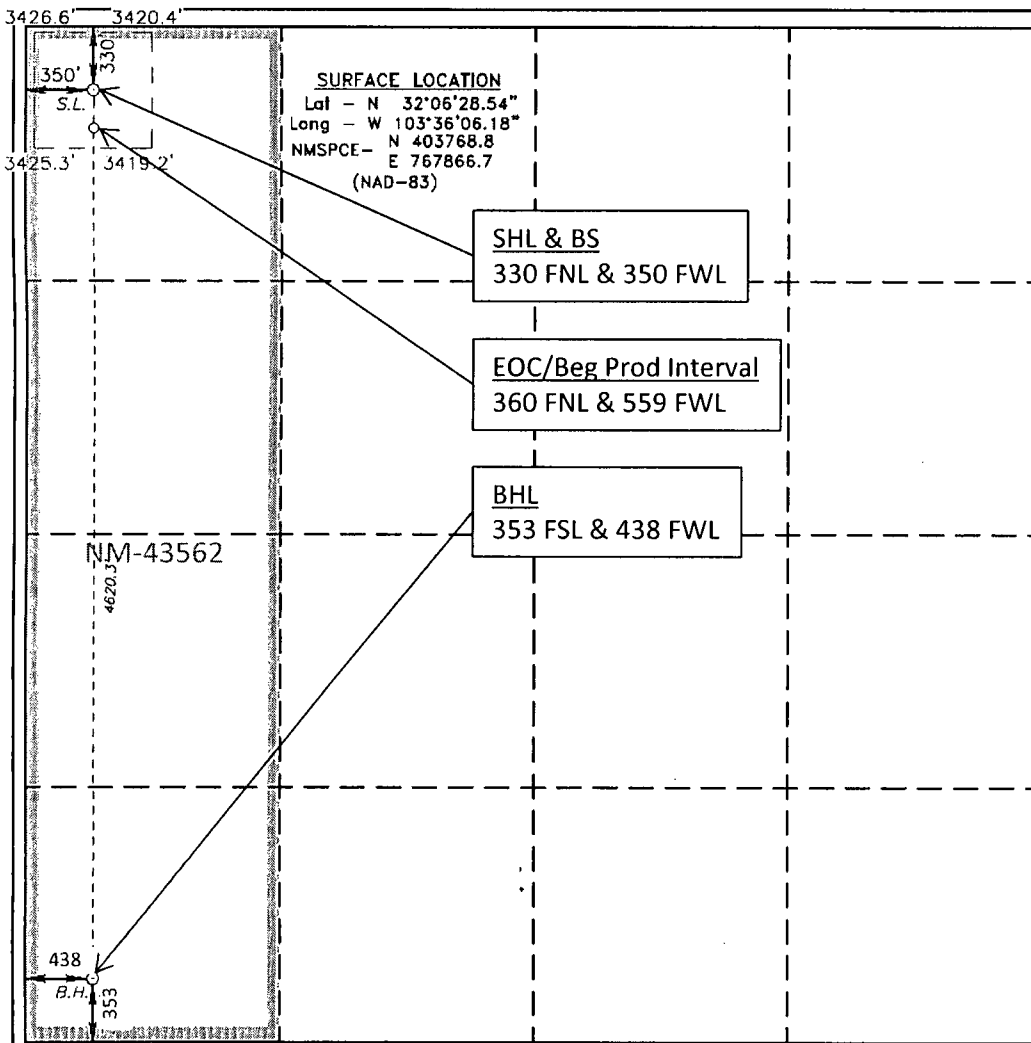

OPERATOR CERTIFICATION I hereby certify that the information contained herein is true and complete to the best of my knowledge and belief, and that this organization either owns a working interest or unleased mineral interest in the land including the proposed bottom hole location or has a right to drill this well at this location pursuant to a contract with an owner of such a mineral or working interest, or to a voluntary pooling agreement or a compulsory pooling order heretofore entered by the division. Signature: <i>Terri Stathem</i> Date: 12/10/2012 Printed Name: Terri Stathem Email Address: tstathem@cimarex.com	
SURVEYOR CERTIFICATION I hereby certify that the well location shown on this plat was plotted from field notes of actual surveys made by me or under my supervision, and that the same is true and correct to the best of my belief. Date Surveyed: 12/10/2012 Signature & Seal of Professional Surveyor: <i>Gary L. Jones</i> Certificate No. Gary L. Jones 7977 BASIN SURVEYS 25030	