

District I
1625 N. French Dr., Hobbs, NM 88240
Phone: (575) 393-6161 Fax: (575) 393-0720
District II
811 S. First St., Artesia, NM 88210
Phone: (575) 748-1283 Fax: (575) 748-9720
District III
1000 Rio Brazos Road, Aztec, NM 87410
Phone: (505) 334-6178 Fax: (505) 334-6170
District IV
1220 S. St. Francis Dr., Santa Fe, NM 87505
Phone: (505) 476-3460 Fax: (505) 476-3462

State of New Mexico

Form C-101
Revised November 14, 2012

Energy Minerals and Natural Resources

HOBBS OCD Oil Conservation Division

☐ AMENDED REPORT

1220 South St. Francis Dr.

Santa Fe, NM 87505

JAN 24 2013

RECEIVED

APPLICATION FOR PERMIT TO DRILL, RE-ENTER, DEEPEN, PLUGBACK, OR ADD A ZONE

| | | | |
|---|--|------------------------------|--|
| 1. Operator Name and Address COG Operating LLC 2208 West Main Street Artesia, NM 88210 | | 2. OGRID Number 229137 | |
| 3. Property Code 38001 | | 4. APL Number 30125 40955 | |
| 5. Property Name Corazon State Unit | | 6. Well No 13H | |

7. Surface Location

| UL - Lot | Section | Township | Range | Lot Idn | Feet from | N/S Line | Feet From | E/W Line | County |
|----------|---------|----------|-------|---------|-----------|----------|-----------|----------|--------|
| L | 4 | 21S | 33E | | 1980 | South | 50 | West | Lea |

8. Proposed Bottom Hole Location

| UL - Lot | Section | Township | Range | Lot Idn | Feet from | N/S Line | Feet From | E/W Line | County |
|----------|---------|----------|-------|---------|-----------|----------|-----------|----------|--------|
| I | 4 | 21S | 33E | | 1980 | South | 330 | East | Lea |

9. Pool Information

| Pool Name | Pool Code |
|----------------------|-----------|
| Wildcat; Bone Spring | 97895 |

Additional Well Information

| | | | | |
|---------------------------|-----------------------------|--|-------------------------|---------------------------------------|
| 11. Work Type New Well | 12. Well Type Oil | 13. Cable/Rotary | 14. Lease Type State | 15. Ground Level Elevation 3759.8' |
| 16. Multiple N | 17. Proposed Depth 18780 | 18. Formation Bone Spring | 19. Contractor | 20. Spud Date 1/29/2013 |
| Depth to Ground water | | Distance from nearest fresh water well | | Distance to nearest surface water |

21. Proposed Casing and Cement Program

| Type | Hole Size | Casing Size | Casing Weight/ft | Setting Depth | Sacks of Cement | Estimated TOC |
|-----------|-----------|-------------|------------------|---------------|-----------------|---------------|
| Surface | 17.5 | 13.375 | 54.5 | 1825 | 1100 | |
| Intrmd | 12.25 | 9.625 | 36 | 5500 | 1400 | |
| Open Hole | 7.875 | 5.5 | 17 | 18780 | 1600 | 5300 |

Casing/Cement Program: Additional Comments

Plan to drill a 17-1/2" hole to 1825' with Fresh Water. Run 13-3/8", 54.5#, J-55 csg and cmt to surface. Drill 12-1/4" hole to 5500' with Brine, and run 9-5/8", 36# J55 (40# f/3500 - 5500') and cement to surface. Drill 7-7/8" hole with cut brine to 10,800'. Kick off and drill curve then drill 7-7/8" lateral to approx. 18,780' MD (11,325' TVD). Run 5-1/2", 17#, P-110 csg and cement to 5300'.

Permit Expires 2 Years From Approval
Date Unless Drilling Underway

22. Proposed Blowout Prevention Program

| Type | Working Pressure | Test Pressure | Manufacturer |
|------------|------------------|---------------|--------------|
| Double Ram | 3000 | 3000 | Cameron |

23. I hereby certify that the information given above is true and complete to the best of my knowledge and belief.

I further certify that I have complied with 19.15.14.9 (A) NMAC ☒ and/or 19.15.14.9 (B) NMAC ☒ if applicable.

Signature: *Mayte Reyes*

Printed name: Mayte Reyes

Title: Regulatory Analyst

E-mail Address: mreyes1@concho.com

Date: 1/23/2013

Phone: 575-748-6945

OIL CONSERVATION DIVISION

Approved By:

Title: PETROLEUM ENGINEER

Approved Date: JAN 31 2013

Expiration Date:

Conditions of Approval Attached

FEB 04 2013

DISTRICT I

1625 N. FRENCH DR., HOBBS, NM 88240

HOBBS OCD

State of New Mexico
Energy, Minerals and Natural Resources Department

DISTRICT II

1301 W. GRAND AVENUE, ARTESIA, NM 88210

DISTRICT III

1000 RIO BRAZOS RD., AZTEC, NM 87412

DISTRICT IV

11885 S. ST. FRANCIS DR., SANTA FE, NM 87505

WELL LOCATION AND ACREAGE DEDICATION PLAT

☐ AMENDED REPORT

| | | |
|----------------------------|-------------------------------------|---|
| API Number 30-025-40955 | Pool Code 97895 | Pool Name Wildcat G-08 S213304D; Bone Spring |
| Property Code 38601 | Property Name CORAZON STATE UNIT | Well Number 13H |
| OGRID No. 229137 | Operator Name COG OPERATING, LLC | Elevation 3759.8' |

Surface Location

| UL or lot No. | Section | Township | Range | Lot Idn | Feet from the | North/South line | Feet from the | East/West line | County |
|---------------|---------|----------|-------|---------|---------------|------------------|---------------|----------------|--------|
| L | 4 | 21-S | 33-E | | 1980 | SOUTH | 50 | WEST | LEA |

Bottom Hole Location If Different From Surface

| UL or lot No. | Section | Township | Range | Lot Idn | Feet from the | North/South line | Feet from the | East/West line | County |
|--------------------------|-----------------|--------------------|-----------|---------|---------------|------------------|---------------|----------------|--------|
| I | 4 | 21-S | 33-E | | 1980 | SOUTH | 330 | EAST | LEA |
| Dedicated Acres 160.0 | Joint or Infill | Consolidation Code | Order No. | | | | | | |

NO ALLOWABLE WILL BE ASSIGNED TO THIS COMPLETION UNTIL ALL INTERESTS HAVE BEEN CONSOLIDATED
OR A NON-STANDARD UNIT HAS BEEN APPROVED BY THE DIVISION

| | | | | |
|---|--|--|--|---|
| <p><u>SURFACE LOCATION</u> Y=548590.7 N X=730559.1 E LAT.=32.505963° N LONG.=103.585455° W</p> <p><u>W 1/4 CORNER</u> Y=549250.5' N X=730503.6' E</p> <p><u>1/16 CORNER</u> Y=547930.7' N X=730514.5' E</p> | | <p><u>PROPOSED BOTTOM HOLE LOCATION</u> Y=548619.7 N X=735452.7 E LAT.=32.505947° N LONG.=103.569582° W</p> <p><u>E 1/4 CORNER</u> Y=549281.8' N X=735777.6' E</p> <p><u>1/16 CORNER</u> Y=547962.0' N X=735787.6' E</p> | | <p>OPERATOR CERTIFICATION</p> <p>I hereby certify that the information herein is true and complete to the best of my knowledge and belief, and that this organization either owns a working interest or unleased mineral interest in the land including the proposed bottom hole location or has a right to drill this well at this location pursuant to a contract with an owner of such mineral or working interest, or to a voluntary pooling agreement or a compulsory pooling order heretofore entered by the division.</p> <p><i>Melanie J. Parker</i> 1/23/13 Signature Date Melanie J. Parker Printed Name</p> |
| <p><u>GRID AZ. - 89°39'36"</u> <u>HORZ. DIST. - 4893.69'</u></p> | | <p><u>DATE SURVEYED</u> AUGUST 15, 2012</p> | | <p>SURVEYOR CERTIFICATION</p> <p>I hereby certify that the well location shown on this plat was plotted from field notes of actual surveys made by me or under my supervision, and that the same is true and correct to the best of my belief.</p> <p>CHAD HARCROW Professional Surveyor 2-078</p> <p>Certified No. CHAD HARCROW 17777 2012-037</p> |

SECTION 4, TOWNSHIP 21 SOUTH, RANGE 33 EAST, N.M.P.M.,
LEA COUNTY NEW MEXICO

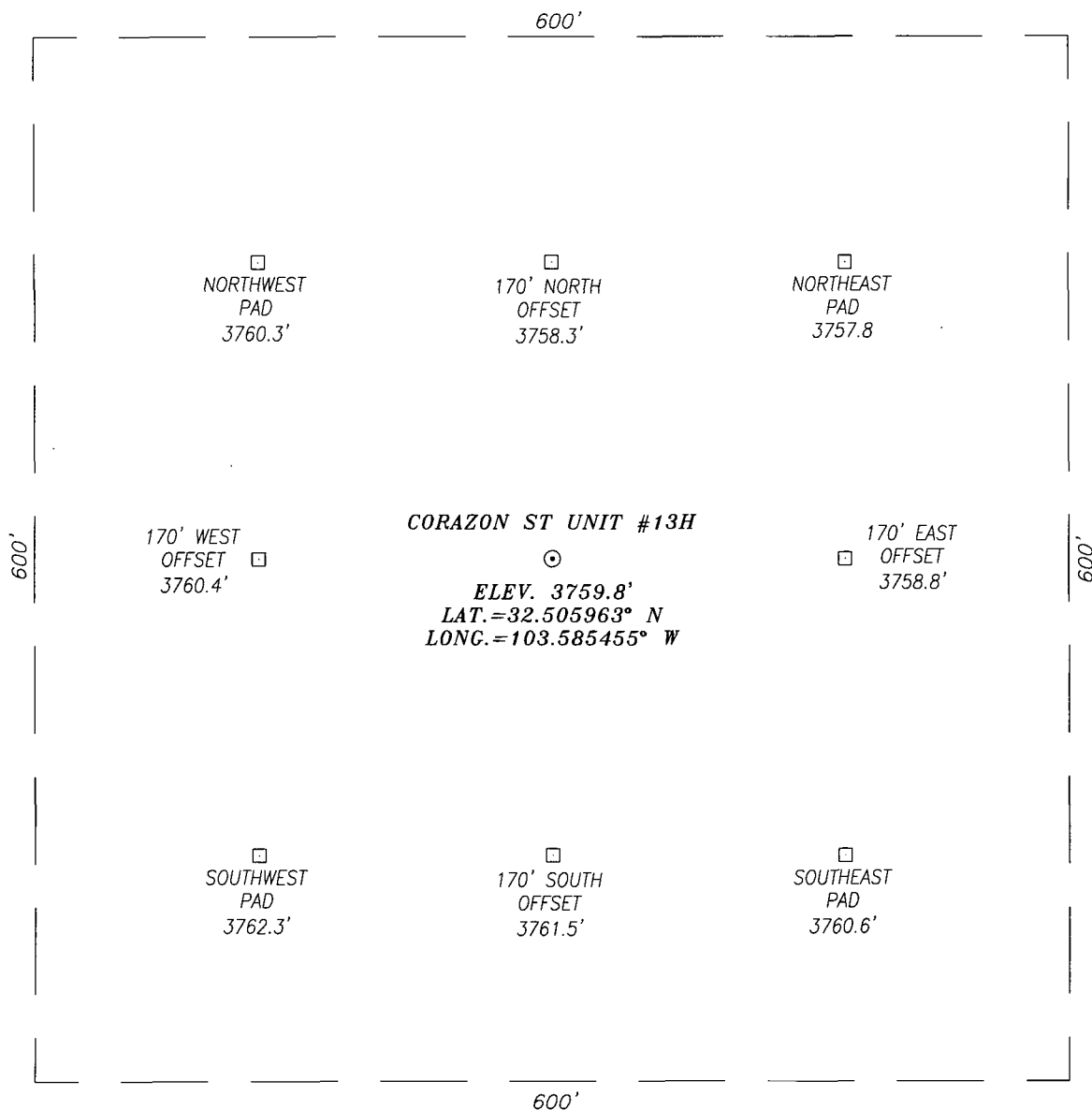

DIRECTIONS TO LOCATION

HEADING EAST ON HWY. 176 APPROXIMATELY 0.1 MILES PAST MILE MARKER
9 TURN RIGHT ONTO CALICHE LEASE ROAD. ON LEASE ROAD HEAD WEST
FOR APPROXIMATELY 0.3 MILES TO EXISTING PAD. MAKE WAY TO
SOUTHWEST PAD CORNER AND WELL IS 1.0 MILES SOUTH.

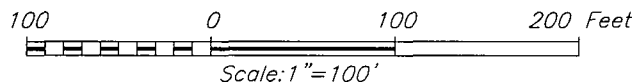

HARCROW SURVEYING
1107 WATSON, ARTESIA N.M. 88210
PH: (575) 513-2570
FAX: (575) 746-2808
EST. 2007



COG OPERATING, LLC

CORAZON ST UNIT #13H WELL
LOCATED 1980 FEET FROM THE SOUTH LINE
AND 50 FEET FROM THE WEST LINE OF SECTION 4,
TOWNSHIP 21 SOUTH, RANGE 33 EAST, N.M.P.M.,
LEA COUNTY, NEW MEXICO

| | |
|--------------------------------|-----------------------------|
| SURVEY DATE: AUGUST 07, 2012 | PAGE: 1 OF 1 |
| DRAFTING DATE: AUGUST 15, 2012 | |
| APPROVED BY: CH | DRAWN BY: DDSI FILE: 12-079 |

Topographic map of the Corazon St Unit #13H area. The map shows contour lines with elevations ranging from 3750 to 3875. Key features include:

- MILE MARKER 9**: Located at the top center of the map.
- EXISTING WELL PAD**: A rectangular area outlined in the upper right quadrant.
- CORAZON ST UNIT #13H**: The central area of the map, labeled with a large '4'.
- Gravel Pit**: Two locations, one near the mile marker and another in the upper right.
- Drill Hole**: A point marked with a black dot and a line pointing to it from the label.
- South Tank**: A small structure located near the bottom center.
- Tank**: A larger structure located near the bottom right.
- Trails**: Labeled as 'TRAIL' and 'JEOP' (likely Jeep trail).
- Grid**: A coordinate grid is overlaid on the map, with numbers 32, 33, 5, 4, 3, 8, 9, and 10 visible.

CONTOUR INTERVAL: 10'

HARCROW SURVEYING
1107 WATSON, ARTESIA N.M. 88210
PH: (575) 513-2570
FAX: (575) 746-2808
EST. 2007



| | | |
|--------------------------------|----------------|--------------|
| SURVEY DATE: AUGUST 07, 2012 | | PAGE: 1 OF 1 |
| DRAFTING DATE: AUGUST 15, 2012 | | |
| APPROVED BY: CH | DRAWN BY: DDSI | FILE: 12-079 |

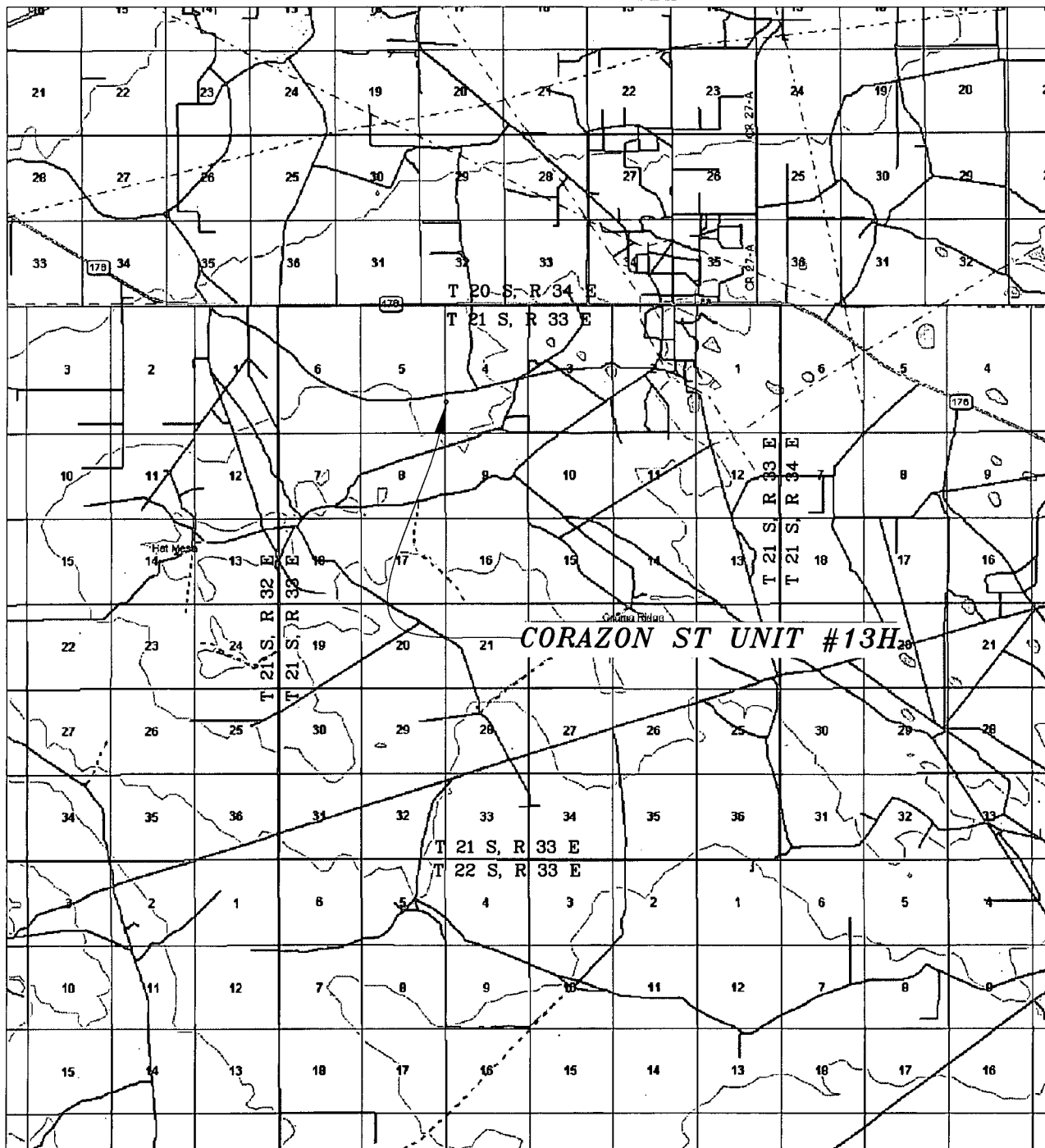

SEC. 4 TWP. 21-S RGE. 33-E
SURVEY N.M.P.M.
COUNTY LEA STATE NEW MEXICO
DESCRIPTION 1980' FSL & 50' FWL
ELEVATION 3760'
OPERATOR COG OPERATING, LLC
LEASE CORAZON ST UNIT

HARCROW SURVEYING
1107 WATSON, ARTESIA N.M. 88210
PH: (575) 513-2570
FAX: (575) 746-2808
EST. 2007



| | | |
|--------------------------------|----------------|--------------|
| SURVEY DATE: AUGUST 07, 2012 | | PAGE: 1 OF 1 |
| DRAFTING DATE: AUGUST 15, 2012 | | |
| APPROVED BY: CH | DRAWN BY: DDSI | FILE: 12-079 |