

Submit 1 Copy To Appropriate District Office
District I - (575) 393-6161
1625 N. French Dr., Hobbs, NM 88240
District II - (575) 748-1283
811 S. First St., Artesia, NM 88210
District III - (505) 334-6178
1000 Rio Brazos Rd., Aztec, NM 87410
District IV - (505) 476-3460
1220 S. St. Francis Dr., Santa Fe, NM 87505

State of New Mexico
Energy, Minerals and Natural Resources

Form C-103
Revised August 1, 2011

OIL CONSERVATION DIVISION
1220 South St. Francis Dr.
Santa Fe, NM 87505

HOBBS OCD
JAN 23 2013
RECEIVED

SUNDRY NOTICES AND REPORTS ON WELLS (DO NOT USE THIS FORM FOR PROPOSALS TO DRILL OR TO DEEPEN OR PLUG BACK TO A DIFFERENT RESERVOIR. USE "APPLICATION FOR PERMIT" (FORM C-101) FOR SUCH PROPOSALS.)		WELL API NO. 30-025-40619
1. Type of Well: Oil Well <input checked="" type="checkbox"/> Gas Well <input type="checkbox"/> Other <input type="checkbox"/>		5. Indicate Type of Lease STATE <input checked="" type="checkbox"/> FEE <input type="checkbox"/>
2. Name of Operator Cimarex Energy Co.		6. State Oil & Gas Lease No.
3. Address of Operator 600 N. Marienfeld St., Suite 600, Midland, TX 79701		7. Lease Name or Unit Agreement Name Blanco 3 State Com
4. Well Location Unit Letter O : 330 feet from the South line and 1980 feet from the East line Section 3 Township 23S Range 33E NMPM Lea County		8. Well Number 001H
11. Elevation (Show whether DR, RKB, RT, GR, etc.) 3570' GR		9. OGRID Number 215099
		10. Pool name or Wildcat Brinninstool; Bone Spring

12. Check Appropriate Box to Indicate Nature of Notice, Report or Other Data

NOTICE OF INTENTION TO:

PERFORM REMEDIAL WORK ☐ PLUG AND ABANDON ☐
TEMPORARILY ABANDON ☐ CHANGE PLANS ☐
PULL OR ALTER CASING ☐ MULTIPLE COMPL ☐
DOWNHOLE COMMINGLE ☐

SUBSEQUENT REPORT OF:

REMEDIAL WORK ☐ ALTERING CASING ☐
COMMENCE DRILLING OPNS. ☐ P AND A ☐
CASING/CEMENT JOB ☐

OTHER: frac water analysis & Info ☒

OTHER: ☐

13. Describe proposed or completed operations. (Clearly state all pertinent details, and give pertinent dates, including estimated date of starting any proposed work). SEE RULE 19.15.7.14 NMAC. For Multiple Completions: Attach wellbore diagram of proposed completion or recompletion.

Cimarex Energy respectfully requests approval of frac water from the Snoddy Federal frac pit to be used during the frac of the Blanco 3 State Com #1 well.

Attachments:

Frac water analysis
Snoddy frac pit diagram

Spud Date:

11/19/2012

Rig Release Date:

12/13/2012

I hereby certify that the information above is true and complete to the best of my knowledge and belief.

SIGNATURE  TITLE Regulatory Compliance DATE 1/18/2013

Type or print name Terri Stathem E-mail address: tstathem@cimarex.com PHONE: 918-295-1763

For State Use Only

APPROVED BY:  TITLE DIST. MGR DATE 3-4-2013

Conditions of Approval (if any):

SECTION 26, TOWNSHIP 20 SOUTH, RANGE 32 EAST, N.M.P.M.,
LEA COUNTY, NEW MEXICO.

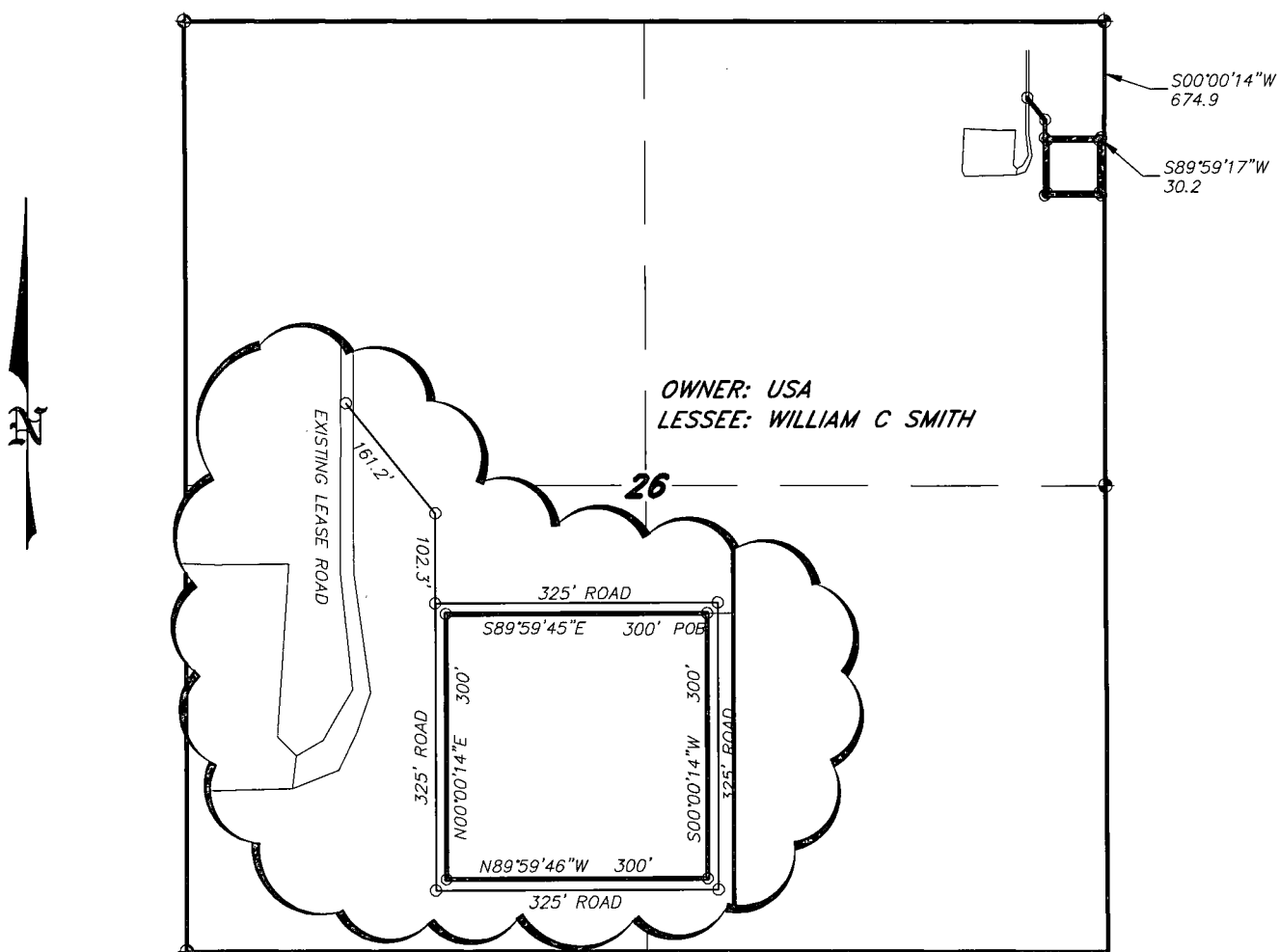

LEGAL DESCRIPTION

A TRACT OF LAND LOCATED IN SECTION 26, TOWNSHIP 20 SOUTH, RANGE 32 EAST, N.M.P.M., LEA COUNTY, NEW MEXICO AND BEING MORE PARTICULARLY DESCRIBED AS FOLLOWS:

BEGINNING AT A POINT WHICH LIES S.00°00'14"W., 674.9 FEET AND S.89°59'17"W., 30.2 FEET FROM THE NORTHEAST CORNER OF SAID SECTION 26; THENCE S.00°00'14"W., 300.0 FEET; THENCE N.89°59'46"W., 300.0 FEET; THENCE N.00°00'14"W., 300.0 FEET; THENCE S.89°59'45"E., 300.0 FEET TO THE POINT OF BEGINNING. SAID TRACT OF LAND BEING 2.07 ACRES, MORE OR LESS.

LEGAL DESCRIPTION

A STRIP OF LAND 25.0 FEET WIDE, LOCATED IN SECTION 26, TOWNSHIP 20 SOUTH, RANGE 32 EAST, N.M.P.M., LEA COUNTY, NEW MEXICO AND BEING 12.5 FEET LEFT AND RIGHT OF THE ABOVE PLATTED CENTERLINE SURVEY.

SECTION 26 = 1563.5 FEET = 94.76 RODS = 0.30 MILES = 0.90 ACRES

I HEREBY CERTIFY THAT THIS PLAT WAS PREPARED FROM FIELD NOTES OF AN ACTUAL SURVEY AND MEETS OR EXCEEDS ALL REQUIREMENTS FOR LAND SURVEYS AS SPECIFIED BY THIS STATE.

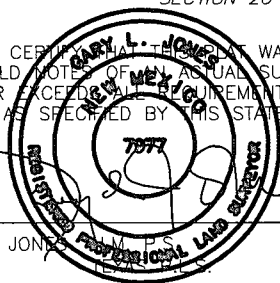

GARY L. JONES

No. 7977
No. 5074

1000 0 1000 2000 FEET

CIMAREX ENERGY CO. OF COLORADO

REF: PROPOSED FRAC PIT

A TRACT OF LAND LOCATED ON USA LAND IN
SECTION 26, TOWNSHIP 20 SOUTH, RANGE 32 EAST,
N.M.P.M., LEA COUNTY, NEW MEXICO.

BASTIN SURVEYS P.O. BOX 1786-HOBBS, NEW MEXICO

W.O. Number: 27109

Drawn By: J. M. SMALL

Date: 07-30-2012

Disk: JMS 27109

Survey Date: 07-27-2012

Sheet 1 of 1 Sheets

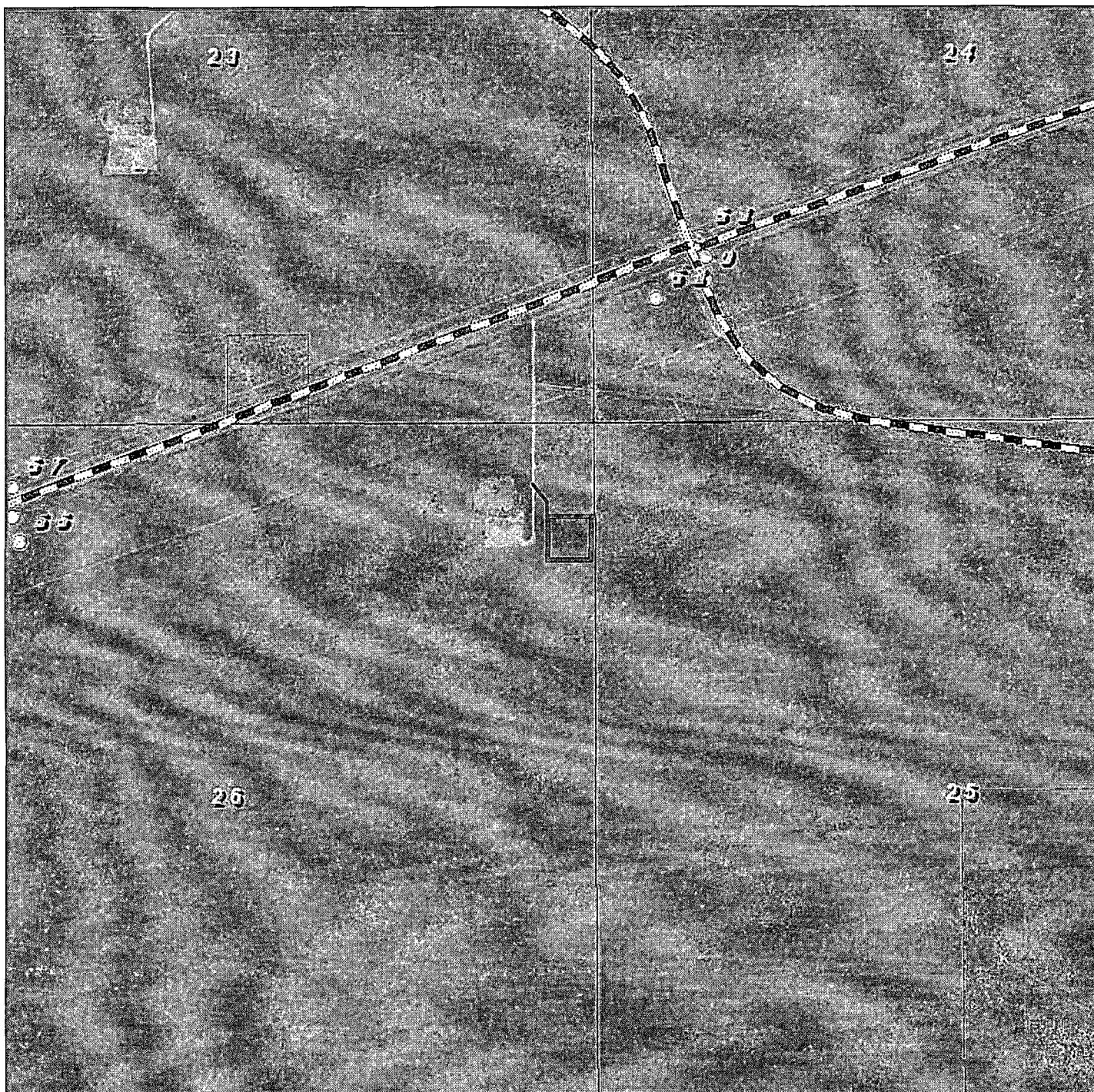

PROPOSED FRAC PIT

Section 26, Township 20 South, Range 32 East,
N.M.P.M., Lea County, New Mexico.

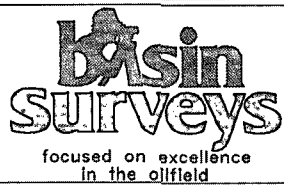

P.O. Box 1786
1120 N. West County Rd.
Hobbs, New Mexico 88241
(575) 393-7316 - Office
(575) 392-2206 - Fax
basinsurveys.com

W.O. Number: JMS 27109

Survey Date: 07-27-2012

Scale: 1" = 2000'

Date: 07-30-2012

CIMAREX
ENERGY CO.
OF COLORADO



PHONE (575) 393-2326 • 101 E. MARLAND • HOBBS, NM 88240

January 11, 2013

JOE L. PANDO

CIMAREX ENERGY CO.-MIDLAND

600 N. MARIENFELD ST, SUITE 600

MIDLAND, TX 79701

HOBBS OCD

JAN 23 2013

RECEIVED

RE: BLANCO 3 STATE 1H

Enclosed are the results of analyses for samples received by the laboratory on 01/02/13 15:00.

Cardinal Laboratories is accredited through Texas NELAP under certificate number T104704398-11-3. Accreditation applies to drinking water, non-potable water and solid and chemical materials. All accredited analytes are denoted by an asterisk (*). For a complete list on accredited analytes and matrices visit the TCEQ website at www.tceq.texas.gov/field/qa/lab_accred_certif.html.

Cardinal Laboratories is accredited through the State of Colorado Department of Public Health and Environment for:

Method EPA 552.2	Haloacetic Acids (HAA-5)
Method EPA 524.2	Total Trihalomethanes (TTHM)
Method EPA 524.4	Regulated VOCs (V1, V2, V3)

Accreditation applies to public drinking water matrices.

This report meets NELAP requirements and is made up of a cover page, analytical results, and a copy of the original chain-of-custody. If you have any questions concerning this report, please feel free to contact me.

Sincerely,

A handwritten signature in black ink that reads "Celey D. Keene". The signature is written in a cursive, flowing style.

Celey D. Keene

Lab Director/Quality Manager

Analytical Results For:

CIMAREX ENERGY CO.-MIDLAND
600 N. MARIENFELD ST, SUITE 600
MIDLAND TX, 79701

Project: BLANCO 3 STATE 1H
Project Number: NONE GIVEN
Project Manager: JOE L. PANDO
Fax To: UNK-NOWN

Reported:
11-Jan-13 10:03

Sample ID	Laboratory ID	Matrix	Date Sampled	Date Received
SNOODY PIT	H300006-01	Water	02-Jan-13 00:00	02-Jan-13 15:00

Cardinal Laboratories

* = Accredited Analyte

PLEASE NOTE: Liability and Damages. Cardinal's liability and client's exclusive remedy for any claim arising, whether based in contract or tort, shall be limited to the amount paid by client for analyses. All claims, including those for negligence and any other cause whatsoever shall be deemed waived unless made in writing and received by Cardinal within thirty (30) days after completion of the applicable service. In no event shall Cardinal be liable for incidental or consequential damages, including, without limitation, business interruptions, loss of use, or loss of profits incurred by client, its subsidiaries, affiliates or successors arising out of or related to the performance of the services hereunder by Cardinal, regardless of whether such claim is based upon any of the above stated reasons or otherwise. Results relate only to the samples identified above. This report shall not be reproduced except in full with written approval of Cardinal Laboratories.



Celey D. Keene, Lab Director/Quality Manager

Analytical Results For:

 CIMAREX ENERGY CO.-MIDLAND
 600 N. MARIENFELD ST, SUITE 600
 MIDLAND TX, 79701

 Project: BLANCO 3 STATE 1H
 Project Number: NONE GIVEN
 Project Manager: JOE L. PANDO
 Fax To: UNK-NOWN

 Reported:
 11-Jan-13 10:03

SNOODY PIT
H300006-01 (Water)

Analyte	Result	Reporting Limit	Units	Dilution	Batch	Analyst	Analyzed	Method	Notes
---------	--------	--------------------	-------	----------	-------	---------	----------	--------	-------

Cardinal Laboratories
Inorganic Compounds

Alkalinity, Bicarbonate	190	5.00	mg/L	1	2121709	AP	04-Jan-13	310.1	
Alkalinity, Carbonate	ND	0.00	mg/L	1	2121709	AP	04-Jan-13	310.1	
Chloride*	120	4.00	mg/L	1	3010318	DW	03-Jan-13	4500-Cl-B	
Conductivity*	871	1.00	uS/cm	1	3010404	AP	04-Jan-13	120.1	
pH*	8.09	0.100	pH Units	1	3010407	AP	04-Jan-13	150.1	
Sulfate*	99.1	10.0	mg/L	1	3010703	AP	08-Jan-13	375.4	
TDS*	520	5.00	mg/L	1	3010418	AP	04-Jan-13	160.1	
Alkalinity, Total*	156	4.00	mg/L	1	2121709	AP	04-Jan-13	310.1	

Dissolved Metals

Calcium	64.1	1.00	mg/L	1	3011102	CK	09-Jan-13	200.7	GAL
Magnesium	17.6	1.00	mg/L	1	3011102	CK	09-Jan-13	200.7	GAL
Potassium	4.53	1.00	mg/L	1	3011102	CK	09-Jan-13	200.7	GAL
Sodium	86.0	1.00	mg/L	1	3011102	CK	09-Jan-13	200.7	GAL

Cardinal Laboratories

*=Accredited Analyte

PLEASE NOTE: Liability and Damages. Cardinal's liability and client's exclusive remedy for any claim arising, whether based in contract or tort, shall be limited to the amount paid by client for analyses. All claims, including those for negligence and any other cause whatsoever shall be deemed waived unless made in writing and received by Cardinal within thirty (30) days after completion of the applicable service. In no event shall Cardinal be liable for incidental or consequential damages, including, without limitation, business interruptions, loss of use, or loss of profits incurred by client, its subsidiaries, affiliates or successors arising out of or related to the performance of the services hereunder by Cardinal, regardless of whether such claim is based upon any of the above stated reasons or otherwise. Results relate only to the samples identified above. This report shall not be reproduced except in full with written approval of Cardinal Laboratories.

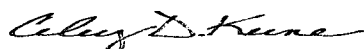

Celey D. Keene, Lab Director/Quality Manager

Analytical Results For:

 CIMAREX ENERGY CO.-MIDLAND
 600 N. MARIENFELD ST, SUITE 600
 MIDLAND TX, 79701

 Project: BLANCO 3 STATE 1H
 Project Number: NONE GIVEN
 Project Manager: JOE L. PANDO
 Fax To: UNK-NOWN

 Reported:
 11-Jan-13 10:03

Inorganic Compounds - Quality Control
Cardinal Laboratories

Analyte	Result	Reporting Limit	Units	Spike Level	Source Result	%REC	%REC Limits	RPD	RPD Limit	Notes
---------	--------	-----------------	-------	-------------	---------------	------	-------------	-----	-----------	-------

Batch 2121709 - General Prep - Wet Chem
Blank (2121709-BLK1)

Prepared & Analyzed: 17-Dec-12

Alkalinity, Carbonate	ND	0.00	mg/L							
Alkalinity, Bicarbonate	ND	5.00	mg/L							
Alkalinity, Total	ND	4.00	mg/L							

LCS (2121709-BS1)

Prepared & Analyzed: 17-Dec-12

Alkalinity, Carbonate	ND	0.00	mg/L				80-120			
Alkalinity, Bicarbonate	146	5.00	mg/L				80-120			
Alkalinity, Total	120	4.00	mg/L	100		120	80-120			

LCS Dup (2121709-BSD1)

Prepared & Analyzed: 17-Dec-12

Alkalinity, Carbonate	ND	0.00	mg/L				80-120		20	
Alkalinity, Bicarbonate	142	5.00	mg/L				80-120	2.78	20	
Alkalinity, Total	116	4.00	mg/L	100		116	80-120	3.39	20	

Batch 3010318 - General Prep - Wet Chem
Blank (3010318-BLK1)

Prepared & Analyzed: 03-Jan-13

Chloride	ND	4.00	mg/L							
----------	----	------	------	--	--	--	--	--	--	--

LCS (3010318-BS1)

Prepared & Analyzed: 03-Jan-13

Chloride	108	4.00	mg/L	100		108	80-120			
----------	-----	------	------	-----	--	-----	--------	--	--	--

LCS Dup (3010318-BSD1)

Prepared & Analyzed: 03-Jan-13

Chloride	104	4.00	mg/L	100		104	80-120	3.77	20	
----------	-----	------	------	-----	--	-----	--------	------	----	--

Batch 3010404 - General Prep - Wet Chem
LCS (3010404-BS1)

Prepared: 03-Jan-13 Analyzed: 04-Jan-13

Conductivity	472		uS/cm	500		94.4	80-120			
--------------	-----	--	-------	-----	--	------	--------	--	--	--

Cardinal Laboratories

*=Accredited Analyte

PLEASE NOTE: Liability and Damages. Cardinal's liability and client's exclusive remedy for any claim arising, whether based in contract or tort, shall be limited to the amount paid by client for analyses. All claims, including those for negligence and any other cause whatsoever shall be deemed waived unless made in writing and received by Cardinal within thirty (30) days after completion of the applicable service. In no event shall Cardinal be liable for incidental or consequential damages, including, without limitation, business interruptions, loss of use, or loss of profits incurred by client, its subsidiaries, affiliates or successors arising out of or related to the performance of the services hereunder by Cardinal, regardless of whether such claim is based upon any of the above stated reasons or otherwise. Results relate only to the samples identified above. This report shall not be reproduced except in full with written approval of Cardinal Laboratories.

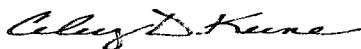

Celey D. Keene, Lab Director/Quality Manager



PHONE (575) 393-2326 • 101 E. MARLAND • HOBBS, NM 88240

Analytical Results For:CIMAREX ENERGY CO.-MIDLAND
600 N. MARIENFELD ST, SUITE 600
MIDLAND TX, 79701Project: BLANCO 3 STATE 1H
Project Number: NONE GIVEN
Project Manager: JOE L. PANDO
Fax To: UNK-NOWNReported:
11-Jan-13 10:03**Inorganic Compounds - Quality Control****Cardinal Laboratories**

Analyte	Result	Reporting Limit	Units	Spike Level	Source Result	%REC	%REC Limits	RPD	RPD Limit	Notes
Batch 3010404 - General Prep - Wet Chem										
Duplicate (3010404-DUP1)		Source: H300003-01			Prepared: 03-Jan-13 Analyzed: 04-Jan-13					
Conductivity	589	1.00	uS/cm		577			2.06	20	
Batch 3010407 - NO PREP										
LCS (3010407-BS1)		Prepared: 03-Jan-13 Analyzed: 04-Jan-13								
pH	6.98		pH Units	7.00		99.7	90-110			
Duplicate (3010407-DUP1)		Source: H300003-01			Prepared: 03-Jan-13 Analyzed: 04-Jan-13					
pH	7.95	0.100	pH Units		7.38			7.44	20	
Batch 3010418 - Filtration										
Blank (3010418-BLK1)		Prepared: 04-Jan-13 Analyzed: 09-Jan-13								
TDS	ND	5.00	mg/L							
LCS (3010418-BS1)		Prepared: 04-Jan-13 Analyzed: 09-Jan-13								
TDS	250	5.00	mg/L	240		104	80-120			
Batch 3010703 - General Prep - Wet Chem										
Blank (3010703-BLK1)		Prepared & Analyzed: 08-Jan-13								
Sulfate	ND	10.0	mg/L							
LCS (3010703-BS1)		Prepared & Analyzed: 08-Jan-13								
Sulfate	21.5	10.0	mg/L	20.0		107	80-120			

Cardinal Laboratories

* = Accredited Analyte

PLEASE NOTE: Liability and Damages. Cardinal's liability and client's exclusive remedy for any claim arising, whether based in contract or tort, shall be limited to the amount paid by client for analyses. All claims, including those for negligence and any other cause whatsoever shall be deemed waived unless made in writing and received by Cardinal within thirty (30) days after completion of the applicable service. In no event shall Cardinal be liable for incidental or consequential damages, including, without limitation, business interruptions, loss of use, or loss of profits incurred by client, its subsidiaries, affiliates or successors arising out of or related to the performance of the services hereunder by Cardinal, regardless of whether such claim is based upon any of the above stated reasons or otherwise. Results relate only to the samples identified above. This report shall not be reproduced except in full with written approval of Cardinal Laboratories.

Celey D. Keene, Lab Director/Quality Manager



PHONE (575) 393-2326 ° 101 E. MARLAND ° HOBBS, NM 88240

Analytical Results For:

CIMAREX ENERGY CO.-MIDLAND
600 N. MARIENFELD ST, SUITE 600
MIDLAND TX, 79701

Project: BLANCO 3 STATE 1H
Project Number: NONE GIVEN
Project Manager: JOE L. PANDO
Fax To: UNK-NOWN

Reported:
11-Jan-13 10:03

Inorganic Compounds - Quality Control

Cardinal Laboratories

Analyte	Result	Reporting Limit	Units	Spike Level	Source Result	%REC	%REC Limits	RPD	RPD Limit	Notes
---------	--------	--------------------	-------	----------------	------------------	------	----------------	-----	--------------	-------

Batch 3010703 - General Prep - Wet Chem

LCS Dup (3010703-BSD1)

Prepared & Analyzed: 08-Jan-13

Sulfate	22.6	10.0	mg/L	20.0		113	80-120	5.40	20	
---------	------	------	------	------	--	-----	--------	------	----	--

Cardinal Laboratories

*=Accredited Analyte

PLEASE NOTE: Liability and Damages. Cardinal's liability and client's exclusive remedy for any claim arising, whether based in contract or tort, shall be limited to the amount paid by client for analyses. All claims, including those for negligence and any other cause whatsoever shall be deemed waived unless made in writing and received by Cardinal within thirty (30) days after completion of the applicable service. In no event shall Cardinal be liable for incidental or consequential damages, including, without limitation, business interruptions, loss of use, or loss of profits incurred by client, its subsidiaries, affiliates or successors arising out of or related to the performance of the services hereunder by Cardinal, regardless of whether such claim is based upon any of the above stated reasons or otherwise. Results relate only to the samples identified above. This report shall not be reproduced except in full with written approval of Cardinal Laboratories.

Celey D. Keene, Lab Director/Quality Manager

Analytical Results For:

 CIMAREX ENERGY CO.-MIDLAND
 600 N. MARIENFELD ST, SUITE 600
 MIDLAND TX, 79701

 Project: BLANCO 3 STATE 1H
 Project Number: NONE GIVEN
 Project Manager: JOE L. PANDO
 Fax To: UNK-NOWN

 Reported:
 11-Jan-13 10:03

Dissolved Metals - Quality Control
Cardinal Laboratories

Analyte	Result	Reporting Limit	Units	Spike Level	Source Result	%REC Limits	RPD	RPD Limit	Notes
---------	--------	--------------------	-------	----------------	------------------	----------------	-----	--------------	-------

Batch 3011102 - Dissolved/Potentially Dissolved Metals
Blank (3011102-BLK1)

Prepared: 07-Jan-13 Analyzed: 09-Jan-13

Magnesium	ND	1.00	mg/L						
Potassium	ND	1.00	mg/L						
Sodium	ND	1.00	mg/L						
Calcium	ND	1.00	mg/L						

LCS (3011102-BS1)

Prepared: 07-Jan-13 Analyzed: 09-Jan-13

Magnesium	26.9		mg/L	25.0		108	85-115		
Calcium	4.80		mg/L	5.00		96.0	85-115		
Potassium	8.87		mg/L	10.0		88.7	85-115		
Sodium	7.80		mg/L	8.10		96.3	85-115		

LCS Dup (3011102-BSD1)

Prepared: 07-Jan-13 Analyzed: 09-Jan-13

Magnesium	26.8		mg/L	25.0		107	85-115	0.372	20
Sodium	7.90		mg/L	8.10		97.5	85-115	1.27	20
Calcium	4.82		mg/L	5.00		96.4	85-115	0.416	20
Potassium	8.87		mg/L	10.0		88.7	85-115	0.00	20

Cardinal Laboratories

*==Accredited Analyte

PLEASE NOTE: Liability and Damages. Cardinal's liability and client's exclusive remedy for any claim arising, whether based in contract or tort, shall be limited to the amount paid by client for analyses. All claims, including those for negligence and any other cause whatsoever shall be deemed waived unless made in writing and received by Cardinal within thirty (30) days after completion of the applicable service. In no event shall Cardinal be liable for incidental or consequential damages, including, without limitation, business interruptions, loss of use, or loss of profits incurred by client, its subsidiaries, affiliates or successors arising out of or related to the performance of the services hereunder by Cardinal, regardless of whether such claim is based upon any of the above stated reasons or otherwise. Results relate only to the samples identified above. This report shall not be reproduced except in full with written approval of Cardinal Laboratories.

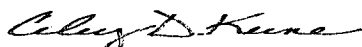

Celey D. Keene, Lab Director/Quality Manager

Notes and Definitions

GAL	Analysis subcontracted to Green Analytical Laboratories, a subsidiary of Cardinal Laboratories.
ND	Analyte NOT DETECTED at or above the reporting limit
RPD	Relative Percent Difference
**	Samples not received at proper temperature of 6°C or below.
***	Insufficient time to reach temperature.
-	Chloride by SM4500Cl-B does not require samples be received at or below 6°C Samples reported on an as received basis (wet) unless otherwise noted on report

Cardinal Laboratories

*=Accredited Analyte

PLEASE NOTE: Liability and Damages. Cardinal's liability and client's exclusive remedy for any claim arising, whether based in contract or tort, shall be limited to the amount paid by client for analyses. All claims, including those for negligence and any other cause whatsoever shall be deemed waived unless made in writing and received by Cardinal within thirty (30) days after completion of the applicable service. In no event shall Cardinal be liable for incidental or consequential damages, including, without limitation, business interruptions, loss of use, or loss of profits incurred by client, its subsidiaries, affiliates or successors arising out of or related to the performance of the services hereunder by Cardinal, regardless of whether such claim is based upon any of the above stated reasons or otherwise. Results relate only to the samples identified above. This report shall not be reproduced except in full with written approval of Cardinal Laboratories.

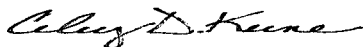

Celey D. Keene, Lab Director/Quality Manager



CHAIN-OF-CUSTODY AND ANALYSIS REQUEST

101 East Marland, Hobbs, NM 88240
(575) 393-2326 FAX (575) 393-2476

Company Name:		Project Manager:		Address:		City:		State:		Zip:		Phone #:		Fax #:		Project #:		Project Owner:		Project Name:		Project Location:		Sampler Name:																																					
Company Name: <i>Conroy Energy</i>												Project Manager: <i>Joe L. Conroy</i>																																																	
Address: <i>622 N. Montanfield St. Suite 100</i>												City: <i>Midland</i>												State: <i>Tx</i>		Zip: <i>79701</i>		Phone #:		Fax #:																															
Project #:												Project Owner:		Project Name: <i>Blanco 3 St 1H</i>		Project Location:		Sampler Name:																																											
P.O. #:												Company:												Attn:		Address:		City:		State:		Zip:		Phone #:		Fax #:																									
FOR LAB USE ONLY												Lab I.D. <i>10002021</i>												Sample I.D. <i>Sandy P.H</i>												GRAB OR (C)OMP. <i>#</i>		# CONTAINERS		GROUNDWATER		WASTEWATER		SOIL		OIL		SLUDGE		OTHER		ACID/BASE		ICE / COOL		OTHER		DATE		TIME	

PLEASE NOTE: Liability and Damages. Cardinal's liability and client's exclusive remedy for any claim arising whether based in contract or tort, shall be limited to the amount paid by the client for the analyses. All claims, including those for negligence and any other cause whatsoever shall be deemed waived unless made in writing and received by Cardinal within 30 days after completion of the applicable service. In no event shall Cardinal be liable for incidental or consequential damages, including without limitation, business interruptions, loss of use, or loss of profits incurred by client, its subsidiaries, affiliates or successors arising out of or related to the performance of services hereunder by Cardinal, regardless of whether such claim is based upon any of the above stated reasons or otherwise.

Relinquished By:		Date:		Received By:		Phone Result:		Fax Result:		Add'l Phone #:		Add'l Fax #:	
<i>[Signature]</i>		<i>1-2-03</i>		<i>[Signature]</i>		<input type="checkbox"/> Yes <input type="checkbox"/> No		<input type="checkbox"/> Yes <input type="checkbox"/> No					
Time:		Time:		Time:		REMARKS:		REMARKS:		REMARKS:		REMARKS:	
<i>3:00</i>		<i>3:00</i>		<i>3:00</i>		<i>email Joe Miller Danney</i>							
Relinquished By:		Date:		Received By:		Sample Condition		CHECKED BY:					
						Cool Intact		(Initials)					
						<input type="checkbox"/> Yes <input type="checkbox"/> No		<i>CDH</i>					
Delivered By: (Circle One)		Sampler - UPS - Bus - Other:											

† Cardinal cannot accept verbal changes. Please fax written changes to (575) 393-2326

MASS BALANCE SHEET

Parameter	Result	Units	Method
Calcium	64.1	mg/L	EPA 200.7
Magnesium	17.6	mg/L	EPA 200.7
Sodium	86	mg/L	EPA 200.7
Potassium	4.53	mg/L	EPA 200.7
Carbonate	0	mg/L	EPA 310.1
Bicarbonate	190	mg/L	EPA 310.1
Sulfate	99.1	mg/L	EPA 375.4
T-Alkalinity	156	mg/L	EPA 310.1
Chloride	120	mg/L	SM4500
Conductance	871	mg/L	EPA 120.1
TDS	520	mg/L	EPA 160.1

H300006-01

Comments:

Anion-Cation Balance Acceptable Y/N?	
Analyte	Meq/L
Carbonate	0
Bicarbonate	3
Sulfate	2
Chloride	3
Calcium	3
Magnesium	1
Sodium	4
Potassium	0

Total Anions	9
Total Cations	9
Anion/Cation (%Diff)	0.34
Calculated TDS	484.93
TDS Ratio (Measured/Calc)	1.07
TDS/COND Ratio	0.59701493

February 28, 2013

GREG LINGAFELTER
CIMAREX ENERGY CO.-MIDLAND
600 N. MARIENFELD ST, SUITE 600
MIDLAND, TX 79701

HOBBS OCD

FEB 28 2013

RECEIVED

RE: SNODDY POND

Enclosed are the results of analyses for samples received by the laboratory on 01/24/13 14:12.

Cardinal Laboratories is accredited through Texas NELAP under certificate number T104704398-11-3. Accreditation applies to drinking water, non-potable water and solid and chemical materials. All accredited analytes are denoted by an asterisk (*). For a complete list on accredited analytes and matrices visit the TCEQ website at www.tceq.texas.gov/field/qa/lab_accred_certif.html.

Cardinal Laboratories is accredited through the State of Colorado Department of Public Health and Environment for:

Method EPA 552.2	Haloacetic Acids (HAA-5)
Method EPA 524.2	Total Trihalomethanes (TTHM)
Method EPA 524.4	Regulated VOCs (V1, V2, V3)

Accreditation applies to public drinking water matrices.

This report meets NELAP requirements and is made up of a cover page, analytical results, and a copy of the original chain-of-custody. If you have any questions concerning this report, please feel free to contact me.

Sincerely,

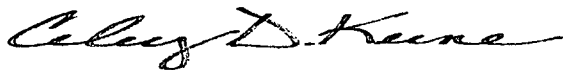

Celey D. Keene
Lab Director/Quality Manager

Analytical Results For:

CIMAREX ENERGY CO.-MIDLAND
600 N. MARIENFELD ST, SUITE 600
MIDLAND TX, 79701

Project: SNODDY POND
Project Number: NONE GIVEN
Project Manager: GREG LINGAFELTER
Fax To: UNK-NOWN

Reported:
28-Feb-13 15:54

Sample ID	Laboratory ID	Matrix	Date Sampled	Date Received
SNODDY POND WATER	H300208-01	Water	24-Jan-13 12:30	24-Jan-13 14:12

Cardinal Laboratories

*=Accredited Analyte

PLEASE NOTE: Liability and Damages. Cardinal's liability and client's exclusive remedy for any claim arising, whether based in contract or tort, shall be limited to the amount paid by client for analyses. All claims, including those for negligence and any other cause whatsoever shall be deemed waived unless made in writing and received by Cardinal within thirty (30) days after completion of the applicable service. In no event shall Cardinal be liable for incidental or consequential damages, including, without limitation, business interruptions, loss of use, or loss of profits incurred by client, its subsidiaries, affiliates or successors arising out of or related to the performance of the services hereunder by Cardinal, regardless of whether such claim is based upon any of the above stated reasons or otherwise. Results relate only to the samples identified above. This report shall not be reproduced except in full with written approval of Cardinal Laboratories.

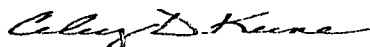

Celey D. Keene, Lab Director/Quality Manager

Analytical Results For:

CIMAREX ENERGY CO.-MIDLAND
600 N. MARIENFELD ST, SUITE 600
MIDLAND TX, 79701

Project: SNODDY POND
Project Number: NONE GIVEN
Project Manager: GREG LINGAFELTER
Fax To: UNK-NOWN

Reported:
28-Feb-13 15:54

SNODDY POND WATER

H300208-01 (Water)

Analyte	Result	Reporting Limit	Units	Dilution	Batch	Analyst	Analyzed	Method	Notes
---------	--------	-----------------	-------	----------	-------	---------	----------	--------	-------

Cardinal Laboratories

Inorganic Compounds

Chloride*	52.0	4.00	mg/L	1	3012507	DW	25-Jan-13	4500-Cl-B	
Cyanide (total)	ND	0.010	mg/L	1	3020815	CK	07-Feb-13	335.4	GAL
Fluoride	0.965	0.200	mg/L	1	3020814	CK	28-Jan-13	4500F C	GAL
Nitrate as N	2.30	0.100	mg/L	1	3012511	AP	25-Jan-13	353.3	
pH*	7.73	0.100	pH Units	1	3012513	DW	25-Jan-13	150.1	
Phenols	ND	0.050	mg/L	1	3020816	CK	07-Feb-13	420.1	GAL
Sulfate*	46.0	10.0	mg/L	1	3012802	DW	28-Jan-13	375.4	
TDS*	306	5.00	mg/L	1	3013002	AP	30-Jan-13	160.1	

Dissolved Metals

Aluminum	ND	0.0500	mg/L	1	3020806	CK	28-Jan-13	200.7	GAL
Arsenic	ND	0.100	mg/L	1	3020806	CK	28-Jan-13	200.7	GAL
Barium	0.101	0.010	mg/L	1	3020806	CK	28-Jan-13	200.7	GAL
Boron	ND	0.200	mg/L	1	3020806	CK	28-Jan-13	200.7	GAL
Cadmium	ND	0.00010	mg/L	1	3020807	CK	05-Feb-13	200.8	GAL
Chromium	ND	0.050	mg/L	1	3020806	CK	28-Jan-13	200.7	GAL
Cobalt	ND	0.0500	mg/L	1	3020806	CK	28-Jan-13	200.7	GAL
Copper	ND	0.020	mg/L	1	3020806	CK	28-Jan-13	200.7	GAL
Iron	ND	0.050	mg/L	1	3020806	CK	28-Jan-13	200.7	GAL
Lead	ND	0.0005	mg/L	1	3020807	CK	05-Feb-13	200.8	GAL
Manganese	ND	0.005	mg/L	1	3020806	CK	28-Jan-13	200.7	GAL
Molybdenum	ND	0.0500	mg/L	1	3020806	CK	28-Jan-13	200.7	GAL
Nickel	ND	0.0500	mg/L	1	3020806	CK	28-Jan-13	200.7	GAL
Selenium	0.005	0.001	mg/L	1	3020807	CK	05-Feb-13	200.8	GAL
Silver	ND	0.050	mg/L	1	3020806	CK	28-Jan-13	200.7	GAL
Uranium	0.00130	0.000100	mg/L	1	3020807	CK	05-Feb-13	200.8	GAL
Zinc	ND	0.050	mg/L	1	3020806	CK	28-Jan-13	200.7	GAL

Cardinal Laboratories

*=Accredited Analyte

PLEASE NOTE: Liability and Damages. Cardinal's liability and client's exclusive remedy for any claim arising, whether based in contract or tort, shall be limited to the amount paid by client for analyses. All claims, including those for negligence and any other cause whatsoever shall be deemed waived unless made in writing and received by Cardinal within thirty (30) days after completion of the applicable service. In no event shall Cardinal be liable for incidental or consequential damages, including, without limitation, business interruptions, loss of use, or loss of profits incurred by client, its subsidiaries, affiliates or successors arising out of or related to the performance of the services hereunder by Cardinal, regardless of whether such claim is based upon any of the above stated reasons or otherwise. Results relate only to the samples identified above. This report shall not be reproduced except in full with written approval of Cardinal Laboratories.

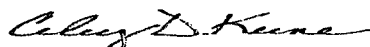

Celey D. Keene, Lab Director/Quality Manager

Analytical Results For:

CIMAREX ENERGY CO.-MIDLAND
600 N. MARIENFELD ST, SUITE 600
MIDLAND TX, 79701

Project: SNODDY POND
Project Number: NONE GIVEN
Project Manager: GREG LINGAFELTER
Fax To: UNK-NOWN

Reported:
28-Feb-13 15:54

SNODDY POND WATER
H300208-01 (Water)

Analyte	Result	Reporting Limit	Units	Dilution	Batch	Analyst	Analyzed	Method	Notes
---------	--------	-----------------	-------	----------	-------	---------	----------	--------	-------

Cardinal Laboratories
Mercury (Total) by CVAA

Mercury	ND	0.0002	mg/L	1	3020808	CK	31-Jan-13	245.1	GAL
---------	----	--------	------	---	---------	----	-----------	-------	-----

Radionuclides
SUB-RS

Radium-226	ND	0.40	pCi/L	1	3022810	CK	31-Jan-13	903.1/904	
Radium-228	ND	0.40	pCi/L	1	3022810	CK	31-Jan-13	903.1/904	
Combined Radium	ND	0.40	pCi/L	1	3022810	CK	31-Jan-13	903.1/904	

PCBs BY GC/ECD
SUB-SS

PCB 1016	ND	2.00	ug/L	1	3020407	CK	01-Feb-13	8082	
PCB 1221	ND	2.00	ug/L	1	3020407	CK	01-Feb-13	8082	
PCB 1232	ND	2.00	ug/L	1	3020407	CK	01-Feb-13	8082	
PCB 1242	ND	2.00	ug/L	1	3020407	CK	01-Feb-13	8082	
PCB 1248	ND	2.00	ug/L	1	3020407	CK	01-Feb-13	8082	
PCB 1254	ND	2.00	ug/L	1	3020407	CK	01-Feb-13	8082	
PCB 1260	ND	2.00	ug/L	1	3020407	CK	01-Feb-13	8082	
Surrogate: Tetrachloro-meta-xylene		103 %	35-140		3020407	CK	01-Feb-13	8082	

Volatile Organic Compounds by EPA Method 8260B

Vinyl chloride*	ND	0.001	mg/L	1	3012807	ms	28-Jan-13	8260	
1,1-Dichloroethene*	ND	0.001	mg/L	1	3012807	ms	28-Jan-13	8260	
Methylene chloride*	ND	0.001	mg/L	1	3012807	ms	28-Jan-13	8260	
1,1-Dichloroethane*	ND	0.001	mg/L	1	3012807	ms	28-Jan-13	8260	
Chloroform*	ND	0.001	mg/L	1	3012807	ms	28-Jan-13	8260	
Carbon tetrachloride*	ND	0.001	mg/L	1	3012807	ms	28-Jan-13	8260	
1,1,1-Trichloroethane*	ND	0.001	mg/L	1	3012807	ms	28-Jan-13	8260	
Benzene*	ND	0.001	mg/L	1	3012807	ms	28-Jan-13	8260	
1,2-Dichloroethane*	ND	0.001	mg/L	1	3012807	ms	28-Jan-13	8260	
Trichloroethene*	ND	0.001	mg/L	1	3012807	ms	28-Jan-13	8260	
Toluene*	ND	0.001	mg/L	1	3012807	ms	28-Jan-13	8260	
Tetrachloroethene*	ND	0.001	mg/L	1	3012807	ms	28-Jan-13	8260	

Cardinal Laboratories

*=Accredited Analyte

PLEASE NOTE: Liability and Damages. Cardinal's liability and client's exclusive remedy for any claim arising, whether based in contract or tort, shall be limited to the amount paid by client for analyses. All claims, including those for negligence and any other cause whatsoever shall be deemed waived unless made in writing and received by Cardinal within thirty (30) days after completion of the applicable service. In no event shall Cardinal be liable for incidental or consequential damages, including, without limitation, business interruptions, loss of use, or loss of profits incurred by client, its subsidiaries, affiliates or successors arising out of or related to the performance of the services hereunder by Cardinal, regardless of whether such claim is based upon any of the above stated reasons or otherwise. Results relate only to the samples identified above. This report shall not be reproduced except in full with written approval of Cardinal Laboratories.

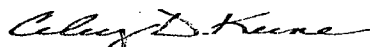

Celey D. Keene, Lab Director/Quality Manager

Analytical Results For:

CIMAREX ENERGY CO.-MIDLAND
600 N. MARIENFELD ST, SUITE 600
MIDLAND TX, 79701

Project: SNODDY POND
Project Number: NONE GIVEN
Project Manager: GREG LINGAFELTER
Fax To: UNK-NOWN

Reported:
28-Feb-13 15:54

SNODDY POND WATER
H300208-01 (Water)

Analyte	Result	Reporting Limit	Units	Dilution	Batch	Analyst	Analyzed	Method	Notes
---------	--------	-----------------	-------	----------	-------	---------	----------	--------	-------

Cardinal Laboratories
Volatile Organic Compounds by EPA Method 8260B

1,1,2-Trichloroethane*	ND	0.001	mg/L	1	3012807	ms	28-Jan-13	8260	
1,2-Dibromoethane*	ND	0.001	mg/L	1	3012807	ms	28-Jan-13	8260	
Ethylbenzene*	ND	0.001	mg/L	1	3012807	ms	28-Jan-13	8260	
m-p Xylenes*	ND	0.002	mg/L	1	3012807	ms	28-Jan-13	8260	
o-Xylene*	ND	0.001	mg/L	1	3012807	ms	28-Jan-13	8260	
Total Xylenes*	ND	0.003	mg/L	1	3012807	ms	28-Jan-13	8260	
1,1,2,2-Tetrachloroethane*	ND	0.001	mg/L	1	3012807	ms	28-Jan-13	8260	
Naphthalene*	ND	0.001	mg/L	1	3012807	ms	28-Jan-13	8260	
Surrogate: Dibromofluoromethane		94.4 %	70.2-143		3012807	ms	28-Jan-13	8260	
Surrogate: Toluene-d8		96.7 %	73.8-118		3012807	ms	28-Jan-13	8260	
Surrogate: 4-Bromofluorobenzene		95.6 %	48-134		3012807	ms	28-Jan-13	8260	

Semivolatile Organic Compounds by GCMS

Naphthalene	ND	0.001	mg/L	1.16	3020508	ms	05-Feb-13	8270C	
2-Methylnaphthalene	ND	0.001	mg/L	1.16	3020508	ms	05-Feb-13	8270C	
1-Methylnaphthalene	ND	0.001	mg/L	1.16	3020508	ms	05-Feb-13	8270C	
Acenaphthylene	ND	0.001	mg/L	1.16	3020508	ms	05-Feb-13	8270C	
Acenaphthene	ND	0.001	mg/L	1.16	3020508	ms	05-Feb-13	8270C	
Fluorene	ND	0.001	mg/L	1.16	3020508	ms	05-Feb-13	8270C	
Phenanthrene	ND	0.001	mg/L	1.16	3020508	ms	05-Feb-13	8270C	
Anthracene	ND	0.001	mg/L	1.16	3020508	ms	05-Feb-13	8270C	
Carbazole	ND	0.001	mg/L	1.16	3020508	ms	05-Feb-13	8270C	
Fluoranthene	ND	0.001	mg/L	1.16	3020508	ms	05-Feb-13	8270C	
Pyrene	ND	0.001	mg/L	1.16	3020508	ms	05-Feb-13	8270C	
Benzo[a]anthracene	ND	0.001	mg/L	1.16	3020508	ms	05-Feb-13	8270C	
Chrysene	ND	0.001	mg/L	1.16	3020508	ms	05-Feb-13	8270C	
Benzo[b]fluoranthene	ND	0.001	mg/L	1.16	3020508	ms	05-Feb-13	8270C	
Benzo[k]fluoranthene	ND	0.001	mg/L	1.16	3020508	ms	05-Feb-13	8270C	
Benzo[a]pyrene	ND	0.0002	mg/L	1.16	3020508	ms	05-Feb-13	8270C	

Cardinal Laboratories

*=Accredited Analyte

PLEASE NOTE: Liability and Damages. Cardinal's liability and client's exclusive remedy for any claim arising, whether based in contract or tort, shall be limited to the amount paid by client for analyses. All claims, including those for negligence and any other cause whatsoever shall be deemed waived unless made in writing and received by Cardinal within thirty (30) days after completion of the applicable service. In no event shall Cardinal be liable for incidental or consequential damages, including, without limitation, business interruptions, loss of use, or loss of profits incurred by client, its subsidiaries, affiliates or successors arising out of or related to the performance of the services hereunder by Cardinal, regardless of whether such claim is based upon any of the above stated reasons or otherwise. Results relate only to the samples identified above. This report shall not be reproduced except in full with written approval of Cardinal Laboratories.

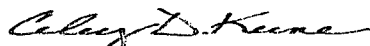

Celey D. Keene, Lab Director/Quality Manager

Analytical Results For:

 CIMAREX ENERGY CO.-MIDLAND
 600 N. MARIENFELD ST, SUITE 600
 MIDLAND TX, 79701

 Project: SNODDY POND
 Project Number: NONE GIVEN
 Project Manager: GREG LINGAFELTER
 Fax To: UNK-NOWN

 Reported:
 28-Feb-13 15:54

SNODDY POND WATER
H300208-01 (Water)

Analyte	Result	Reporting Limit	Units	Dilution	Batch	Analyst	Analyzed	Method	Notes
---------	--------	--------------------	-------	----------	-------	---------	----------	--------	-------

Cardinal Laboratories
Semivolatile Organic Compounds by GCMS

Indeno[1,2,3-cd]pyrene	ND	0.001	mg/L	1.16	3020508	ms	05-Feb-13	8270C	
Dibenz[a,h]anthracene	ND	0.001	mg/L	1.16	3020508	ms	05-Feb-13	8270C	
Benzo[g,h,i]perylene	ND	0.001	mg/L	1.16	3020508	ms	05-Feb-13	8270C	
Surrogate: Nitrobenzene-d5		114 %		35-114	3020508	ms	05-Feb-13	8270C	
Surrogate: 2-Fluorobiphenyl		114 %		43-116	3020508	ms	05-Feb-13	8270C	
Surrogate: Terphenyl-d14		130 %		33-141	3020508	ms	05-Feb-13	8270C	

Cardinal Laboratories

* = Accredited Analyte

PLEASE NOTE: Liability and Damages. Cardinal's liability and client's exclusive remedy for any claim arising, whether based in contract or tort, shall be limited to the amount paid by client for analyses. All claims, including those for negligence and any other cause whatsoever shall be deemed waived unless made in writing and received by Cardinal within thirty (30) days after completion of the applicable service. In no event shall Cardinal be liable for incidental or consequential damages, including, without limitation, business interruptions, loss of use, or loss of profits incurred by client, its subsidiaries, affiliates or successors arising out of or related to the performance of the services hereunder by Cardinal, regardless of whether such claim is based upon any of the above stated reasons or otherwise. Results relate only to the samples identified above. This report shall not be reproduced except in full with written approval of Cardinal Laboratories.



Celey D. Keene, Lab Director/Quality Manager

Analytical Results For:

 CIMAREX ENERGY CO.-MIDLAND
 600 N. MARIENFELD ST, SUITE 600
 MIDLAND TX, 79701

 Project: SNODDY POND
 Project Number: NONE GIVEN
 Project Manager: GREG LINGAFELTER
 Fax To: UNK-NOWN

 Reported:
 28-Feb-13 15:54

Inorganic Compounds - Quality Control
Cardinal Laboratories

Analyte	Result	Reporting Limit	Units	Spike Level	Source Result	%REC	%REC Limits	RPD	RPD Limit	Notes
Batch 3012507 - General Prep - Wet Chem										
Blank (3012507-BLK1)				Prepared & Analyzed: 25-Jan-13						
Chloride	ND	4.00	mg/L							
LCS (3012507-BS1)				Prepared & Analyzed: 25-Jan-13						
Chloride	108	4.00	mg/L	100		108	80-120			
LCS Dup (3012507-BSD1)				Prepared & Analyzed: 25-Jan-13						
Chloride	108	4.00	mg/L	100		108	80-120	0.00	20	
Batch 3012511 - General Prep - Wet Chem										
Blank (3012511-BLK1)				Prepared & Analyzed: 25-Jan-13						
Nitrate as N	ND	0.100	mg/L							
LCS (3012511-BS1)				Prepared & Analyzed: 25-Jan-13						
Nitrate as N	4.60	0.100	mg/L	5.00		92.0	80-120			
Duplicate (3012511-DUP1)				Source: H300208-01 Prepared & Analyzed: 25-Jan-13						
Nitrate as N	1.80	0.100	mg/L		2.30			24.4	25	
Batch 3012513 - NO PREP										
LCS (3012513-BS1)				Prepared & Analyzed: 25-Jan-13						
pH	7.08		pH Units	7.00		101	90-110			
Duplicate (3012513-DUP1)				Source: H300212-01 Prepared & Analyzed: 25-Jan-13						
pH	7.24	0.100	pH Units		7.14			1.39	20	

Cardinal Laboratories

* = Accredited Analyte

PLEASE NOTE: Liability and Damages. Cardinal's liability and client's exclusive remedy for any claim arising, whether based in contract or tort, shall be limited to the amount paid by client for analyses. All claims, including those for negligence and any other cause whatsoever shall be deemed waived unless made in writing and received by Cardinal within thirty (30) days after completion of the applicable service. In no event shall Cardinal be liable for incidental or consequential damages, including, without limitation, business interruptions, loss of use, or loss of profits incurred by client, its subsidiaries, affiliates or successors arising out of or related to the performance of the services hereunder by Cardinal, regardless of whether such claim is based upon any of the above stated reasons or otherwise. Results relate only to the samples identified above. This report shall not be reproduced except in full with written approval of Cardinal Laboratories.

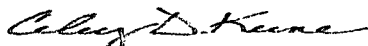

Celey D. Keene, Lab Director/Quality Manager

Analytical Results For:

CIMAREX ENERGY CO.-MIDLAND
600 N. MARIENFELD ST, SUITE 600
MIDLAND TX, 79701

Project: SNODDY POND
Project Number: NONE GIVEN
Project Manager: GREG LINGAFELTER
Fax To: UNK-NOWN

Reported:
28-Feb-13 15:54

Inorganic Compounds - Quality Control
Cardinal Laboratories

Analyte	Result	Reporting Limit	Units	Spike Level	Source Result	%REC	%REC Limits	RPD	RPD Limit	Notes
---------	--------	--------------------	-------	----------------	------------------	------	----------------	-----	--------------	-------

Batch 3012802 - General Prep - Wet Chem
Blank (3012802-BLK1)

Prepared & Analyzed: 28-Jan-13

Sulfate ND 10.0 mg/L

LCS (3012802-BS1)

Prepared & Analyzed: 28-Jan-13

Sulfate 18.9 10.0 mg/L 20.0 94.6 80-120

LCS Dup (3012802-BSD1)

Prepared & Analyzed: 28-Jan-13

Sulfate 24.2 10.0 mg/L 20.0 121 80-120 24.7 25

Batch 3013002 - Filtration
Blank (3013002-BLK1)

Prepared & Analyzed: 30-Jan-13

TDS ND 5.00 mg/L

LCS (3013002-BS1)

Prepared & Analyzed: 30-Jan-13

TDS 222 5.00 mg/L 240 92.5 80-120

Duplicate (3013002-DUP1)

Source: H300209-07

Prepared & Analyzed: 30-Jan-13

TDS 9020 5.00 mg/L 9050 0.421 20

Batch 3020814 - General Prep
Blank (3020814-BLK1)

Prepared & Analyzed: 28-Jan-13

Fluoride ND 0.200 mg/L

LCS (3020814-BS1)

Prepared & Analyzed: 28-Jan-13

Fluoride 0.965 mg/L 1.00 96.5 85-115

Cardinal Laboratories

*=Accredited Analyte

PLEASE NOTE: Liability and Damages. Cardinal's liability and client's exclusive remedy for any claim arising, whether based in contract or tort, shall be limited to the amount paid by client for analyses. All claims, including those for negligence and any other cause whatsoever shall be deemed waived unless made in writing and received by Cardinal within thirty (30) days after completion of the applicable service. In no event shall Cardinal be liable for incidental or consequential damages, including, without limitation, business interruptions, loss of use, or loss of profits incurred by client, its subsidiaries, affiliates or successors arising out of or related to the performance of the services hereunder by Cardinal, regardless of whether such claim is based upon any of the above stated reasons or otherwise. Results relate only to the samples identified above. This report shall not be reproduced except in full with written approval of Cardinal Laboratories.

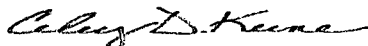

Celey D. Keene, Lab Director/Quality Manager

Analytical Results For:

 CIMAREX ENERGY CO.-MIDLAND
 600 N. MARIENFELD ST, SUITE 600
 MIDLAND TX, 79701

 Project: SNODDY POND
 Project Number: NONE GIVEN
 Project Manager: GREG LINGAFELTER
 Fax To: UNK-NOWN

 Reported:
 28-Feb-13 15:54

Inorganic Compounds - Quality Control
Cardinal Laboratories

Analyte	Result	Reporting Limit	Units	Spike Level	Source Result	%REC Limits	RPD	RPD Limit	Notes
Batch 3020814 - General Prep									
LCS Dup (3020814-BSD1)					Prepared & Analyzed: 28-Jan-13				
Fluoride	1.07		mg/L	1.00		107	85-115	10.3	20
Batch 3020815 - General Prep									
Blank (3020815-BLK1)					Prepared & Analyzed: 07-Feb-13				
Cyanide (total)	ND	0.010	mg/L						
LCS (3020815-BS1)					Prepared & Analyzed: 07-Feb-13				
Cyanide (total)	0.148		mg/L	0.150		98.7	90-110		
Batch 3020816 - General Prep									
Blank (3020816-BLK1)					Prepared & Analyzed: 07-Feb-13				
Phenols	ND	0.050	mg/L						
LCS (3020816-BS1)					Prepared & Analyzed: 07-Feb-13				
Phenols	0.414		mg/L	0.400		104	80-120		
Matrix Spike (3020816-MS1)					Source: H300208-01 Prepared & Analyzed: 07-Feb-13				
Phenols	0.400		mg/L	0.400	0.00	100	70-130		
Matrix Spike Dup (3020816-MSD1)					Source: H300208-01 Prepared & Analyzed: 07-Feb-13				
Phenols	0.393		mg/L	0.400	0.00	98.2	70-130	1.77	20

Cardinal Laboratories

*=Accredited Analyte

PLEASE NOTE: Liability and Damages. Cardinal's liability and client's exclusive remedy for any claim arising, whether based in contract or tort, shall be limited to the amount paid by client for analyses. All claims, including those for negligence and any other cause whatsoever shall be deemed waived unless made in writing and received by Cardinal within thirty (30) days after completion of the applicable service. In no event shall Cardinal be liable for incidental or consequential damages, including, without limitation, business interruptions, loss of use, or loss of profits incurred by client, its subsidiaries, affiliates or successors arising out of or related to the performance of the services hereunder by Cardinal, regardless of whether such claim is based upon any of the above stated reasons or otherwise. Results relate only to the samples identified above. This report shall not be reproduced except in full with written approval of Cardinal Laboratories.

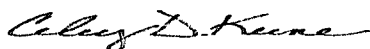

Celey D. Keene, Lab Director/Quality Manager

Analytical Results For:

CIMAREX ENERGY CO.-MIDLAND
600 N. MARIENFELD ST, SUITE 600
MIDLAND TX, 79701

Project: SNODDY POND
Project Number: NONE GIVEN
Project Manager: GREG LINGAFELTER
Fax To: UNK-NOWN

Reported:
28-Feb-13 15:54

Dissolved Metals - Quality Control
Cardinal Laboratories

Analyte	Result	Reporting Limit	Units	Spike Level	Source Result	%REC	%REC Limits	RPD	RPD Limit	Notes
---------	--------	--------------------	-------	----------------	------------------	------	----------------	-----	--------------	-------

Batch 3020806 - Dissolved/Potentially Dissolved Metals
Blank (3020806-BLK1)

Prepared & Analyzed: 28-Jan-13

Aluminum	ND	0.0500	mg/L							
Cobalt	ND	0.0500	mg/L							
Iron	ND	0.050	mg/L							
Manganese	ND	0.005	mg/L							
Nickel	ND	0.0500	mg/L							
Barium	ND	0.010	mg/L							
Arsenic	ND	0.100	mg/L							
Zinc	ND	0.050	mg/L							
Silver	ND	0.050	mg/L							
Boron	ND	0.200	mg/L							
Chromium	ND	0.050	mg/L							
Molybdenum	ND	0.0500	mg/L							
Copper	ND	0.020	mg/L							

LCS (3020806-BS1)

Prepared & Analyzed: 28-Jan-13

Copper	4.86		mg/L	5.00		97.2	85-115			
Nickel	2.36		mg/L	2.50		94.4	85-115			
Aluminum	4.99		mg/L	5.00		99.8	85-115			
Silver	0.124		mg/L	0.125		99.2	85-115			
Cobalt	2.43		mg/L	2.50		97.2	85-115			
Manganese	2.43		mg/L	2.50		97.2	85-115			
Zinc	2.38		mg/L	2.50		95.2	85-115			
Molybdenum	4.83		mg/L	5.00		96.6	85-115			
Boron	4.93		mg/L	5.00		98.6	85-115			
Chromium	2.48		mg/L	2.50		99.2	85-115			
Barium	2.39		mg/L	2.50		95.6	85-115			
Arsenic	4.88		mg/L	5.00		97.6	85-115			
Iron	5.02		mg/L	5.00		100	85-115			

Cardinal Laboratories

*=Accredited Analyte

PLEASE NOTE: Liability and Damages. Cardinal's liability and client's exclusive remedy for any claim arising, whether based in contract or tort, shall be limited to the amount paid by client for analyses. All claims, including those for negligence and any other cause whatsoever shall be deemed waived unless made in writing and received by Cardinal within thirty (30) days after completion of the applicable service. In no event shall Cardinal be liable for incidental or consequential damages, including, without limitation, business interruptions, loss of use, or loss of profits incurred by client, its subsidiaries, affiliates or successors arising out of or related to the performance of the services hereunder by Cardinal, regardless of whether such claim is based upon any of the above stated reasons or otherwise. Results relate only to the samples identified above. This report shall not be reproduced except in full with written approval of Cardinal Laboratories.

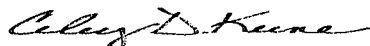

Celey D. Keene, Lab Director/Quality Manager

Analytical Results For:

CIMAREX ENERGY CO.-MIDLAND
600 N. MARIENFELD ST, SUITE 600
MIDLAND TX, 79701

Project: SNODDY POND
Project Number: NONE GIVEN
Project Manager: GREG LINGAFELTER
Fax To: UNK-NOWN

Reported:
28-Feb-13 15:54

Dissolved Metals - Quality Control
Cardinal Laboratories

Analyte	Result	Reporting Limit	Units	Spike Level	Source Result	%REC	%REC Limits	RPD	RPD Limit	Notes
---------	--------	--------------------	-------	----------------	------------------	------	----------------	-----	--------------	-------

Batch 3020806 - Dissolved/Potentially Dissolved Metals
LCS Dup (3020806-BSD1)

Prepared & Analyzed: 28-Jan-13

Boron	4.96		mg/L	5.00		99.2	85-115	0.607	20	
Nickel	2.38		mg/L	2.50		95.2	85-115	0.844	20	
Molybdenum	4.89		mg/L	5.00		97.8	85-115	1.23	20	
Barium	2.42		mg/L	2.50		96.8	85-115	1.25	20	
Zinc	2.40		mg/L	2.50		96.0	85-115	0.837	20	
Aluminum	5.00		mg/L	5.00		100	85-115	0.200	20	
Iron	5.04		mg/L	5.00		101	85-115	0.398	20	
Arsenic	4.96		mg/L	5.00		99.2	85-115	1.63	20	
Copper	4.89		mg/L	5.00		97.8	85-115	0.615	20	
Manganese	2.44		mg/L	2.50		97.6	85-115	0.411	20	
Chromium	2.50		mg/L	2.50		100	85-115	0.803	20	
Silver	0.126		mg/L	0.125		101	85-115	1.60	20	
Cobalt	2.45		mg/L	2.50		98.0	85-115	0.820	20	

Batch 3020807 - Dissolved/Potentially Dissolved Metals
Blank (3020807-BLK1)

Prepared & Analyzed: 05-Feb-13

Selenium	ND	0.001	mg/L							
Uranium	ND	0.000100	mg/L							
Cadmium	ND	0.00010	mg/L							
Lead	ND	0.0005	mg/L							

LCS (3020807-BS1)

Prepared & Analyzed: 05-Feb-13

Uranium	0.0493		mg/L	0.0500		98.6	85-115			
Lead	0.0500		mg/L	0.0500		100	85-115			
Selenium	0.254		mg/L	0.250		102	85-115			
Cadmium	0.0500		mg/L	0.0500		100	85-115			

Cardinal Laboratories

*=Accredited Analyte

PLEASE NOTE: Liability and Damages. Cardinal's liability and client's exclusive remedy for any claim arising, whether based in contract or tort, shall be limited to the amount paid by client for analyses. All claims, including those for negligence and any other cause whatsoever shall be deemed waived unless made in writing and received by Cardinal within thirty (30) days after completion of the applicable service. In no event shall Cardinal be liable for incidental or consequential damages, including, without limitation, business interruptions, loss of use, or loss of profits incurred by client, its subsidiaries, affiliates or successors arising out of or related to the performance of the services hereunder by Cardinal, regardless of whether such claim is based upon any of the above stated reasons or otherwise. Results relate only to the samples identified above. This report shall not be reproduced except in full with written approval of Cardinal Laboratories.



Celey D. Keene, Lab Director/Quality Manager

Analytical Results For:

 CIMAREX ENERGY CO.-MIDLAND
 600 N. MARIENFELD ST, SUITE 600
 MIDLAND TX, 79701

 Project: SNODDY POND
 Project Number: NONE GIVEN
 Project Manager: GREG LINGAFELTER
 Fax To: UNK-NOWN

 Reported:
 28-Feb-13 15:54

Total Metals by ICPMS - Quality Control
Cardinal Laboratories

Analyte	Result	Reporting Limit	Units	Spike Level	Source Result	%REC	%REC Limits	RPD	RPD Limit	Notes
---------	--------	--------------------	-------	----------------	------------------	------	----------------	-----	--------------	-------

Batch 3020807 - Dissolved/Potentially Dissolved Metals
LCS Dup (3020807-BSD1)

Prepared & Analyzed: 05-Feb-13

Uranium	0.0502		mg/L	0.0500		100	85-115	1.81	20	
Cadmium	0.0506		mg/L	0.0500		101	85-115	1.19	20	
Selenium	0.259		mg/L	0.250		104	85-115	1.95	20	
Lead	0.0513		mg/L	0.0500		103	85-115	2.57	20	

Cardinal Laboratories

* = Accredited Analyte

PLEASE NOTE: Liability and Damages. Cardinal's liability and client's exclusive remedy for any claim arising, whether based in contract or tort, shall be limited to the amount paid by client for analyses. All claims, including those for negligence and any other cause whatsoever shall be deemed waived unless made in writing and received by Cardinal within thirty (30) days after completion of the applicable service. In no event shall Cardinal be liable for incidental or consequential damages, including, without limitation, business interruptions, loss of use, or loss of profits incurred by client, its subsidiaries, affiliates or successors arising out of or related to the performance of the services hereunder by Cardinal, regardless of whether such claim is based upon any of the above stated reasons or otherwise. Results relate only to the samples identified above. This report shall not be reproduced except in full with written approval of Cardinal Laboratories.

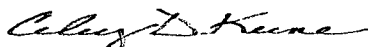

Celey D. Keene, Lab Director/Quality Manager

Analytical Results For:

 CIMAREX ENERGY CO.-MIDLAND
 600 N. MARIENFELD ST, SUITE 600
 MIDLAND TX, 79701

 Project: SNODDY POND
 Project Number: NONE GIVEN
 Project Manager: GREG LINGAFELTER
 Fax To: UNK-NOWN

 Reported:
 28-Feb-13 15:54

Mercury (Total) by CVAA - Quality Control
Cardinal Laboratories

Analyte	Result	Reporting Limit	Units	Spike Level	Source Result	%REC	%REC Limits	RPD	RPD Limit	Notes
Batch 3020808 - EPA 245.1										
Blank (3020808-BLK1)				Prepared: 29-Jan-13 Analyzed: 31-Jan-13						
Mercury	ND	0.0002	mg/L							
LCS (3020808-BS1)				Prepared: 29-Jan-13 Analyzed: 31-Jan-13						
Mercury	0.0020		mg/L	0.00200		100	85-115			
LCS Dup (3020808-BSD1)				Prepared: 29-Jan-13 Analyzed: 31-Jan-13						
Mercury	0.0019		mg/L	0.00200		95.0	85-115	5.13	20	

Cardinal Laboratories

* = Accredited Analyte

PLEASE NOTE: Liability and Damages. Cardinal's liability and client's exclusive remedy for any claim arising, whether based in contract or tort, shall be limited to the amount paid by client for analyses. All claims, including those for negligence and any other cause whatsoever shall be deemed waived unless made in writing and received by Cardinal within thirty (30) days after completion of the applicable service. In no event shall Cardinal be liable for incidental or consequential damages, including, without limitation, business interruptions, loss of use, or loss of profits incurred by client, its subsidiaries, affiliates or successors arising out of or related to the performance of the services hereunder by Cardinal, regardless of whether such claim is based upon any of the above stated reasons or otherwise. Results relate only to the samples identified above. This report shall not be reproduced except in full with written approval of Cardinal Laboratories.

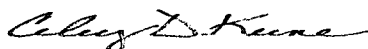

Celey D. Keene, Lab Director/Quality Manager

Analytical Results For:

CIMAREX ENERGY CO.-MIDLAND
600 N. MARIENFELD ST, SUITE 600
MIDLAND TX, 79701

Project: SNODDY POND
Project Number: NONE GIVEN
Project Manager: GREG LINGAFELTER
Fax To: UNK-NOWN

Reported:
28-Feb-13 15:54

PCBs BY GC/ECD - Quality Control
Cardinal Laboratories

Analyte	Result	Reporting Limit	Units	Spike Level	Source Result	%REC %REC	%REC Limits	RPD	RPD Limit	Notes
---------	--------	--------------------	-------	----------------	------------------	--------------	----------------	-----	--------------	-------

Batch 3020407 - EPA 3510C
Blank (3020407-BLK1)

Prepared: 30-Jan-13 Analyzed: 01-Feb-13

PCB 1016	ND	2.00	ug/L							
PCB 1221	ND	2.00	ug/L							
PCB 1232	ND	2.00	ug/L							
PCB 1242	ND	2.00	ug/L							
PCB 1248	ND	2.00	ug/L							
PCB 1254	ND	2.00	ug/L							
PCB 1260	ND	2.00	ug/L							

Surrogate: Tetrachloro-meta-xylene 8.77 ug/L 10.0 87.7 35-140

LCS (3020407-BS1)

Prepared: 30-Jan-13 Analyzed: 01-Feb-13

PCB 1016	71.9		ug/L	100		71.9	40-130			
PCB 1242	ND	2.00	ug/L				40-130			
PCB 1254	ND	2.00	ug/L				40-130			
PCB 1260	82.7		ug/L	100		82.7	40-130			

Surrogate: Tetrachloro-meta-xylene 8.81 ug/L 10.0 88.1 35-140

LCS Dup (3020407-BSD1)

Prepared: 30-Jan-13 Analyzed: 01-Feb-13

PCB 1016	74.4		ug/L	100		74.4	40-130	3.42	30	
PCB 1242	ND	2.00	ug/L				40-130		30	
PCB 1254	ND	2.00	ug/L				40-130		30	
PCB 1260	80.8		ug/L	100		80.8	40-130	2.32	30	

Surrogate: Tetrachloro-meta-xylene 9.31 ug/L 10.0 93.1 35-140

Cardinal Laboratories

*=Accredited Analyte

PLEASE NOTE: Liability and Damages. Cardinal's liability and client's exclusive remedy for any claim arising, whether based in contract or tort, shall be limited to the amount paid by client for analyses. All claims, including those for negligence and any other cause whatsoever shall be deemed waived unless made in writing and received by Cardinal within thirty (30) days after completion of the applicable service. In no event shall Cardinal be liable for incidental or consequential damages, including, without limitation, business interruptions, loss of use, or loss of profits incurred by client, its subsidiaries, affiliates or successors arising out of or related to the performance of the services hereunder by Cardinal, regardless of whether such claim is based upon any of the above stated reasons or otherwise. Results relate only to the samples identified above. This report shall not be reproduced except in full with written approval of Cardinal Laboratories.

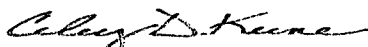

Celey D. Keene, Lab Director/Quality Manager

Analytical Results For:

CIMAREX ENERGY CO.-MIDLAND
600 N. MARIENFELD ST, SUITE 600
MIDLAND TX, 79701

Project: SNODDY POND
Project Number: NONE GIVEN
Project Manager: GREG LINGAFELTER
Fax To: UNK-NOWN

Reported:
28-Feb-13 15:54

Volatile Organic Compounds by EPA Method 8260B - Quality Control

Cardinal Laboratories

Analyte	Result	Reporting Limit	Units	Spike Level	Source Result	%REC	%REC Limits	RPD	RPD Limit	Notes
---------	--------	-----------------	-------	-------------	---------------	------	-------------	-----	-----------	-------

Batch 3012807 - Volatiles

Blank (3012807-BLK1)

Prepared & Analyzed: 28-Jan-13

Vinyl chloride	ND	0.001	mg/L							
1,1-Dichloroethene	ND	0.001	mg/L							
Methylene chloride	ND	0.001	mg/L							
1,1-Dichloroethane	ND	0.001	mg/L							
Chloroform	ND	0.001	mg/L							
Carbon tetrachloride	ND	0.001	mg/L							
1,1,1-Trichloroethane	ND	0.001	mg/L							
Benzene	ND	0.001	mg/L							
1,2-Dichloroethane	ND	0.001	mg/L							
Trichloroethene	ND	0.001	mg/L							
Toluene	ND	0.001	mg/L							
Tetrachloroethene	ND	0.001	mg/L							
1,1,2-Trichloroethane	ND	0.001	mg/L							
1,2-Dibromoethane	ND	0.001	mg/L							
Ethylbenzene	ND	0.001	mg/L							
m-p Xylenes	ND	0.002	mg/L							
o-Xylene	ND	0.001	mg/L							
Total Xylenes	ND	0.003	mg/L							
1,1,2,2-Tetrachloroethane	ND	0.001	mg/L							
Naphthalene	ND	0.001	mg/L							
Surrogate: Dibromofluoromethane	0.00950		mg/L	0.0100		95.0	70.2-143			
Surrogate: Toluene-d8	0.00966		mg/L	0.0100		96.6	73.8-118			
Surrogate: 4-Bromofluorobenzene	0.00955		mg/L	0.0100		95.5	48-134			

LCS (3012807-BS1)

Prepared & Analyzed: 28-Jan-13

Vinyl chloride	0.020	0.001	mg/L	0.0200		102	63.4-131			
1,1-Dichloroethene	0.020	0.001	mg/L	0.0200		99.9	68.7-131			
Methylene chloride	0.019	0.001	mg/L	0.0200		93.6	63.1-134			
1,1-Dichloroethane	0.020	0.001	mg/L	0.0200		100	74.5-121			
Chloroform	0.019	0.001	mg/L	0.0200		93.8	76-115			
Carbon tetrachloride	0.020	0.001	mg/L	0.0200		98.8	66.6-128			
1,1,1-Trichloroethane	0.020	0.001	mg/L	0.0200		98.2	71.1-127			

Cardinal Laboratories

*=Accredited Analyte

PLEASE NOTE: Liability and Damages. Cardinal's liability and client's exclusive remedy for any claim arising, whether based in contract or tort, shall be limited to the amount paid by client for analyses. All claims, including those for negligence and any other cause whatsoever shall be deemed waived unless made in writing and received by Cardinal within thirty (30) days after completion of the applicable service. In no event shall Cardinal be liable for incidental or consequential damages, including, without limitation, business interruptions, loss of use, or loss of profits incurred by client, its subsidiaries, affiliates or successors arising out of or related to the performance of the services hereunder by Cardinal, regardless of whether such claim is based upon any of the above stated reasons or otherwise. Results relate only to the samples identified above. This report shall not be reproduced except in full with written approval of Cardinal Laboratories.



Celey D. Keene, Lab Director/Quality Manager

Analytical Results For:

CIMAREX ENERGY CO.-MIDLAND
600 N. MARIENFELD ST, SUITE 600
MIDLAND TX, 79701

Project: SNODDY POND
Project Number: NONE GIVEN
Project Manager: GREG LINGAFELTER
Fax To: UNK-NOWN

Reported:
28-Feb-13 15:54

Volatile Organic Compounds by EPA Method 8260B - Quality Control
Cardinal Laboratories

Analyte	Result	Reporting Limit	Units	Spike Level	Source Result	%REC	%REC Limits	RPD	RPD Limit	Notes
---------	--------	-----------------	-------	-------------	---------------	------	-------------	-----	-----------	-------

Batch 3012807 - Volatiles
LCS (3012807-BS1)

Prepared & Analyzed: 28-Jan-13

Benzene	0.020	0.001	mg/L	0.0200		99.4	76.5-120			
1,2-Dichloroethane	0.020	0.001	mg/L	0.0200		99.3	75.5-117			
Trichloroethene	0.020	0.001	mg/L	0.0200		98.5	76.3-118			
Toluene	0.019	0.001	mg/L	0.0200		96.6	74.8-121			
Tetrachloroethene	0.019	0.001	mg/L	0.0200		96.0	52.4-136			
1,1,2-Trichloroethane	0.020	0.001	mg/L	0.0200		101	76.6-118			
1,2-Dibromoethane	0.020	0.001	mg/L	0.0200		98.2	77.8-119			
Ethylbenzene	0.019	0.001	mg/L	0.0200		97.2	78.4-121			
m-p Xylenes	0.039	0.002	mg/L	0.0400		97.4	80-120			
o-Xylene	0.019	0.001	mg/L	0.0200		97.3	71-126			
Total Xylenes	0.058	0.003	mg/L	0.0600		97.4	73.6-126			
1,1,2,2-Tetrachloroethane	0.020	0.001	mg/L	0.0200		101	74.2-122			
Naphthalene	0.022	0.001	mg/L	0.0200		110	68.4-126			
Surrogate: Dibromofluoromethane	0.0101		mg/L	0.0100		101	70.2-143			
Surrogate: Toluene-d8	0.00987		mg/L	0.0100		98.7	73.8-118			
Surrogate: 4-Bromofluorobenzene	0.00992		mg/L	0.0100		99.2	48-134			

LCS Dup (3012807-BSD1)

Prepared & Analyzed: 28-Jan-13

Vinyl chloride	0.020	0.001	mg/L	0.0200		100	63.4-131	1.97	12.3	
1,1-Dichloroethene	0.020	0.001	mg/L	0.0200		97.7	68.7-131	2.23	18.3	
Methylene chloride	0.019	0.001	mg/L	0.0200		94.3	63.1-134	0.692	19.8	
1,1-Dichloroethane	0.019	0.001	mg/L	0.0200		97.2	74.5-121	2.84	9.91	
Chloroform	0.018	0.001	mg/L	0.0200		91.9	76-115	2.05	9.44	
Carbon tetrachloride	0.019	0.001	mg/L	0.0200		96.0	66.6-128	2.82	16	
1,1,1-Trichloroethane	0.019	0.001	mg/L	0.0200		95.6	71.1-127	2.68	12.2	
Benzene	0.020	0.001	mg/L	0.0200		97.8	76.5-120	1.67	9.89	
1,2-Dichloroethane	0.019	0.001	mg/L	0.0200		96.8	75.5-117	2.55	9.07	
Trichloroethene	0.019	0.001	mg/L	0.0200		96.0	76.3-118	2.57	12	
Toluene	0.019	0.001	mg/L	0.0200		95.8	74.8-121	0.884	12.3	
Tetrachloroethene	0.019	0.001	mg/L	0.0200		92.8	52.4-136	3.34	43.6	
1,1,2-Trichloroethane	0.020	0.001	mg/L	0.0200		101	76.6-118	0.397	11.1	
1,2-Dibromoethane	0.019	0.001	mg/L	0.0200		96.9	77.8-119	1.33	11.3	

Cardinal Laboratories

*=Accredited Analyte

PLEASE NOTE: Liability and Damages. Cardinal's liability and client's exclusive remedy for any claim arising, whether based in contract or tort, shall be limited to the amount paid by client for analyses. All claims, including those for negligence and any other cause whatsoever shall be deemed waived unless made in writing and received by Cardinal within thirty (30) days after completion of the applicable service. In no event shall Cardinal be liable for incidental or consequential damages, including, without limitation, business interruptions, loss of use, or loss of profits incurred by client, its subsidiaries, affiliates or successors arising out of or related to the performance of the services hereunder by Cardinal, regardless of whether such claim is based upon any of the above stated reasons or otherwise. Results relate only to the samples identified above. This report shall not be reproduced except in full with written approval of Cardinal Laboratories.

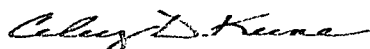

Celey D. Keene, Lab Director/Quality Manager

Analytical Results For:

CIMAREX ENERGY CO.-MIDLAND
600 N. MARIENFELD ST, SUITE 600
MIDLAND TX, 79701

Project: SNODDY POND
Project Number: NONE GIVEN
Project Manager: GREG LINGAFELTER
Fax To: UNK-NOWN

Reported:
28-Feb-13 15:54

Volatile Organic Compounds by EPA Method 8260B - Quality Control
Cardinal Laboratories

Analyte	Result	Reporting Limit	Units	Spike Level	Source Result	%REC Limits	RPD	RPD Limit	Notes
Batch 3012807 - Volatiles									
LCS Dup (3012807-BSD1)				Prepared & Analyzed: 28-Jan-13					
Ethylbenzene	0.019	0.001	mg/L	0.0200		96.2	78.4-121	1.14	13.2
m-p Xylenes	0.038	0.002	mg/L	0.0400		96.0	80-120	1.45	20
o-Xylene	0.019	0.001	mg/L	0.0200		96.0	71-126	1.40	11.7
Total Xylenes	0.058	0.003	mg/L	0.0600		96.0	73.6-126	1.43	13.1
1,1,2,2-Tetrachloroethane	0.020	0.001	mg/L	0.0200		101	74.2-122	0.347	10.6
Naphthalene	0.022	0.001	mg/L	0.0200		111	68.4-126	0.271	10.5
Surrogate: Dibromofluoromethane	0.0101		mg/L	0.0100		101	70.2-143		
Surrogate: Toluene-d8	0.00990		mg/L	0.0100		99.0	73.8-118		
Surrogate: 4-Bromofluorobenzene	0.00995		mg/L	0.0100		99.5	48-134		

Cardinal Laboratories

*=Accredited Analyte

PLEASE NOTE: Liability and Damages. Cardinal's liability and client's exclusive remedy for any claim arising, whether based in contract or tort, shall be limited to the amount paid by client for analyses. All claims, including those for negligence and any other cause whatsoever shall be deemed waived unless made in writing and received by Cardinal within thirty (30) days after completion of the applicable service. In no event shall Cardinal be liable for incidental or consequential damages, including, without limitation, business interruptions, loss of use, or loss of profits incurred by client, its subsidiaries, affiliates or successors arising out of or related to the performance of the services hereunder by Cardinal, regardless of whether such claim is based upon any of the above stated reasons or otherwise. Results relate only to the samples identified above. This report shall not be reproduced except in full with written approval of Cardinal Laboratories.



Celey D. Keene, Lab Director/Quality Manager

Analytical Results For:

CIMAREX ENERGY CO.-MIDLAND
600 N. MARIENFELD ST, SUITE 600
MIDLAND TX, 79701

Project: SNODDY POND
Project Number: NONE GIVEN
Project Manager: GREG LINGAFELTER
Fax To: UNK-NOWN

Reported:
28-Feb-13 15:54

Semivolatile Organic Compounds by GCMS - Quality Control

Cardinal Laboratories

Analyte	Result	Reporting Limit	Units	Spike Level	Source Result	%REC	%REC Limits	RPD	RPD Limit	Notes
---------	--------	-----------------	-------	-------------	---------------	------	-------------	-----	-----------	-------

Batch 3020508 - SW846-3510

Blank (3020508-BLK1)

Prepared & Analyzed: 05-Feb-13

Naphthalene	ND	0.001	mg/L							
2-Methylnaphthalene	ND	0.001	mg/L							
1-Methylnaphthalene	ND	0.001	mg/L							
Acenaphthylene	ND	0.001	mg/L							
Acenaphthene	ND	0.001	mg/L							
Fluorene	ND	0.001	mg/L							
Phenanthrene	ND	0.001	mg/L							
Anthracene	ND	0.001	mg/L							
Carbazole	ND	0.001	mg/L							
Fluoranthene	ND	0.001	mg/L							
Pyrene	ND	0.001	mg/L							
Benzo[a]anthracene	ND	0.001	mg/L							
Chrysene	ND	0.001	mg/L							
Benzo[b]fluoranthene	ND	0.001	mg/L							
Benzo[k]fluoranthene	ND	0.001	mg/L							
Benzo[a]pyrene	ND	0.0002	mg/L							
Indeno[1,2,3-cd]pyrene	ND	0.001	mg/L							
Dibenz[a,h]anthracene	ND	0.001	mg/L							
Benzo[g,h,i]perylene	ND	0.001	mg/L							
Surrogate: Nitrobenzene-d5	0.0424		mg/L	0.0500		84.8	35-114			
Surrogate: 2-Fluorobiphenyl	0.0457		mg/L	0.0500		91.4	43-116			
Surrogate: Terphenyl-d14	0.0508		mg/L	0.0500		102	33-141			

LCS (3020508-BS1)

Prepared & Analyzed: 05-Feb-13

Naphthalene	0.010	0.001	mg/L	0.0125		78.7	21-133			
2-Methylnaphthalene	0.010	0.001	mg/L	0.0125		82.6	21-133			
Acenaphthylene	0.010	0.001	mg/L	0.0125		82.6	33-145			
Acenaphthene	0.010	0.001	mg/L	0.0125		79.3	47-145			
Fluorene	0.010	0.001	mg/L	0.0125		80.4	59-121			
Phenanthrene	0.011	0.001	mg/L	0.0125		85.4	54-120			
Anthracene	0.010	0.001	mg/L	0.0125		81.7	27-133			
Carbazole	0.010	0.001	mg/L	0.0125		77.7	70-130			

Cardinal Laboratories

*=Accredited Analyte

PLEASE NOTE: Liability and Damages. Cardinal's liability and client's exclusive remedy for any claim arising, whether based in contract or tort, shall be limited to the amount paid by client for analyses. All claims, including those for negligence and any other cause whatsoever shall be deemed waived unless made in writing and received by Cardinal within thirty (30) days after completion of the applicable service. In no event shall Cardinal be liable for incidental or consequential damages, including, without limitation, business interruptions, loss of use, or loss of profits incurred by client, its subsidiaries, affiliates or successors arising out of or related to the performance of the services hereunder by Cardinal, regardless of whether such claim is based upon any of the above stated reasons or otherwise. Results relate only to the samples identified above. This report shall not be reproduced except in full with written approval of Cardinal Laboratories.

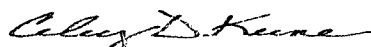

Celey D. Keene, Lab Director/Quality Manager

Analytical Results For:

CIMAREX ENERGY CO.-MIDLAND
600 N. MARIENFELD ST, SUITE 600
MIDLAND TX, 79701

Project: SNODDY POND
Project Number: NONE GIVEN
Project Manager: GREG LINGAFELTER
Fax To: UNK-NOWN

Reported:
28-Feb-13 15:54

Semivolatile Organic Compounds by GCMS - Quality Control
Cardinal Laboratories

Analyte	Result	Reporting Limit	Units	Spike Level	Source Result	%REC	%REC Limits	RPD	RPD Limit	Notes
---------	--------	-----------------	-------	-------------	---------------	------	-------------	-----	-----------	-------

Batch 3020508 - SW846-3510
LCS (3020508-BS1)

Prepared & Analyzed: 05-Feb-13

Fluoranthene	0.010	0.001	mg/L	0.0125		83.3	26-137			
Pyrene	0.010	0.001	mg/L	0.0125		80.7	52-115			
Benzo[a]anthracene	0.009	0.001	mg/L	0.0125		75.8	33-143			
Chrysene	0.010	0.001	mg/L	0.0125		81.8	17-168			
Benzo[b]fluoranthene	0.010	0.001	mg/L	0.0125		76.5	24-159			
Benzo[k]fluoranthene	0.010	0.001	mg/L	0.0125		83.6	11-162			
Benzo[a]pyrene	0.010	0.0002	mg/L	0.0125		80.4	17-163			
Indeno[1,2,3-cd]pyrene	0.010	0.001	mg/L	0.0125		82.4	0-171			
Dibenz[a,h]anthracene	0.010	0.001	mg/L	0.0125		81.9	0-227			
Benzo[g,h,i]perylene	0.010	0.001	mg/L	0.0125		82.5	0-219			

LCS Dup (3020508-BSD1)

Prepared & Analyzed: 05-Feb-13

Naphthalene	0.010	0.001	mg/L	0.0125		79.0	21-133	0.304	20	
2-Methylnaphthalene	0.010	0.001	mg/L	0.0125		82.8	21-133	0.193	20	
Acenaphthylene	0.010	0.001	mg/L	0.0125		82.4	33-145	0.291	20	
Acenaphthene	0.010	0.001	mg/L	0.0125		76.4	47-145	3.70	20	
Fluorene	0.010	0.001	mg/L	0.0125		77.8	59-121	3.34	20	
Phenanthrene	0.010	0.001	mg/L	0.0125		83.4	54-120	2.27	20	
Anthracene	0.010	0.001	mg/L	0.0125		79.8	27-133	2.38	20	
Carbazole	0.010	0.001	mg/L	0.0125		79.4	70-130	2.14	20	
Fluoranthene	0.011	0.001	mg/L	0.0125		84.9	26-137	1.90	20	
Pyrene	0.010	0.001	mg/L	0.0125		83.4	52-115	3.31	20	
Benzo[a]anthracene	0.010	0.001	mg/L	0.0125		83.7	33-143	9.93	20	
Chrysene	0.010	0.001	mg/L	0.0125		79.7	17-168	2.67	20	
Benzo[b]fluoranthene	0.010	0.001	mg/L	0.0125		76.7	24-159	0.313	20	
Benzo[k]fluoranthene	0.010	0.001	mg/L	0.0125		80.2	11-162	4.10	20	
Benzo[a]pyrene	0.010	0.0002	mg/L	0.0125		79.3	17-163	1.40	20	
Indeno[1,2,3-cd]pyrene	0.010	0.001	mg/L	0.0125		82.1	0-171	0.389	20	
Dibenz[a,h]anthracene	0.010	0.001	mg/L	0.0125		81.5	0-227	0.489	20	
Benzo[g,h,i]perylene	0.010	0.001	mg/L	0.0125		81.1	0-219	1.66	20	

Cardinal Laboratories

*=Accredited Analyte

PLEASE NOTE: Liability and Damages. Cardinal's liability and client's exclusive remedy for any claim arising, whether based in contract or tort, shall be limited to the amount paid by client for analyses. All claims, including those for negligence and any other cause whatsoever shall be deemed waived unless made in writing and received by Cardinal within thirty (30) days after completion of the applicable service. In no event shall Cardinal be liable for incidental or consequential damages, including, without limitation, business interruptions, loss of use, or loss of profits incurred by client, its subsidiaries, affiliates or successors arising out of or related to the performance of the services hereunder by Cardinal, regardless of whether such claim is based upon any of the above stated reasons or otherwise. Results relate only to the samples identified above. This report shall not be reproduced except in full with written approval of Cardinal Laboratories.

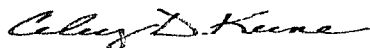

Celey D. Keene, Lab Director/Quality Manager

Notes and Definitions

SUB-SS	Analysis subcontracted to SunStar Laboratories, Inc.
SUB-RS	Analysis subcontracted to Radiation Safety Engineering, Inc.
GAL	Analysis subcontracted to Green Analytical Laboratories, a subsidiary of Cardinal Laboratories.
ND	Analyte NOT DETECTED at or above the reporting limit
RPD	Relative Percent Difference
**	Samples not received at proper temperature of 6°C or below.
***	Insufficient time to reach temperature.
-	Chloride by SM4500Cl-B does not require samples be received at or below 6°C Samples reported on an as received basis (wet) unless otherwise noted on report

Cardinal Laboratories

*=Accredited Analyte

PLEASE NOTE: Liability and Damages. Cardinal's liability and client's exclusive remedy for any claim arising, whether based in contract or tort, shall be limited to the amount paid by client for analyses. All claims, including those for negligence and any other cause whatsoever shall be deemed waived unless made in writing and received by Cardinal within thirty (30) days after completion of the applicable service. In no event shall Cardinal be liable for incidental or consequential damages, including, without limitation, business interruptions, loss of use, or loss of profits incurred by client, its subsidiaries, affiliates or successors arising out of or related to the performance of the services hereunder by Cardinal, regardless of whether such claim is based upon any of the above stated reasons or otherwise. Results relate only to the samples identified above. This report shall not be reproduced except in full with written approval of Cardinal Laboratories.

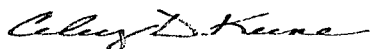

Celey D. Keene, Lab Director/Quality Manager





CHAIN-OF-CUSTODY AND ANALYSIS REQUEST

101 East Marland, Hobbs, NM 88240
(575) 393-2326 FAX (575) 393-2476

[illegible]

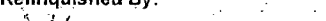
PLEASE NOTE: Liability and Damages. Cardinal's liability and client's exclusive remedy for any claim arising whether based in contract or tort, shall be limited to the amount paid by the client for the analyses. All claims, including those for negligence and any other cause whatsoever shall be deemed waived unless made in writing and received by Cardinal within 30 days after completion of the applicable service. In no event shall Cardinal be liable for incidental or consequential damages, including without limitation, business interruptions, loss of use, or loss of profits incurred by client, its subsidiaries, affiliates or successors arising out of or related to the performance of services hereunder by Cardinal, regardless of whether such claim is based upon any of the above stated reasons or otherwise.

Relinquished By:		Date:	Received By:	Phone Result:	<input type="checkbox"/> Yes <input type="checkbox"/> No	Add'l Phone #:
		1-24-13		Fax Result:	<input type="checkbox"/> Yes <input type="checkbox"/> No	Add'l Fax #:
Relinquished By:		Time:		REMARKS:		
		14:13pm		JLingard@ci.maricopa.com - 432-260-7789 cell		
Date:		Received By:	DMargum@ci.maricopa.com			
Time:			TSathern@ci.maricopa.com			
Delivered By: (Circle One)		Sample Condition		CHECKED BY:		
Sampler - UPS - Bus - Other:		Cool Intact		(Initials)		
		<input type="checkbox"/> Yes <input type="checkbox"/> No <input type="checkbox"/> Yes <input type="checkbox"/> No				

† Cardinal cannot accept verbal changes. Please fax written changes to (575) 393-2326