

HOBBS OCD

MAR 11 2013

District I  
1625 N. French Dr., Hobbs, NM 88240  
Phone: (575) 393-6161 Fax: (575) 393-0720  
District II  
811 S. First St., Artesia, NM 88210  
Phone: (575) 748-1283 Fax: (575) 748-9720  
District III  
1000 Rio Brazos Road, Aztec, NM 87410  
Phone: (505) 334-6178 Fax: (505) 334-6170  
District IV  
1220 S. St. Francis Dr., Santa Fe, NM 87505  
Phone: (505) 476-3460 Fax: (505) 476-3462

State of New Mexico

Energy, Minerals & Natural Resources Department  
**RECEIVED** OIL CONSERVATION DIVISION

1220 South St. Francis Dr.  
Santa Fe, NM 87505

Form C-102

Revised August 1, 2011

Submit one copy to appropriate  
District Office

☐ AMENDED REPORT

WELL LOCATION AND ACREAGE DEDICATION PLAT

|   |   |   |
|---|---|---|
| <sup>1</sup> API Number<br>30-025-36689 | <sup>2</sup> Pool Code<br>33230   | <sup>3</sup> Pool Name<br>House; Blinebry |
| <sup>4</sup> Property Code<br>303233    | <sup>5</sup> Property Name<br>White Owl   | <sup>6</sup> Well Number<br>001           |
| <sup>7</sup> OGRID No.<br>873           | <sup>8</sup> Operator Name<br>Apache Corporation: 303 Veterans Airpark Lane, Suite 3000 Midland, TX 79705 | <sup>9</sup> Elevation<br>3573' GR        |

<sup>10</sup> Surface Location

| UL or lot no. | Section | Township | Range | Lot Idn | Feet from the | North/South line | Feet from the | East/West line | County |
|---------------|---------|----------|-------|---------|---------------|------------------|---------------|----------------|--------|
| D             | 02      | 20S      | 38E   | 04      | 582           | North            | 330           | West           | Lea    |

<sup>11</sup> Bottom Hole Location If Different From Surface

| UL or lot no. | Section | Township | Range | Lot Idn | Feet from the | North/South line | Feet from the | East/West line | County |
|---------------|---------|----------|-------|---------|---------------|------------------|---------------|----------------|--------|
| D             | 02      | 20S      | 38E   | 04      | 1268          | North            | 335           | West           | Lea    |

|                                       |                               |                                  |                         |
|---------------------------------------|-------------------------------|----------------------------------|-------------------------|
| <sup>12</sup> Dedicated Acres<br>40.0 | <sup>13</sup> Joint or Infill | <sup>14</sup> Consolidation Code | <sup>15</sup> Order No. |
|---------------------------------------|-------------------------------|----------------------------------|-------------------------|

No allowable will be assigned to this completion until all interests have been consolidated or a non-standard unit has been approved by the division.

|  |  |  |  |   |
|--|--|--|--|---|
|  |  |  |  | <p><b><sup>17</sup> OPERATOR CERTIFICATION</b></p> <p><i>I hereby certify that the information contained herein is true and complete to the best of my knowledge and belief, and that this organization either owns a working interest or unleased mineral interest in the land including the proposed bottom hole location or has a right to drill this well at this location pursuant to a contract with an owner of such a mineral or working interest, or to a voluntary pooling agreement or a compulsory pooling order heretofore entered by the division.</i></p> <p> <br/>           Signature         </p> <p>03/04/2013<br/>Date</p> <p>Fatima Vasquez<br/>Printed Name</p> <p>Fatima.Vasquez@apachecorp.com<br/>E-mail Address</p> |
|  |  |  |  | <p><b><sup>18</sup> SURVEYOR CERTIFICATION</b></p> <p><i>I hereby certify that the well location shown on this plat was plotted from field notes of actual surveys made by me or under my supervision, and that the same is true and correct to the best of my belief.</i></p>  |
|  |  |  |  | <p>Date of Survey</p> <p>Signature and Seal of Professional Surveyor</p>  |
|  |  |  |  | <p>Certificate Number</p>   |

SEP 09 2013

District I  
1625 N. French Dr., Hobbs, NM 88240  
Phone: (575) 393-6161 Fax: (575) 393-0720  
District II  
811 S. First St., Artesia, NM 88210  
Phone: (575) 748-1283 Fax: (575) 748-9720  
District III  
1000 Rio Brazos Road, Aztec, NM 87410  
Phone: (505) 334-6178 Fax: (505) 334-6170  
District IV  
1220 S. St. Francis Dr., Santa Fe, NM 87505  
Phone: (505) 476-3460 Fax: (505) 476-3462

**HOBBS OCD**  
**MAR 11 2013**

**RECEIVED**

State of New Mexico  
Energy, Minerals & Natural Resources Department  
**OIL CONSERVATION DIVISION**  
1220 South St. Francis Dr.  
Santa Fe, NM 87505

Form C-102  
Revised August 1, 2011  
Submit one copy to appropriate  
District Office

☐ AMENDED REPORT

**WELL LOCATION AND ACREAGE DEDICATION PLAT**

|   |   |                                       |
|---|---|---------------------------------------|
| <sup>1</sup> API Number<br>30-025-36689 | <sup>2</sup> Pool Code<br>78760   | <sup>3</sup> Pool Name<br>House; Tubb |
| <sup>4</sup> Property Code<br>303233    | <sup>5</sup> Property Name<br>White Owl   | <sup>6</sup> Well Number<br>001       |
| <sup>7</sup> OGRID No.<br>873           | <sup>8</sup> Operator Name<br>Apache Corporation: 303 Veterans Airpark Lane, Suite 3000 Midland, TX 79705 | <sup>9</sup> Elevation<br>3573' GR    |

<sup>10</sup> Surface Location

| UL or lot no. | Section | Township | Range | Lot Idn | Feet from the | North/South line | Feet from the | East/West line | County |
|---------------|---------|----------|-------|---------|---------------|------------------|---------------|----------------|--------|
| D             | 02      | 20S      | 38E   | 04      | 582           | North            | 330           | West           | Lea    |

<sup>11</sup> Bottom Hole Location If Different From Surface

| UL or lot no. | Section | Township | Range | Lot Idn | Feet from the | North/South line | Feet from the | East/West line | County |
|---------------|---------|----------|-------|---------|---------------|------------------|---------------|----------------|--------|
| D             | 02      | 20S      | 38E   | 04      | 1268          | North            | 335           | West           | Lea    |

|                                       |                               |                                  |                         |
|---------------------------------------|-------------------------------|----------------------------------|-------------------------|
| <sup>12</sup> Dedicated Acres<br>40.0 | <sup>13</sup> Joint or Infill | <sup>14</sup> Consolidation Code | <sup>15</sup> Order No. |
|---------------------------------------|-------------------------------|----------------------------------|-------------------------|

No allowable will be assigned to this completion until all interests have been consolidated or a non-standard unit has been approved by the division.

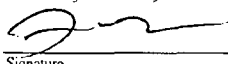
|  |  |  |  |   |
|--|--|--|--|---|
|  |  |  |  | <p><b><sup>17</sup> OPERATOR CERTIFICATION</b></p> <p><i>I hereby certify that the information contained herein is true and complete to the best of my knowledge and belief, and that this organization either owns a working interest or unleased mineral interest in the land including the proposed bottom hole location or has a right to drill this well at this location pursuant to a contract with an owner of such a mineral or working interest, or to a voluntary pooling agreement or a compulsory pooling order heretofore entered by the division.</i></p> <p> 03/05/2013</p> <p>Signature Date</p> <p>Fatima Vasquez</p> <p>Printed Name</p> <p>Fatima.Vasquez@apachecorp.com</p> <p>E-mail Address</p> |
|  |  |  |  |   |
|  |  |  |  |   |
|  |  |  |  |   |
|  |  |  |  | <p><b><sup>18</sup> SURVEYOR CERTIFICATION</b></p> <p><i>I hereby certify that the well location shown on this plat was plotted from field notes of actual surveys made by me or under my supervision, and that the same is true and correct to the best of my belief.</i></p> <p>Date of Survey</p> <p>Signature and Seal of Professional Surveyor:</p> <p>Certificate Number</p>  |
|  |  |  |  |   |
|  |  |  |  |   |
|  |  |  |  |   |

District I  
1625 N. French Dr., Hobbs, NM 88240  
Phone: (575) 393-6161 Fax: (575) 393-0720  
District II  
811 S. First St., Artesia, NM 88210  
Phone: (575) 748-1283 Fax: (575) 748-9720  
District III  
1000 Rio Brazos Road, Aztec, NM 87410  
Phone: (505) 334-6178 Fax: (505) 334-6170  
District IV  
1220 S. St. Francis Dr., Santa Fe, NM 87505  
Phone: (505) 476-3460 Fax: (505) 476-3462

**HOBBS OCEAN**  
Energy, Minerals & Natural Resources Department  
MAR 11 2013  
OIL CONSERVATION DIVISION  
1220 South St. Francis Dr.  
Santa Fe, NM 87505

Form C-102  
Revised August 1, 2011  
Submit one copy to appropriate  
District Office

☐ AMENDED REPORT

# WELL LOCATION AND ACREAGE DEDICATION PLAT

|   |   |   |
|---|---|---|
| <sup>1</sup> API Number<br>30-025-36689 | <sup>2</sup> Pool Code<br>33250   | <sup>3</sup> Pool Name<br>House; Drinkard |
| <sup>4</sup> Property Code<br>303233    | <sup>5</sup> Property Name<br>White Owl   | <sup>6</sup> Well Number<br>001           |
| <sup>7</sup> OGRID No.<br>873           | <sup>8</sup> Operator Name<br>Apache Corporation: 303 Veterans Airpark Lane, Suite 3000 Midland, TX 79705 | <sup>9</sup> Elevation<br>3573' GR        |

## <sup>10</sup> Surface Location

| UL or lot no. | Section | Township | Range | Lot Idn | Feet from the | North/South line | Feet from the | East/West line | County |
|---------------|---------|----------|-------|---------|---------------|------------------|---------------|----------------|--------|
| D             | 02      | 20S      | 38E   | 04      | 582           | North            | 330           | West           | Lea    |

## <sup>11</sup> Bottom Hole Location If Different From Surface

| UL or lot no. | Section | Township | Range | Lot Idn | Feet from the | North/South line | Feet from the | East/West line | County |
|---------------|---------|----------|-------|---------|---------------|------------------|---------------|----------------|--------|
| D             | 02      | 20S      | 38E   | 04      | 1268          | North            | 335           | West           | Lea    |

|                                       |                               |                                  |                         |
|---------------------------------------|-------------------------------|----------------------------------|-------------------------|
| <sup>12</sup> Dedicated Acres<br>40.0 | <sup>13</sup> Joint or Infill | <sup>14</sup> Consolidation Code | <sup>15</sup> Order No. |
|---------------------------------------|-------------------------------|----------------------------------|-------------------------|

No allowable will be assigned to this completion until all interests have been consolidated or a non-standard unit has been approved by the division.

|  |  |  |  |  |
|--|--|--|--|--|
|  |  |  |  | <b><sup>17</sup> OPERATOR CERTIFICATION</b><br>I hereby certify that the information contained herein is true and complete to the best of my knowledge and belief, and that this organization either owns a working interest or unleased mineral interest in the land including the proposed bottom hole location or has a right to drill this well at this location pursuant to a contract with an owner of such a mineral or working interest, or to a voluntary pooling agreement or a compulsory pooling order heretofore entered by the division.<br><br>Signature Date 03/05/2013<br>Printed Name<br>Fatima Vasquez<br>E-mail Address<br>Fatima.Vasquez@apachecorp.com |
|  |  |  |  | <b><sup>18</sup> SURVEYOR CERTIFICATION</b><br>I hereby certify that the well location shown on this plat was plotted from field notes of actual surveys made by me or under my supervision, and that the same is true and correct to the best of my belief.<br>Date of Survey<br>Signature and Seal of Professional Surveyor:   |
|  |  |  |  | Certificate Number   |
|  |  |  |  |  |

District I  
1625 N. French Dr., Hobbs, NM 88240  
Phone: (575) 393-6161 Fax: (575) 393-0720

District II  
811 S. First St., Artesia, NM 88210  
Phone: (575) 748-1283 Fax: (575) 748-9720

District III  
1000 Rio Brazos Road, Aztec, NM 87410  
Phone: (505) 334-6178 Fax: (505) 334-6170

District IV  
1220 S. St. Francis Dr., Santa Fe, NM 87505  
Phone: (505) 476-3460 Fax: (505) 476-3462

State of New Mexico  
Energy, Minerals & Natural Resources Department  
OIL CONSERVATION DIVISION  
1220 South St. Francis Dr.  
Santa Fe, NM 87505

Form C-102  
Revised August 1, 2011  
Submit one copy to appropriate  
District Office

☐ AMENDED REPORT

HOBBS OCD

MAR 11 2013

WELL LOCATION AND ACREAGE DEDICATION PLAT

|   |   |                                      |
|---|---|--------------------------------------|
| <sup>1</sup> API Number<br>30-025-36689 | <sup>2</sup> Pool Code<br>332-10  | <sup>3</sup> Pool Name<br>House; Abo |
| <sup>4</sup> Property Code<br>303233    | <sup>5</sup> Property Name<br>White Owl   | <sup>6</sup> Well Number<br>001      |
| <sup>7</sup> OGRID No.<br>873           | <sup>8</sup> Operator Name<br>Apache Corporation: 303 Veterans Airpark Lane, Suite 3000 Midland, TX 79705 | <sup>9</sup> Elevation<br>3573' GR   |

<sup>10</sup> Surface Location

|                    |               |                 |              |               |                      |                           |                      |                        |               |
|--------------------|---------------|-----------------|--------------|---------------|----------------------|---------------------------|----------------------|------------------------|---------------|
| UL or lot no.<br>D | Section<br>02 | Township<br>20S | Range<br>38E | Lot Idn<br>04 | Feet from the<br>582 | North/South line<br>North | Feet from the<br>330 | East/West line<br>West | County<br>Lea |
|--------------------|---------------|-----------------|--------------|---------------|----------------------|---------------------------|----------------------|------------------------|---------------|

<sup>11</sup> Bottom Hole Location If Different From Surface

|                                       |                               |                                  |                         |               |                       |                           |                      |                        |               |
|---------------------------------------|-------------------------------|----------------------------------|-------------------------|---------------|-----------------------|---------------------------|----------------------|------------------------|---------------|
| UL or lot no.<br>D                    | Section<br>02                 | Township<br>20S                  | Range<br>38E            | Lot Idn<br>04 | Feet from the<br>1268 | North/South line<br>North | Feet from the<br>335 | East/West line<br>West | County<br>Lea |
| <sup>12</sup> Dedicated Acres<br>80.0 | <sup>13</sup> Joint or Infill | <sup>14</sup> Consolidation Code | <sup>15</sup> Order No. |               |                       |                           |                      |                        |               |

No allowable will be assigned to this completion until all interests have been consolidated or a non-standard unit has been approved by the division.

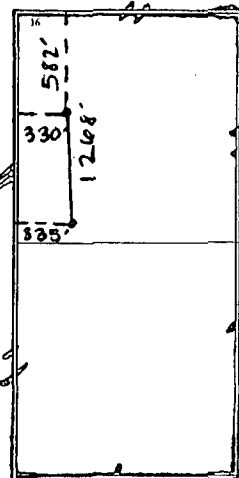

<sup>17</sup> OPERATOR CERTIFICATION

I hereby certify that the information contained herein is true and complete to the best of my knowledge and belief, and that this organization either owns a working interest or unleased mineral interest in the land including the proposed bottom hole location or has a right to drill this well at this location pursuant to a contract with an owner of such a mineral or working interest, or to a voluntary pooling agreement or a compulsory pooling order heretofore entered by the division.

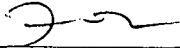
 03/04/2013  
Signature Date

Fatima Vasquez

Printed Name

Fatima.Vasquez@apachecorp.com

E-mail Address

<sup>18</sup> SURVEYOR CERTIFICATION

I hereby certify that the well location shown on this plat was plotted from field notes of actual surveys made by me or under my supervision, and that the same is true and correct to the best of my belief.

Date of Survey

Signature and Seal of Professional Surveyor:

Certificate Number