

HOBBS OCD

State of New Mexico

DISTRICT I

1625 N. FRENCH DR., HOBBS, NM 88240

Energy, Minerals and Natural Resources Department

Form C-102

Revised October 12, 2005

Submit to Appropriate District Office

State Lease - 4 Copies

Fee Lease - 3 Copies

DISTRICT II

1301 W. GRAND AVENUE, ARTESIA, NM 88210

OIL CONSERVATION DIVISION

1220 SOUTH ST. FRANCIS DR.

Santa Fe, New Mexico 87505

DISTRICT III

1000 Rio Brazos Rd., Aztec, NM 87410

RECEIVED

DISTRICT IV

1220 S. ST. FRANCIS DR., SANTA FE, NM 87505

WELL LOCATION AND ACREAGE DEDICATION PLAT

☐ AMENDED REPORT

API Number 30-025-41483	Pool Code 50350	Pool Name <i>Penrose Skelly Bragburg</i>
Property Code 2690	Property Name W.T. MCCOMACK	Well Number 28
OGRID No. 4373	Operator Name CHEVRON USA INC.	Elevation 3470'

Surface Location

UL or lot No.	Section	Township	Range	Lot Idn	Feet from the	North/South line	Feet from the	East/West line	County
J	32	21-S	37-E		1330	SOUTH	2310	EAST	LEA

Bottom Hole Location If Different From Surface

UL or lot No.	Section	Township	Range	Lot Idn	Feet from the	North/South line	Feet from the	East/West line	County
Dedicated Acres 40	Joint or Infill	Consolidation Code	Order No. NSL-6015						

NO ALLOWABLE WILL BE ASSIGNED TO THIS COMPLETION UNTIL ALL INTERESTS HAVE BEEN CONSOLIDATED
OR A NON-STANDARD UNIT HAS BEEN APPROVED BY THE DIVISION

<p>GEODETIC COORDINATES NAD 27 NME</p> <p>Y=522665.6 N X=854753.9 E</p> <p>LAT.=32.431673° N LONG.=103.183560° W</p>	<p>OPERATOR CERTIFICATION</p> <p>I hereby certify that the information herein is true and complete to the best of my knowledge and belief, and that this organization either owns a working interest or unleased mineral interest in the land including the proposed bottom hole location or has a right to drill this well at this location pursuant to a contract with an owner of such mineral or working interest, or to a voluntary pooling agreement or a compulsory pooling order heretofore entered by the division.</p> <p><i>11-04-2013</i> <i>7-15-10</i></p> <p>Signature: <i>Denise Pinkerton</i> Date: <i>7-15-10</i></p> <p>Printed Name: _____</p>	
	<p>SURVEYOR CERTIFICATION</p> <p>I hereby certify that the well location shown on this plat was plotted from field notes of actual surveys made by me or under my supervision, and that the same is true and correct to the best of my belief.</p> <p>DECEMBER 19, 2008</p> <p>Date Surveyed: _____</p> <p>Signature & Seal of Professional Surveyor: <i>Ronald J. Eidson</i> <i>12/24/08</i></p> <p>Certificate No. CARY EIDSON 12641 RONALD J. EIDSON 3239</p>	
	<p>2310'</p> <p>1330'</p>	
	<p>NOV 06 2013</p>	

SECTION 32, TOWNSHIP 21 SOUTH, RANGE 37 EAST, N.M.P.M.,
LEA COUNTY, NEW MEXICO

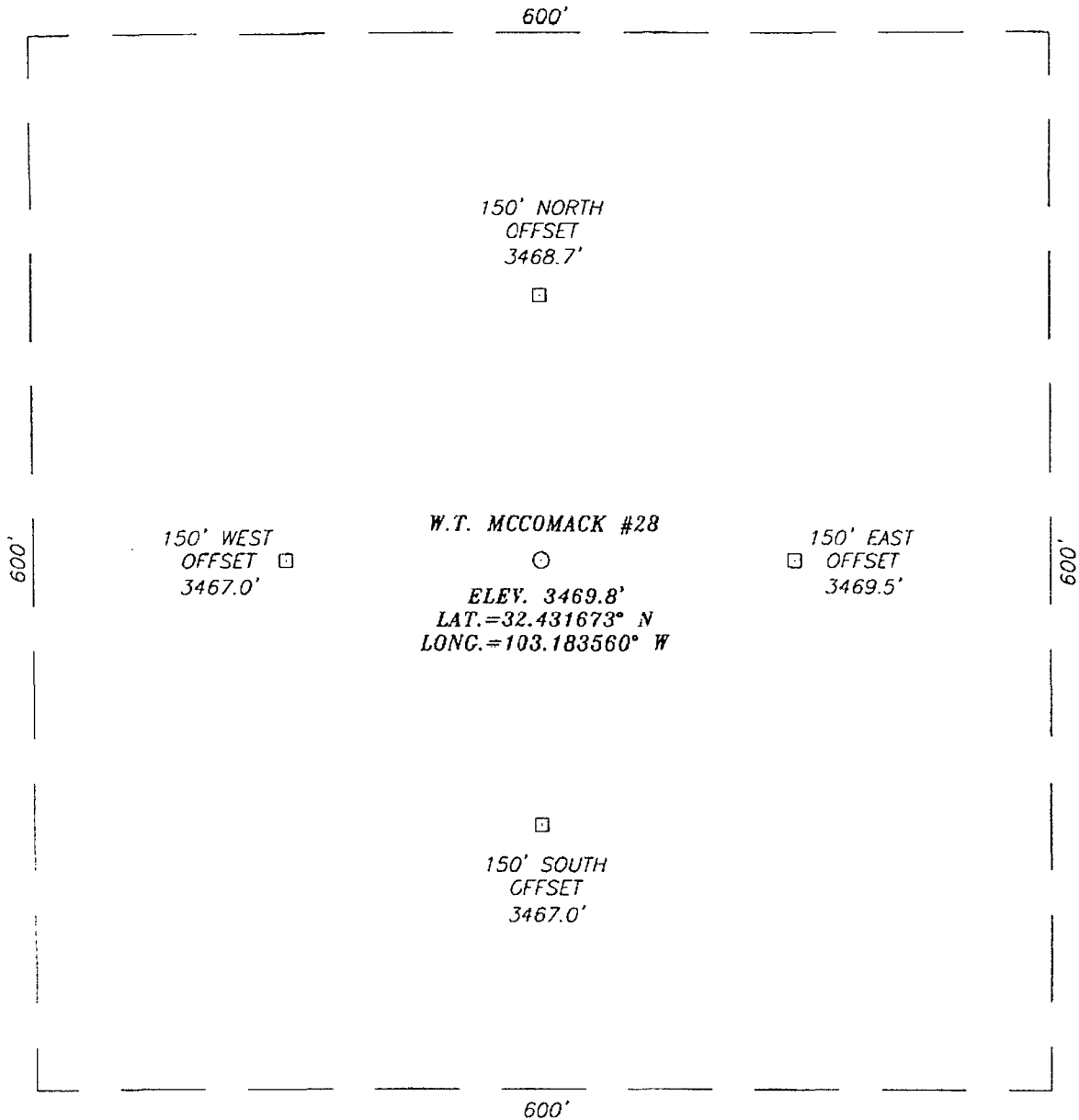

DIRECTIONS TO LOCATION

FROM THE INTERSECTION OF TEXAS AVENUE AND
LEGION ROAD, GO WEST ON TEXAS AVENUE
APPROX. 0.4 MILES. TURN LEFT AND GO SOUTH
APPROX. 0.25 MILES. THIS LOCATION IS APPROX.
400 FEET WEST OF LEASE ROAD.

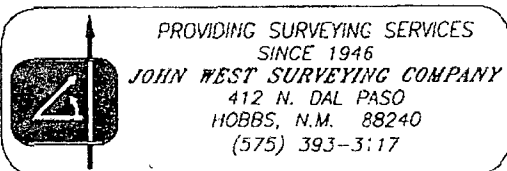
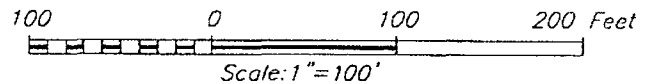

CHEVRON USA INC.

W.T. MCCOMACK #28 WELL
LOCATED 1330 FEET FROM THE SOUTH LINE
AND 2310 FEET FROM THE EAST LINE OF SECTION 32,
TOWNSHIP 21 SOUTH, RANGE 37 EAST, N.M.P.M.,
LEA COUNTY, NEW MEXICO.

Survey Date: 12/19/08	Sheet 1 of 1 Sheets
W.O. Number: 08.11.2036	Dr By: AR
Date: 12/23/08	Disk: 08112036
	Scale: 1"=100'

VICINITY MAP

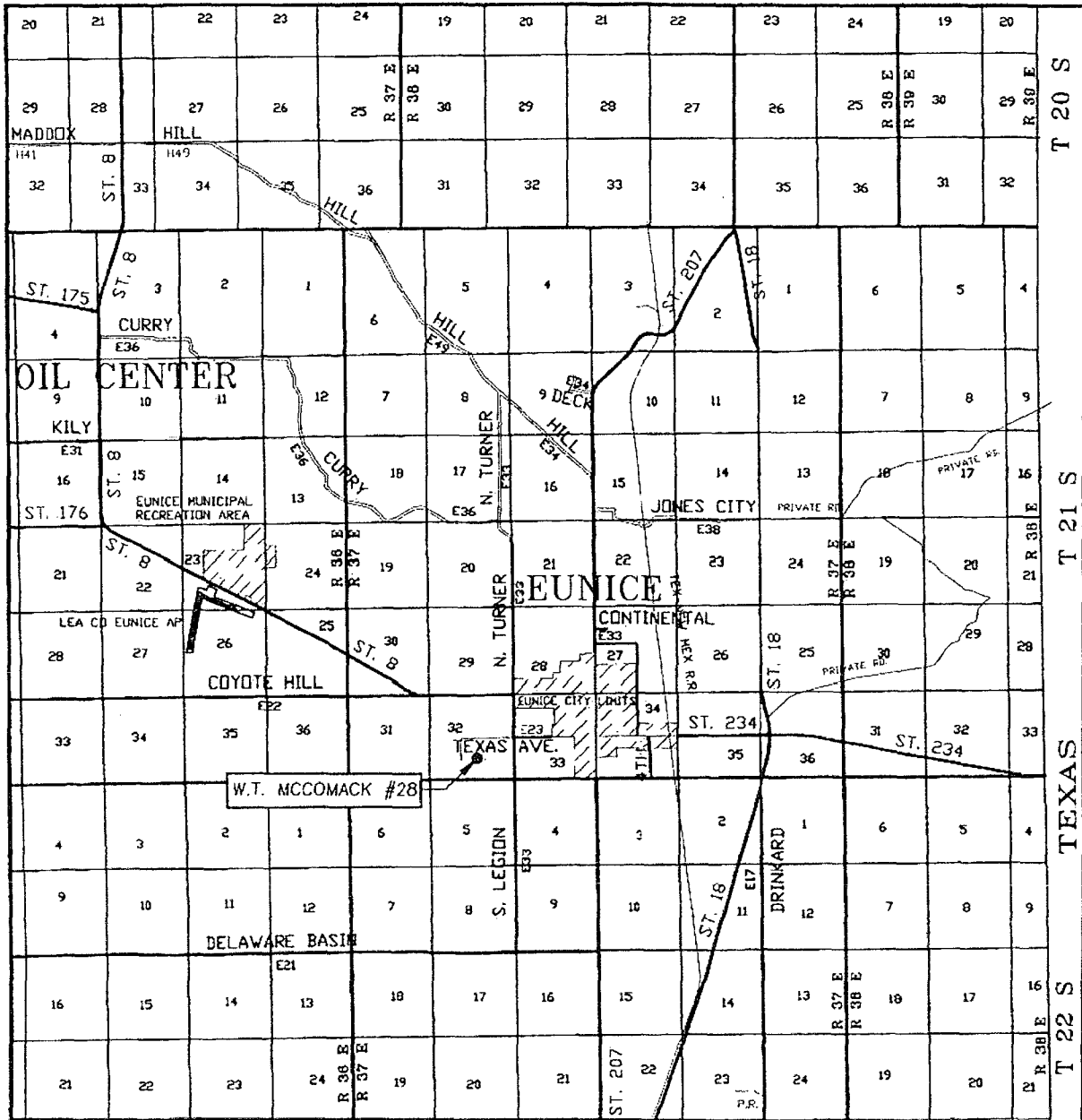

SCALE: 1" = 2 MILES

SEC. 32 TWP. 21-S RGE. 37-E

SURVEY N.M.P.M.

COUNTY LEA STATE NEW MEXICO

DESCRIPTION 1330' FSL & 2310' FEL

ELEVATION 3470'

OPERATOR CHEVRON USA INC.

LEASE W.T. MCCOMACK

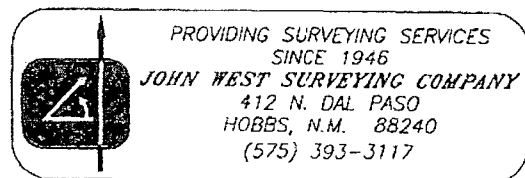

LOCATION VERIFICATION MAP

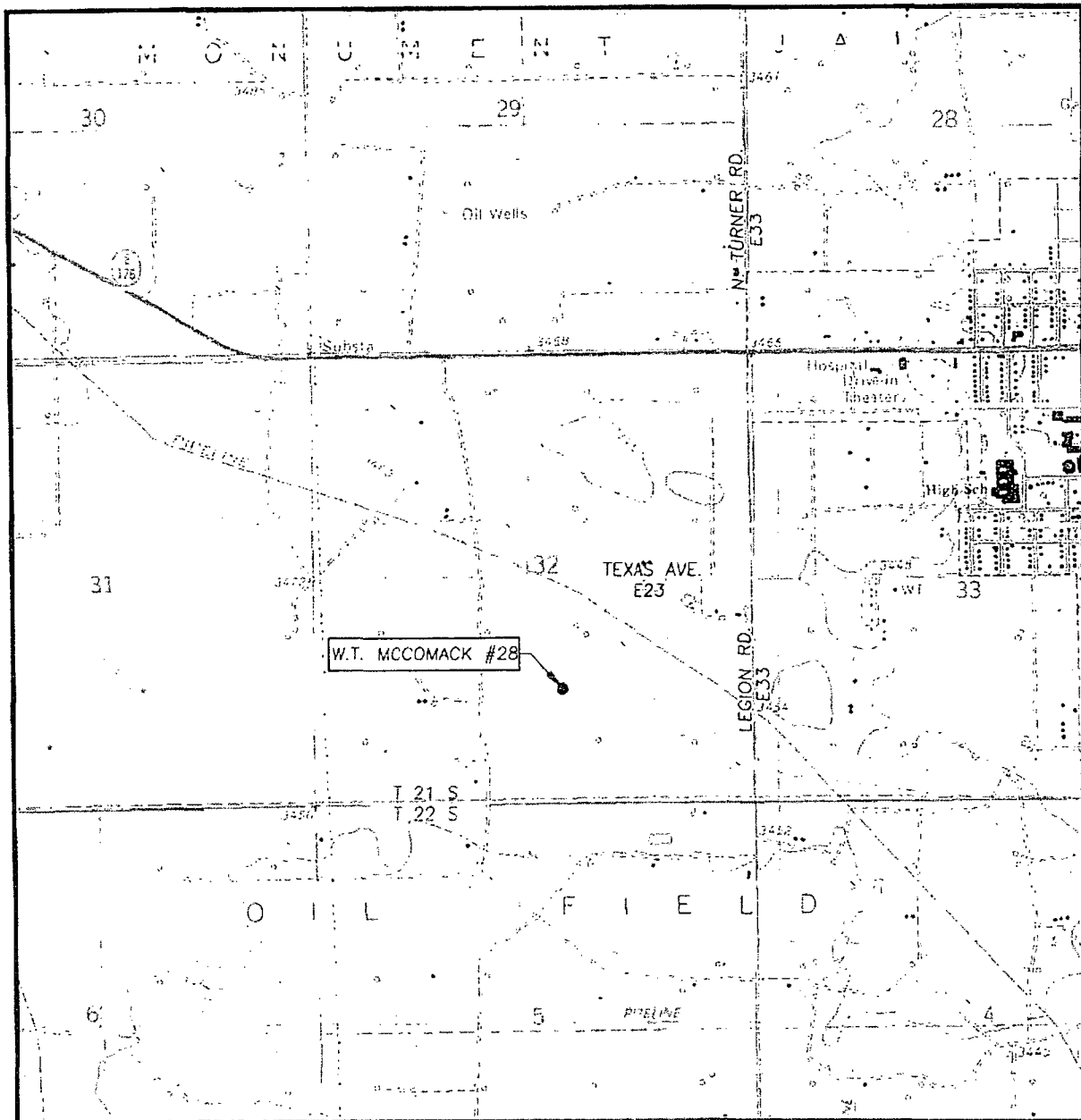

SCALE: 1" = 2000'

CONTOUR INTERVAL:
EUNICE, N.M. - 10'

SEC. 32 TWP. 21-S RGE. 37-E

SURVEY _____ N.M.P.M.

COUNTY LEA STATE NEW MEXICO

DESCRIPTION 1330' FSL & 2310' FEL

ELEVATION 3470'

OPERATOR CHEVRON USA INC.

LEASE W.T. MCCOMACK

U.S.G.S. TOPOGRAPHIC MAP
EUNICE, N.M.

