

RECEIVED

State of New Mexico

HOBBS OCD

DISTRICT I

1825 N. FRANCE DR., HOBBS, NM 88240

JUL 16 2010

Energy, Minerals and Natural Resources Department

DISTRICT II

1301 W. GRAND AVENUE, ARTESIA, NM 88203

HOBBSOCD

CONSERVATION DIVISION

1220 SOUTH ST. FRANCIS DR.

Santa Fe, New Mexico 87505

NOV 06 2013

Form C-102

Revised October 12, 2005

Submit to Appropriate District Office

State Lease - 4 Copies

Fee Lease - 3 Copies

DISTRICT III

1000 Rio Brazos Rd., Aztec, NM 87410

RECEIVED

DISTRICT IV

1220 S. ST. FRANCIS DR., SANTA FE, NM 87505

WELL LOCATION AND ACREAGE DEDICATION PLAT

☐ AMENDED REPORT

API Number 30-025-41485	Pool Code 50350	Pool Name Penrose Skelly Grayburg
Property Code 30014	Property Name STATE S	Well Number 12
OGRID No. 4323	Operator Name CHEVRON USA INC.	Elevation 3445'

Surface Location

UL or lot No.	Section	Township	Range	Lot Idn	Feet from the	North/South line	Feet from the	East/West line	County
C	15	21-S	37-E		990	NORTH	1330	WEST	LEA

Bottom Hole Location If Different From Surface

UL or lot No.	Section	Township	Range	Lot Idn	Feet from the	North/South line	Feet from the	East/West line	County

Dedicated Acres 40	Joint or Infill	Consolidation Code	Order No. NAL-6016
------------------------------	-----------------	--------------------	------------------------------

NO ALLOWABLE WILL BE ASSIGNED TO THIS COMPLETION UNTIL ALL INTERESTS HAVE BEEN CONSOLIDATED
OR A NON-STANDARD UNIT HAS BEEN APPROVED BY THE DIVISION

<p>GEODETIC COORDINATES NAD 27 NME</p> <p>Y=541557.1 N X=863464.0 E</p> <p>LAT.=32.483331° N LONG.=103.154659° W</p>	<p>OPERATOR CERTIFICATION</p> <p>I hereby certify that the information herein is true and complete to the best of my knowledge and belief, and that this organization either owns a working interest or unleased mineral interest in the land including the proposed bottom hole location or has a right to drill this well at this location pursuant to a contract with an owner of such mineral or working interest, or to a voluntary pooling agreement or a compulsory pooling order heretofore entered by the division.</p> <p>Signature <i>Denise Pinkerton</i> Date 11-04-2013 Printed Name Denise Pinkerton</p>
	<p>SURVEYOR CERTIFICATION</p> <p>I hereby certify that the well location shown on this plat was plotted from field notes of actual surveys made by me or under my supervision, and that the same is true and correct to the best of my belief.</p> <p>Signature & Seal of Professional Surveyor <i>Ronald J. Eidson</i> 11-23-08</p>
	<p>Certificate No. CARY EIDSON 12641 RONALD J. EIDSON 3239</p>

NOV 06 2013

SECTION 15, TOWNSHIP 21 SOUTH, RANGE 37 EAST, N.M.P.M.,
LEA COUNTY, NEW MEXICO

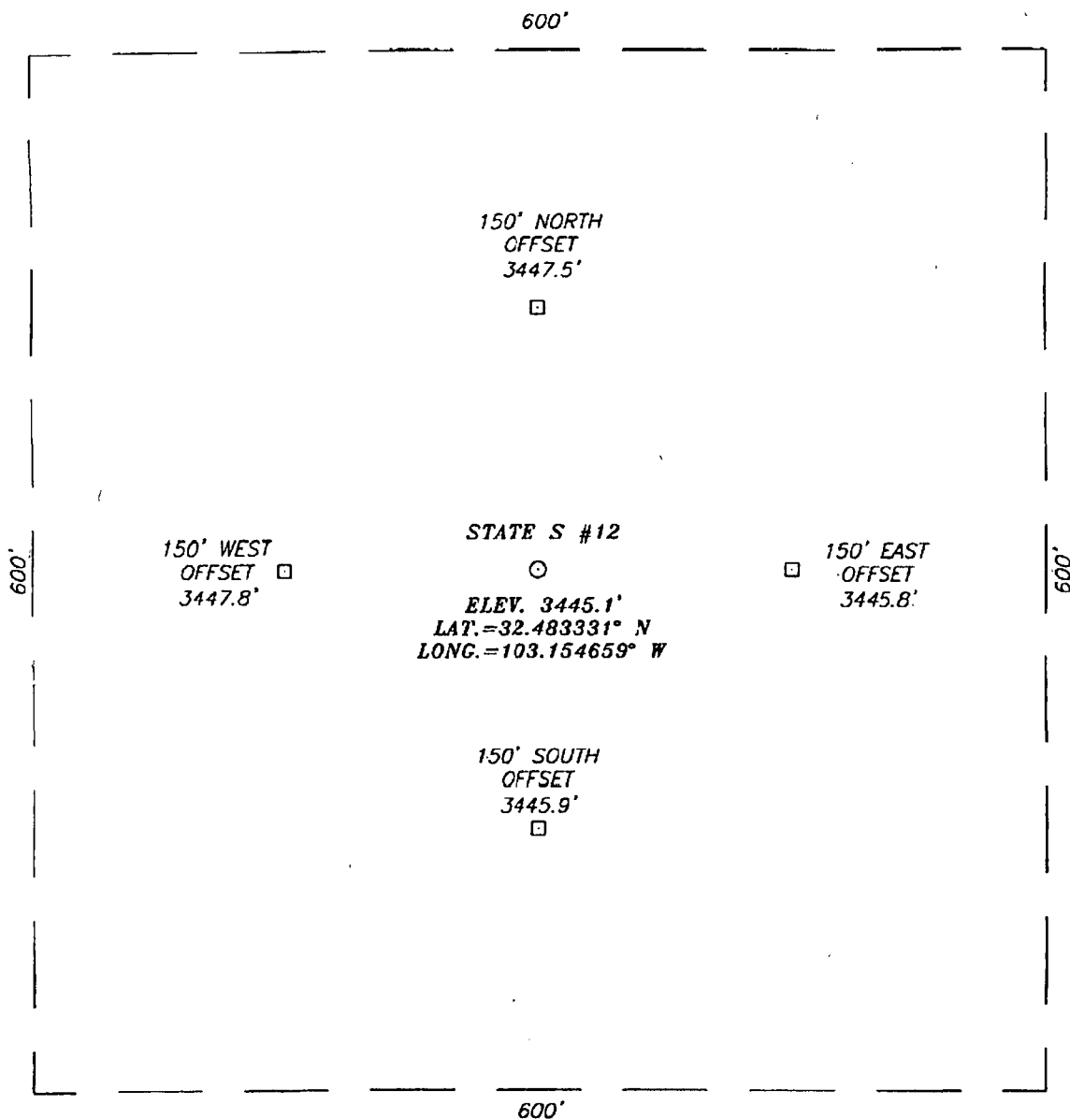

DIRECTIONS TO LOCATION

FROM THE INTERSECTION OF ST. HWY. #207 AND HILL ROAD, GO NORTH ON ST. HWY. #207 APPROX. 0.4 MILES TO A LEASE ROAD. TURN RIGHT AND GO EAST APPROX. 0.25 MILES. THIS LOCATION IS APPROX. 320 FEET SOUTH OF LEASE ROAD.

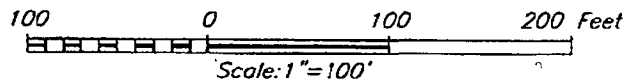

PROVIDING SURVEYING SERVICES
SINCE 1946
JOHN WEST SURVEYING COMPANY
412 N. DAL PASO
HOBBS, N.M. 88240
(575) 393-3117

CHEVRON USA INC.			
STATE S #12 WELL LOCATED 930 FEET FROM THE NORTH LINE AND 1330 FEET FROM THE WEST LINE OF SECTION 15, TOWNSHIP 21 SOUTH, RANGE 37 EAST, N.M.P.M., LEA COUNTY, NEW MEXICO.			
Survey Date: 12/18/08	Sheet 1 of 1 Sheets		
W.O. Number: 08.11.2043	Dr By: AR	Rev 1:N/A	
Date: 12/22/08	Disk:	08112043	Scale: 1"=100'

VICINITY MAP

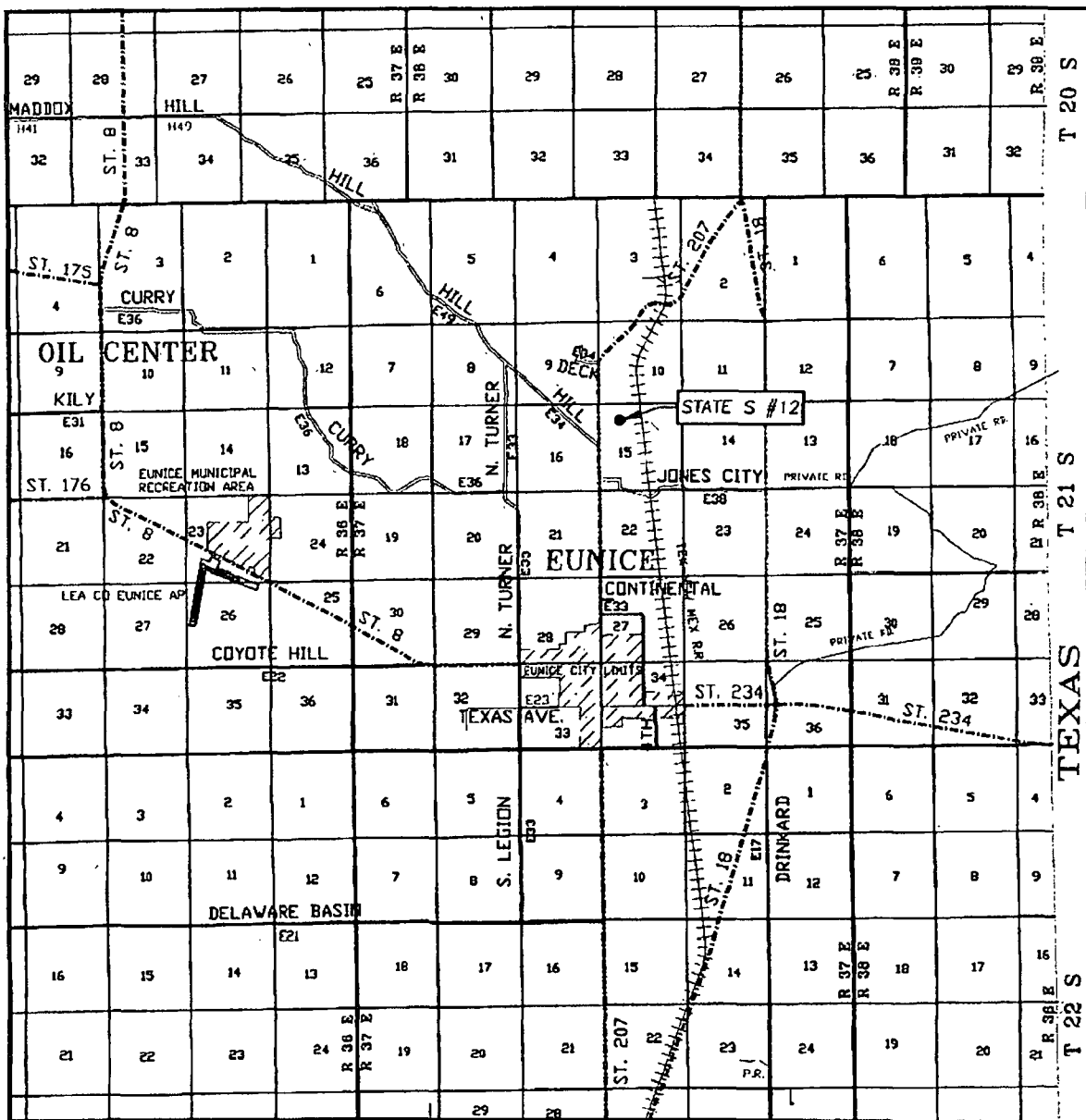

SCALE: 1" = 2 MILES

SEC. 15 TWP. 21-S. RGE. 37-E

SURVEY N.M.P.M.

COUNTY LEA STATE NEW MEXICO

DESCRIPTION 990' FNL & 1330' FWL

ELEVATION 3445'

OPERATOR CHEVRON USA INC.

LEASE STATE S

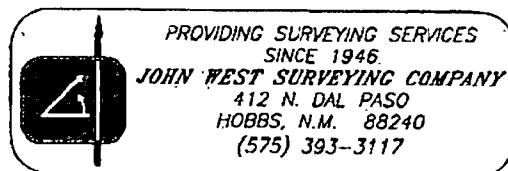

LOCATION VERIFICATION MAP

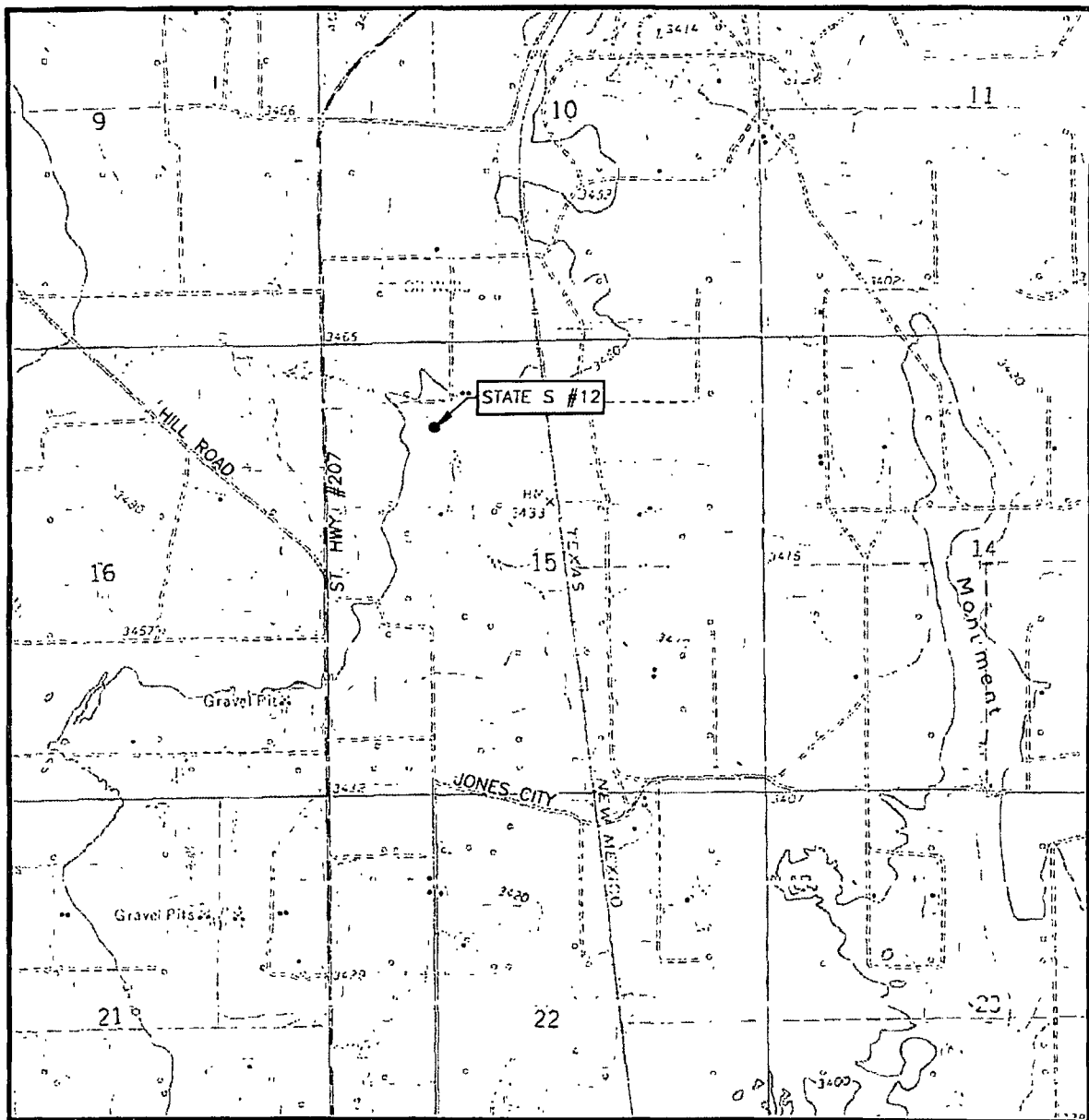

SCALE: 1" = 2000'

CONTOUR INTERVAL:
EUNICE, N.M. - 10'

SEC. 15 TWP. 21-S RGE. 37-E

SURVEY N.M.P.M.

COUNTY LEA STATE NEW MEXICO

DESCRIPTION 990' FNL & 1330' FWL

ELEVATION 3445'

OPERATOR CHEVRON USA INC.

LEASE STATE S

U.S.G.S. TOPOGRAPHIC MAP
EUNICE, N.M.

