

Submit to Appropriate
District Office
State Lease - 4 copies
Fee Lease - 3 copies

State of New Mexico
Energy, Minerals and Natural Resources Department

Form C-102
Revised 1-1-8

OIL CONSERVATION DIVISION RECEIVED

DISTRICT I
P.O. Box 1980, Hobbs, NM 88240

P.O. Box 2088
Santa Fe, New Mexico 87504-2088

DEC 12 2013

DISTRICT II
P.O. Drawer DD, Artesia, NM 88210

DISTRICT III
1000 Rio Brazos Ed., Artec, NM 87410

WELL LOCATION AND ACREAGE DEDICATION PLAT

All Distances must be from the outer boundaries of the section

HOBBS OGD

Operator DEVON ENERGY PRODUCTION COMPANY, L.P.			Lease KACHINA "5" FEDERAL		Well No. 3
Unit Letter K	Section 5	Township 18 SOUTH	Range 33 EAST	NMPM	County LEA
Actual Footage Location of Well:					
1980 feet from the SOUTH line and		1980 feet from the WEST line			
Ground Level Elev. 3972.0	Producing Formation BONE SPRING	Pool 13155, CORBIN		Dedicated Acreage: 40 Acres	

- Outline the acreage dedicated to the subject well by colored pencil or hachure marks on the plat below.
- If more than one lease is dedicated to the well, outline each and identify the ownership thereof (both as to working interest and royalty).
- If more than one lease of different ownership is dedicated to the well, have the interest of all owners been consolidated by communization, unitization, force-pooling, etc.?
☐ Yes ☐ No If answer is "yes" type of consolidation _____

If answer is "no" list of owners and tract descriptions which have actually been consolidated. (Use reverse side of this form necessary.)

No allowable will be assigned to the well unit all interests have been consolidated (by communization, unitization, forced-pooling, otherwise) or until a non-standard unit, eliminating such interest, has been approved by the Division.

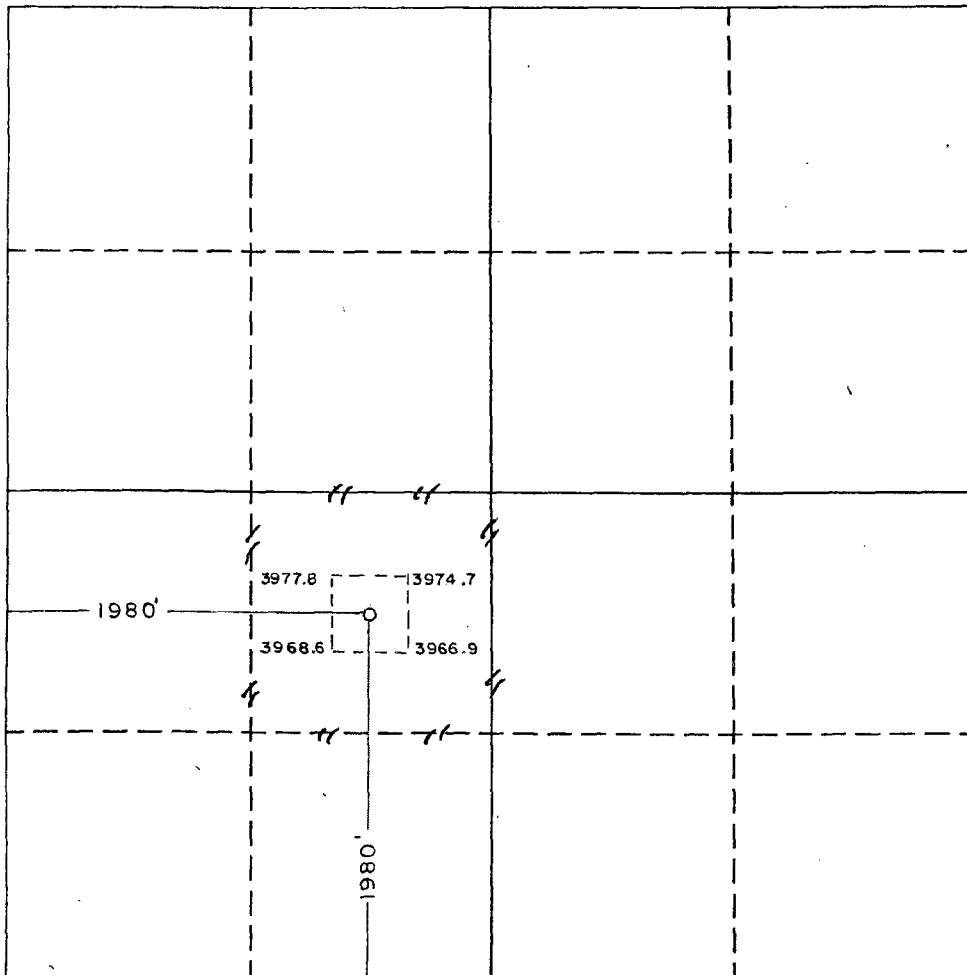

OPERATOR CERTIFICATION

I hereby certify the the information contained herein is true and complete to the best of my knowledge and belief.

Signature

Printed Name

David H. Cook

Position

Regulatory Specialist

Company

Devon Energy Production Co., L.P.

Date

12/12/13

SURVEYOR CERTIFICATION

I hereby certify that the well location shown on this plat was plotted from field notes of actual surveys made by me or under my supervision, and that the same is true and correct to the best of my knowledge and belief.

Date Surveyed

DEC. 30, 1991

Signature & Seal of
Professional Surveyor

REGISTERED LAND SURVEYOR
Certificate No. JOHN W. WEST, 676
RONALD J. EIDSON, 3239
MARY L. JONES, 7877

W.O. 917100554985

DEC 16 2013