

UNITED STATES  
DEPARTMENT OF THE INTERIOR  
BUREAU OF LAND MANAGEMENT

OCD Hobbs

FORM APPROVED  
OMB NO. 1004-0135  
Expires: July 31, 2010**SUNDRY NOTICES AND REPORTS ON WELLS**  
*Do not use this form for proposals to drill or to re-enter an abandoned well. Use form 3160-3 (APD) for such proposals.***SUBMIT IN TRIPLICATE - Other instructions on reverse side.**

## 1. Type of Well

☒ Oil Well ☐ Gas Well ☐ Other

## 2. Name of Operator

CIMAREX ENERGY COMPANY

Contact: DEYSI FAVELA

E-Mail: dfavela@cimarex.com

## 3a. Address

600 NORTH MARIENFELD STREET STE 600  
MIDLAND, TX 79701

## 3b. Phone No. (include area code)

Ph: 432-420-1884

HOBBS OCD

## 4. Location of Well (Footage, Sec., T., R., M., or Survey Description)

Sec 4 T26S R32E NENW 330FNL 1650FWL

DEC 23 2013

## 5. Lease Serial No.

NMNM0392082A

## 6. If Indian, Allottee or Tribe Name

## 7. If Unit or CA/Agreement, Name and/or No.

## 8. Well Name and No.

HALLERTAU 4 FEDERAL 2H

## 9. API Well No.

30-025-41119

## 10. Field and Pool, or Exploratory

JENNINGS BS; UPPER SHALE

## 11. County or Parish, and State

LEA COUNTY, NM

## 12. CHECK APPROPRIATE BOX(ES) TO INDICATE NATURE OF NOTICE, REPORT, OR OTHER DATA

TYPE OF SUBMISSION	TYPE OF ACTION			
<input checked="" type="checkbox"/> Notice of Intent	<input type="checkbox"/> Acidize	<input type="checkbox"/> Deepen	<input type="checkbox"/> Production (Start/Resume)	<input type="checkbox"/> Water Shut-Off
<input type="checkbox"/> Subsequent Report	<input type="checkbox"/> Alter Casing	<input type="checkbox"/> Fracture Treat	<input type="checkbox"/> Reclamation	<input type="checkbox"/> Well Integrity
<input type="checkbox"/> Final Abandonment Notice	<input type="checkbox"/> Casing Repair	<input type="checkbox"/> New Construction	<input type="checkbox"/> Recomplete	<input checked="" type="checkbox"/> Other
	<input type="checkbox"/> Change Plans	<input type="checkbox"/> Plug and Abandon	<input type="checkbox"/> Temporarily Abandon	Change to Original APD
	<input type="checkbox"/> Convert to Injection	<input type="checkbox"/> Plug Back	<input type="checkbox"/> Water Disposal	

13. Describe Proposed or Completed Operation (clearly state all pertinent details, including estimated starting date of any proposed work and approximate duration thereof. If the proposal is to deepen directionally or recompleat horizontally, give subsurface locations and measured and true vertical depths of all pertinent markers and zones. Attach the Bond under which the work will be performed or provide the Bond No. on file with BLM/BIA. Required subsequent reports shall be filed within 30 days following completion of the involved operations. If the operation results in a multiple completion or recompleat in a new interval, a Form 3160-4 shall be filed once testing has been completed. Final Abandonment Notices shall be filed only after all requirements, including reclamation, have been completed, and the operator has determined that the site is ready for final inspection.)

Cimarex Energy respectfully requests BHL changes to the original APD:

Approved:

KOP 8799'

EOC 9249'

MD 13657'

TVD 9085'

BHL 330' FSL &amp; 1980' FWL

Change to:

KOP 8923'

EOC 9673'

## 14. I hereby certify that the foregoing is true and correct.

**Electronic Submission #229058 verified by the BLM Well Information System  
For CIMAREX ENERGY COMPANY, sent to the Hobbs  
Committed to AFMSS for processing by JOHNNY DICKERSON on 12/11/2013 ()**

Name (Printed/Typed) DEYSI FAVELA

Title DRILLING TECHNICIAN

Signature

(Electronic Submission)

Date 12/10/2013

**THIS SPACE FOR FEDERAL OR STATE OFFICE USE APPROVED**

Approved By

Title Petroleum Engineer

Date

Conditions of approval, if any, are attached. Approval of this notice does not warrant or certify that the applicant holds legal or equitable title to those rights in the subject lease which would entitle the applicant to conduct operations thereon.

Office

DEC 20 2013  
/s/ Chris Walls

Title 18 U.S.C. Section 1001 and Title 43 U.S.C. Section 1212, make it a crime for any person knowingly and willfully to make to any department or agency of the United States any false, fictitious or fraudulent statements or representations as to any matter within its jurisdiction.

BUREAU OF LAND MANAGEMENT  
CARLSBAD FIELD OFFICE**\*\* OPERATOR-SUBMITTED \*\* OPERATOR-SUBMITTED \*\* OPERATOR-SUBMITTED \*\***

DEC 30 2013

**Additional data for EC transaction #229058 that would not fit on the form**

**32. Additional remarks, continued**

MD 13893'  
TVD 9400'  
BHL 330' FSL & 2015' FWL  
No Pilot Hole

See Attachments



WELL	Hallertau 4 Federal #2H		FIELD	NM Lea County (NAD 83)		STRUCTURE	Cimarex Hallertau 4 Federal #2	
Magnetic Parameters	Model	BGM 2012	Dip	59.920°	Date	December 09, 2013	Surface Location	NAD83 New Mexico State Plane, Eastern Zone, US Feet
			Mag Dec	7.430°		FS	Lat	N 32 44.431
							Lon	W 103 41 0.049
							Northing	39285.96 NUS
							Easting	74255.05 NUS
							Grid Conv.	0.345°
							Scale Fact	0.9999551
Miscellaneous	Sit. Plan	Hallertau 4 Federal #2H	TVD Ref.	Ground Level (3314ft above MSL)				
		Cimarex Hallertau 4 Federal #2H						

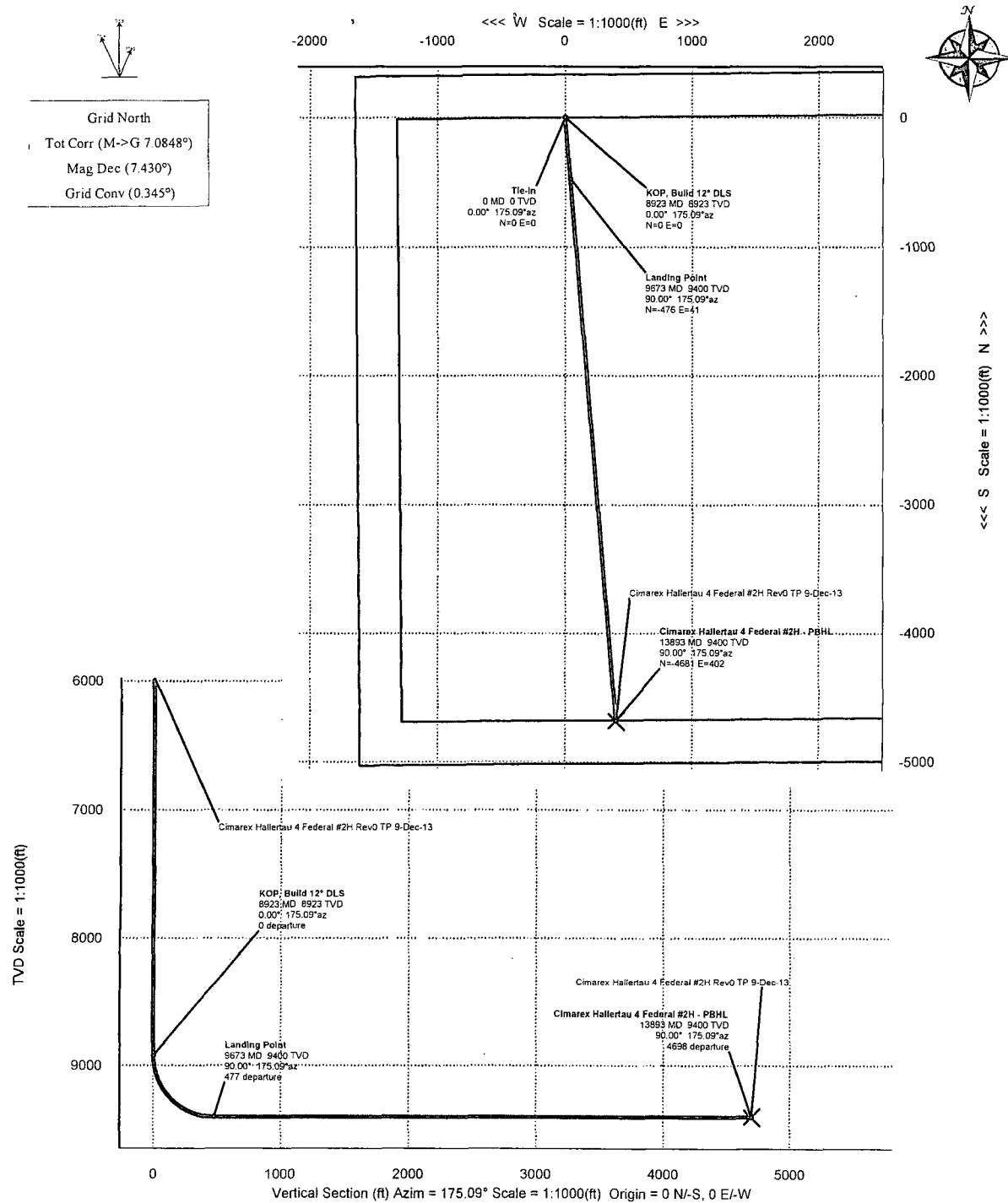

#### Critical Points

Critical Point	MD	INCL	AZIM	TVD	VSEC	N(+) / S(-)	E(+) / W(-)	DLS
Tie-In	0.00	0.00	175.09	0.00	0.00	0.00	0.00	
KOP, Build 12° DLS	8922.50	0.00	175.09	8922.50	0.00	0.00	0.00	0.00
Landing Point	9672.56	90.00	175.09	9400.00	477.50	-475.75	40.84	12.00
Cimarex Hallertau 4 Federal #2H - PBHL	13892.84	90.00	175.09	9400.00	4697.79	-4680.58	401.77	0.00

## Cimarex Hallertau 4 Federal #2H Rev0 TP 9-Dec-13 Proposal Report

(Non-Def Plan)

<b>Report Date:</b>	December 09, 2013 - 03:43 PM	<b>Survey / DLS Computation:</b>	Minimum Curvature / Lubinski
<b>Client:</b>		<b>Vertical Section Azimuth:</b>	175.094 ° (Grid North)
<b>Field:</b>	NM Lea County (NAD 83)	<b>Vertical Section Origin:</b>	0.000 ft, 0.000 ft
<b>Structure / Slot:</b>	Cimarex Hallertau 4 Federal #2H / Hallertau 4 Federal #2H	<b>TVD Reference Datum:</b>	Ground Level
<b>Well:</b>	Hallertau 4 Federal #2H	<b>TVD Reference Elevation:</b>	3314.000 ft above MSL
<b>Borehole:</b>	Original Borehole	<b>Seabed / Ground Elevation:</b>	3314.000 ft above MSL
<b>UWI / API#:</b>	Unknown / Unknown	<b>Magnetic Declination:</b>	7.430 °
<b>Survey Name:</b>	Cimarex Hallertau 4 Federal #2H Rev0 TP 9-Dec-13	<b>Total Field Strength:</b>	48224.640 nT
<b>Survey Date:</b>	December 09, 2013	<b>Magnetic Dip Angle:</b>	59.920 °
<b>Tort / AHD / DDI / ERD Ratio:</b>	90.000 ° / 4697.790 ft / 5.796 / 0.500	<b>Declination Date:</b>	December 09, 2013
<b>Coordinate Reference System:</b>	NAD83 New Mexico State Plane, Eastern Zone, US Feet	<b>Magnetic Declination Model:</b>	BGGM 2012
<b>Location Lat / Long:</b>	N 32° 4' 43.43119" W 103° 41' 0.04915"	<b>North Reference:</b>	Grid North
<b>Location Grid N/E Y/X:</b>	N 392985.960 ftUS, E 742655.046 ftUS	<b>Grid Convergence Used:</b>	0.3452 °
<b>CRS Grid Convergence Angle:</b>	0.3452 °	<b>Total Corr Mag North-&gt;Grid North:</b>	7.0848 °
<b>Grid Scale Factor:</b>	0.99995551	<b>Local Coord Referenced To:</b>	Structure Reference Point

Comments	MD (ft)	Incl (°)	Azim Grid (°)	TVD (ft)	VSEC (ft)	NS (ft)	EW (ft)	Northing (ftUS)	Easting (ftUS)	Latitude (N/S ° ' ")	Longitude (E/W ° ' ")	Closure (ft)	Closure Azimuth (°)	DLS (°/100ft)
Tie-In	0.00	0.00	175.09	0.00	0.00	0.00	0.00	392985.96	742655.05	N 32 4 43.43	W 103 41 0.05	0.00	0.00	N/A
KOP, Build 12° DLS	8922.50	0.00	175.09	8922.50	0.00	0.00	0.00	392985.96	742655.05	N 32 4 43.43	W 103 41 0.05	0.00	0.00	0.00
Landing Point	9672.56	90.00	175.09	9400.00	477.50	-475.75	40.84	392510.23	742695.88	N 32 4 38.72	W 103 40 59.61	477.50	175.09	12.00
Cimarex Hallertau 4 Federal #2H - PBHL	13892.84	90.00	175.09	9400.00	4697.79	-4680.58	401.77	388305.60	743056.80	N 32 3 57.09	W 103 40 55.71	4697.79	175.09	0.00

**Survey Type:** Non-Def Plan

**Survey Error Model:** ISCWSA Rev 0 \*\*\* 3-D 95.000% Confidence 2.7955 sigma

**Survey Program:**

Description	MD From (ft)	MD To (ft)	EOU Freq (ft)	Hole Size (in)	Casing Diameter (in)	Survey Tool Type	Borehole / Survey
	0.000	13892.845	1/100.000	30.000	30.000	SLB_MWD-STD	Original Borehole / Cimarex Hallertau 4 Federal #2H Rev0 TP

DISTRICT I  
1025 N. French Dr., Hobbs, NM 88240

DISTRICT II  
1301 W. Grand Avenue, Artesia, NM 88210

DISTRICT III  
1000 Rio Brazos Rd., Aztec, NM 87410

DISTRICT IV  
1220 S. St. Francis Dr., Santa Fe, NM 87505

State of New Mexico  
Energy, Minerals and Natural Resources Department

OIL CONSERVATION DIVISION  
1220 South St. Francis Dr.  
Santa Fe, New Mexico 87505

Form C-102  
Revised July 10, 2010

Submit one copy to appropriate  
District Office

WELL LOCATION AND ACREAGE DEDICATION PLAT

☐ AMENDED REPORT

API Number 30-025-41119	Pool Code	Pool Name Jennings Bone Spring; Upper Shale
Property Code	Property Name HALLERTAU "4" FEDERAL	Well Number 2H
OGRID No. 162683	Operator Name CIMAREX ENERGY CO. OF COLORADO	Elevation 3314'

Surface Location

UL or lot No. C	Section 4	Township 26 S	Range 32 E	Lot Idn	Feet from the 330	North/South line NORTH	Feet from the 1650	East/West line WEST	County LEA
--------------------	--------------	------------------	---------------	---------	----------------------	---------------------------	-----------------------	------------------------	---------------

Bottom Hole Location If Different From Surface

UL or lot No. N	Section 4	Township 26 S	Range 32 E	Lot Idn	Feet from the 330	North/South line SOUTH	Feet from the 2015	East/West line WEST	County LEA
--------------------	--------------	------------------	---------------	---------	----------------------	---------------------------	-----------------------	------------------------	---------------

Dedicated Acres 160	Joint or Infill	Consolidation Code	Order No.
------------------------	-----------------	--------------------	-----------

NO ALLOWABLE WILL BE ASSIGNED TO THIS COMPLETION UNTIL ALL INTERESTS HAVE BEEN CONSOLIDATED  
OR A NON-STANDARD UNIT HAS BEEN APPROVED BY THE DIVISION

<p>3310.2' 3314.4'</p> <p>1650'</p> <p><b>SURFACE LOCATION</b> Lat - N 32°04'43.43" Long - W 103°41'00.05" NMSPCE- N 392085.060 E 742655.046 (NAD-83)</p> <p>3306.2'</p> <p>330</p> <p>2015'</p> <p><b>PROPOSED BOTTOM HOLE LOCATION</b> Lat - N 32°03'57.09" Long - W 103°40'55.71" NMSPCE- N 388305.6 E 743056.8 (NAD-83)</p> <p>330</p> <p>NMNM0392082A</p>	<p><b>OPERATOR CERTIFICATION</b> I hereby certify that the information contained herein is true and complete to the best of my knowledge and belief, and that this organization either owns a working interest or unleased mineral interest in the land including the proposed bottom hole location or has a right to drill this well at this location pursuant to a contract with an owner of such a mineral or working interest, or to a voluntary pooling agreement or a compulsory pooling order heretofore entered by the division.</p> <p><i>Deysi Favela</i> 12/10/2013 Signature Date</p> <p>Deysi Favela Printed Name dfavela@cimarex.com Email Address</p> <p><b>SURVEYOR CERTIFICATION</b> I hereby certify that the well location shown on this plat was plotted from field notes of actual surveys made by me or under my supervision and that the same is true and correct to the best of my belief.</p> <p>Date Surveyed Signature and Seal of Professional Surveyor</p> <p>Certificate No. Gary L. Jones 7977</p> <p>BASIN SURVEYS 24491</p>
--	--