

UNITED STATES
DEPARTMENT OF THE INTERIOR
BUREAU OF LAND MANAGEMENT
OCD HobbsFORM APPROVED
OMB NO. 1004-0135
Expires: July 31, 2010**SUNDRY NOTICES AND REPORTS ON WELLS**
*Do not use this form for proposals to drill or to re-enter an abandoned well. Use form 3160-3 (APD) for such proposals.*5. Lease Serial No.
NMNM0392082A

6. If Indian, Allottee or Tribe Name

SUBMIT IN TRIPLICATE - Other instructions on reverse side.

7. If Unit or CA/Agreement, Name and/or No.

1. Type of Well

☒ Oil Well ☐ Gas Well ☐ Other8. Well Name and No.
HALLERTAU 4 FEDERAL 6H

2. Name of Operator

Contact: PAULA BRUNSON
CIMAREX ENERGY COMPANY OF CO-Mail: pbrunson@cimarex.com

9. API Well No.

30-025-41628-00-X1

3a. Address

600 NORTH MARIENFELD STREET, SUITE 600
MIDLAND, TX 797013b. Phone No. (include area code)
Ph: 432-571-784810. Field and Pool, or Exploratory
JENNINGS

4. Location of Well (Footage, Sec., T., R., M., or Survey Description)

Sec 4 T26S R32E NENW 330FNL 2260FWL

11. County or Parish, and State

LEA COUNTY, NM

12. CHECK APPROPRIATE BOX(ES) TO INDICATE NATURE OF NOTICE, REPORT, OR OTHER DATA

TYPE OF SUBMISSION	TYPE OF ACTION			
<input checked="" type="checkbox"/> Notice of Intent	<input type="checkbox"/> Acidize	<input type="checkbox"/> Deepen	<input type="checkbox"/> Production (Start/Resume)	<input type="checkbox"/> Water Shut-Off
<input type="checkbox"/> Subsequent Report	<input type="checkbox"/> Alter Casing	<input type="checkbox"/> Fracture Treat	<input type="checkbox"/> Reclamation	<input type="checkbox"/> Well Integrity
<input type="checkbox"/> Final Abandonment Notice	<input type="checkbox"/> Casing Repair	<input type="checkbox"/> New Construction	<input type="checkbox"/> Recomplete	<input checked="" type="checkbox"/> Other
	<input type="checkbox"/> Change Plans	<input type="checkbox"/> Plug and Abandon	<input type="checkbox"/> Temporarily Abandon	Change to Original A
	<input type="checkbox"/> Convert to Injection	<input type="checkbox"/> Plug Back	<input type="checkbox"/> Water Disposal	PD

13. Describe Proposed or Completed Operation (clearly state all pertinent details, including estimated starting date of any proposed work and approximate duration thereof. If the proposal is to deepen directionally or recompleat horizontally, give subsurface locations and measured and true vertical depths of all pertinent markers and zones. Attach the Bond under which the work will be performed or provide the Bond No. on file with BLM/BIA. Required subsequent reports shall be filed within 30 days following completion of the involved operations. If the operation results in a multiple completion or recompleat in a new interval, a Form 3160-4 shall be filed once testing has been completed. Final Abandonment Notices shall be filed only after all requirements, including reclamation, have been completed, and the operator has determined that the site is ready for final inspection.)

Cimarex Energy respectfully requests permission to change the rig layout from the layout approved in the original APD. The current approval is v-door east. Due to a gas pipeline on the east side of the pad, we would like to place the v-door to the south.

A revised Rig Diagram and Interim Reclamation Layout Diagram are attached.

All COA's still Apply

14. I hereby certify that the foregoing is true and correct.

Electronic Submission #249827 verified by the BLM Well Information System
For CIMAREX ENERGY COMPANY OF CO, sent to the Hobbs
Committed to AFMSS for processing by CATHY QUEEN on 06/19/2014 (14CQ0130SE)

Name(Printed/Typed) PAULA BRUNSON

Title REGULATORY ANALYST

Signature (Electronic Submission)

Date 06/16/2014

THIS SPACE FOR FEDERAL OR STATE OFFICE USEApproved By STEPHEN J. CAFFEY

Title

Date JUL 14 2014

Conditions of approval, if any, are attached. Approval of this notice does not warrant or certify that the applicant holds legal or equitable title to those rights in the subject lease which would entitle the applicant to conduct operations thereon.

Office

Title 18 U.S.C. Section 1001 and Title 43 U.S.C. Section 1212, make it a crime for any person knowingly and willfully to make to any department or agency of the United States any false, fictitious or fraudulent statements or representations as to any matter within its jurisdiction.

**** BLM REVISED ** BLM REVISED ** BLM REVISED ** BLM REVISED *****MSB/OCD 7/17/2014**JUL 17 2014**fm*

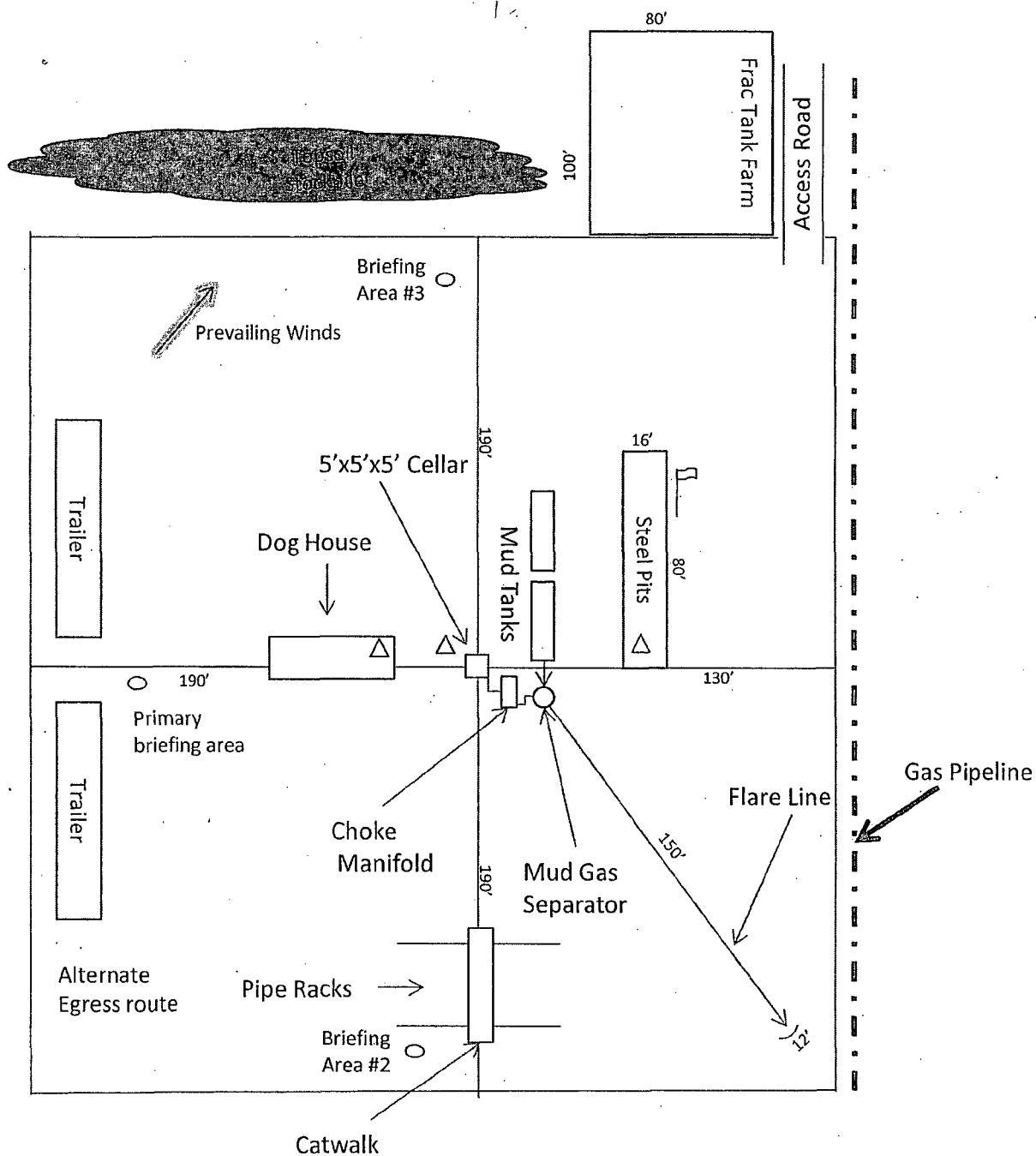

- Wind Direction Indicators**
(wind sock or streamers)
- **H2S Monitors**
(alarms at bell nipple and shale shaker)
- **Briefing Areas**

Exhibit D – Rig Diagram
Hallertau 4 Federal No. 6
 Cimarex Energy Co. of Colorado
 4-26S-32E
 SHL 330 FNL & 2260 FWL
 BHL 330 FSL & 2290 FWL
 Lea County, NM

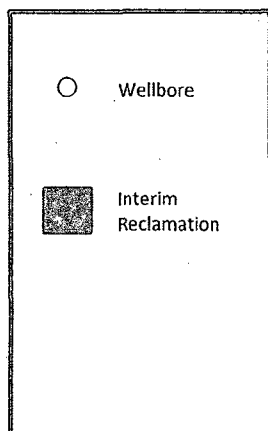
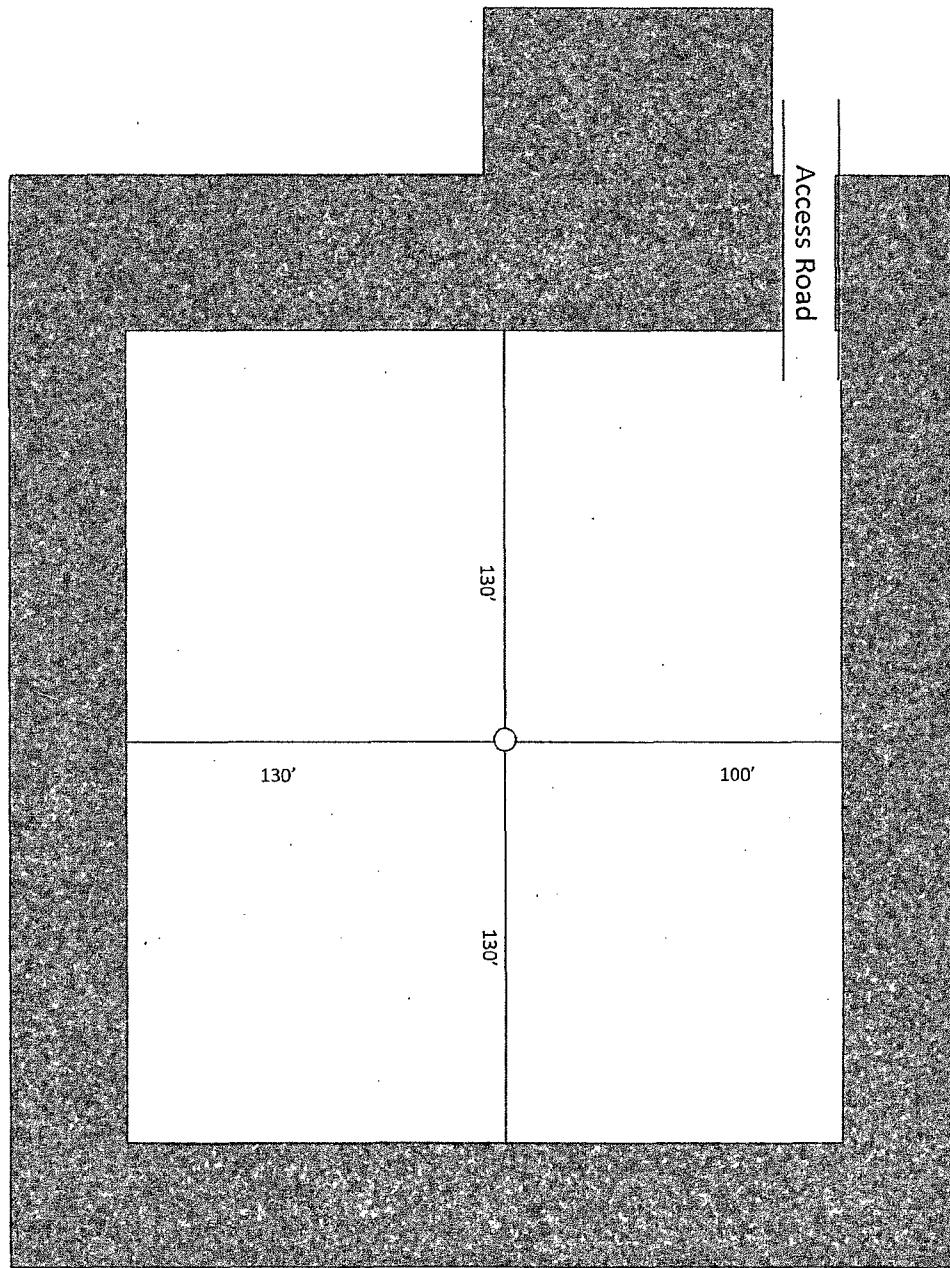

Exhibit D-1
Interim Reclamation Layout Diagram
Hallertau 4 Federal No. 6
Cimarex Energy Co. of Colorado
4-26S-32E
SHL 330 FNL & 2260 FWL
BHL 330 FSL & 2290 FWL
Lea County, NM