

Form 3160- 5
(August, 2007)UNITED STATES
DEPARTMENT OF THE INTERIOR
BUREAU OF LAND MANAGEMENTFORM APPROVED
OMB No. 1004- 0137
Expires: July 31, 2010SUNDRY NOTICES AND REPORTS ON WELLS
*Do not use this form for proposals to drill or to re-enter an abandoned well. Use Form 3160-3 (APD) for such proposals.*5. Lease Serial No.
NMNM104076 112932

6. If Indian, Allottee, or Tribe Name

7. If Unit or CA. Agreement Name and/or No.

8. Well Name and No.

Warhawk 3 Federal Com #1H ✓

9. API Well No.

30-025-40635 ✓

10. Field and Pool, or Exploratory Area

Lusk; Bone Spring

11. County or Parish, State

Lea

NM

SUBMIT IN TRIPLICATE - Other Instructions on page 2.

1. Type of Well

☒ Oil Well☐ Gas Well☐ Other

2. Name of Operator

COG Operating, LLC ✓

Contact: Melanie Parker

Email: mparker@concho.com

3a. Address

2208 W. Main Street
Artesia, NM 88210

3b. Phone No. (include area code)

575-748-6940

4. Location of Well (Footage, Sec., T., R., M., or Survey Description)

Sec 3 T19S R32E 780' FNL & 170' FWL ✓

Lat.

Long.

12. CHECK APPROPRIATE BOX(S) TO INDICATE NATURE OF NOTICE, REPORT, OR OTHER DATA

TYPE OF SUBMISSION

TYPE OF ACTION

☐ Notice of Intent☐ Acidize☐ Deepen☐ Production (Start/ Resume)☐ Water Shut-off☒ Subsequent Report☐ Altering Casing☐ Fracture Treat☐ Reclamation☐ Well Integrity☐ Casing Repair☐ New Construction☐ Recomplete

X Other Site Facility

☐ Final Abandonment Notice☐ Change Plans☐ Plug and abandon☐ Temporarily Abandon☐ Convert to Injection☐ Plug back☐ Water Disposal

13. Describe Proposed or Completed Operation (clearly state all pertinent details including estimated starting date of any proposed work and approximate duration thereof. If the proposal is to deepen directionally or recomple horizontally, give subsurface locations and measured and true vertical depths or pertinent markers and sands. Attach the Bond under which the work will performed or provide the Bond No. on file with the BLM/ BIA. Required subsequent reports shall be filed within 30 days following completion of the involved operations. If the operation results in a multiple completion or recomple in a new interval, a Form 3160-4 shall be filed once testing has been completed. Final Abandonment Notice shall be filed only after all requirements, including reclamation, have been completed, and the operator has determined that the site is ready for final inspection.)

Please see attached Site Facility diagram

Accepted for Record Purposes.

Approval Subject to Onsite Inspection.

Date: 9/16/14

14. I hereby certify that the foregoing is true and correct.

Name (Printed/ Typed)

Eric Conklin

Title:

Regulatory Technician

Signature: Eric Conklin

Date:

2/4/14

THIS SPACE FOR FEDERAL OR STATE OFFICE USE

Approved by:

Conditions of approval, if any are attached. Approval of this notice does not warrant or certify that the applicant holds legal or equitable title to those rights in the subject lease which would entitle the applicant to conduct operations thereon.

Title:

Office:

Date:

Title 18 U.S.C. Section 1001 AND Title 43 U.S.C. Section 1212, make it a crime for any person knowingly and willfully to make any department or agency of the United States any false, fictitious or fraudulent statements or representations as to any matter within its jurisdiction.

(Instructions on page 2)

SEP 22 2014

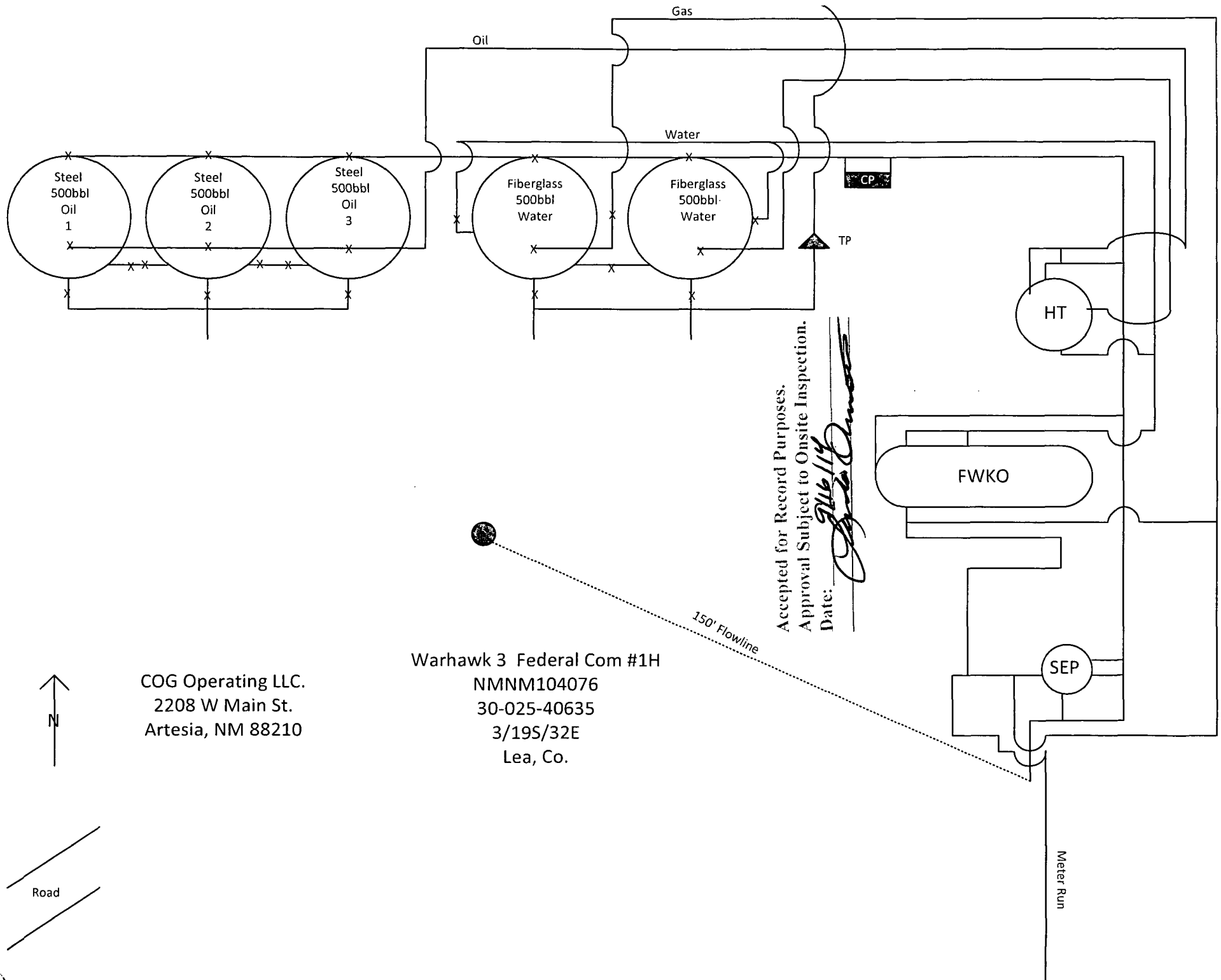

COG Operating LLC.
2208 W Main St.
Artesia, NM 88210

Warhawk 3 Federal Com #1H
NMNM104076
30-025-40635
3/19S/32E
Lea, Co.

COG Operating LLC
Warhawk 3 Federal Com #1H
NMNM-104076
30-025-40635
Sec 3-T19S-R32E
Lea County, NM

1. Production Phase (OT#1)

- A. Valves #1,#2,#4,#5,#7 Open
- B. Valve #3 Closed and Sealed
- C. Valve #6 Closed
- D. Valves on OT #1 Positioned:
 - 1. Valves #1 ,#3 & #4 Closed and sealed

II. Sales Phase (OT#1)

- A. Valves #1,#2 and #4 Closed and Sealed
- B. Valve #3 on OT #1 Open
- C. Valves on OT #2 Positioned:
 - 1. Valve #1 Open
 - 2. Valve #2, #3 and #4 Closed and Sealed

Production Phase (OT #2)

- A. Valves #1,#2,#4,#5,#7 Open
- B. Valve #3 Closed and Sealed
- C. Valve #6 Closed
- D. Valves on OT #1 and #3 Positioned:
 - 1. Valves #1,#3 & #4 Closed and Sealed

Sales Phase (OT#2)

- A. Valves #1,#2and #4 Closed and Sealed
- B. Valve #3 on OT #2 Open
- C. Valves on OT #1 Positioned:
 - 1. Valve #1 Open
 - 2. Valve #2, #3 and #4 Closed and Sealed

Production Phase (OT #3)

- A. Valves #1,#2,#4,#5,#6 & #8 Open
- B. Valve #3 Closed and Sealed
- C. Valve #7 Closed
- D. Valves on OT #2 and #1 Positioned:
 - 1. Valves #1,#2, #3 & #4 Closed and Sealed

Sales Phase (OT#3)

- A. Valves #1,#2and #4 Closed and Sealed
- B. Valve #3 on OT #3 Open
- C. Valves on OT #1 and #2 Positioned:
 - 1. Valve #1 and #2 Open
 - 2. Valve #3 and #4 Closed and Sealed