

HOBBS OCD
NOV 02 2014
RECEIVED

H₂S Contingency Plan
James 20 Federal Com 26H
Cimarex Energy Co.
UL: C, Sec. 20, 23S, 32E
Lea Co., NM

30-025-42225

Emergency Procedures

In the event of a release of gas containing H₂S, the first responder(s) must:

- « Isolate the area and prevent entry by other persons into the 100 ppm ROE.
- « Evacuate any public places encompassed by the 100 ppm ROE.
- « Be equipped with H₂S monitors and air packs in order to control the release.
- « Use the "buddy system" to ensure no injuries occur during the response.
- « Take precautions to avoid personal injury during this operation.
- « Contact operator and/or local officials to aid in operation. See list of phone numbers attached.
- « Have received training in the:
 - Detection of H₂S, and
 - Measures for protection against the gas,
 - Equipment used for protection and emergency response.

Ignition of Gas Source

Should control of the well be considered lost and ignition considered, take care to protect against exposure to Sulfur Dioxide (SO₂). Intentional ignition must be coordinated with the NMOCD and local officials. Additionally, the NM State Police may become involved. NM State Police shall be the Incident Command on scene of any major release. Take care to protect downwind whenever there is an ignition of the gas.

Characteristics of H₂S and SO₂

Please see attached International Chemical Safety Cards.

Contacting Authorities

Cimarex Energy Co. of Colorado's personnel must liaise with local and state agencies to ensure a proper response to a major release. Additionally, the OCD must be notified of the release as soon as possible but no later than 4 hours. Agencies will ask for information such as type and volume of release, wind direction, location of release, etc. Be prepared with all information available including directions to site. The following call list of essential and potential responders has been prepared for use during a release. Cimarex Energy Co. of Colorado's response must be in coordination with the State of New Mexico's "Hazardous Materials Emergency Response Plan" (HMER).

H₂S Contingency Plan Emergency Contacts

James 20 Federal Com 26H

Cimarex Energy Co.

UL: C, Sec. 20, 23S, 32E

Lea Co., NM

Company Office

Cimarex Energy Co. of Colorado	800-969-4789
Co. Office and After-Hours Menu	

Key Personnel

Name	Title	Office	Mobile
Larry Seigrist	Drilling Manager	432-620-1934	580-243-8485
Doug McQuitty	Drilling Superintendent	432-620-1933	806-640-2605
Scott Lucas	Drilling Superintendent	432-620-1989	432-894-5572
Conner Cromeens	Construction Foreman		432-270-0313
Roy Shirley	Construction Superintendent		432-634-2136

Artesia

Ambulance	911
State Police	575-746-2703
City Police	575-746-2703
Sheriff's Office	575-746-9888
Fire Department	575-746-2701
Local Emergency Planning Committee	575-746-2122
New Mexico Oil Conservation Division	575-748-1283

Carlsbad

Ambulance	911
State Police	575-885-3137
City Police	575-885-2111
Sheriff's Office	575-887-7551
Fire Department	575-887-3798
Local Emergency Planning Committee	575-887-6544
US Bureau of Land Management	575-887-6544

Santa Fe

New Mexico Emergency Response Commission (Santa Fe)	505-476-9600
New Mexico Emergency Response Commission (Santa Fe) 24 Hrs	505-827-9126
New Mexico State Emergency Operations Center	505-476-9635

National

National Emergency Response Center (Washington, D.C.)	800-424-8802
---	--------------

Medical

Flight for Life - 4000 24th St.; Lubbock, TX	806-743-9911
Aerocare - R3, Box 49F; Lubbock, TX	806-747-8923
Med Flight Air Amb - 2301 Yale Blvd S.E., #D3; Albuquerque, NM	505-842-4433
SB Air Med Service - 2505 Clark Carr Loop S.E.; Albuquerque, NM	505-842-4949

Other

Boots & Coots IWC	800-256-9688	or	281-931-8884
Cudd Pressure Control	432-699-0139	or	432-563-3356
Halliburton	575-746-2757		
B.J. Services	575-746-3569		

The site plan illustrates the layout of the James 20 Federal Com #34 Well Pad. Key features include:

- Access Road:** Located on the left side of the plan.
- Equipment and Structures:**
 - Compressor:** A large rectangular structure with two smaller rectangular components labeled "Sep".
 - Dehy:** A small rectangular structure located below the compressor.
 - Flare:** A small rectangular structure located near the top center.
 - Well Pad:** A large rectangular area on the right side, divided into sections with dimensions 90' and 120'.
- Dimensions:**
 - Overall width: 100'.
 - Overall height: 100'.
 - Well Pad width: 90'.
 - Well Pad height: 120'.
 - Compressor width: 55'.
 - Compressor height: 65'.
 - Dehy width: 55'.
 - Dehy height: 50'.
 - Flare width: 55'.
 - Flare height: 50'.
 - Well Pad sections: 90' and 120'.
- Labels:**
 - James 20 Fed Com #26
 - James 20 Federal Com #34
 - James 20 Fed Com #34 Well Pad

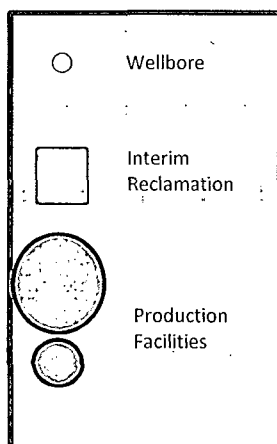

N

Exhibit D-1
Interim Reclamation & Production Facilities Diagram

James 20 Federal:Com 26H

Cimarex Energy Company

20-23S-32E

SHL 330 FNL & 1980 FWL

BHL 330 FSL & 1980 FWL

Lea County, NM

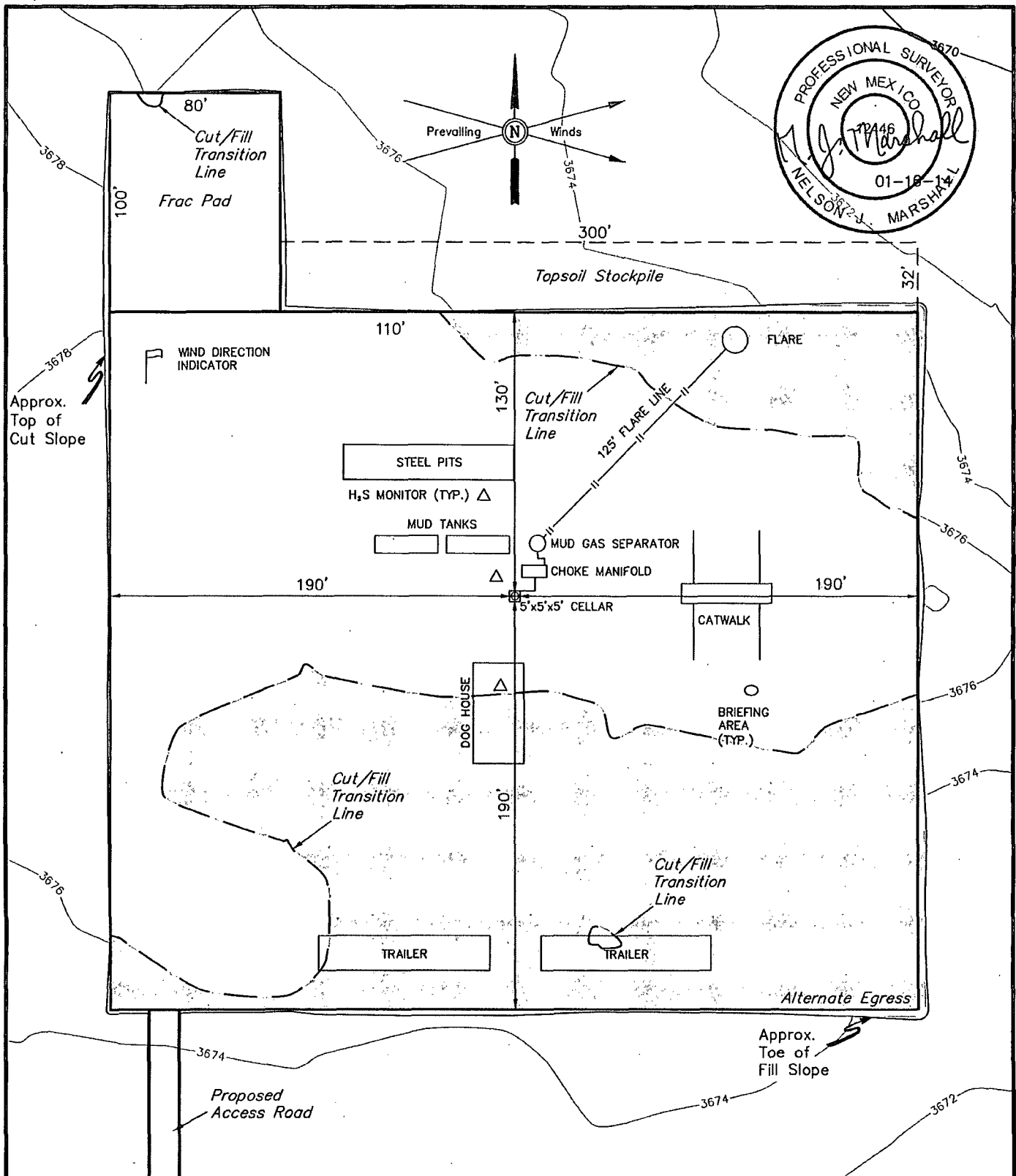

NOTES:

- * Flare pit is to be located a min. of 160' from the well head.



CIMAREX ENERGY CO.

JAMES 20 FEDERAL COM 26H
SECTION 20, T23S, R32E, N.M.P.M.
330' FNL 1980' FWL

DRAWN BY: J.S.	SCALE: 1" = 60'	REV: 01-16-14 B.D.H.
DATE: 09-13-13	REV: 11-27-13 B.D.H.	

TYPICAL RIG LAYOUT

EXHIBIT D



Corporate Office * 85 South 200 East
Vernal, UT 84078 * (435) 789-1017