

Submit 1 Copy To Appropriate District Office
District I - (575) 393-6161
1625 N. French Dr., Hobbs, NM 88240
District II - (575) 748-1283
811 S. First St., Artesia, NM 88210
District III - (505) 334-6178
1000 Rio Brazos Rd., Aztec, NM 87410
District IV - (505) 476-3460
1220 S. St. Francis Dr., Santa Fe, NM 87505

State of New Mexico
Energy, Minerals and Natural Resources

Form C-103
Revised July 18, 2013

OIL CONSERVATION DIVISION
1220 South St. Francis Dr.
Santa Fe, NM 87505

WELL API NO. 30-025-40899
5. Indicate Type of Lease STATE <input type="checkbox"/> FEE <input checked="" type="checkbox"/>
State Oil & Gas Lease No.
7. Lease Name or Unit Agreement Name Pan Head Fee
8. Well Number 2H
9. OGRID Number 229137
10. Pool name or Wildcat Maljamar; Yeso, West 44500
11. Elevation (Show whether DR, RKB, RT, GR, etc.) 4163' GR

SUNDRY NOTICES AND REPORTS ON WELLS
(DO NOT USE THIS FORM FOR PROPOSALS TO DRILL OR TO DEEPEN OR PLUG BACK TO A DIFFERENT RESERVOIR. USE "APPLICATION FOR PERMIT" (FORM C-101) FOR SUCH PROPOSALS.)

1. Type of Well: Oil Well ☒ Gas Well ☐ Other

2. Name of Operator

COG Operating LLC

3. Address of Operator

One Concho Center, 600 W. Illinois Ave., Midland, Tx 79701

4. Well Location

Unit Letter D : 330 feet from the North line and 990 feet from the West line
Section 11 Township 17S Range 32E NMPM County LEA

12. Check Appropriate Box to Indicate Nature of Notice, Report or Other Data

NOTICE OF INTENTION TO:

PERFORM REMEDIAL WORK ☐ PLUG AND ABANDON ☐
TEMPORARILY ABANDON ☐ CHANGE PLANS ☐
PULL OR ALTER CASING ☐ MULTIPLE COMPL ☐
DOWNHOLE COMMINGLE ☐
CLOSED-LOOP SYSTEM ☐
OTHER: Change Well Number ☒

SUBSEQUENT REPORT OF:

REMEDIAL WORK ☐ ALTERING CASING ☐
COMMENCE DRILLING OPNS. ☐ P AND A ☐
CASING/CEMENT JOB ☐
OTHER: ☐

13. Describe proposed or completed operations. (Clearly state all pertinent details, and give pertinent dates, including estimated date of starting any proposed work). SEE RULE 19.15.7.14 NMAC. For Multiple Completions: Attach wellbore diagram of proposed completion or recompletion.

COG Operating LLC respectfully requests to change the well number of this well to be #12H.

Spud Date:

Rig Release Date:

I hereby certify that the information above is true and complete to the best of my knowledge and belief.

SIGNATURE Robyn M. Odom TITLE Regulatory Analyst DATE 11/03/2014

Type or print name Robyn M. Odom E-mail address: Rodom@concho.com PHONE: 432-685-4385

For State Use Only

APPROVED BY: [Signature] TITLE Petroleum Engineer DATE 11/04/14

Conditions of Approval (if any):

NOV 05 2014

DISTRICT I
1625 N. French Dr., Hobbs, NM 88240
Phone: (575) 393-6161 Fax: (575) 393-0720

DISTRICT II
811 S. First St., Artesia, NM 88210
Phone: (575) 748-1283 Fax: (575) 748-9720

DISTRICT III
1000 Rio Brazos Road, Aztec, NM 87410
Phone: (505) 334-6178 Fax: (505) 334-6170

DISTRICT IV
1220 S. St. Francis Dr., Santa Fe, NM 87505
Phone: (505) 476-3460 Fax: (505) 476-3462

State of New Mexico
Energy, Minerals & Natural Resources Department
OIL CONSERVATION DIVISION
1220 South St. Francis Dr.
Santa Fe, New Mexico 87505

Form C-102
Revised August 1, 2011
Submit one copy to appropriate
District Office

AMENDED REPORT

WELL LOCATION AND ACREAGE DEDICATION PLAT

API Number 30-025-40899	Pool Code 44500	Pool Name Maljamar; Yeso, West
Property Code 39256	Property Name PAN HEAD FEE	Well Number 12H
OGRID No. 229137	Operator Name COG OPERATING, LLC	Elevation 4163

Surface Location

UL or lot No. D	Section 11	Township 17-S	Range 32-E	Lot Idn	Feet from the 330	North/South line NORTH	Feet from the 990	East/West line WEST	County LEA
--------------------	---------------	------------------	---------------	---------	----------------------	---------------------------	----------------------	------------------------	---------------

Bottom Hole Location If Different From Surface

UL or lot No. D	Section 14	Township 17-S	Range 32-E	Lot Idn	Feet from the 986	North/South line NORTH	Feet from the 986	East/West line WEST	County LEA
--------------------	---------------	------------------	---------------	---------	----------------------	---------------------------	----------------------	------------------------	---------------

Dedicated Acres 200	Joint or Infill	Consolidation Code	Order No.
------------------------	-----------------	--------------------	-----------

NO ALLOWABLE WILL BE ASSIGNED TO THIS COMPLETION UNTIL ALL INTERESTS HAVE BEEN CONSOLIDATED OR A NON-STANDARD UNIT HAS BEEN APPROVED BY THE DIVISION

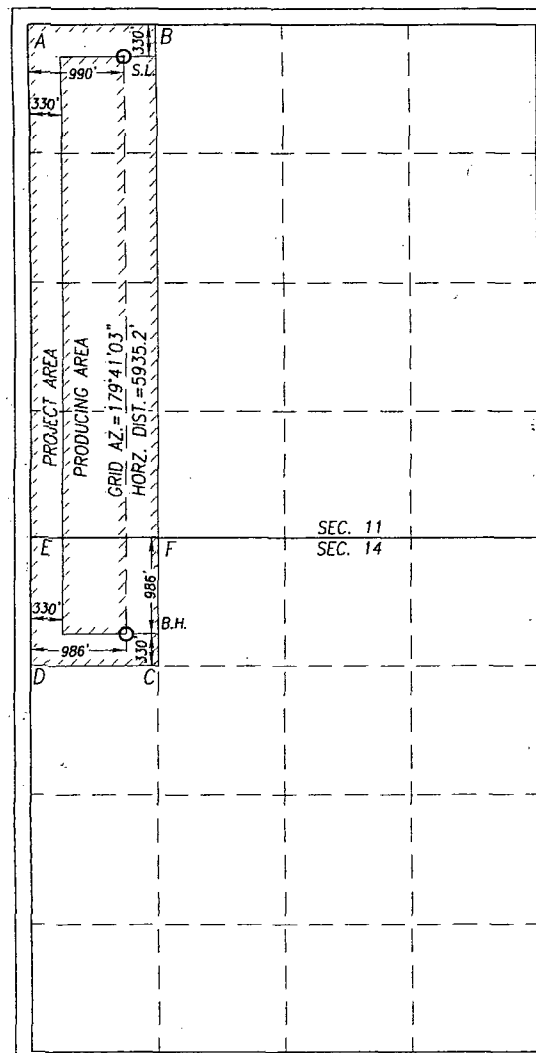

GEODETIC COORDINATES
NAD 27 NME

SURFACE LOCATION
Y=675380.8 N
X=681600.1 E

LAT.=32.855308° N
LONG.=103.741966° W

BOTTOM HOLE LOCATION
Y=669442.9 N
X=681634.5 E

CORNER COORDINATES TABLE

A - Y=675706.5 N, X=680608.2 E
B - Y=675712.2 N, X=681927.0 E
C - Y=669118.6 N, X=681964.8 E
D - Y=669113.8 N, X=680646.8 E
E - Y=670433.3 N, X=680638.6 E
F - Y=670432.4 N, X=681956.0 E

OPERATOR CERTIFICATION

I hereby certify that the information herein is true and complete to the best of my knowledge and belief, and that this organization either owns a working interest or unleased mineral interest in the land including the proposed bottom hole location or has a right to drill this well at this location pursuant to a contract with an owner of such mineral or working interest, or to a voluntary pooling agreement or a compulsory pooling order heretofore entered by the division.

Robyn M. Odom 11/3/14
Signature Date

Robyn M. Odom

Printed Name

Rodom@concho.com

E-mail Address

SURVEYOR CERTIFICATION

I hereby certify that the well location shown on this plat was plotted from field notes of actual surveys made by me or under my supervision, and that the same is true and correct to the best of my belief.

OCTOBER 11, 2012

Date of Survey

Signature & Seal of Professional Surveyor:

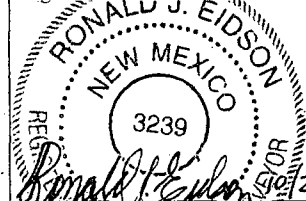

Certificate Number: 3239
Garrett Eidson 12641
Ronald J. Eidson 3239

LSL REDWQW33570517 JWSC W.O.: 14.13.1155