

HOBBS

NOV 10 2014

District I  
1625 N. French Dr., Hobbs, NM 88240  
Phone: (575) 393-6161 Fax: (575) 393-0720

District II  
811 S. First St., Artesia, NM 88210  
Phone: (575) 748-1283 Fax: (575) 748-9780

District III  
1000 Rio Bravo Road, Aztec, NM 87410  
Phone: (505) 334-6178 Fax: (505) 334-6170

District IV  
1220 S. St. Francis Dr., Santa Fe, NM 87505  
Phone: (505) 476-3460 Fax: (505) 476-3462

State of New Mexico

Energy, Minerals &amp; Natural Resources Department

OIL CONSERVATION DIVISION

1220 South St. Francis Dr.

Santa Fe, NM 87505

Form C-102

Revised August 1, 2011

Submit one copy to appropriate

District Office

☐ AMENDED REPORT

## WELL LOCATION AND ACREAGE DEDICATION PLAT

API Number 30-025- 42267	Pool Code 6925	Pool Name Boottles Ridge Delaware, NW
Property Code 39664	Property Name SPEAKEASY FEDERAL UNIT	Well Number 5H
OGRID No. 16696	Operator Name OXY USA INC.	Elevation 3661.8'

## Surface Location

UL or lot no.	Section	Township	Range	Lot Idn	Feet from the	North/South line	Feet from the	East/West line	County
47	1	22 SOUTH	32 EAST, N.M.P.M.		660'	NORTH	330'	WEST	LEA

## Bottom Hole Location If Different From Surface

UL or lot no.	Section	Township	Range	Lot Idn	Feet from the	North/South line	Feet from the	East/West line	County
47	2	22 SOUTH	32 EAST, N.M.P.M.		660'	NORTH	330'	WEST	LEA

Dedicated Acres	Joint or Infill	Consolidation Code	Order No.
160	N		

No allowable will be assigned to this completion until all interests have been consolidated or a non-standard unit has been approved by the division.

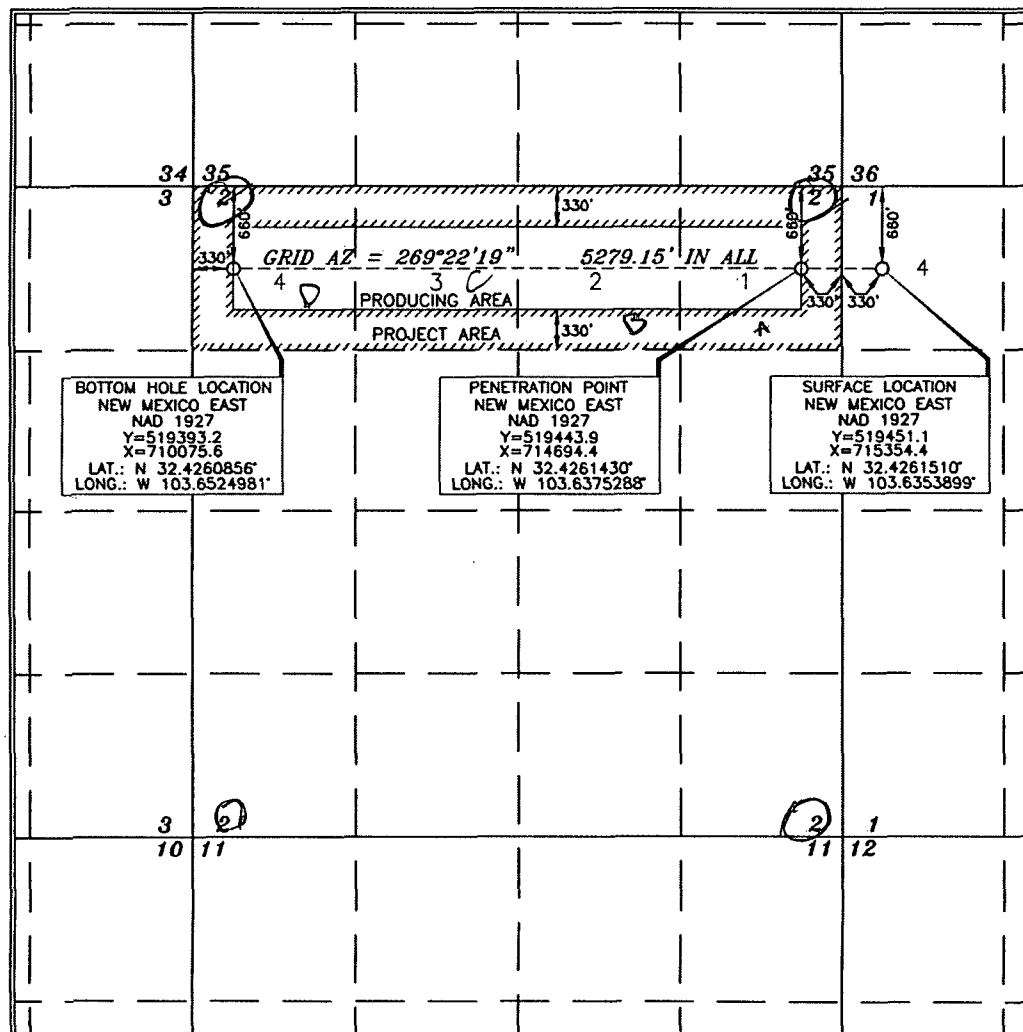

## OPERATOR CERTIFICATION

I hereby certify that the information contained herein is true and complete to the best of my knowledge and belief, and that this organization either owns a working interest or unleased mineral interest in the land including the proposed bottom hole location or has a right to drill this well at this location pursuant to a contract with an owner of such a mineral or working interest, or to a voluntary pooling agreement or a compulsory pooling order heretofore entered by the division.

Signature: *David Stewart* Date: 2/20/14  
Printed Name: David Stewart Sr. Reg. Adv.  
E-mail Address: david\_stewart@oxy.com

## SURVEYOR CERTIFICATION

I hereby certify that the well location shown on this plat was plotted from field notes of actual surveys made by me or under my supervision, and that the same is true and correct to the best of my belief.

Date of Survey: JANUARY 31, 2014

Signature and Seal of Professional Surveyor:

Signature: *Terry J. Paul* Certificate Number: 15079

WO# 130228WL-g (Rev. A) (KA)

NOV 14 2014

LA

Survey Date: 01/31/14	Sheet 1 of 1 Sheets	
W.O. Number: 130228WL-g (Rev. A)	Drawn By: KA	Rev: A
Date: 01/31/14	130228WL-g	Scale: 1"=1000'

# OXY USA INC.

## SPEAKEASY FEDERAL UNIT #5H

### SITE PLAN

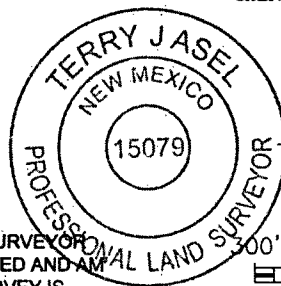
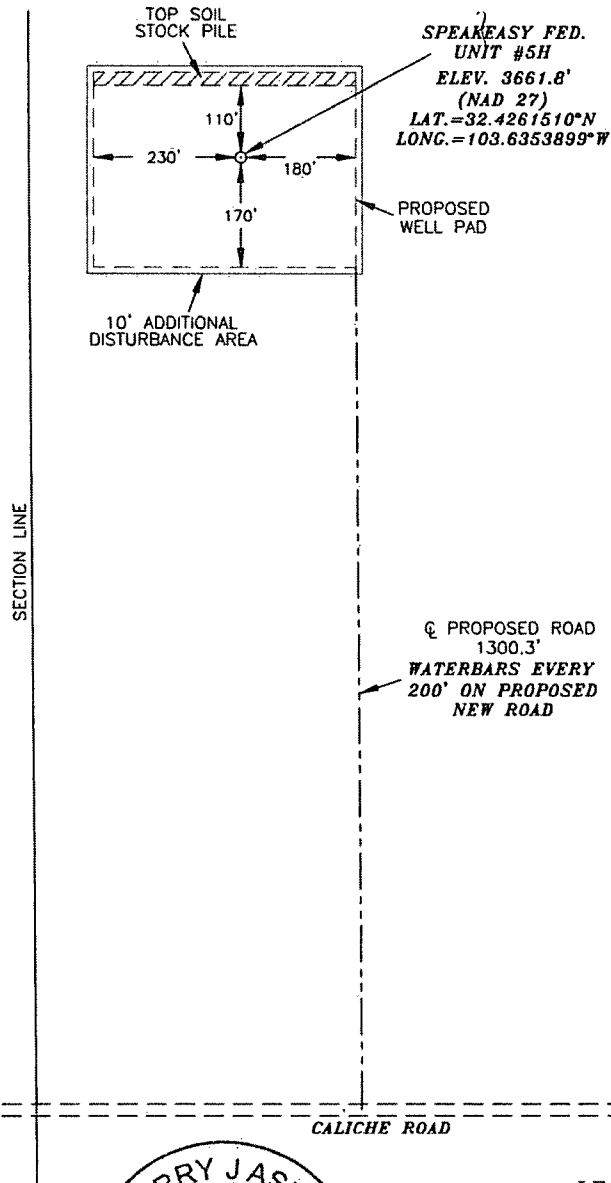

#### LEGEND

- ▨ - DENOTES STOCK PILE AREA
- - DENOTES PROPOSED WELL PAD
- - DENOTES PROPOSED ROAD

#### SURVEYORS CERTIFICATE

I, TERRY J. ASEL, NEW MEXICO PROFESSIONAL SURVEYOR NO. 15079, DO HEREBY CERTIFY THAT I CONDUCTED AND AM RESPONSIBLE FOR THIS SURVEY, THAT THIS SURVEY IS TRUE AND CORRECT TO THE BEST OF MY KNOWLEDGE AND BELIEF, AND MEETS THE "MINIMUM STANDARDS FOR SURVEYING IN NEW MEXICO" AS ADOPTED BY THE NEW MEXICO STATE BOARD OF REGISTRATION FOR PROFESSIONAL ENGINEERS AND SURVEYORS.

*Terry J. Asel* 1/31/2014  
Terry J. Asel, N.M. R.P.L.S. No. 15079

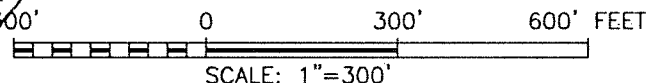

## OXY USA INC.

SPEAKEASY FED. UNIT #5H WELL PAD LOCATED  
AT 660' FNL & 330' FWL IN SECTION 1,  
TOWNSHIP 22 SOUTH, RANGE 32 EAST,  
N.M.P.M., LEA COUNTY, NEW MEXICO

Asel Surveying

P.O. BOX 393 - 310 W. TAYLOR  
HOBBS, NEW MEXICO - 575-393-9146

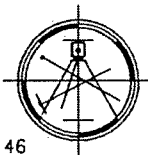

Survey Date: 01/31/14	Sheet 1 of 1 Sheets
W.O. Number: 130228WL-g (Rev. A)	Drawn By: KA Rev: A
Date: 01/31/14	130228WL-g Scale: 1"=300'

LUM

# LOCATION VERIFICATION MAP

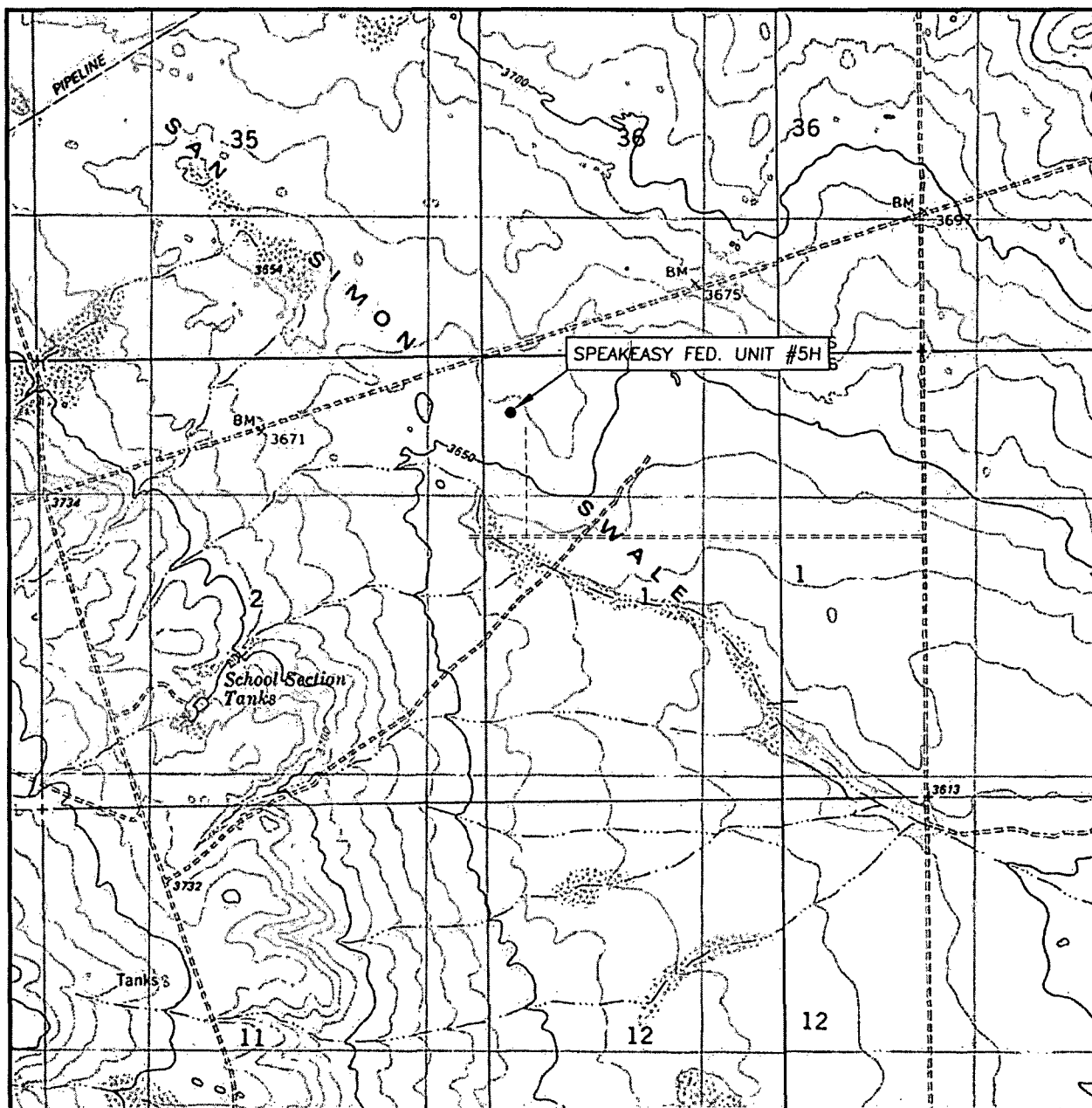

SCALE: 1" = 2000'

CONTOUR INTERVAL: 10'

SEC. 1 TWP. 22-S RGE. 32-E

SURVEY N.M.P.M.

COUNTY LEA

DESCRIPTION 660' FNL & 330' FWL

ELEVATION 3661.8'

OPERATOR OXY USA INC.

LEASE SPEAKEASY FED. UNIT #5H

U.S.G.S. TOPOGRAPHIC MAP  
THE DIVIDE, N.M.

Asel Surveying

P.O. BOX 393 - 310 W. TAYLOR  
HOBBS, NEW MEXICO - 575-393-9146

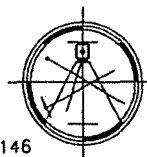

UM

# VICINITY MAP

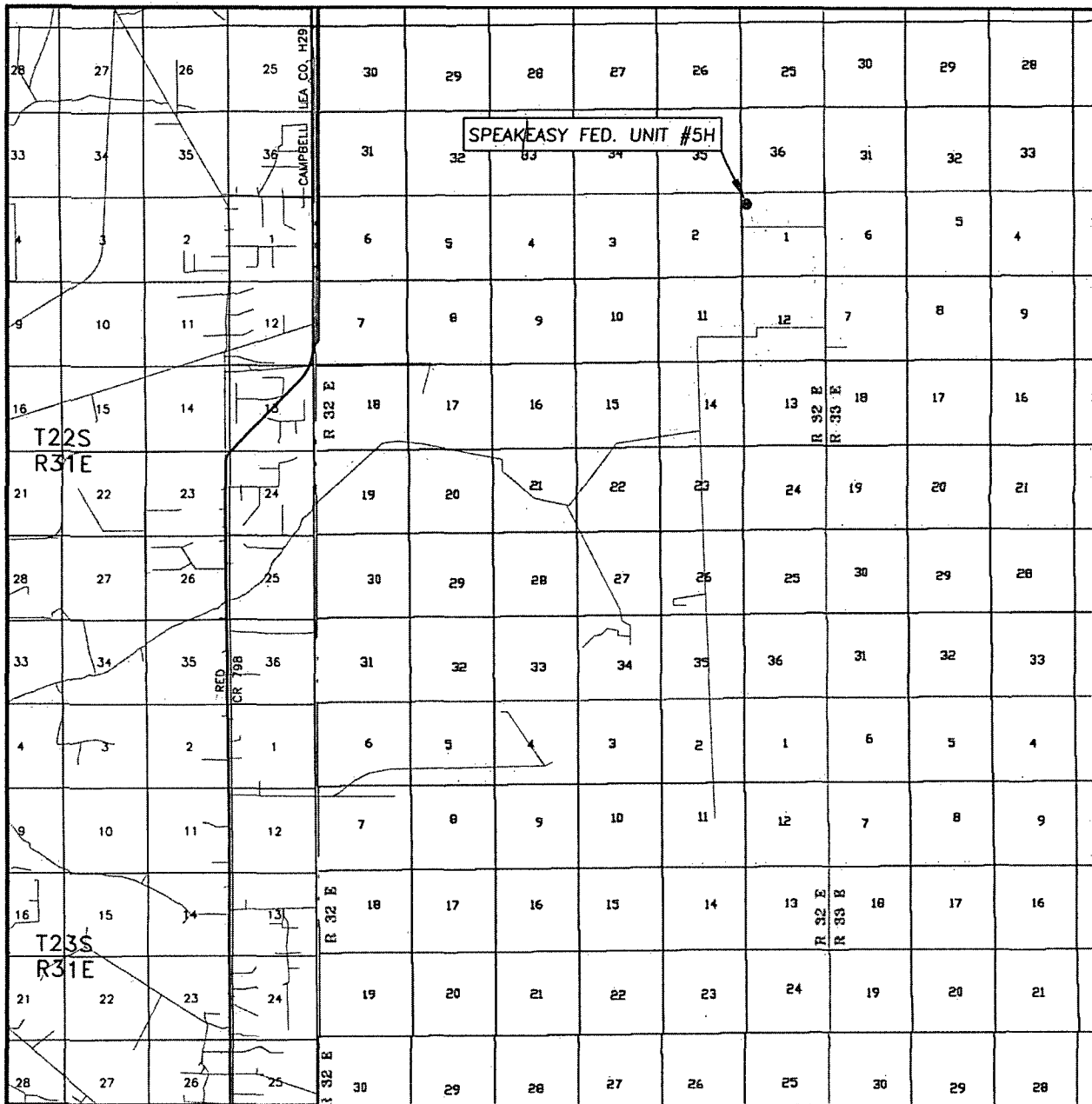

SEC. 1 TWP. 22-S RGE. 32-E  
 SURVEY N.M.P.M.  
 COUNTY LEA  
 DESCRIPTION 660' FNL & 330' FWL  
 ELEVATION 3661.8'  
 OPERATOR OXY USA INC.  
 LEASE SPEAKEASY FED. UNIT #5H

SCALE: 1" = 2 MILES

Asel Surveying

P.O. BOX 393 - 310 W. TAYLOR  
 HOBBS, NEW MEXICO - 575-393-9146

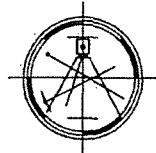

DIRECTIONS BEGINNING AT THE INTERSECTION OF HWY. #128 AND COUNTY ROAD #798 (RED ROAD), GO NORTH ON COUNTY ROAD #798 FOR 7.3 MILES, TURN RIGHT AND GO NORTHEAST ON CALICHE ROAD FOR 2.7 MILES, CONTINUE EAST SOUTHEAST FOR 2.5 MILES, CONTINUE NORTHEAST FOR 2.0 MILES, TURN LEFT AND GO NORTH FOR 1.2 MILES, TURN RIGHT AND GO EAST FOR 0.7 MILES, TURN LEFT AND GO NORTH FOR 0.2 MILES, TURN RIGHT AND GO EAST FOR 0.8 MILES, TURN LEFT AND GO NORTH FOR 0.9 MILES, TURN LEFT AND GO WEST FOR 0.9 MILES, TURN RIGHT ON PROPOSED ROAD AND GO NORTH FOR 1300.3 FEET TO LOCATION.

## Speak Easy Federal Unit #5H - 1Mile AOR

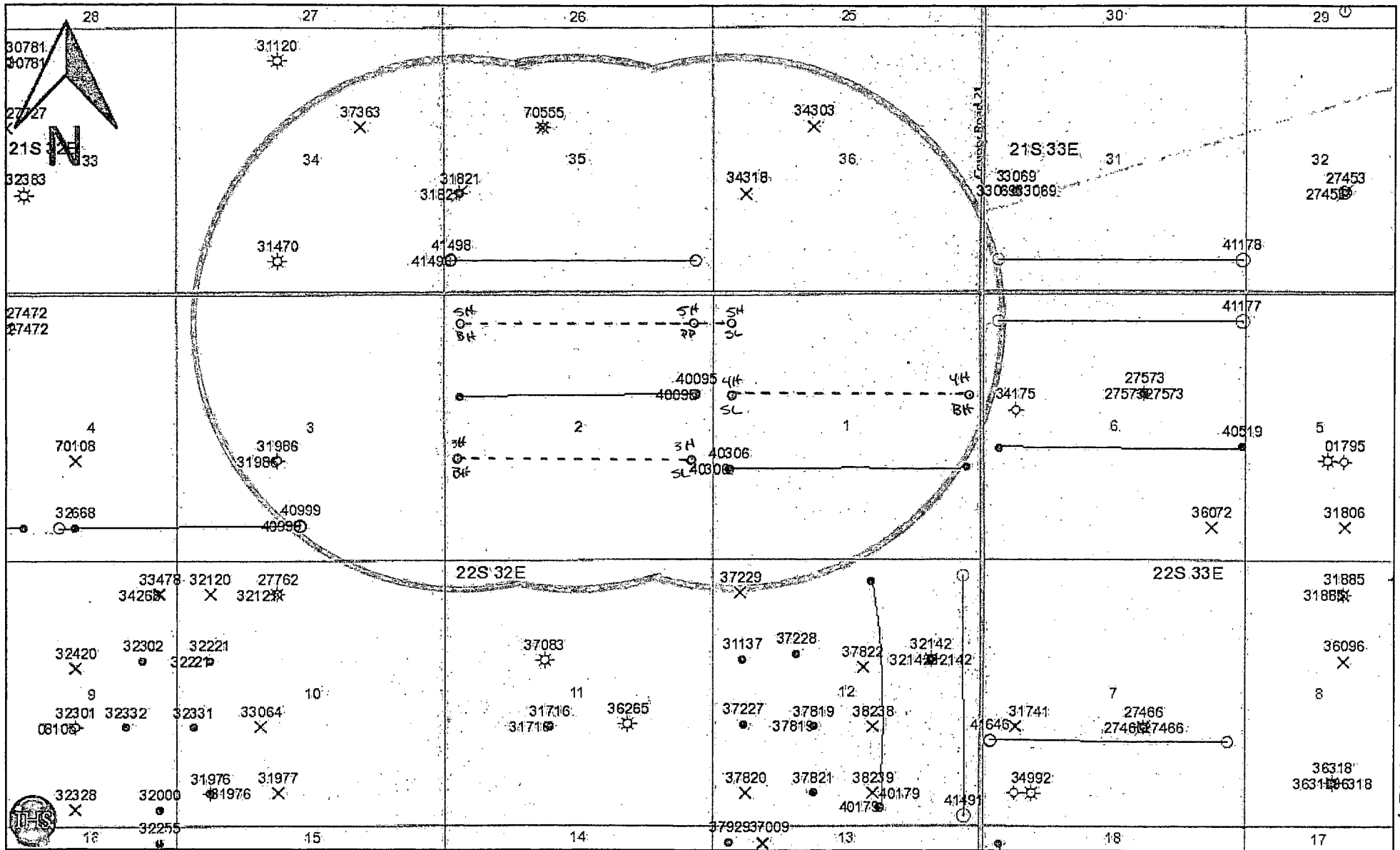

1 mile AOR

## Speak Easy Federal Unit #5H

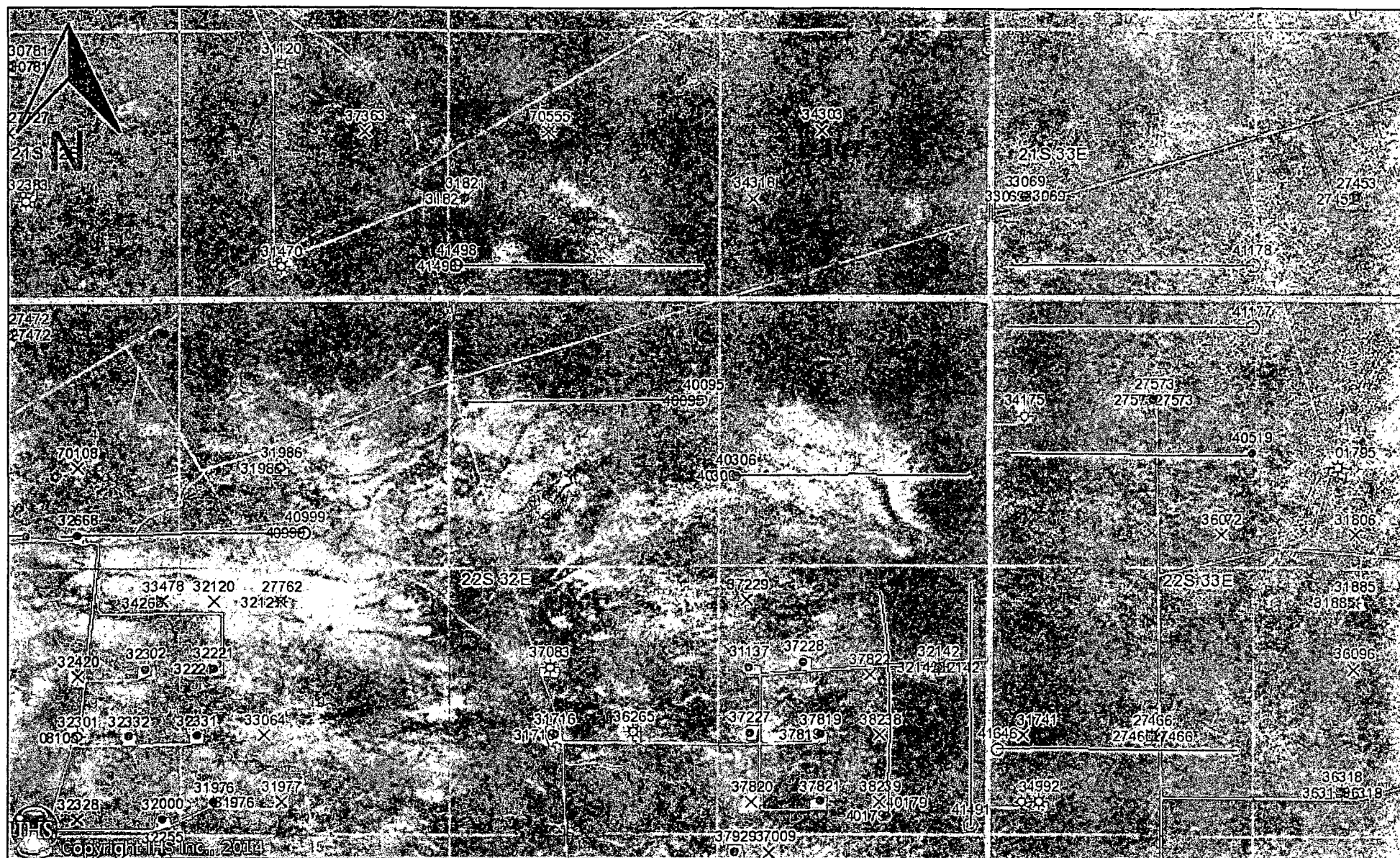

9 sec



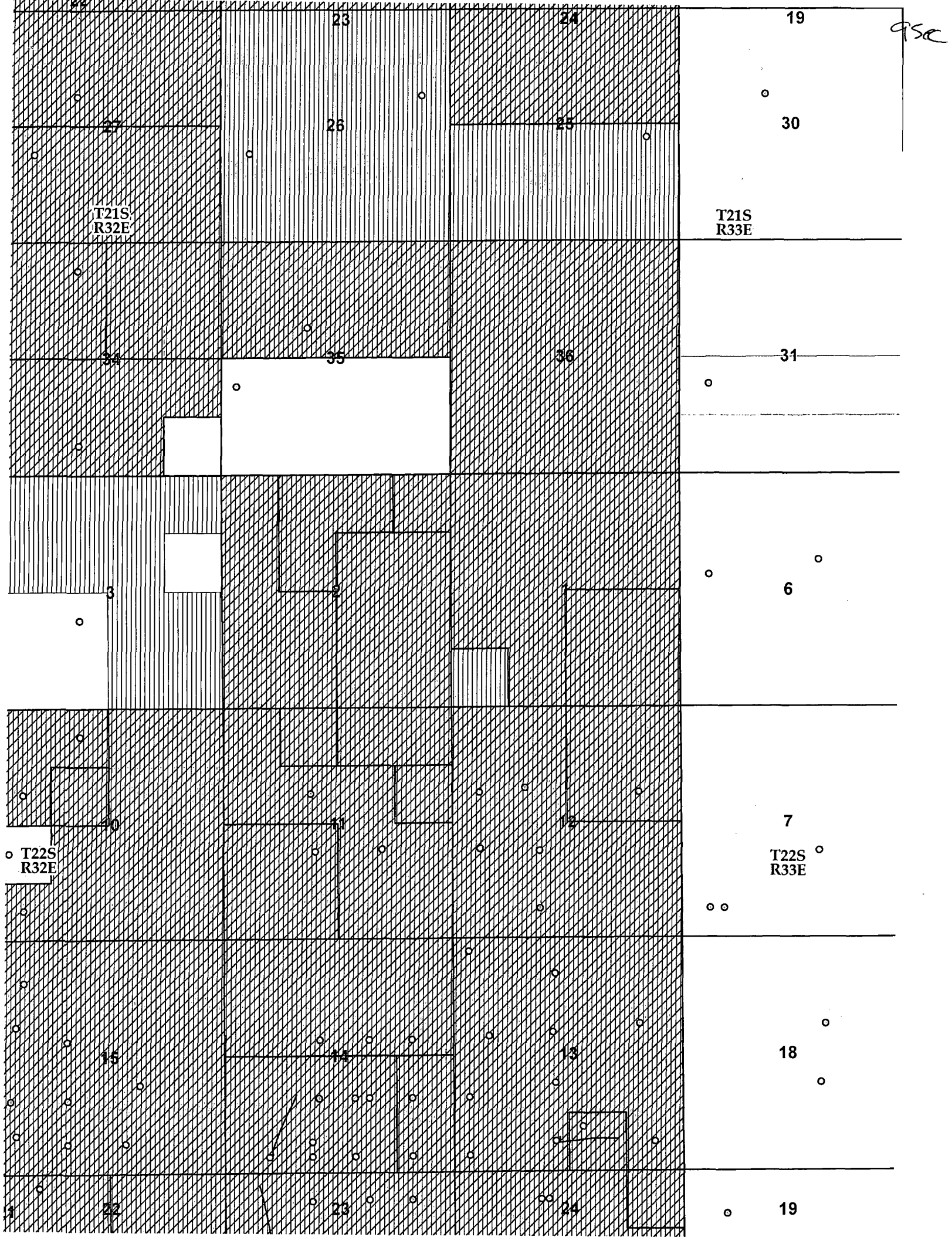



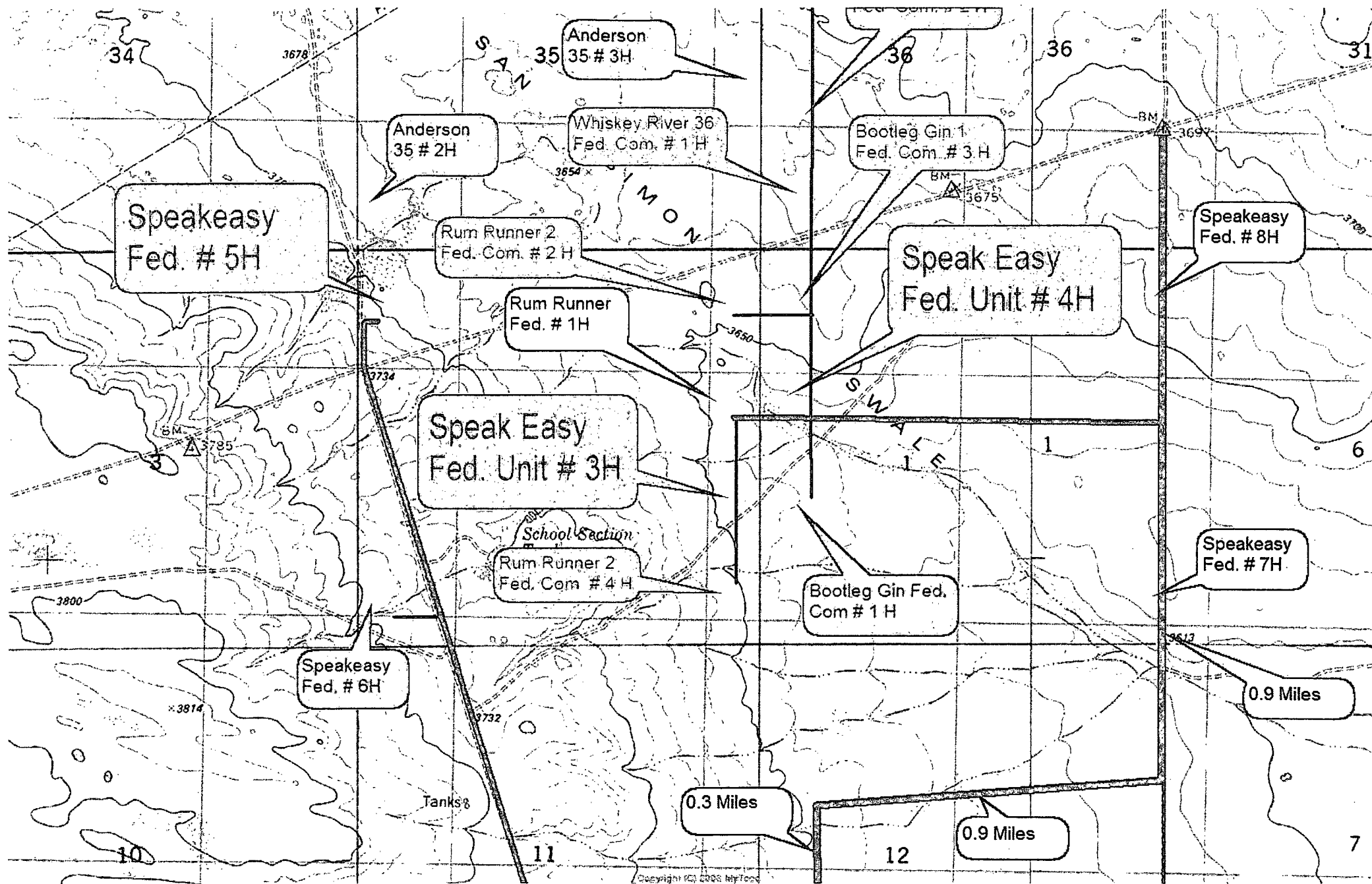

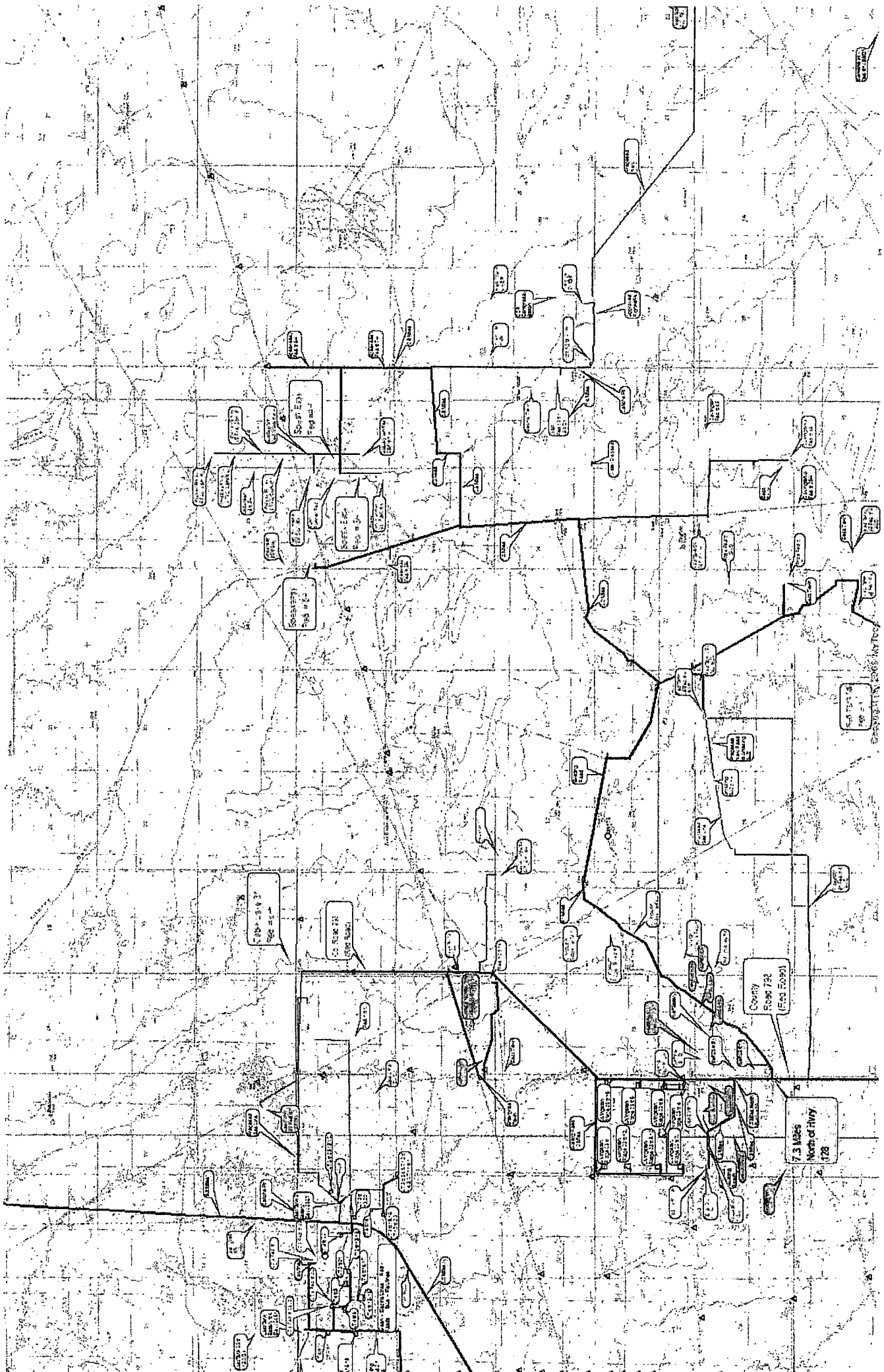



Flow line from Speak Easy Unit # 5 to Speak Easy Unit # 2, Approx 0.5 Miles, 4" ID, Flexpipe, above ground following the roads. Approx 100 psi operating pressure.

Pipeline Route