

DISTRICT I  
1625 N. French Dr., Hobbs, NM 88240  
Phone: (575) 393-6161 Fax: (575) 393-0720

DISTRICT II  
811 S. First St., Artesia, NM 88210  
Phone: (575) 748-1283 Fax: (575) 748-9720

DISTRICT III  
1000 Rio Brazos Road, Aztec, NM 87410  
Phone: (505) 334-6178 Fax: (505) 334-6170

DISTRICT IV  
1220 S. St. Francis Dr., Santa Fe, NM 87505  
Phone: (505) 476-3460 Fax: (505) 476-3462

State of New Mexico  
Energy, Minerals & Natural Resources Department  
OIL CONSERVATION DIVISION  
1220 South St. Francis Dr.  
Santa Fe, New Mexico 87505

HOBBS OGD

DEC 23 2014

RECEIVED

Form C-102  
Revised August 1, 2011  
Submit one copy to appropriate  
District Office

☐ AMENDED REPORT

WELL LOCATION AND ACREAGE DEDICATION PLAT

API Number <b>30-025-41006</b>	Pool Code <b>44500</b>	Pool Name <b>Maljamar Yeso West</b>
Property Code <b>39744</b>	Property Name <b>BRANEX-COG FEDERAL COM</b>	Well Number <b>27H</b>
OGRID No. <b>229137</b>	Operator Name <b>COG OPERATING, LLC</b>	Elevation <b>4059'</b>

Surface Location

UL or lot No.	Section	Township	Range	Lot Idn	Feet from the	North/South line	Feet from the	East/West line	County
M	9	17-S	32-E		1025	SOUTH	330	WEST	LEA

Bottom Hole Location If Different From Surface

UL or lot No.	Section	Township	Range	Lot Idn	Feet from the	North/South line	Feet from the	East/West line	County
P	9	17-S	32-E		990	SOUTH	330	EAST	LEA

Dedicated Acres <b>160</b>	Joint or Infill	Consolidation Code	Order No.
-------------------------------	-----------------	--------------------	-----------

NO ALLOWABLE WILL BE ASSIGNED TO THIS COMPLETION UNTIL ALL INTERESTS HAVE BEEN CONSOLIDATED OR A NON-STANDARD UNIT HAS BEEN APPROVED BY THE DIVISION

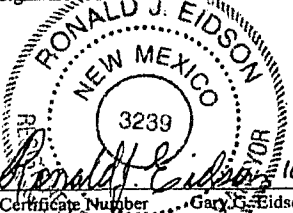
<p><b>CORNER COORDINATES TABLE</b></p> <p>A) Y=671719.2 N, X=670077.3 E</p> <p>B) Y=671735.3 N, X=675358.9 E</p> <p>C) Y=670400.2 N, X=670086.3 E</p> <p>D) Y=670415.4 N, X=675366.5 E</p>	<p><b>GEODETIC COORDINATES</b> NAD 27 NME</p> <p><b>SURFACE LOCATION</b> Y=671425.8 N X=670409.3 E</p> <p>LAT.=32.844604° N LONG.=103.778474° W</p> <p><b>BOTTOM HOLE LOCATION</b> Y=671404.2 N X=675030.9 E</p>	<p><b>OPERATOR CERTIFICATION</b></p> <p>I hereby certify that the information herein is true and complete to the best of my knowledge and belief, and that this organization either owns a working interest or unleased mineral interest in the land including the proposed bottom hole location or has a right to drill this well at this location pursuant to a contract with an owner of such mineral or working interest, or to a voluntary pooling agreement or a compulsory pooling order heretofore entered by the division.</p> <p> Signature</p> <p><b>11-6-14</b> Date</p> <p><b>Kelly J. Holly</b> Printed Name</p> <p><b>kholly@concho.com</b> E-mail Address</p>
<p><b>Estimated Completed Interval:</b> 990 FSL 527 FWL</p>	<p><b>DETAIL</b></p> <p>4059.2' 4065.8'</p> <p>600'</p> <p>4054.4' 4060.9'</p> <p>GRID AZ.=90°16'02" HORIZ. DIST.=4622.8'</p> <p>Producing Area</p> <p>Project Area</p>	<p><b>SURVEYOR CERTIFICATION</b></p> <p>I hereby certify that the well location shown on this plat was plotted from field notes of actual surveys made by me or under my supervision, and that the same is true and correct to the best of my belief.</p> <p><b>JUNE 13, 2012</b></p> <p>Date of Survey</p> <p>Signature &amp; Seal of Professional Surveyor:</p> <p> RONALD J. EIDSON NEW MEXICO 3239</p> <p><b>10/27/2014</b></p> <p>Certificate Number: Gary G. Eidson 12641 Ronald J. Eidson 3239</p> <p>LSL REL. W.O. 12/13/1480 JWSC W.O.: 14.13.1150</p>

DEC 24 2014

Survey Date: 6/13/12		CAD Date: 10/24/14		Drawn By: LSL	
W.O. No.: 14131150		Rev: .		Rel. W.O.: 12131480	
				Sheet 1 of 1	

# VICINITY MAP

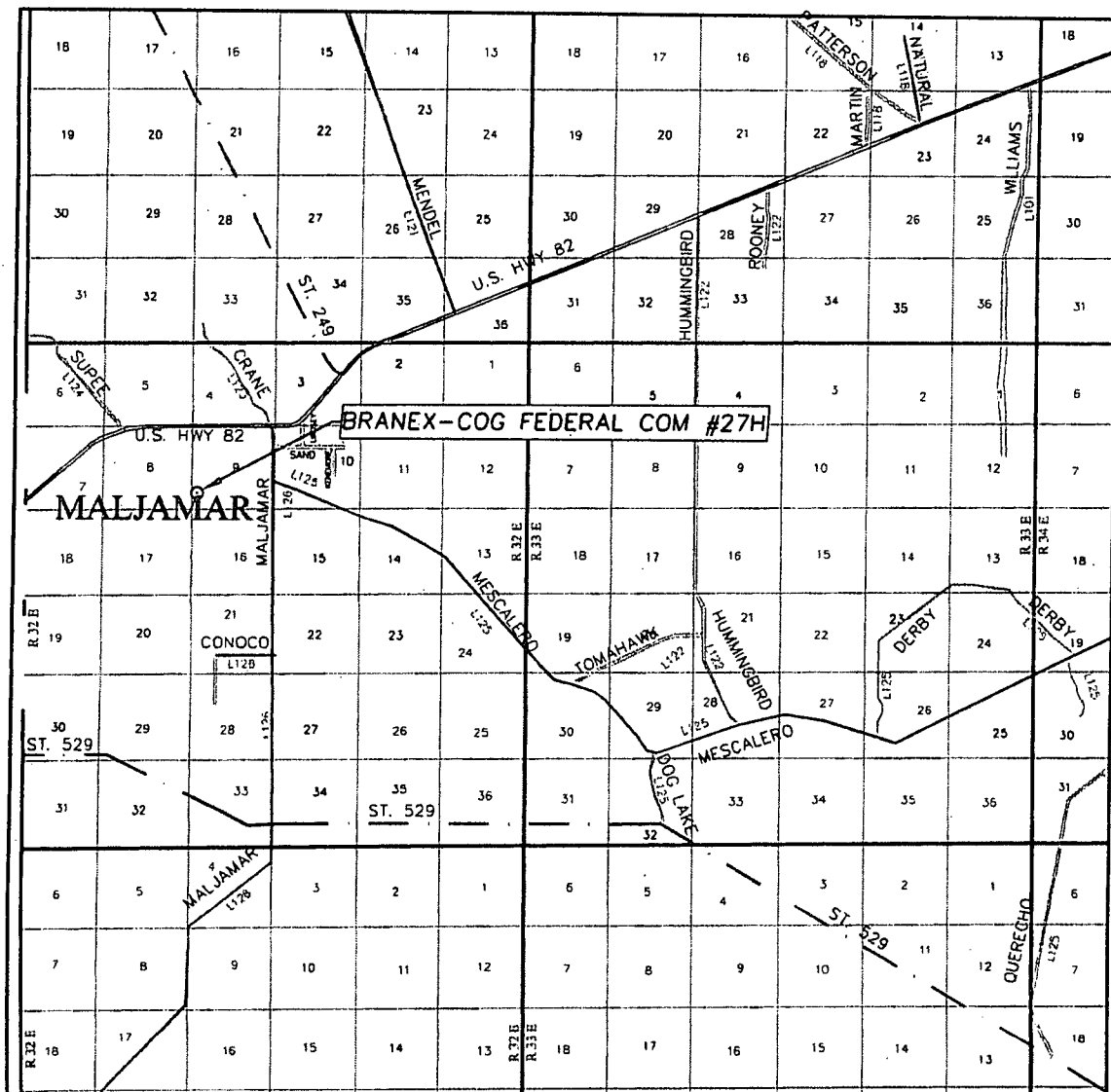

SCALE: 1" = 2 MILES

SEC. 9 TWP. 17-S RGE. 32-E  
 SURVEY N.M.P.M.  
 COUNTY LEA STATE NEW MEXICO  
 DESCRIPTION 1025' FSL & 330' FWL  
 ELEVATION 4059'  
 OPERATOR COG OPERATING, LLC  
 LEASE BRANEX-COG FEDERAL COM

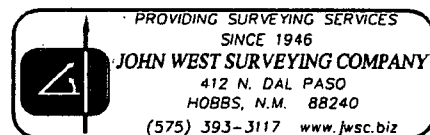

# LOCATION VERIFICATION MAP

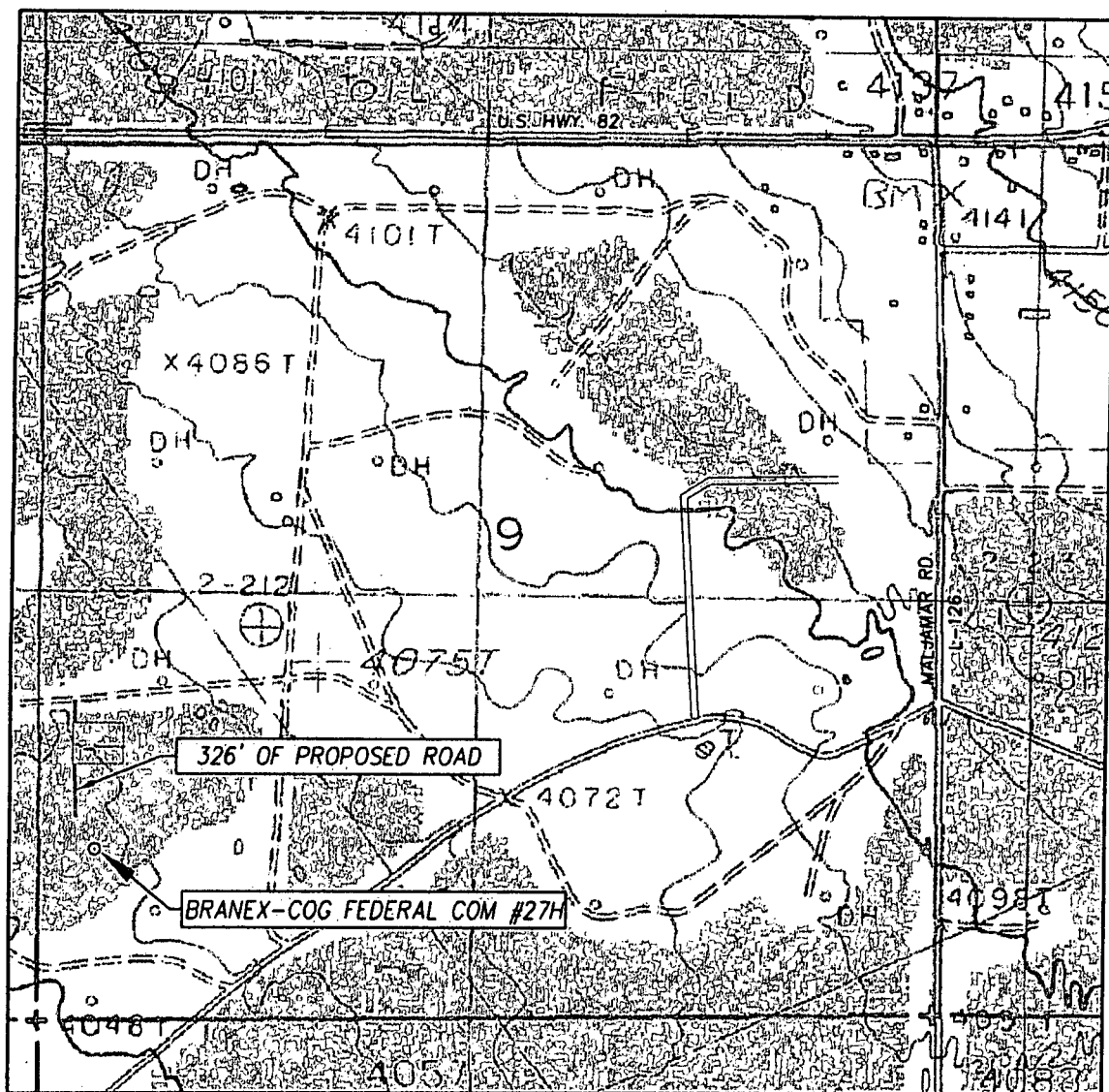

SCALE: 1" = 1000'

CONTOUR INTERVAL:  
MALJAMAR, N.M. - 10'

SEC. 9 TWP. 17-S RGE. 32-E

SURVEY N.M.P.M.

COUNTY LEA STATE NEW MEXICO

DESCRIPTION 1025' FSL & 330' FWL

ELEVATION 4059'

OPERATOR COG OPERATING, LLC

LEASE BRANEX-COG FEDERAL COM

U.S.G.S. TOPOGRAPHIC MAP

MALJAMAR, N.M.

