

SECTION 16, TOWNSHIP 26 SOUTH, RANGE 34 EAST, N.M.P.M.
LEA COUNTY, STATE OF NEW MEXICO
AERIAL PHOTO

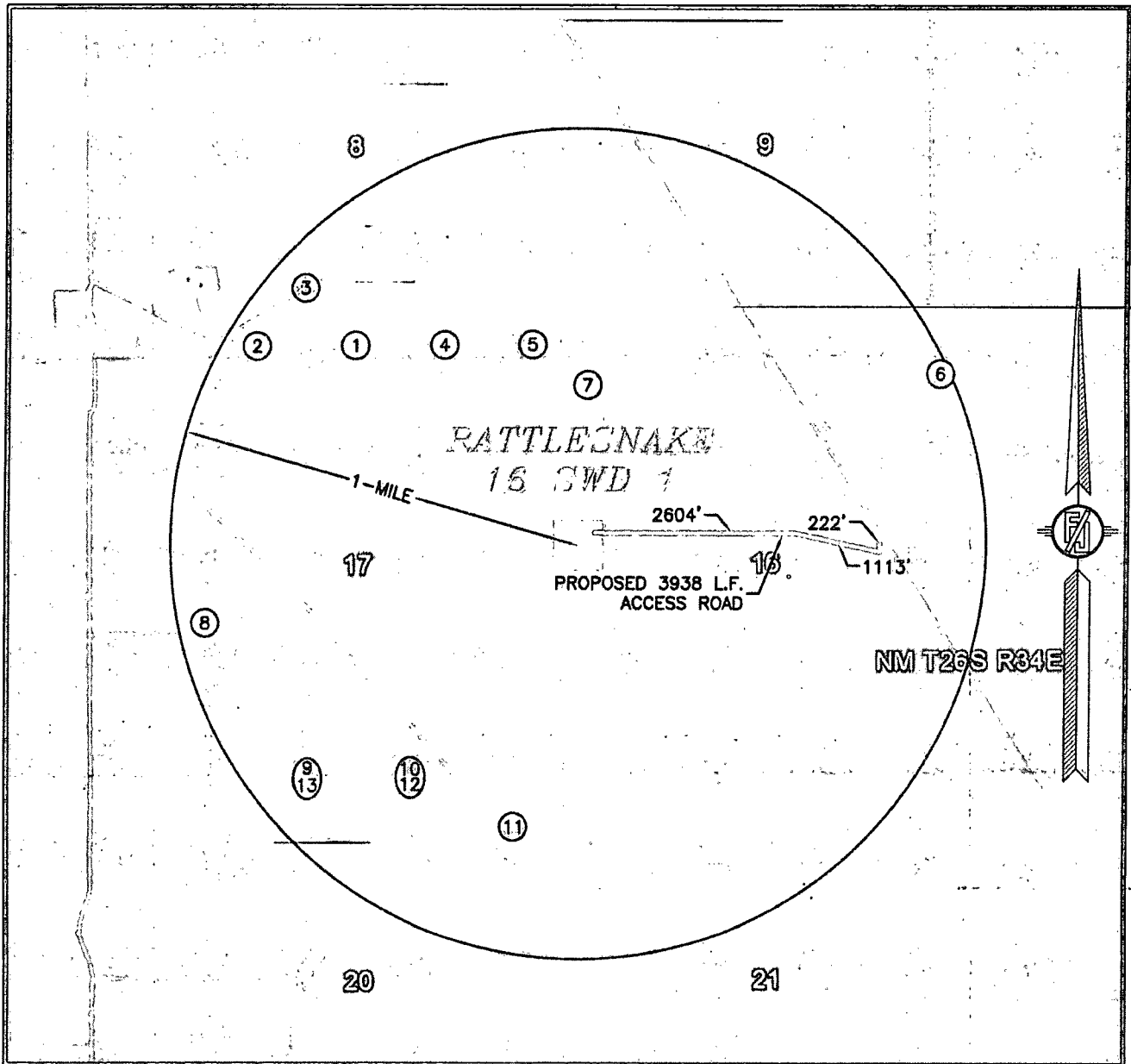

NOT TO SCALE
AERIAL PHOTO:
GOOGLE EARTH
APR. 2013

DEVON ENERGY PRODUCTION COMPANY, L.P.
RATTLESNAKE 16 SWD 1

LOCATED 2375 FT. FROM THE NORTH LINE
AND 210 FT. FROM THE WEST LINE OF
SECTION 16, TOWNSHIP 26 SOUTH,
RANGE 34 EAST, N.M.P.M.
LEA COUNTY, STATE OF NEW MEXICO

NOVEMBER 24, 2014

SURVEY NO. 2918B

MADRON SURVEYING, INC. 301 SOUTH CANAL (575) 234-3341 CARLSBAD, NEW MEXICO

JAN 07 2015

**SECTION 16, TOWNSHIP 26 SOUTH, RANGE 34 EAST, N.M.P.M.
LEA COUNTY, STATE OF NEW MEXICO
WELLS WITHIN 1-MILE OF WELL**

API	Well	Type	Status	ULSTR	Current Operator
1	30-025-41181 GUNNER 8 FEDERAL #006H	Oil	New	N-08-26S-34E	[229137] COG OPERATING LLC
2	30-025-41211 GUNNER 8 FEDERAL #007H	Oil	New	N-08-26S-34E	[229137] COG OPERATING LLC
3	30-025-28650 PRE-ONGARD WELL #001	Oil	Plugged	N-08-26S-34E	[214263] PRE-ONGARD WELL OPERATOR
4	30-025-41180 GUNNER 8 FEDERAL #005H	Oil	Active	O-08-26S-34E	[229137] COG OPERATING LLC
5	30-025-41187 GUNNER 8 FEDERAL #004H	Oil	New	P-08-26S-34E	[229137] COG OPERATING LLC
6	30-025-41649 NAUTILUS 16 STATE COM #601H	Oil	New	A-16-26S-34E	[7377] EOG RESOURCES INC
7	30-025-40890 GUNNER 16 STATE SWD #001	Salt Water Disposal	Active	D-16-26S-34E	[229137] COG OPERATING LLC
8	30-025-28402 PRE-ONGARD WELL #001	Oil	Plugged	L-17-26S-34E	[214263] PRE-ONGARD WELL OPERATOR
9	30-025-41232 GREEN WAVE 17 FEDERAL #001H	Oil	New	N-17-26S-34E	[6137] DEVON ENERGY PRODUCTION COMPANY, LP
10	30-025-41233 GREEN WAVE 17 FEDERAL #002H	Oil	New	O-17-26S-34E	[6137] DEVON ENERGY PRODUCTION COMPANY, LP
11	30-025-20440 PRE-ONGARD WELL #001	Oil	Plugged	A-20-26S-34E	[214263] PRE-ONGARD WELL OPERATOR
12	30-025-41235 GREEN WAVE 20 FEDERAL #003H	Oil	New	B-20-26S-34E	[6137] DEVON ENERGY PRODUCTION COMPANY, LP
13	30-025-41234 GREEN WAVE 20 FEDERAL #002H	Oil	New	C-20-26S-34E	[6137] DEVON ENERGY PRODUCTION COMPANY, LP

**DEVON ENERGY PRODUCTION COMPANY, L.P.
RATTLESNAKE 16 SWD 1
LOCATED 2375 FT. FROM THE NORTH LINE
AND 210 FT. FROM THE WEST LINE OF
SECTION 16, TOWNSHIP 26 SOUTH,
RANGE 34 EAST, N.M.P.M.
LEA COUNTY, STATE OF NEW MEXICO**

NOVEMBER 24, 2014

SURVEY NO. 2918B

MADRON SURVEYING, INC. 301 SOUTH CANAL (575) 234-3341 **CARLSBAD, NEW MEXICO**

SECTION 16, TOWNSHIP 26 SOUTH, RANGE 34 EAST, N.M.P.M.
LEA COUNTY, STATE OF NEW MEXICO
AERIAL ACCESS ROUTE MAP

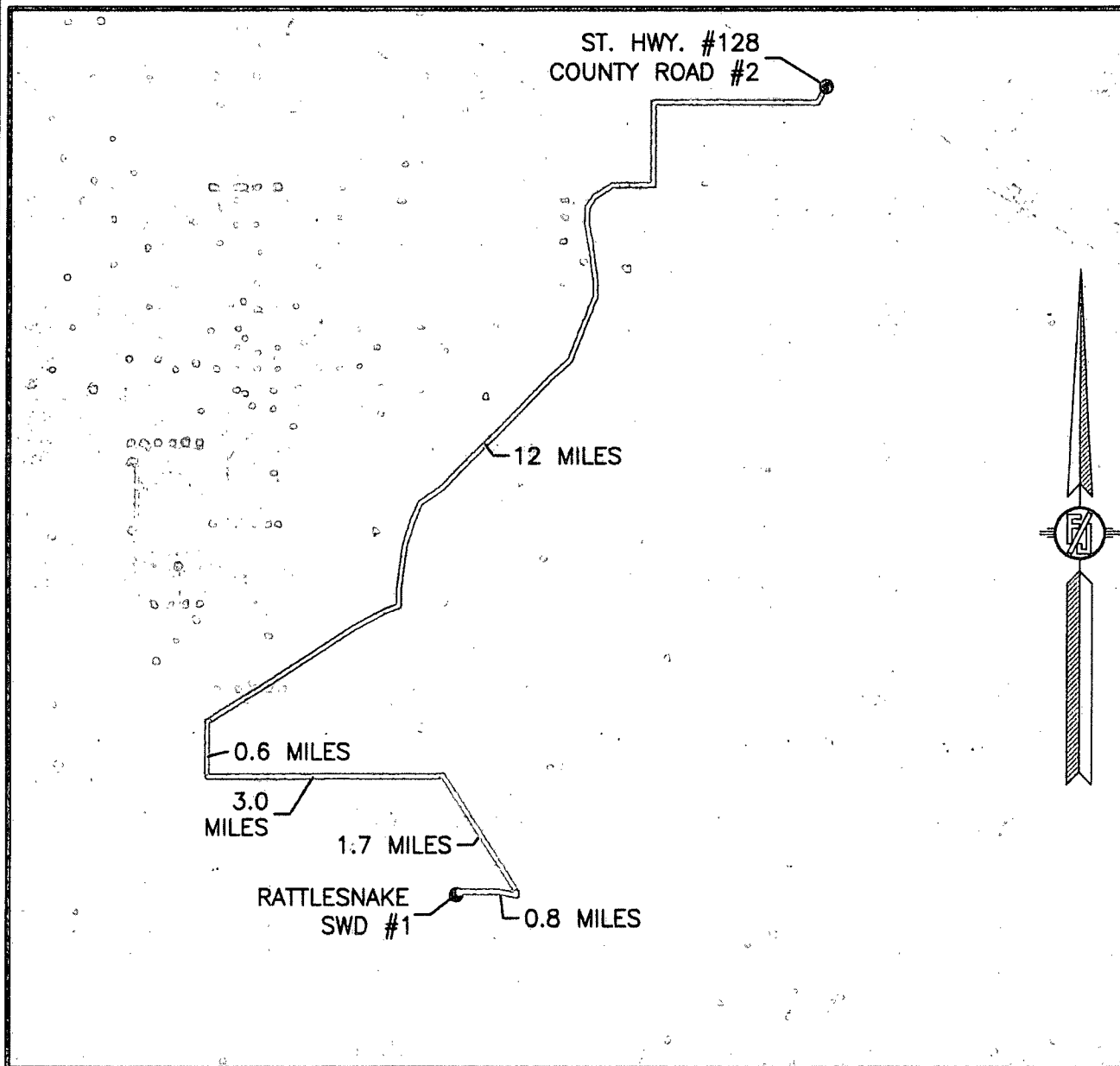

NOT TO SCALE
AERIAL PHOTO:
GOOGLE EARTH
APR. 2013

DEVON ENERGY PRODUCTION COMPANY, L.P.
RATTLESNAKE 16 SWD 1

LOCATED 2375 FT. FROM THE NORTH LINE
AND 210 FT. FROM THE WEST LINE OF
SECTION 16, TOWNSHIP 26 SOUTH,
RANGE 34 EAST, N.M.P.M.
LEA COUNTY, STATE OF NEW MEXICO

NOVEMBER 24, 2014

SURVEY NO. 2918B

MADRON SURVEYING, INC. 301 SOUTH CANAL (575) 234-3341 CARLSBAD, NEW MEXICO