

UNITED STATES
DEPARTMENT OF THE INTERIOR
BUREAU OF LAND MANAGEMENT

OCD Hobbs

FORM APPROVED
OMB No. 1004-0137
Expires: October 31, 2014

SUNDRY NOTICES AND REPORTS ON WELLS
**Do not use this form for proposals to drill or to re-enter an
abandoned well. Use Form 3160-3 (APD) for such proposals.**

SUBMIT IN TRIPLICATE - Other instructions on page 2.

1. Type of Well

☒ Oil Well ☐ Gas Well ☐ Other

FEB 23 2015

2. Name of Operator
Apache Corporation

3a. Address
303 Veterans Airport Lane, Suite 3000
Midland, TX 79705

3b. Phone No. (include area code)
432/818-1062

4. Location of Well (Footage, Sec., T., R., M., or Survey Description)

330' FSL & 1650' FEL UL O Sec 5 T21S R37E

5. Lease Serial No.
NMLC-031741A

6. If Indian, Allottee or Tribe Name

7. If Unit of CA/Agreement, Name and/or No.

8. Well Name and No.
Hawk Federal A-5 #003 (31036)

9. API Well No.
30-025-37380

10. Field and Pool or Exploratory Area
BliO&G(Oil)/TubbO&G(Oil)/Drinkard/Wantz;Abo

11. County or Parish, State
Lea County, NM

12. CHECK THE APPROPRIATE BOX(ES) TO INDICATE NATURE OF NOTICE, REPORT OR OTHER DATA

TYPE OF SUBMISSION	TYPE OF ACTION			
<input checked="" type="checkbox"/> Notice of Intent	<input type="checkbox"/> Acidize	<input type="checkbox"/> Deepen	<input type="checkbox"/> Production (Start/Resume)	<input type="checkbox"/> Water Shut-Off
<input type="checkbox"/> Subsequent Report	<input type="checkbox"/> Alter Casing	<input type="checkbox"/> Fracture Treat	<input type="checkbox"/> Reclamation	<input type="checkbox"/> Well Integrity
<input type="checkbox"/> Final Abandonment Notice	<input type="checkbox"/> Casing Repair	<input type="checkbox"/> New Construction	<input type="checkbox"/> Recomplete	<input checked="" type="checkbox"/> Other RE-OPEN ABO & DHC w/B-T-D
	<input type="checkbox"/> Change Plans	<input type="checkbox"/> Plug and Abandon	<input type="checkbox"/> Temporarily Abandon	
	<input type="checkbox"/> Convert to Injection	<input type="checkbox"/> Plug Back	<input type="checkbox"/> Water Disposal	

13. Describe Proposed or Completed Operation: Clearly state all pertinent details, including estimated starting date of any proposed work and approximate duration thereof. If the proposal is to deepen directionally or recompleat horizontally, give subsurface locations and measured and true vertical depths of all pertinent markers and zones. Attach the Bond under which the work will be performed or provide the Bond No. on file with BLM/BIA. Required subsequent reports must be filed within 30 days following completion of the involved operations. If the operation results in a multiple completion or recompleat in a new interval, a Form 3160-4 must be filed once testing has been completed. Final Abandonment Notices must be filed only after all requirements, including reclamation, have been completed and the operator has determined that the site is ready for final inspection.)

Apache is requesting permission to drill out CIBP over Abo perforations, acid/fracture stimulate the Abo and return well to production with Abo & BTD DHC, per the attached procedure. We would like to amend our allocations:

Apache requests permission to add Abo to the Blinbry-Tubb-Drinkard DHC-HOB-0138, per the following:

Pool Names:	Blinbry Oil & Gas	6660	Perforations:	Blinbry	5737'-6025'
	Tubb Oil & Gas	60240		Tubb	6255'-6388'
	Drinkard	19190		Drinkard	6736'-6850'
	Wantz, Abo	62700		Abo	6988'-7190'

Rejected. Ed Fernandez was not provided the information he requested. i.e. Water, gas, + oil analysis

The allocation method will be as follows based on offset production (See attached application for exception to Rule 303-C).

	OIL	GAS	WATER
Blinbry	18%	57%	9%
Tubb	20%	8%	22%
Drinkard	15%	0%	64%
Abo	47%	35%	5%

Downhole commingling will not reduce the value of these pools. Ownership is the same for each of these pools.

14. I hereby certify that the foregoing is true and correct. Name (Printed/Typed)

Reesa Holland Fisher

Title Sr. Staff Reg Tech

Signature

Reesa Fisher

Date 09/30/2013

THIS SPACE FOR FEDERAL OR STATE OFFICE USE

Approved by

Title

Office

Conditions of approval, if any, are attached. Approval of this notice does not warrant or certify that the applicant holds legal or equitable title to those rights in the subject lease which would entitle the applicant to conduct operations thereon.

Title 18 U.S.C. Section 1001 and Title 43 U.S.C. Section 1212, make it a crime for any person knowingly and willfully to make to any department or agency of the United States any false, fictitious or fraudulent statements or representations as to any matter within its jurisdiction.

(Instructions on page 2)

FEB 23 2015

DATE IN	SUSPENSE	ENGINEER	LOGGED IN	TYPE	APP NO.
---------	----------	----------	-----------	------	---------

ABOVE THIS LINE FOR DIVISION USE ONLY

NEW MEXICO OIL CONSERVATION DIVISION

- Engineering Bureau -

1220 South St. Francis Drive, Santa Fe, NM 87505



ADMINISTRATIVE APPLICATION CHECKLIST

THIS CHECKLIST IS MANDATORY FOR ALL ADMINISTRATIVE APPLICATIONS FOR EXCEPTIONS TO DIVISION RULES AND REGULATIONS WHICH REQUIRE PROCESSING AT THE DIVISION LEVEL IN SANTA FE

Application Acronyms:

[NSL-Non-Standard Location] [NSP-Non-Standard Proration Unit] [SD-Simultaneous Dedication]
[DHC-Downhole Commingling] [CTB-Lease Commingling] [PLC-Pool/Lease Commingling]
[PC-Pool Commingling] [OLS - Off-Lease Storage] [OLM-Off-Lease Measurement]
[WFX-Waterflood Expansion] [PMX-Pressure Maintenance Expansion]
[SWD-Salt Water Disposal] [IPI-Injection Pressure Increase]
[EOR-Qualified Enhanced Oil Recovery Certification] [PPR-Positive Production Response]

[1] TYPE OF APPLICATION - Check Those Which Apply for [A]

[A] Location - Spacing Unit - Simultaneous Dedication
☐ NSL ☐ NSP ☐ SD

Check One Only for [B] or [C]

[B] Commingling - Storage - Measurement
☒ DHC ☐ CTB ☐ PLC ☐ PC ☐ OLS ☐ OLM

[C] Injection - Disposal - Pressure Increase - Enhanced Oil Recovery
☐ WFX ☐ PMX ☐ SWD ☐ IPI ☐ EOR ☐ PPR

[D] Other: Specify _____

[2] NOTIFICATION REQUIRED TO: - Check Those Which Apply, or Does Not Apply

[A] ☐ Working, Royalty or Overriding Royalty Interest Owners

[B] ☐ Offset Operators, Leaseholders or Surface Owner

[C] ☐ Application is One Which Requires Published Legal Notice

[D] ☒ Notification and/or Concurrent Approval by BLM or SLO
 U.S. Bureau of Land Management - Commissioner of Public Lands, State Land Office

[E] ☐ For all of the above, Proof of Notification or Publication is Attached, and/or,

[F] ☐ Waivers are Attached

[3] SUBMIT ACCURATE AND COMPLETE INFORMATION REQUIRED TO PROCESS THE TYPE OF APPLICATION INDICATED ABOVE.

[4] **CERTIFICATION:** I hereby certify that the information submitted with this application for administrative approval is **accurate** and **complete** to the best of my knowledge. I also understand that **no action** will be taken on this application until the required information and notifications are submitted to the Division.

Note: Statement must be completed by an individual with managerial and/or supervisory capacity.

REESA HOLLAND FISHER
 Print or Type Name

Signature

Reesa Fisher

SR STAFF REG TECH
 Title

10/1/2013
 Date

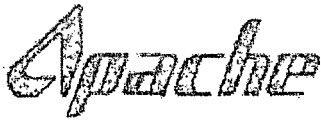

September 11, 2013

Mr. Phillip Goetze
New Mexico Oil Conservation Division
1625 N French Drive
Hobbs, New Mexico 88240

RE: Application for Exception to Rule 303-C – Downhole Commingling
Hawk A-5 #3 (30-025-37380)
Unit O, Section 5, T21S, R37E
Bliebry Oil & Gas (6660), Tubb Oil & Gas (60240), Drinkard (19190) &
Wantz; Abo (62700)
Lea County, New Mexico

Dear Mr. Goetze;

Enclosed please find form C-107A and attachments to amend DHC-HOB-0138, downhole commingling the captioned well. The ownerships (WI, NRI and ORRI) of these pools are identical in this wellbore. The fluids from each of these pools are compatible as seen in other similar commingles in the area. Combining these fluids will not result in any damage to these pools. Commingling will improve the efficiency of present and future recovery operations. Cross flow will not be a problem due to having a production lift system capable of keeping the well pumped off thereby maximizing production. This commingling will not reduce the value of the total remaining production.

This well is currently producing from the BTD and we would like to add Abo production. Apache's performance prediction for the Abo used the offset Hawk A #37 well, which is producing from the Abo only, as a type well. To generate predictions for the Hawk A-5 #3 and #9, our engineer, Michael Hunter, took the production forecast for the Hawk A #37 and adjusted it by the hydrocarbon net pay in each well relative to the Hawk A #37. Hydrocarbon net pays in the Hawk A #37, Hawk A-5#3, and Hawk A-5 #9 are 1.17 ft, 0.50 ft, and 1.46 ft, respectively.

For the Hawk A-5 #3 from the Abo, we are predicting an initial 30 day IP of 20 BOPD, declining hyperbolically with a b factor of 0.8 to 7 BOPD after five months and afterwards declining exponentially to an EUR of 10.3 MB at an economic limit of 0.5 BOPD after 109 total months of production.

If you need additional information or have any questions, please give me a call at (432) 818-1062 or contact Michael Hunter at (432) 818-1109.

Sincerely,

A handwritten signature in cursive script that reads "Reesa Fisher". The signature is written in black ink and is positioned above the printed name.

Reesa Holland Fisher
Sr. Staff Regulatory Technician

Enclosures

)



Hawk A-5 #3 Proposed Procedure

**Drill out CBP over Abo Perforations, Acid Fracture the Abo,
Return well to Production with Abo & BTD DHC**

September 9, 2013

API: 30-025-37380

330' FSL & 1650' FEL, Unit 0

Section 5, Township 21S, Range 37E

Lea County, New Mexico

TD: 7500'

PBTD: 7437'

Bridge Plug: 6978' w/25sx cmt. @ 6970'

GL elev: 3502'

KB elev: 3512'

Production Casing: 5-1/2", 17 lb/ft J-55/L-80 set @ 7500' w/ 2300 sx cmt (TOC @ 70')

Procedure:

1. MIRU. POOH w/ rods and pump. Install BOP. POOH w/ 2-7/8" tubing
2. RIH w/ 4-3/4" bit on 2-7/8" tubing, drill out cement and CIBP @ 6970'. Cont. RIH to PBTD @ +/- 7437'. Circulate well clean
3. RIH w/ casing scraper on 2-7/8" tubing to +/-6950'. POOH
4. RIH w/ treating packer on 3-1/2" N-80 work string. Set packer @ +/- 6950'
5. NU frac equipment
6. Acid frac the Middle/Upper Abo with 30,000 gal x-linked brine and 450 lb rock salt/19,200 gal retarded 15% HCl/4,500 gal 15% HCl in four equal stages @ 30+ BPM (max pressure 7,000 psi) as per frac recommendation. Shut-down to obtain fracture closure. After fracture closure, perform 4,200 gal 15% HCl acid stage at matrix rates (max pressure 1,500 psi) to ensure connectivity of hydraulic fracture to the wellbore
7. ND frac equipment. Shut well in overnight to allow acid to spend
8. Open well up and flow back fracture
9. After well has been flowed back, release packer and RBP, POOH w/ 3-1/2" tubing
10. Release packer, POOH w/ 3-1/2" tubing
11. RIH w/ 2-7/8" production tubing, set SN @ +/- 7250'. RIH w/ 1-1/2" pump and rods
12. Return well to production. Place well in test

Apache Corporation

Hawk A-5 #3



WELL DIAGRAM (CURRENT CONFIGURATION)

SURF. CSG.
CMT. CIRC.

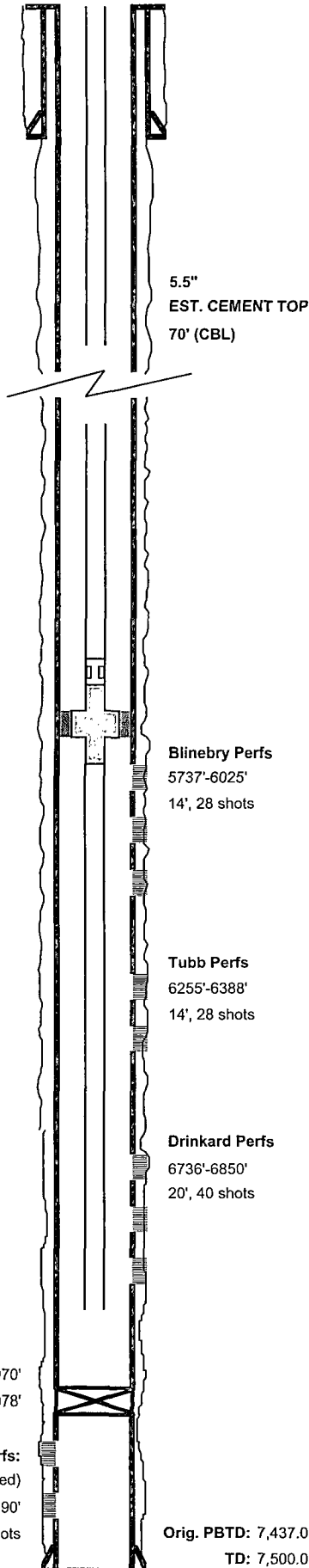

5.5"
EST. CEMENT TOP
70' (CBL)

Blinbry Perfs
5737'-6025'
14', 28 shots

Tubb Perfs
6255'-6388'
14', 28 shots

Drinkard Perfs
6736'-6850'
20', 40 shots

25sx CMT @ 6970'
CIBP @ 6978'

Abo Perfs:
(Suspended)
6988'-7190'
47', 94 shots

Orig. PBTD: 7,437.0
TD: 7,500.0

WELL NAME:		Hawk A-5 #3		API:		30-025-37380		
LOCATION:		330'S/1650'E, Unit O, Sec 5, T-21S, R-37E		COUNTY:		Lea Co, NM		
SPUD-TD DATE:		08/06/2005-08/20/2005		COMP. DATE:		1/17/2006		
PREPARED BY:		Cindy Rios		DATE:		8/19/2013		
TD (ft):		7,500.0	KB Elev. (ft):		3,512.0	KB to Ground (ft):		10.0
PBTD (ft):		6,970.0	Ground Elev. (ft):		3,502.0			
CASING/TUBING		SIZE (IN)	WEIGHT (LB/FT)	GRADE		DEPTHS (FT)		
Surface Casing		8-5/8"	24.0	J-55		0.00	1,230.0	
		(Cemented w/575 sx						
		circ to surface)						
Prod. Casing		5-1/2"	17.0	J-55/L-80		0.00	7,500.0	
		(Cemented w/2300 sx						
		TOC @ 70' CBL)						
Open Hole								
Tubing		2-7/8"	6.5	J-55		0.00	6,869.2	
PRODUCTION TBG STRING.								
ITEM	DESCRIPTION					LENGTH (FT)	Depth (FT)	
1	179 JTS 2-7/8" 8RT EUE J-55 6.5#					5643.1	5653.1	
2	TAC: 2-7/8" X 5-1/2" W/ 35 K SHEAR					2.8	5655.8	
3	37 JTS 2 -7/8" 8RT EUE J-55 6.5#					1181.4	6837.2	
4	BLAST JT: 2-7/8" 8RT EUE J-55 6.5# DON-NAN					30.8	6868.0	
5	SN: 2 3/8" 8RT API W/ CROSSOVER					1.2	6869.2	
6								
7								
8								
9								
10								
PRODUCTION ROD STRING								
ITEM	DESCRIPTION					LENGTH (FT)	Btm (FT)	
1	1-1/2" SM W/ 7/8" PINS					26.0	26.0	
2	1" PLAIN KD SHSM ROD					2.0	28.0	
3	1" PLAIN KD SHSM ROD					4.0	32.0	
4	1" PLAIN KD SHSM ROD					6.0	38.0	
5	67 JTS 1" PLAIN KD SHSM RODS					1675.0	1713.0	
6	81 JTS 7/8" PLAIN KD FHSM					2025.0	3738.0	
7	122 JTS 3/4" PLAIN KD FHSM					3050.0	6788.0	
8	BHP: 2" X 1-1/2" X 24' RHBS W/ RHR					24.0	6812.0	
9								
10								
SURFACE EQUIPMENT								
PUMPING UNIT SIZE:				640 PU		MOTOR HP:		
PUMPING UNIT MAKE:				MOTOR MAKE:				
PERFORATIONS								
Form.	Intervals					FT	SPF	
Blinebry	Active: 5737'-39', 5888'-92', 5918'-22', 6021'-25'					14	2	
Tubb	Active: 6255'-57', 6304'-08', 35'-37', 63'-65', 84'-88'					14	2	
Drinkard	Active: 6736'-40', 72'-76', 6805'-09', 21'-26', 47'-50'					20	2	
Abo	Suspended: 6988'-98', 7048'-52', 54'-64', 7070'-73', 84'-88', 7096'-7102', 7124'-28, 58'-60', 86'-90'					47	2	

Apache Corporation

Hawk A-5 #3



WELL DIAGRAM (PROPOSED CONFIGURATION)

SURF. CSG.
CMT. CIRC.

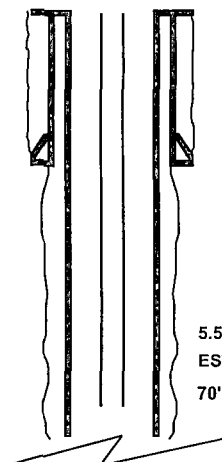

5.5"
EST. CEMENT TOP
70' (CBL)

Blinebry Perfs
5737'-6025'
14', 28 shots

Tubb Perfs
6255'-6388'
14', 28 shots

Drinkard Perfs
6736'-6850'
20', 40 shots

Abo Perfs:
6988'-7190'
47', 94 shots

PBTD: 7,437.0
TD: 7,500.0

WELL NAME:		Hawk A-5 #3		API:		30-025-37380	
LOCATION:		330°S/1650°E, Unit O, Sec 5, T-21S, R-37E		COUNTY:		Lea Co, NM	
SPUD-TD DATE:		08/06/2005-08/20/2005		COMP. DATE:		1/17/2006	
PREPARED BY:		Michael Hunter		DATE:		9/9/2013	
TD (ft): 7,500.0		KB Elev. (ft): 3,512.0		KB to Ground (ft):		10.0	
PBTD (ft): 7,437.0		Ground Elev. (ft): 3,502.0					
CASING/TUBING	SIZE (IN)	WEIGHT (LB/FT)	GRADE	DEPTHS (FT)			
Surface Casing	8-5/8"	24.0	J-55	0.00	1,230.0		
	(Cemented w/575 sx						
	circ to surface)						
Prod. Casing	5-1/2"	17.0	J-55/L-80	0.00	7,500.0		
	(Cemented w/2300 sx						
	TOC @ 70' CBL)						
Open Hole							
Tubing	2-7/8"	6.5	J-55	0.00	6,869.2		
PRODUCTION TBG STRING							
ITEM	DESCRIPTION			LENGTH (FT)	Depth (FT)		
1	230 JTS 2-7/8" 6.5# J-55						
2	TAC				+/-5500		
3	SN				+/-7250		
4							
5							
6							
7							
8							
9							
10							
PRODUCTION ROD STRING							
ITEM	DESCRIPTION			LENGTH (FT)	Btm (FT)		
1	78 JTS 1" KD RODS			1950.0			
2	81 JTS 7/8" KD RODS			2175.0			
3	122 JTS 3/4" KD RODS			3050.0			
4	BHP: 2" X 1-1/2" X 24' RHBC			24.0			
5							
6							
7							
8							
9							
10							
SURFACE EQUIPMENT							
PUMPING UNIT SIZE:			640 PU	MOTOR HP:			
PUMPING UNIT MAKE:				MOTOR MAKE:			
PERFORATIONS							
Form.	Intervals			FT	SPF		
Blinebry	Active: 5737'-39', 5888'-92', 5918'-22', 6021'-25'			14	2		
Tubb	Active: 6255'-57', 6304'-08', 35'-37', 63'-65', 84'-88'			14	2		
Drinkard	Active: 6736'-40', 72'-76', 6805'-09', 21'-26', 47'-50'			20	2		
Abo	Active: 6988'-98', 7048'-52', 54'-64', 7070'-73', 84'-88', 7096'-7102', 7124'-28, 58'-60', 86'-90'			47	2		

District I
1625 N. French Drive, Hobbs, NM 88240

District II
1301 W. Grand Avenue, Artesia, NM 88210

District III
1000 Rio Brazos Road, Aztec, NM 87410

District IV
1220 S. St. Francis Dr., Santa Fe, NM 87505

State of New Mexico
Energy, Minerals and Natural Resources Department

Form C-107A
Revised June 10, 2003

Oil Conservation Division
1220 South St. Francis Dr.
Santa Fe, New Mexico 87505

APPLICATION TYPE

☒ Single Well

☐ Establish Pre-Approved Pools

EXISTING WELLBORE

☒ Yes ☐ No

APPLICATION FOR DOWNHOLE COMMINGLING

Apache Corporation 303 Veterans Airpark Lane Suite 3000 Midland TX 79705
Operator Address
Hawk Federal A-5 003 O 5 21S 37E Lea
Lease Well No. Unit Letter-Section-Township-Range County
OGRID No. 873 Property Code 31036 API No. 30-025-37380 Lease Type: ☒ Federal ☐ State ☐ Fee

DATA ELEMENT	UPPER ZONE	INTERMEDIATE ZONE	LOWER ZONE
Pool Name	Blinebry Oil & Gas (Oil)	Tubb Oil & Gas (Oil)	Drinkard
Pool Code	6660	60240	19190
Top and Bottom of Pay Section (Perforated or Open-Hole Interval)	5737'-6025'	6255'-6388'	6736'-6850'
Method of Production (Flowing or Artificial Lift)	Artificial Lift	Artificial Lift	Artificial Lift
Bottomhole Pressure (Note: Pressure data will not be required if the bottom perforation in the lower zone is within 150% of the depth of the top perforation in the upper zone)			
Oil Gravity or Gas BTU (Degree API or Gas BTU)	37.0	37.0	37.0
Producing, Shut-In or New Zone	Producing	Producing	Producing
Date and Oil/Gas/Water Rates of Last Production. (Note: For new zones with no production history, applicant shall be required to attach production estimates and supporting data.)	Date: See Attached Rates: See Attached	Date: See Attached Rates: See Attached	Date: See Attached Rates: See Attached
Fixed Allocation Percentage (Note: If allocation is based upon something other than current or past production, supporting data or explanation will be required.)	Oil Gas 18 % 57 %	Oil Gas 20 % 8 %	Oil Gas 15 % 0 %

ADDITIONAL DATA

Are all working, royalty and overriding royalty interests identical in all commingled zones? Yes ☒ No ☐
If not, have all working, royalty and overriding royalty interest owners been notified by certified mail? Yes ☐ No ☐

Are all produced fluids from all commingled zones compatible with each other? Yes ☒ No ☐

Will commingling decrease the value of production? Yes ☐ No ☒

If this well is on, or communitized with, state or federal lands, has either the Commissioner of Public Lands or the United States Bureau of Land Management been notified in writing of this application? Yes ☒ No ☐

NMOCD Reference Case No. applicable to this well: _____

Attachments:

- C-102 for each zone to be commingled showing its spacing unit and acreage dedication.
- Production curve for each zone for at least one year. (If not available, attach explanation.)
- For zones with no production history, estimated production rates and supporting data.
- Data to support allocation method or formula.
- Notification list of working, royalty and overriding royalty interests for uncommon interest cases.
- Any additional statements, data or documents required to support commingling.

PRE-APPROVED POOLS

If application is to establish Pre-Approved Pools, the following additional information will be required:

- List of other orders approving downhole commingling within the proposed Pre-Approved Pools
- List of all operators within the proposed Pre-Approved Pools
- Proof that all operators within the proposed Pre-Approved Pools were provided notice of this application.
- Bottomhole pressure data.

I hereby certify that the information above is true and complete to the best of my knowledge and belief.

SIGNATURE Reesa Fisher TITLE Sr. Staff Regulatory Tech DATE 9/30/2013

TYPE OR PRINT NAME Reesa Holland Fisher TELEPHONE NO. (432) 818-1062

E-MAIL ADDRESS Reesa.Holland@apachecorp.com

District I
1625 N. French Drive, Hobbs, NM 88240
District II
1301 W. Grand Avenue, Artesia, NM 88210
District III
1000 Rio Brazos Road, Aztec, NM 87410
District IV
1220 S. St. Francis Dr., Santa Fe, NM 87505

State of New Mexico
Energy, Minerals and Natural Resources Department

Form C-107A
Revised June 10, 2003

Oil Conservation Division
1220 South St. Francis Dr.
Santa Fe, New Mexico 87505

APPLICATION TYPE
☒ Single Well
☐ Establish Pre-Approved Pools
EXISTING WELLBORE
☒ Yes ☐ No

APPLICATION FOR DOWNHOLE COMMINGLING

Apache Corporation 303 Veterans Airpark Lane Suite 3000 Midland TX 79705
Operator Address
Hawk Federal A-5 003 O 5 21S 37E Lea
Lease Well No. Unit Letter-Section-Township-Range County
OGRID No. 873 Property Code 31036 API No. 30-025-37380 Lease Type: ☒ Federal ☐ State ☐ Fee

DATA ELEMENT	UPPER ZONE	INTERMEDIATE ZONE	LOWER ZONE
Pool Name			Wantz; Abo
Pool Code			62700
Top and Bottom of Pay Section (Perforated or Open-Hole Interval)			6988'-7190'
Method of Production (Flowing or Artificial Lift)			Artificial Lift
Bottomhole Pressure (Note: Pressure data will not be required if the bottom perforation in the lower zone is within 150% of the depth of the top perforation in the upper zone)			
Oil Gravity or Gas BTU (Degree API or Gas BTU)			38.0
Producing, Shut-In or New Zone			CIBP @ 6978'
Date and Oil/Gas/Water Rates of Last Production. (Note: For new zones with no production history, applicant shall be required to attach production estimates and supporting data.)	Date: Rates:	Date: Rates:	Date: See Attached Rates: See Attached
Fixed Allocation Percentage (Note: If allocation is based upon something other than current or past production, supporting data or explanation will be required.)	Oil Gas % %	Oil Gas % %	Oil Gas 47 % 35 %

ADDITIONAL DATA

Are all working, royalty and overriding royalty interests identical in all commingled zones? Yes ☒ No ☐
If not, have all working, royalty and overriding royalty interest owners been notified by certified mail? Yes ☐ No ☐
Are all produced fluids from all commingled zones compatible with each other? Yes ☒ No ☐
Will commingling decrease the value of production? Yes ☐ No ☒
If this well is on, or communitized with, state or federal lands, has either the Commissioner of Public Lands or the United States Bureau of Land Management been notified in writing of this application? Yes ☒ No ☐
NMOCD Reference Case No. applicable to this well: _____

Attachments:
C-102 for each zone to be commingled showing its spacing unit and acreage dedication.
Production curve for each zone for at least one year. (If not available, attach explanation.)
For zones with no production history, estimated production rates and supporting data.
Data to support allocation method or formula.
Notification list of working, royalty and overriding royalty interests for uncommon interest cases.
Any additional statements, data or documents required to support commingling.

PRE-APPROVED POOLS

If application is to establish Pre-Approved Pools, the following additional information will be required:

List of other orders approving downhole commingling within the proposed Pre-Approved Pools
List of all operators within the proposed Pre-Approved Pools
Proof that all operators within the proposed Pre-Approved Pools were provided notice of this application.
Bottomhole pressure data.

I hereby certify that the information above is true and complete to the best of my knowledge and belief.

SIGNATURE Reesa Fisher TITLE Sr. Staff Regulatory Tech DATE 9/30/2013
TYPE OR PRINT NAME Reesa Holland Fisher TELEPHONE NO. (432) 818-1062
E-MAIL ADDRESS Reesa.Holland@apachecorp.com

Calculated splits as per the table below:

Hawk A-5 #3 Allocated Forecast Remaining Production - With Abo						
Zone	Oil		Gas		Water	
	(BBL)	(%)	(MCF)	(%)	(BBL)	(%)
Blinebry	3,803	17.5%	53,940	57.4%	2,905	8.5%
Tubb	4,376	20.1%	7,148	7.6%	7,424	21.8%
Drinkard	3,341	15.3%	0	0.0%	21,952	64.5%
Abo	10,260	47.1%	32,832	35.0%	1,744	5.1%
Total	21,779	100.0%	93,920	100.0%	34,026	100.0%

Petrophysics Summary					
Well	h (ft)	Phi (%)	Phi-h (%)	Sw	SoPhiH (%)
Hawk A #37	26	7.7%	2.0	42.2%	1.17
Hawk A-5 #3	10	8.3%	0.8	39.4%	0.50
Hawk A-5 #9	28.5	8.9%	2.5	42.6%	1.46

Hawk A-37		Hawk A-5 #3		Hawk A-5 #9	
Production Forecast		Production Prediction		Production Prediction	
Segment 1		Segment 1		Segment 1	
qi	47.3 BOPD	qi	20.3 BOPD	qi	59.1 BOPD
qf	17.3 BOPD	qf	7.4 BOPD	qf	21.6 BOPD
b	0.8	b	0.8	b	0.8
di	30.9% /Mo.	di	30.9% /Mo.	di	30.9% /Mo.
tf	5 /Mo	tf	5 /Mo	tf	5 /Mo
Qf	5.3 MB	Qf	2.3 MB	Qf	6.6 MB
Segment 2		Segment 2		Segment 2	
qi	16.9 BOPD	qi	7.2 BOPD	qi	21.1 BOPD
qf	0.5 BOPD	qf	0.5 BOPD	qf	0.5 BOPD
b	0	b	0	b	0
d	2.6% /Mo.	d	2.6% /Mo.	d	2.6% /Mo.
tf	141 Mos.	tf	109 Mos.	tf	150 Mos.
Qf	24.3 MB	Qf	10.3 MB	Qf	30.9 MB

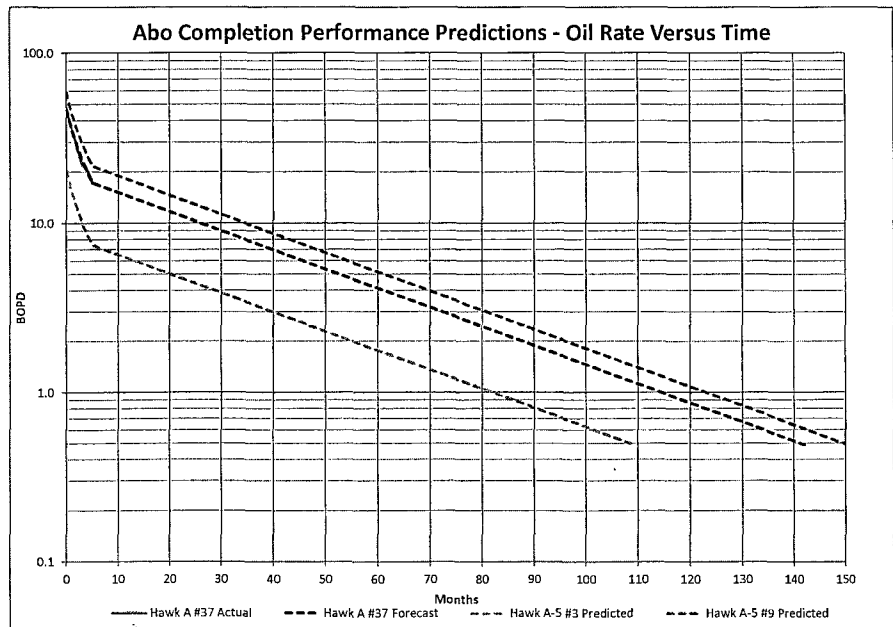
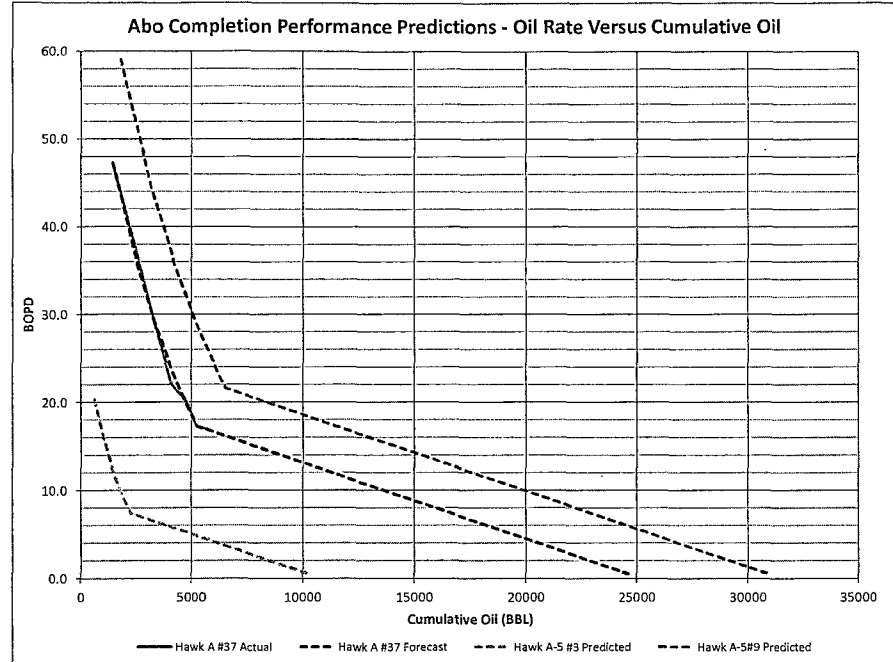

Hawk A #37 Allocated Monthly Production			
Month	Abo		
	Oil	Gas	Water
	(BBL)	(MCF)	(BBL)
Jan-13	1437	1868	761
Feb-13	1118	2864	359
Mar-13	862	2277	161
Apr-13	675	1973	98
May-13	621	1843	101
Jun-13	526	1685	93
Jul-13	524	1660	86

Hawk A #37 Allocated Cumulative Production		
Abo		
Oil	Gas	Water
(BBL)	(MCF)	(BBL)
5,763	14,169	1,659

Hawk A-5 #3 Allocated Monthly Production												
Month	Blinebry			Drinkard			Tubb			Total		
	Oil (BBL)	Gas (MCF)	Water (BBL)	Oil (BBL)	Gas (MCF)	Water (BBL)	Oil (BBL)	Gas (MCF)	Water (BBL)	Oil (BBL)	Gas (MCF)	Water (BBL)
Oct-05	264	742	59	232	0	447	304	209	151	800	951	657
Nov-05	437	1588	138	384	0	1041	503	448	352	1324	2036	1531
Dec-05	315	1439	136	277	0	1027	363	406	347	955	1845	1510
Jan-06	323	1649	110	284	0	835	372	465	282	979	2114	1227
Feb-06	255	1552	528	224	0	3988	294	438	1349	773	1990	5865
Mar-06	294	1673	481	258	0	3634	338	472	1229	890	2145	5344
Apr-06	249	1601	413	219	0	3120	287	451	1055	755	2052	4588
May-06	260	2303	398	228	0	3008	299	649	1017	787	2952	4423
Jun-06	238	2221	395	209	0	2984	274	626	1009	721	2847	4388
Jul-06	253	2148	422	222	0	3190	291	606	1079	766	2754	4691
Aug-06	219	1941	226	193	0	1706	252	548	577	664	2489	2509
Sep-06	201	4158	84	177	0	632	232	534	214	610	4692	930
Oct-06	205	9875	117	180	0	883	236	1906	299	621	11781	1299
Nov-06	177	4998	167	156	0	1260	204	604	426	537	5602	1853
Dec-06	167	4254	301	147	0	2277	192	565	770	506	4819	3348
Jan-07	177	4613	330	156	0	2492	204	672	843	537	5285	3665
Feb-07	141	4111	272	124	0	2058	162	516	696	427	4627	3026
Mar-07	136	5681	284	119	0	2144	156	306	725	411	5987	3153
Apr-07	122	3180	232	107	0	1754	141	683	593	370	3863	2579
May-07	115	8122	290	101	0	2192	132	487	741	348	8609	3223
Jun-07	118	7765	181	103	0	1365	135	251	462	356	8016	2008
Jul-07	142	6306	41	125	0	311	163	104	105	430	6410	457
Aug-07	112	9901	143	98	0	1083	128	201	366	338	10102	1592
Sep-07	55	8986	143	48	0	1082	63	127	366	166	9113	1591
Oct-07	23	5232	73	20	0	550	27	74	186	70	5306	809
Nov-07	65	9655	196	58	0	1479	75	213	500	198	9868	2175
Dec-07	61	10344	169	54	0	1281	70	377	433	185	10721	1883
Jan-08	49	9425	145	43	0	1097	57	356	371	149	9781	1613
Feb-08	288	7328	161	253	0	1217	331	316	412	872	7644	1790
Mar-08	223	4634	123	196	0	931	257	219	315	676	4853	1369
Apr-08	324	6892	186	285	0	1404	374	413	475	983	7305	2065
May-08	296	7591	185	260	0	1397	340	387	472	896	7978	2054
Jun-08	212	7332	166	187	0	1256	244	401	425	643	7733	1847
Jul-08	75	9182	199	66	0	1504	86	306	509	227	9488	2212
Aug-08	85	7462	174	75	0	1312	98	684	444	258	8146	1930
Sep-08	41	1581	94	36	0	713	47	446	241	124	2027	1048
Oct-08	48	2389	161	42	0	1214	55	674	411	145	3063	1786
Nov-08	40	1848	287	35	0	2167	46	521	733	121	2369	3187
Dec-08	40	1793	328	35	0	2482	46	506	839	121	2299	3649
Jan-09	42	1684	272	37	0	2054	49	475	695	128	2159	3021
Feb-09	66	1158	244	58	0	1846	76	327	624	200	1485	2714
Mar-09	143	1266	216	126	0	1631	165	357	552	434	1623	2399
Apr-09	106	1065	175	93	0	1324	122	300	448	321	1365	1947
May-09	60	1237	262	53	0	1976	69	349	668	182	1586	2906
Jun-09	47	1407	231	41	0	1747	54	397	591	142	1804	2569
Jul-09	45	1504	227	40	0	1717	52	424	581	137	1928	2525
Aug-09	90	1346	165	79	0	1246	103	380	421	272	1726	1832
Sep-09	111	954	127	98	0	959	128	269	324	337	1223	1410
Oct-09	134	891	141	118	0	1069	154	251	361	406	1142	1571
Nov-09	145	945	177	127	0	1338	167	266	453	439	1211	1968
Dec-09	130	1125	143	110	0	1081	144	317	366	384	1442	1590
Jan-10	93	830	113	82	0	856	108	234	290	283	1064	1259
Feb-10	93	706	113	82	0	856	107	199	290	282	905	1259
Mar-10	92	599	167	78	0	1264	103	169	428	273	768	1859
Apr-10	45	747	139	40	0	1052	52	211	356	137	958	1547
May-10	89	993	138	78	0	1044	102	280	353	269	1273	1535
Jun-10	91	1001	121	80	0	911	105	282	308	276	1283	1340
Jul-10	95	978	108	83	0	815	109	276	276	287	1254	1199
Aug-10	86	1027	37	76	0	279	99	290	94	261	1317	410
Sep-10	77	984	70	68	0	531	89	277	180	234	1261	781
Oct-10	97	927	81	85	0	613	112	261	207	294	1188	901
Nov-10	104	759	96	91	0	728	120	214	246	315	973	1070
Dec-10	82	638	83	72	0	626	95	180	212	249	818	921
Jan-11	92	778	91	81	0	691	106	219	234	279	997	1016
Feb-11	63	609	58	56	0	437	73	172	148	192	781	643
Mar-11	94	930	120	83	0	910	109	262	308	286	1192	1338
Apr-11	91	910	95	80	0	720	105	257	244	276	1167	1059
May-11	77	1035	85	67	0	641	88	292	217	232	1327	943
Jun-11	71	1022	108	63	0	814	82	288	275	216	1310	1197
Jul-11	72	1023	129	64	0	976	83	289	330	219	1312	1435
Aug-11	80	1007	142	70	0	1075	92	284	364	242	1291	1581
Sep-11	67	944	130	59	0	981	77	266	332	203	1210	1443
Oct-11	57	1000	112	50	0	848	65	282	287	172	1282	1247
Nov-11	65	917	89	57	0	671	74	259	227	196	1176	987
Dec-11	43	756	110	38	0	831	49	213	281	130	969	1222
Jan-12	52	810	124	46	0	935	60	229	316	158	1039	1375
Feb-12	48	773	69	43	0	525	56	218	177	147	991	771
Mar-12	41	753	54	36	0	408	47	212	138	124	965	600
Apr-12	41	753	56	36	0	427	47	212	144	124	965	627
May-12	38	768	22	34	0	170	44	217	57	116	985	249
Jun-12	42	877	24	37	0	179	49	247	60	128	1124	263
Jul-12	85	842	45	75	0	339	98	237	115	258	1079	499
Aug-12	88	845	99	77	0	746	101	238	252	266	1083	1097
Sep-12	81	770	70	71	0	526	93	217	178	245	987	774
Oct-12	111	827	90	97	0	683	127	233	231	335	1060	1004
Nov-12	123	770	88	109	0	668	142	217	226	374	987	982
Dec-12	139	814	103	122	0	776	160	230	262	421	1044	1141
Jan-13	117	782	95	103	0	717	134	220	242	354	1002	1054
Feb-13	66	678	64	58	0	482	76	191	163	200	869	709
Mar-13	107	779	74	94	0	561	124	220	190	325	999	825
Apr-13	42	581	13	37	0	95	49	164	32	128	745	140
May-13	41	451	19	36	0	140	48	127	47	125	578	206
Jun-13	56	656	30	49	0	223	65	185	75	170	841	328
Jul-13	56	764	40	49	0	300	65	216	102	170	980	442

Hawk A-5 #3 Allocated Cumulative Production												
Month	Blinebry			Drinkard			Tubb			Total		
	Oil (BBL)	Gas (MCF)	Water (BBL)	Oil (BBL)	Gas (MCF)	Water (BBL)	Oil (BBL)	Gas (MCF)	Water (BBL)	Oil (BBL)	Gas (MCF)	Water (BBL)
11,254	243,490	14,632	9,888	0	110,575	12,950	32,265	37,397	34,092	275,755	162,604	

Hawk A-5 #9 Allocated Monthly Production												
Month	Blinebry			Drinkard			Tubb			Total		
	Oil	Gas	Water	Oil	Gas	Water	Oil	Gas	Water	Oil	Gas	Water
	(BBL)	(MCF)	(BBL)	(BBL)	(MCF)	(BBL)	(BBL)	(MCF)	(BBL)	(BBL)	(MCF)	(BBL)
Oct-12	313	287	1220	871	574	1870	177	734	976	1361	1595	4066
Nov-12	339	465	1490	943	931	2284	192	1190	1192	1474	2586	4966
Dec-12	97	174	221	271	348	339	55	445	177	423	967	737
Jan-13	115	203	189	321	405	289	65	518	151	501	1126	629
Feb-13	134	296	456	372	592	700	76	757	365	582	1645	1521
Mar-13	150	329	459	416	657	703	85	840	367	651	1826	1529
Apr-13	115	331	442	370	662	677	65	846	353	500	1839	1472
May-13	128	287	327	356	574	502	72	734	262	556	1595	1091
Jun-13	90	274	309	251	548	474	51	700	248	392	1522	1031
Jul-13	113	289	422	315	578	647	64	738	338	492	1605	1407

Hawk A-5 #9 Allocated Cumulative Production											
Blinebry			Drinkard			Tubb			Total		
Oil	Gas	Water	Oil	Gas	Water	Oil	Gas	Water	Oil	Gas	Water
(BBL)	(MCF)	(BBL)	(BBL)	(MCF)	(BBL)	(BBL)	(MCF)	(BBL)	(BBL)	(MCF)	(BBL)
1,594	2,935	5,535	4,436	5,869	8,485	902	7,502	4,429	6,932	16,306	18,449

Well Test History Report

Page 1 of 1
9/11/2013 3:34:59 pm

Select By: Field

Display: All well tests between 01/01/2013 - 09/09/2013

Test Date	Effective Date	Measured Hours	Type	24 Hour Volumes					Ratios					Fluid Level
				Gr Liquid	OIL	GAS	WAT	LIFT	GOR	GLR	IGOR	IGLR	TGLR	
Field: EUNICE AREA BTD														
HAWK /A-5/ #3 (BLINEBRY)														
1/27/2013	1/27/2013	24	A	32	7	37	25	0	5,286	1,156	0	0	1,156	
2/24/2013	2/24/2013	24	A	36	10	40	26	0	4,000	1,111	0	0	1,111	
3/15/2013	3/15/2013	24	A	34	8	40	26	0	5,000	1,176	0	0	1,176	
4/2/2013	4/2/2013	24	A	6	3	30	3	0	10,000	5,000	0	0	5,000	
5/2/2013	5/2/2013	24	A	8	3	20	5	0	6,667	2,500	0	0	2,500	
6/12/2013	6/12/2013	24	A	14	5	35	9	0	7,000	2,500	0	0	2,500	
7/22/2013	7/22/2013	24	A	11	3	33	8	0	11,000	3,000	0	0	3,000	
8/27/2013	8/27/2013	24	A	8	5	36	3	0	7,200	4,500	0	0	4,500	
Averages by Completion				19	6	34	13	0						

** All values are recorded using imperial units.

C-103 Received 2-2-2006

PNRM 0606930652

DHC No. Assigned 3-10-2006

Order Number		API Number		Operator		County	
H08-0138		30-025-37380		Apache Corporation		Lea	
Order Date		Well Name		Number		Location	
		Hawk A-5		003		0 5 21 S 37 E UL Sec T (+Dir) R (+Dir)	
Pool 1	06660	Blinebry Oil & Gas (Oil)		Oil %	33%	Gas %	78%
Pool 2	60240	Tubb Oil & Gas (Oil)		Oil %	38%	Gas %	22%
Pool 3	19190	Drinkard		Oil %	29%	Gas %	0%
Pool 4				Oil %		Gas %	
Comments: Work completed effective _____ Work cancelled effective _____ Supplement _____							

Posted to
R B Dym
3-10-2006

(3)

DOWNHOLE COMMINGLE CALCULATIONS:

30-025-37380
HOB-0138

OPERATOR: Apache Corporation

PROPERTY NAME: Hawk A-5

WNULSTR: 3-0, 5-21-37

	SECTION I:		ALLOWABLE AMOUNT
06660	POOL NO. 1 <u>Blinebry Oil & Gas (Oil)</u>	<u>107</u>	<u>428</u> MCF 4000
60240	POOL NO. 2 <u>Tubb Oil & Gas (Oil)</u>	<u>142</u>	<u>284</u> MCF 2000
19190	POOL NO. 3 <u>Drinkard</u>	<u>142</u>	<u>852</u> MCF 6000

POOL NO. 4 _____ MCF

POOL TOTALS 391 1564

SECTION II:
POOL NO. 1 Blinebry Oil & Gas (Oil)

Oil Gas
33% 78%

POOL NO. 2 Tubb Oil & Gas (Oil)

38% X 391 = 148.58 22%

POOL NO. 3 Drinkard

29% 0%

POOL NO. 4 _____

OIL

GAS

SECTION III:

$107 \div 38\% = 281.57 (282)$

SECTION IV:

$282 \times 33\% = 93.06 (93)$

$282 \times 38\% = 107.16 (107)$

$282 \times 29\% = 81.78 (82)$

Submit to appropriate District Office
District I
1625 N. French Dr., Hobbs, NM 88240
District II
1301 W. Grand Ave., Artesia, NM 88210
District III
0 Rio Brazos Rd., Aztec, NM 87410
District IV
20 S. St. Francis Dr., Santa Fe, NM 87505

State of New Mexico
Energy, Minerals and Natural Resources

Form C-103
May 27, 2004

OIL CONSERVATION DIVISION
1220 South St. Francis Dr.
Santa Fe, NM 87505

WELL API NO.	30-025-37380
5. Indicate Type of Lease	Federal <input checked="" type="checkbox"/> STATE <input type="checkbox"/> FEE <input type="checkbox"/>
6. State Oil & Gas Lease No.	
7. Lease Name or Unit Agreement Name	HAWK A-5
8. Well Number	3
9. OGRID Number	00873
10. Pool name or Wildcat	Blinebry O&G, Tubb O&G & Drinkard

SUNDRY NOTICES AND REPORTS ON WELLS (DO NOT USE THIS FORM FOR PROPOSALS TO DRILL OR TO DEEPEN OR PLUG BACK TO A DIFFERENT RESERVOIR. USE "APPLICATION FOR PERMIT" (FORM C-101) FOR SUCH PROPOSALS)	
1. Type of Well: Oil Well <input checked="" type="checkbox"/> Gas Well <input type="checkbox"/> Other <input type="checkbox"/>	
2. Name of Operator Apache Corporation	
3. Address of Operator 6120 South Yale, Suite 1500 Tulsa, OK 74136-4224	
4. Well Location Unit Letter <u>O</u> : <u>330</u> feet from the <u>South</u> line and <u>1650</u> feet from the <u>East</u> line Section <u>5</u> Township <u>21S</u> Range <u>37E</u> NMPM County <u>Lea</u>	
11. Elevation (Show whether DR, RKB, RT, GR, etc.) 3502'	
Pit or Below-grade Tank Application <input type="checkbox"/> or Closure <input type="checkbox"/>	
Pit type _____ Depth to Groundwater _____ Distance from nearest fresh water well _____ Distance from nearest surface water _____	
Pit Liner Thickness: _____ mil Below-Grade Tank: Volume _____ bbls; Construction Material _____	

12. Check Appropriate Box to Indicate Nature of Notice, Report or Other Data

NOTICE OF INTENTION TO:

PERFORM REMEDIAL WORK ☐ PLUG AND ABANDON ☐
TEMPORARILY ABANDON ☐ CHANGE PLANS ☐
LL OR ALTER CASING ☐ MULTIPLE COMPL ☐

SUBSEQUENT REPORT OF:

REMEDIAL WORK ☐ ALTERING CASING ☐
COMMENCE DRILLING OPNS. ☐ P AND A ☐
CASING/CEMENT JOB ☐

OTHER: ☐

OTHER: Downhole Commingle Blinebry, Tubb & Drinkard ☒

13. Describe proposed or completed operations. (Clearly state all pertinent details, and give pertinent dates, including estimated date of starting any proposed work). SEE RULE 1103. For Multiple Completions: Attach wellbore diagram of proposed completion or recompletion.

Pursuant to Division Order R-11363

Pool Names: Blinebry Oil & Gas (Oil) 06660, Tubb Oil & Gas (Oil) 60240, Drinkard 19190

Perforations:

BLINEBRY 5737-39, 5888-92, 5918-22 & 6021-25' 2 JSPF

TUBB 6255-57, 6304-08, 6335-37, 6363-65 & 6384-88' 2 JSPF

DRINKARD 6736-40, 6772-76, 6805-09, 6821-26 & 6847-50' 2 JSPF

ABO 6988-98, 7048-52, 7054-64, 7070-73, 84-88, 7096-7102, 24-28, 58-60 & 7186-90' 1 JSPF

CIBP @ 6978'

The allocation method will be as follows: Test 58 BO X 81 MCF X 203 BW

	Oil	Alloc%	Gas	Alloc%	Wtr	Alloc%
Blinebry	19	33	63	78	17	9
Tubb	22	38	18	22	47	23
Drinkard	17	29	0	0	139	68
	58	100	81	100	203	100

Downhole commingling will not reduce the value of the pools.
Ownership is the same for each of these pools.

DHC Order No.

HOB-0138

I hereby certify that the information above is true and complete to the best of my knowledge and belief. I further certify that any pit or below-grade tank has been/will be constructed or closed according to NMOC guidelines ☐, a general permit ☐ or an (attached) alternative OCD-approved plan ☐.

SIGNATURE

Elaine Linton

TITLE Engineering Technician

DATE 02/01/2006

or print name Elaine Linton

E-mail address: elaine.linton@apachecorp.com Telephone No. (918)491-5362

For State Use Only

APPROVED BY:

[Signature]

TITLE

PETROLEUM ENGINEER

DATE MAR 10 2006

Conditions of Approval (if any):

DISTRICT I

1625 N. FRENCH DR., HOBBBS, NM 88240

DISTRICT II

1301 W. GRAND AVENUE, ARTESIA, NM 88210

DISTRICT III

1000 Rio Brazos Rd., Aztec, NM 87410

DISTRICT IV

1220 S. ST. FRANCIS DR., SANTA FE, NM 87505

State of New Mexico

Energy, Minerals and Natural Resources Department

OIL CONSERVATION DIVISION
1220 SOUTH ST. FRANCIS DR.
Santa Fe, New Mexico 87505

Form C-102

Revised JUNE 10, 2003

Submit to Appropriate District Office

State Lease - 4 Copies

Fee Lease - 3 Copies

WELL LOCATION AND ACREAGE DEDICATION PLAT

☐ AMENDED REPORT

API Number 30-025-37380	Pool Code 06660	Pool Name Blinebry Oil & Gas (Oil)
Property Code 24426	Property Name HAWK A-5	Well Number 3
OGRID No. 00873	Operator Name APACHE CORPORATION	Elevation 3502'

Surface Location

UL or lot No.	Section	Township	Range	Lot Idn	Feet from the	North/South line	Feet from the	East/West line	County
0	5	21-S	37-E		330	SOUTH	1650	EAST	LEA

Bottom Hole Location If Different From Surface

UL or lot No.	Section	Township	Range	Lot Idn	Feet from the	North/South line	Feet from the	East/West line	County

Dedicated Acres	Joint or Infill	Consolidation Code	Order No.
4.0			

NO ALLOWABLE WILL BE ASSIGNED TO THIS COMPLETION UNTIL ALL INTERESTS HAVE BEEN CONSOLIDATED
OR A NON-STANDARD UNIT HAS BEEN APPROVED BY THE DIVISION

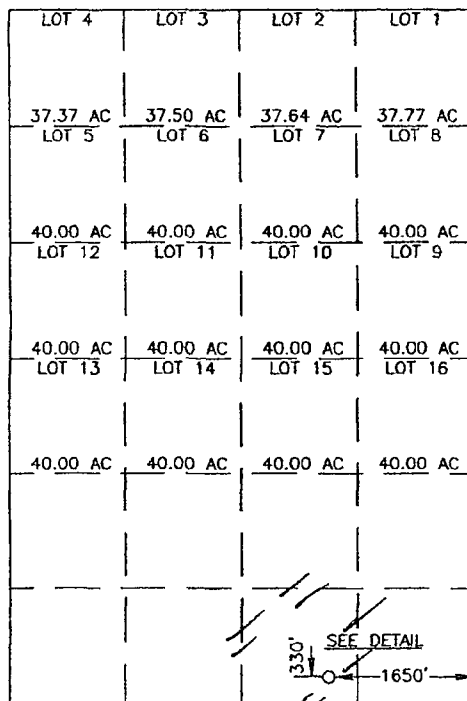

SCALE - 1"=2000'

SEE DETAIL

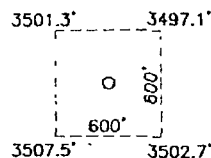

GEODETIC COORDINATES
NAD 27 NME

Y=548072.9 N
X=855126.6 E

LAT.=32°30'05.36" N
LONG.=103°10'53.27" W

OPERATOR CERTIFICATION

I hereby certify that the information
contained herein is true and complete to the
best of my knowledge and belief.

Elaine Linton
Signature

Elaine Linton
Printed Name

Engineering Technician
Title

12/1/2005
Date

SURVEYOR CERTIFICATION

I hereby certify that the well location shown
on this plat was plotted from field notes of
actual surveys made by me or under my
supervision, and that the same is true and
correct to the best of my belief.

DECEMBER 16, 2004

Date Surveyed
Signature & Seal of
Professional Surveyor

GARY EIDSON
04.11.169
12/16/04

Certificate No. GARY EIDSON 12641

DISTRICT I
1625 N. FRENCH DR., HOBBS, NM 88240

DISTRICT II
RAND AVENUE, ARTESIA, NM 88210

DISTRICT III
1000 Rio Brazos Rd., Aztec, NM 87410

DISTRICT IV
1220 S. ST. FRANCIS DR., SANTA FE, NM 87505

State of New Mexico

Energy, Minerals and Natural Resources Department

OIL CONSERVATION DIVISION
1220 SOUTH ST. FRANCIS DR.
Santa Fe, New Mexico 87505

Form C-102
Revised JUNE 10, 2003
Submit to Appropriate District Office
State Lease - 4 Copies
Fee Lease - 3 Copies

WELL LOCATION AND ACREAGE DEDICATION PLAT

☐ AMENDED REPORT

API Number 30-025-37380	Pool Code 60240	Pool Name Tubb Oil & Gas (Oil)
Property Code 24426	Property Name HAWK A-5	Well Number 3
OGRID No. 00873	Operator Name APACHE CORPORATION	Elevation 3502'

Surface Location

UL or lot No.	Section	Township	Range	Lot Idn	Feet from the	North/South line	Feet from the	East/West line	County
0	5	21-S	37-E		330	SOUTH	1650	EAST	LEA

Bottom Hole Location If Different From Surface

UL or lot No.	Section	Township	Range	Lot Idn	Feet from the	North/South line	Feet from the	East/West line	County

Dedicated Acres	Joint or Infill	Consolidation Code	Order No.

NO ALLOWABLE WILL BE ASSIGNED TO THIS COMPLETION UNTIL ALL INTERESTS HAVE BEEN CONSOLIDATED
OR A NON-STANDARD UNIT HAS BEEN APPROVED BY THE DIVISION

LOT 4	LOT 3	LOT 2	LOT 1
37.37 AC LOT 5	37.50 AC LOT 6	37.64 AC LOT 7	37.77 AC LOT 8
40.00 AC LOT 12	40.00 AC LOT 11	40.00 AC LOT 10	40.00 AC LOT 9
40.00 AC LOT 13	40.00 AC LOT 14	40.00 AC LOT 15	40.00 AC LOT 16
40.00 AC	40.00 AC	40.00 AC	40.00 AC

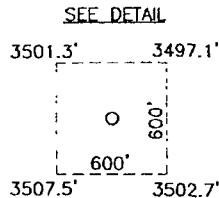

GEODETIC COORDINATES
NAD 27 NME

Y=548072.9 N
X=855126.6 E

LAT.=32°30'05.36" N
LONG.=103°10'53.27" W

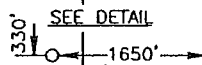

SCALE - 1"=2000'

OPERATOR CERTIFICATION

I hereby certify the the information
contained herein is true and complete to the
best of my knowledge and belief.

Elaine Linton
Signature

Elaine Linton
Printed Name

Engineering Technician
Title

2/1/2006
Date

SURVEYOR CERTIFICATION

I hereby certify that the well location shown
on this plat was plotted from field notes of
actual surveys made by me or under my
supervision, and that the same is true and
correct to the best of my belief

DECEMBER 16, 2004

Date Surveyed
Signature & Seal of Professional Surveyor

Gary Eidsen
12/30/04
04.11.1691

Certificate No. GARY EIDSON 12641

DISTRICT I

1625 N. FRENCH DR., HOBBS, NM 88240

DISTRICT II

1625 N. FRENCH DR., HOBBS, NM 88240

DISTRICT III

1000 Rio Brazos Rd., Aztec, NM 87410

DISTRICT IV

1220 S. ST. FRANCIS DR., SANTA FE, NM 87505

State of New Mexico

Energy, Minerals and Natural Resources Department

OIL CONSERVATION DIVISION

1220 SOUTH ST. FRANCIS DR.
Santa Fe, New Mexico 87505

Form C-102

Revised JUNE 10, 2003

Submit to Appropriate District Office

State Lease - 4 Copies

Fee Lease - 3 Copies

WELL LOCATION AND ACREAGE DEDICATION PLAT

☐ AMENDED REPORT

API Number 30-025-37380		Pool Code 19190	Pool Name Drinkard
Property Code 24426	Property Name HAWK A-5		Well Number 3
OGRID No. 00873	Operator Name APACHE CORPORATION		Elevation 3502'

Surface Location

UL or lot No.	Section	Township	Range	Lot Idn	Feet from the	North/South line	Feet from the	East/West line	County
0	5	21-S	37-E		330	SOUTH	1650	EAST	LEA

Bottom Hole Location If Different From Surface

UL or lot No.	Section	Township	Range	Lot Idn	Feet from the	North/South line	Feet from the	East/West line	County
Dedicated Acres	Joint or Infill	Consolidation Code	Order No.						

NO ALLOWABLE WILL BE ASSIGNED TO THIS COMPLETION UNTIL ALL INTERESTS HAVE BEEN CONSOLIDATED
OR A NON-STANDARD UNIT HAS BEEN APPROVED BY THE DIVISION

LOT 4	LOT 3	LOT 2	LOT 1
37.37 AC LOT 5	37.50 AC LOT 6	37.64 AC LOT 7	37.77 AC LOT 8
40.00 AC LOT 12	40.00 AC LOT 11	40.00 AC LOT 10	40.00 AC LOT 9
40.00 AC LOT 13	40.00 AC LOT 14	40.00 AC LOT 15	40.00 AC LOT 16
40.00 AC	40.00 AC	40.00 AC	40.00 AC

SEE DETAIL

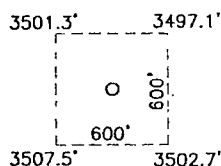

GEODETIC COORDINATES
NAD 27 NME

Y=548072.9 N
X=855126.6 E

LAT.=32°30'05.36" N
LONG.=103°10'53.27" W

SEE DETAIL
1330'
1650'

SCALE - 1"=2000'

OPERATOR CERTIFICATION

I hereby certify that the information
contained herein is true and complete to the
best of my knowledge and belief.

Elaine Linton
Signature

Elaine Linton
Printed Name

Engineering Technician
Title

2/1/2006
Date

SURVEYOR CERTIFICATION

I hereby certify that the well location shown
on this plat was plotted from field notes of
actual surveys made by me or under my
supervision and that the same is true and
correct to the best of my belief

DECEMBER 16, 2004

Date Surveyed LA
Signature & Seal of
Professional Surveyor

Cary Edson
04.11.1691

Certificate No. CARY-EDSON 12641

District I
1625 N. French Dr., Hobbs, NM 88240
District II
1301 W. Grand Avenue, Artesia, NM 88210
District III
1000 Rio Brazos Rd., Aztec, NM 87410
District IV
1220 S. St. Francis Dr., Santa Fe, NM 87505

State of New Mexico
Energy, Minerals & Natural Resources Department
OIL CONSERVATION DIVISION
1220 South St. Francis Dr.
Santa Fe, NM 87505

Form C-102
Revised October 12, 2005
Submit to Appropriate District Office
State Lease - 4 Copies
Fee Lease - 3 Copies

☐ AMENDED REPORT

WELL LOCATION AND ACREAGE DEDICATION PLAT

¹ API Number 30-025-37380	² Pool Code 62700	³ Pool Name Wantz; Abo
⁴ Property Code 31036	⁵ Property Name Hawk Federal A-5	
⁷ OGRID No. 873	⁶ Well Number 003	⁸ Elevation 3502'
⁹ Operator Name Apache Corporation: 303 Veterans Airpark Lane, Suite 3000 Midland, TX 79705		

¹⁰ Surface Location

UL or lot no.	Section	Township	Range	Lot Idn	Feet from the	North/South line	Feet from the	East/West line	County
O	5	21S	37E		330	South	1650	East	Lea

¹¹ Bottom Hole Location If Different From Surface

UL or lot no.	Section	Township	Range	Lot Idn	Feet from the	North/South line	Feet from the	East/West line	County
¹² Dedicated Acres 40	¹³ Joint or Infill	¹⁴ Consolidation Code		¹⁵ Order No. DHC-HOB-0138					

No allowable will be assigned to this completion until all interests have been consolidated or a non-standard unit has been approved by the division.

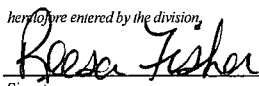
16					¹⁷ OPERATOR CERTIFICATION <i>I hereby certify that the information contained herein is true and complete to the best of my knowledge and belief, and that this organization either owns a working interest or unleased mineral interest in the land including the proposed bottom hole location or has a right to drill this well at this location pursuant to a contract with an owner of such a mineral or working interest, or to a voluntary pooling agreement or a compulsory pooling order heretofore entered by the division.</i>  09/11/2013 Signature Date Reesa Holland Fisher Printed Name
					¹⁸ SURVEYOR CERTIFICATION <i>I hereby certify that the well location shown on this plat was plotted from field notes of actual surveys made by me or under my supervision, and that the same is true and correct to the best of my belief.</i> Date of Survey Signature and Seal of Professional Surveyor: Certificate Number

District I
1625 N. French Dr., Hobbs, NM 88240
Phone: (575) 393-6161 Fax: (575) 393-0720
District II
811 S. First St., Artesia, NM 88210
Phone: (575) 748-1283 Fax: (575) 748-9720
District III
1000 Rio Brazos Road, Aztec, NM 87410
Phone: (505) 334-6178 Fax: (505) 334-6170
District IV
1220 S. St. Francis Dr., Santa Fe, NM 87505
Phone: (505) 476-3460 Fax: (505) 476-3462

State of New Mexico

Form C-101
Revised July 18, 2013

Energy Minerals and Natural Resources

Oil Conservation Division

☐ AMENDED REPORT

1220 South St. Francis Dr.

Santa Fe, NM 87505

APPLICATION FOR PERMIT TO DRILL, RE-ENTER, DEEPEN, PLUGBACK, OR ADD A ZONE

¹ Operator Name and Address Apache Corporation 303 Veterans Airpark Lane, Suite 3000 Midland, TX 79705		² OGRID Number 873
		³ API Number 30-025-37380
⁴ Property Code 31036	⁵ Property Name Hawk A-5	⁶ Well No. 003

⁷ Surface Location

UL - Lot	Section	Township	Range	Lot Idn	Feet from	N/S Line	Feet From	E/W Line	County
O	5	21S	37E		330	S	1650	E	Lea

⁸ Proposed Bottom Hole Location

UL - Lot	Section	Township	Range	Lot Idn	Feet from	N/S Line	Feet From	E/W Line	County

⁹ Pool Information

Pool Name	Pool Code
Blinebry (6660) - Tubb (60240) - Drinkard (19190) Completed, Adding Wantz; Abo	62700

Additional Well Information

¹¹ Work Type A	¹² Well Type O	¹³ Cable/Rotary	¹⁴ Lease Type F	¹⁵ Ground Level Elevation 3502'
¹⁶ Multiple N	¹⁷ Proposed Depth 7500'	¹⁸ Formation Wantz; Abo (62700)	¹⁹ Contractor	²⁰ Spud Date 8/6/2005
Depth to Ground water		Distance from nearest fresh water well		Distance to nearest surface water

☒ We will be using a closed-loop system in lieu of lined pits

²¹ Proposed Casing and Cement Program

Type	Hole Size	Casing Size	Casing Weight/ft	Setting Depth	Sacks of Cement	Estimated TOC
J-55	11"	8-5/8"	27#	1230'	575 sx Class C	Surface
J-55/L-80	7-7/8"	5-1/2"	17#	7500'	2300 sx Class C	70' CBL

Casing/Cement Program: Additional Comments

--

²² Proposed Blowout Prevention Program

Type	Working Pressure	Test Pressure	Manufacturer

²³ I hereby certify that the information given above is true and complete to the best of my knowledge and belief.

I further certify that I have complied with 19.15.14.9 (A) NMAC ☐ and/or 19.15.14.9 (B) NMAC ☐, if applicable.

Signature:

Reesa Fisher

Printed name: Reesa Holland Fisher

Title: Sr Staff Reg Tech

E-mail Address: Reesa.Holland@apachecorp.com

Date: 9/11/2013

Phone: 432/818-1062

OIL CONSERVATION DIVISION

Approved By:

Title:

Approved Date:

Expiration Date:

Conditions of Approval Attached