

District I
1625 N. French Dr., Hobbs, NM 88240
Phone: (575) 393-6161 Fax: (575) 393-0720

District II
811 S. First St., Artesia, NM 88210
Phone: (575) 748-1283 Fax: (575) 748-9720

District III
1000 Rio Brazos Road, Aztec, NM 87410
Phone: (505) 334-6178 Fax: (505) 334-6170

District IV
1220 S. St. Francis Dr., Santa Fe, NM 87505
Phone: (505) 476-3466 Fax: (505) 476-3462

Form C-102
Revised August 1, 2011
Submit one copy to
appropriate
District Office

X AMENDED REPORT
UL is 0, not 15

WELL LOCATION AND ACREAGE DEDICATION RECEIVED

1 API Number 30-025-42272	2 Pool Code 22900	3 Pool Name EUNICE; BLI-TU-DR, NORTH
4 Property Code 22503	5 Property Name NORTH EAST DRINKARD UNIT	6 Well Number #349
7 OGRID No. 873	8 Operator Name APACHE CORPORATION	9 Elevation 3416.29

UL or lot no.	Section	Township	Range	Lot idn	Feet from the	North/South line	Feet from the	East/West line	County
O	3	21 S	37 E		960	SOUTH	2,515	EAST	LEA

UL or lot no.	Section	Township	Range	Lot Idn	Feet from the	North/South line	Feet from the	East/West line	County
O	3	21 S	37 E		880	SOUTH	2,320	EAST	LEA

SECTION 3, TOWNSHIP 21 SOUTH, RANGE 37 EAST P.M.

<p>FOUND 3 INCH IRON PIPE, CAPPED</p> <p>LAT: 32.521977 N LONG: -103.141730 W NADSPCE N: 555682.672 NADSPCE E: 867025.653 (N.A.D. 27)</p> <p>LAT: 32.522096 N LONG: -103.142202 W NADSPCE N: 555682.616 NADSPCE E: 867026.197 (N.A.D. 83)</p>	<p>FOUND 3 INCH IRON PIPE, CAPPED</p> <p>LAT: 32.521975 N LONG: -103.141730 W NADSPCE N: 555680.572 NADSPCE E: 867294.102 (N.A.D. 27)</p> <p>LAT: 32.522094 N LONG: -103.142202 W NADSPCE N: 555726.403 NADSPCE E: 868477.594 (N.A.D. 83)</p>						
<p>SURFACE HOLE TO BOTTOM HOLE LOCATION DISTANCE</p> <table border="1" style="margin-left: auto; margin-right: auto;"> <thead> <tr> <th>LINE</th> <th>BEARING</th> <th>DISTANCE</th> </tr> </thead> <tbody> <tr> <td>L1</td> <td>S 60°19'50"E</td> <td>210.5W'</td> </tr> </tbody> </table>		LINE	BEARING	DISTANCE	L1	S 60°19'50"E	210.5W'
LINE	BEARING	DISTANCE					
L1	S 60°19'50"E	210.5W'					
<p>FOUND 2 INCH IRON PIPE, CAPPED, DISTURBED</p> <p>LAT: 32.500407 N LONG: -103.158794 W NADSPCE N: 547753.190 NADSPCE E: 865120.436 (N.A.D. 27)</p> <p>LAT: 32.500527 N LONG: -103.159265 W NADSPCE N: 547815.309 NADSPCE E: 8651304.335 (N.A.D. 83)</p>	<p>BOTTOM HOLE LOCATION</p> <p>DD LAT: 32.502840 N DD LONG: -103.143240 W DMS LAT: 32°30'10.222" N DMS LONG: 103°8'57.764" W NADSPCE N: 548872.681 NADSPCE E: 865055.422 (N.A.D. 27)</p> <p>DD LAT: 32.502860 N DD LONG: -103.149711 W DMS LAT: 32°30'10.654" N DMS LONG: 103°07'56.980" W NADSPCE N: 548732.904 NADSPCE E: 866240.309 (N.A.D. 83)</p>						
<p>FOUND 2 INCH IRON PIPE, CAPPED, DISTURBED</p> <p>LAT: 32.500432 N LONG: -103.141714 W NADSPCE N: 547822.755 NADSPCE E: 867365.629 (N.A.D. 27)</p> <p>LAT: 32.500552 N LONG: -103.142185 W NADSPCE N: 547802.641 NADSPCE E: 868370.543 (N.A.D. 83)</p>							

Diagram details:
- Well location marked with a circle.
- Bearings: L1 (S 60°19'50"E), L2 (S 60°19'50"E), L3 (S 60°19'50"E).
- Distances: 210.5W', 2.515', 37.5', 100', 100'.
- A dashed line connects the well location to the bottom hole location.

17 OPERATOR CERTIFICATION

I hereby certify that the information contained herein is true and complete to the best of my knowledge and belief, and that this organization either owns a working interest or unleased mineral interest in the land including the proposed bottom hole location or has a right to drill this well at this location pursuant to a contract with an owner of such a mineral or working interest, or to a voluntary pooling agreement or a compulsory pooling order heretofore entered by the division.

[Signature]

2-16-15

Signature _____ Date _____

Brian Wood

Printed Name **brian@permitswest.com**

E-mail Address _____

18 SURVEYOR CERTIFICATION

I hereby certify that the well location shown on this plat was plotted from field notes of actual surveys made by me or under my supervision, and that the same is true and correct to the best of my belief.

10-02-2014

Date of Survey _____

Signature and Seal of Professional Surveyor

Jeffery E. Hudson
Certificate Number
20559

40 acre dedication

FEB 23 2015

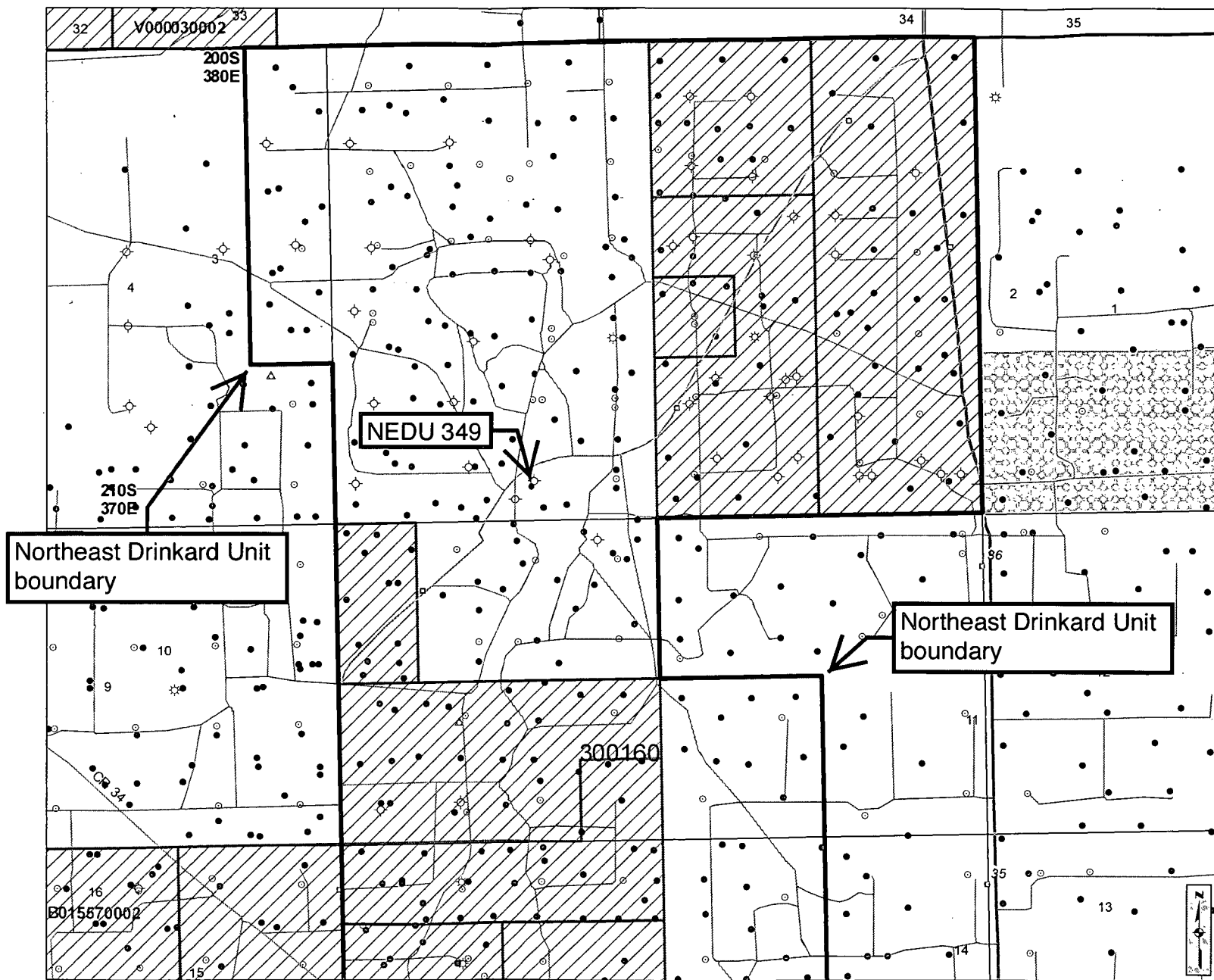

New Mexico State Land Office **Oil, Gas and Minerals**

0 0.1 0.2 0.4 0.6 0.8
Miles
Universal Transverse Mercator Projection, Zone 13
1983 North American Datum

The New Mexico State Land Office assumes no responsibility or liability for, or in connection with, the accuracy, reliability or use of the information provided here, in State Land Office data layers or any other data layer.

Land Office Geographic Information Center
logic@slo.state.nm.us

Created On: 2/16/2015 10:37:24 AM

Cartographic Features

- County Boundaries
- County Seats
- City, Town or Village
- SLO District Offices
- SLO District Boundary
- Hwy Mileposts
- Interstate
- US Hwy
- NM Hwy
- Local Road
- Continental Divide

Federal Minerals Ownership

- All Minerals
- Coal Only
- Oil and Gas Only
- Oil, Gas and Coal Only
- Other Minerals

State Trust Lands

- Surface Estate
- Subsurface Estate
- Surface and Subsurface Estate

State Leases

- Oil and Gas Leases
- Agricultural Leases
- Commercial Leases
- Minerals Leases
- Not Available for Oil and Gas Leasing
- Oil and Gas Leasing Influenced by Restriction

Oil and Gas Related Features

- Oil and Gas Unit Boundary
- Participating Areas in Units
- Geologic Regions
- Volcanic Vents
- NMOC Order R-111-P Potash Enclave Outline

NMOC Oil and Gas Wells

- CO₂
- Gas
- Injection
- Miscellaneous
- Oil
- Salt Water Disposal
- Water
- DA or PA

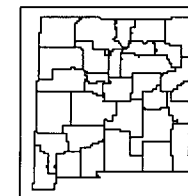

www.nmstatelands.org