

HOBBS OCD

MAR 16 2015

Form C-102

State of New Mexico
Energy, Minerals & Natural Resources Department
OIL CONSERVATION DIVISION
1220 South St. Francis Dr.
Santa Fe, NM 87505

Revised August 1, 2011

RECEIVED

Please send one copy to appropriate

District Office

☐ AMENDED REPORT

District I
1625 N. French Dr., Hobbs, NM 88240
Phone: (575) 393-6161 Fax: (575) 393-0720
District II
811 S. First St., Artesia, NM 88210
Phone: (505) 748-1283 Fax: (505) 748-9720
District III
1000 Rio Brazos Road, Aztec, NM 87410
Phone: (505) 334-6178 Fax: (505) 334-6170
District IV
1220 S. St. Francis Dr., Santa Fe, NM 87505
Phone: (505) 476-3460 Fax: (505) 476-3462

WELL LOCATION AND ACREAGE DEDICATION PLAT

¹ API Number 30-026-42476	² Pool Code 97899	³ Pool Name WC-026 G-06 5253206M; B3
⁴ Property Code	⁵ Property Name TRIONYX 6 FEDERAL	⁶ Well Number 10H
⁷ OGRID No. 6137	⁸ Operator Name DEVON ENERGY PRODUCTION COMPANY, L.P.	⁹ Elevation 3442.4

¹⁰ Surface Location

UL or lot no.	Section	Township	Range	Lot Idn	Feet from the	North/South line	Feet from the	East/West line	County
N	6	25 S	32 E		200	SOUTH	1350	WEST	LEA

¹¹ Bottom Hole Location If Different From Surface

UL or lot no.	Section	Township	Range	Lot Idn	Feet from the	North/South line	Feet from the	East/West line	County
3	6	25 S	32 E		330	NORTH	1980	WEST	LEA

¹² Dedicated Acres 160.77 ac	¹³ Joint or Infill	¹⁴ Consolidation Code	¹⁵ Order No.
--	-------------------------------	----------------------------------	-------------------------

No allowable will be assigned to this completion until all interests have been consolidated or a non-standard unit has been approved by the division.

<p>N89°37'30"E 2637.93 FT</p> <p>N89°21'34"E 2659.09 FT</p> <p>1980'</p> <p>LOT 4</p> <p>NW CORNER SEC. 6 LAT. = 32.1665814°N LONG. = 103.7229569°W NMSP EAST (FT) N = 424872.91 E = 730205.58</p> <p>LOT 5</p> <p>W/4 CORNER SEC. 6 COMPUTED</p> <p>LOT 6</p> <p>SW CORNER SEC. 6 LAT. = 32.1520816°N LONG. = 103.7229769°W NMSP EAST (FT) N = 419598.07 E = 730229.30</p> <p>LOT 7</p> <p>SURFACE LOCATION</p> <p>1350'</p> <p>S89°42'07"W 2662.90 FT</p>		<p>330'</p> <p>LOT 3</p> <p>40.04 ± AC. (SW)</p> <p>BOTTOM OF HOLE</p> <p>LAT. = 32.1656791°N LONG. = 103.7185610°W NMSP EAST (FT) N = 424555.94 E = 732186.58</p> <p>NOTE: LATITUDE AND LONGITUDE COORDINATES ARE SHOWN USING THE NORTH AMERICAN DATUM OF 1983 (NAD83). LISTED NEW MEXICO STATE PLANE EAST COORDINATES ARE GRID (NAD83). BASIS OF BEARING AND DISTANCES USED ARE NEW MEXICO STATE PLANE EAST COORDINATES MODIFIED TO THE SURFACE.</p> <p>TRIONYX "6" FEDERAL 10H</p> <p>ELEV. = 3442.4'</p> <p>LAT. = 32.1526296°N (NAD83) LONG. = 103.7180149°W NMSP EAST (FT) N = 419805.11 E = 731578.14</p> <p>S/4 CORNER SEC. 6 LAT. = 32.1520779°N LONG. = 103.7143746°W NMSP EAST (FT) N = 419611.92 E = 72891.58</p> <p>Project Area</p> <p>Producing Area</p> <p>500'32.45"E 2654.62 FT</p>		<p>¹¹ OPERATOR CERTIFICATION</p> <p>I hereby certify that the information contained herein is true and complete to the best of my knowledge and belief, and that this organization either owns a working interest or leased mineral interest in the land including the proposed bottom hole location or has a right to drill this well at this location pursuant to a contract with an owner of such a mineral or working interest, or to a voluntary pooling agreement or a compulsory pooling order heretofore entered by the division.</p> <p><i>Trina C. Couch</i> 8/11/14 Signature Date</p> <p>Trina C. Couch, Regulatory Analyst Printed Name</p> <p>trina.couch@dmv.com E-mail Address</p>	
<p>500'32.45"E 2636.14 FT</p> <p>SE CORNER SEC. 6 LAT. = 32.1520868°N LONG. = 103.7057795°W NMSP EAST (FT) N = 419630.53 E = 735551.61</p> <p>S89°35'57"W 2660.68 FT</p>		<p>¹³ SURVEYOR CERTIFICATION</p> <p>I hereby certify that the well location shown on this plat was plotted from field notes of actual surveys made by me or under my supervision, and that the same is true and correct to the best of my belief.</p> <p>MAYS 2015 Date of Survey</p> <p>12797 Certificate Number</p> <p>Signature and Seal of Professional Surveyor</p> <p>CERTIFICATE NO. 12797 SURVEY NO. 1823</p>			

SECTION 6, TOWNSHIP 25 SOUTH, RANGE 32 EAST, N.M.P.M.
LEA COUNTY, STATE OF NEW MEXICO
SITE MAP

NOTE: LATITUDE AND LONGITUDE COORDINATES ARE SHOWN USING THE NORTH AMERICAN DATUM OF 1983 (NAD83). LISTED NEW MEXICO STATE PLANE EAST COORDINATES ARE GRID (NAD83). BASIS OF BEARING AND DISTANCES USED ARE NEW MEXICO STATE PLANE EAST COORDINATES MODIFIED TO THE SURFACE.

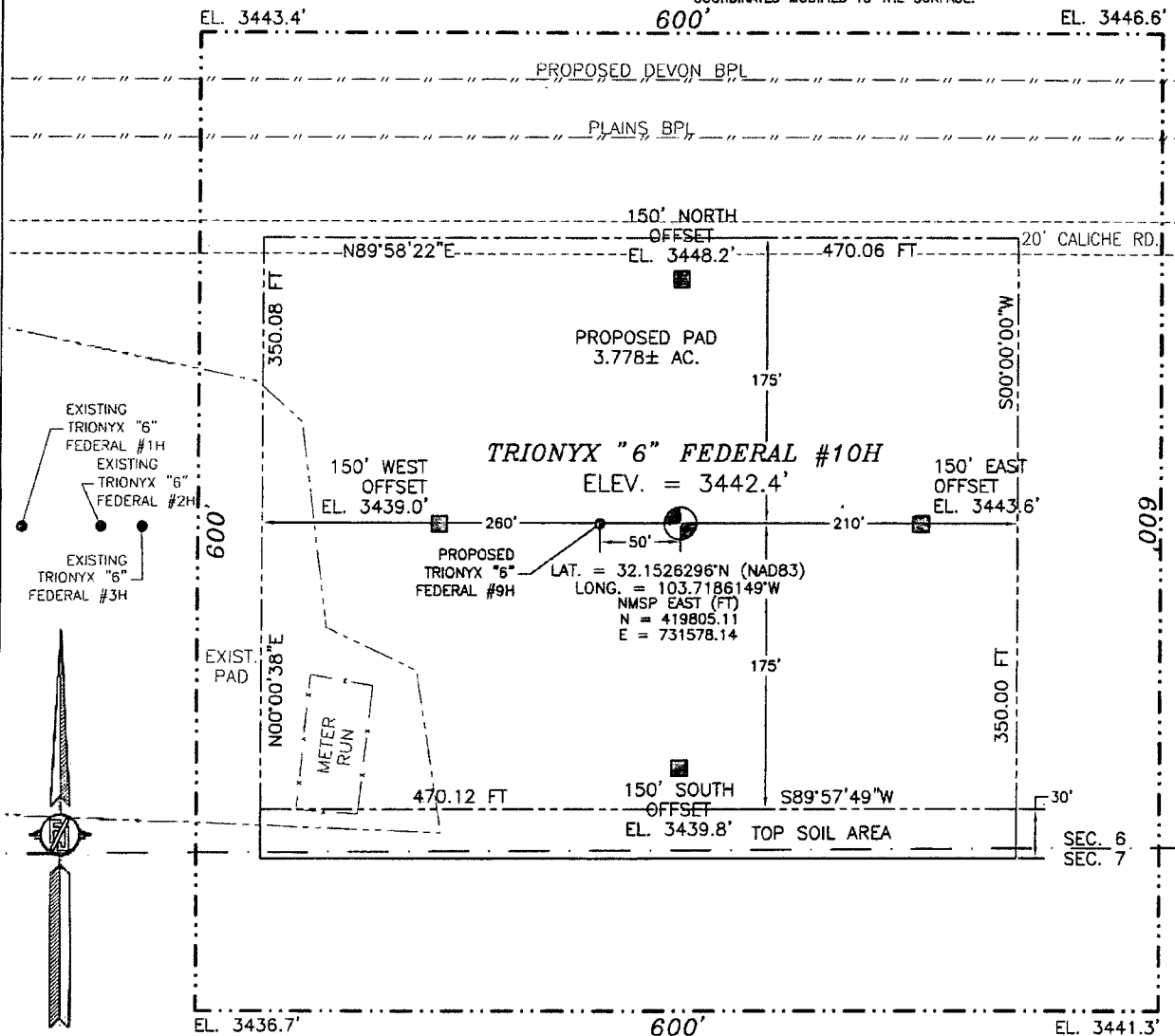

010 50 100 200

SCALE 1" = 100'

DIRECTIONS TO LOCATION

FROM STATE HWY. 128 AND CR#1 (ORLA ROAD) GO SOUTH ON CR. #1 6.2 MILES, TURN RIGHT ON CALICHE ROAD (MONSANTO RD.) AND GO WEST 2.2 MILES, TURN RIGHT AND GO NORTH 0.75 MILES, BEND LEFT AND GO WEST 2.0 MILES, TURN RIGHT AND GO NORTH 1.2 MILES, TURN RIGHT AND GO EAST 1.25 MILES AND LOCATION IS ON THE RIGHT (SOUTH) 175'.

DEVON ENERGY PRODUCTION COMPANY, L.P.

TRIONYX "6" FEDERAL #10H

LOCATED 200 FT. FROM THE SOUTH LINE
AND 1350 FT. FROM THE WEST LINE OF
SECTION 6, TOWNSHIP 25 SOUTH,
RANGE 32 EAST, N.M.P.M.

LEA COUNTY, STATE OF NEW MEXICO

MAY 8, 2013

SURVEY NO. 1823

MADRON SURVEYING, INC.

301 SOUTH CANAL
(575) 234-3341

CARLSBAD, NEW MEXICO

The map displays the Trionyx 6 Federal #10H oil field. Key features include:

- Central Label:** TRIONYX 6 FEDERAL #10H, with a square symbol below it.
- Grid and Coordinates:** A grid system with labels such as 3472, 3450, 3452, 3422, and 3412.
- Geographic Features:** Contour lines, a dashed line labeled 'TRAIL', and a dashed line labeled 'W.C.P.'.
- Infrastructure:** Labels for 'Drill Hole', 'Gas Well', and 'Well'.
- Orientation:** A north arrow on the right side of the map.

NOT TO SCALE

LOCATED 200 FT. FROM THE SOUTH LINE
AND 1350 FT. FROM THE WEST LINE OF
SECTION 6, TOWNSHIP 25 SOUTH,
RANGE 32 EAST, N.M.P.M.
LEA COUNTY, STATE OF NEW MEXICO

SURVEY NO. 1823

MADRON SURVEYING, INC. 301 SOUTH CANAL CARLSBAD, NEW MEXICO
(575) 234-3341

301 SOUTH CANAL
(575) 234-3341

SECTION 6, TOWNSHIP 25 SOUTH, RANGE 32 EAST, N.M.P.M.
LEA COUNTY, STATE OF NEW MEXICO
VICINITY MAP

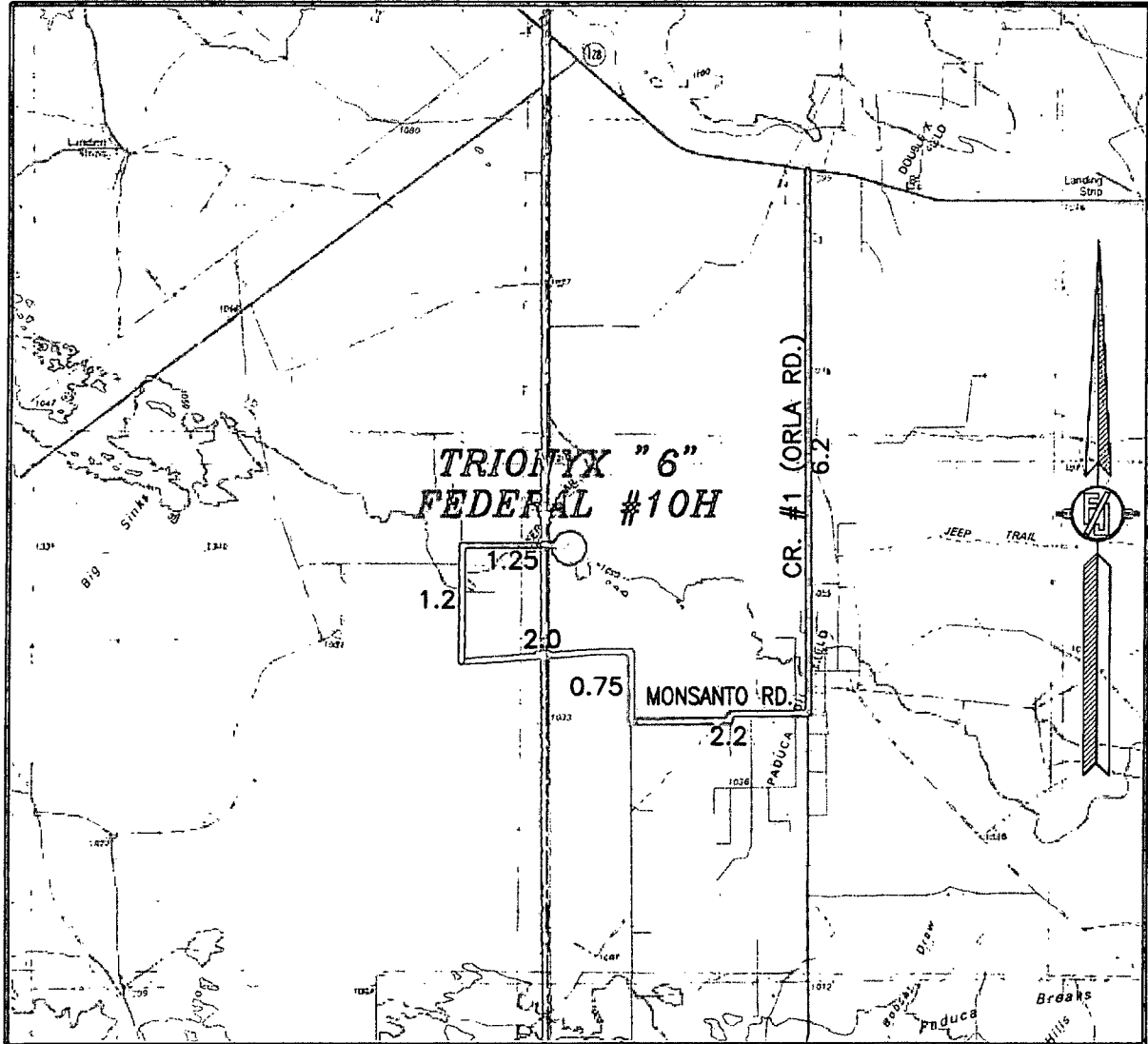

DISTANCES SHOWN IN MILES

NOT TO SCALE

DEVON ENERGY PRODUCTION COMPANY, L.P.

TRIONYX "6" FEDERAL #10H

LOCATED 200 FT. FROM THE SOUTH LINE
AND 1350 FT. FROM THE WEST LINE OF
SECTION 6, TOWNSHIP 25 SOUTH,
RANGE 32 EAST, N.M.P.M.
LEA COUNTY, STATE OF NEW MEXICO

DIRECTIONS TO LOCATION

FROM STATE HWY. 128 AND CR#1 (ORLA ROAD) GO SOUTH ON CR.
#1 6.2 MILES, TURN RIGHT ON CALICHE ROAD (MONSANTO RD.) AND
GO WEST 2.2 MILES, TURN RIGHT AND GO NORTH 0.75 MILES, BEND
LEFT AND GO WEST 2.0 MILES, TURN RIGHT AND GO NORTH 1.2
MILES, TURN RIGHT AND GO EAST 1.25 MILES AND LOCATION IS ON
THE RIGHT (SOUTH) 175'.

MAY 8, 2013

SURVEY NO. 1823

MADRON SURVEYING, INC. 301 SOUTH CANAL (575) 234-3341 CARLSBAD, NEW MEXICO

SECTION 6, TOWNSHIP 25 SOUTH, RANGE 32 EAST, N.M.P.M.
LEA COUNTY, STATE OF NEW MEXICO
AERIAL PHOTO

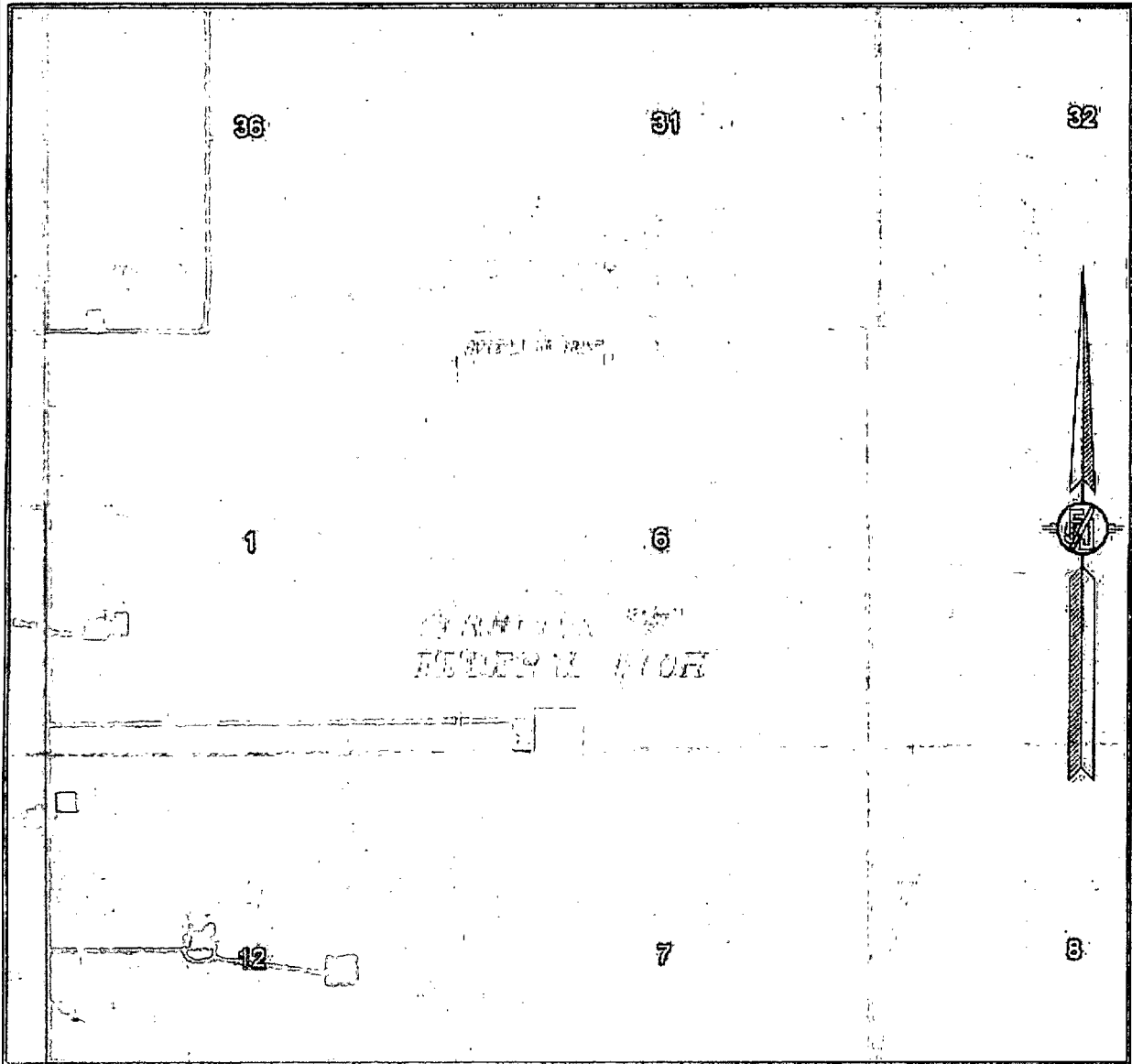

NOT TO SCALE
AERIAL PHOTO:
GOOGLE EARTH
MARCH 2012

DEVON ENERGY PRODUCTION COMPANY, L.P.
TRIONYX "6" FEDERAL #10H
LOCATED 200 FT. FROM THE SOUTH LINE
AND 1350 FT. FROM THE WEST LINE OF
SECTION 6, TOWNSHIP 25 SOUTH,
RANGE 32 EAST, N.M.P.M.
LEA COUNTY, STATE OF NEW MEXICO

MAY 8, 2013

SURVEY NO. 1823

MADRON SURVEYING, INC. 301 SOUTH CANAL (575) 234-3341 CARLSBAD, NEW MEXICO

