

DISTRICT I  
1625 N. French Dr., Hobbs, NM 88240  
Phone: (505) 393-6161 Fax: (505) 393-0720

DISTRICT II  
811 S. First St., Artesia, NM 88210  
Phone: (505) 748-1283 Fax: (505) 748-9720

DISTRICT III  
1000 Rio Brazos Road, Aztec, NM 87410  
Phone: (505) 334-6178 Fax: (505) 334-6170

DISTRICT IV  
1220 S. St. Francis Dr., Santa Fe, NM 87505  
Phone: (505) 476-3460 Fax: (505) 476-3462

State of New Mexico  
Energy, Minerals & Natural Resources Department  
OIL CONSERVATION DIVISION  
1220 South St. Francis Dr.  
Santa Fe, New Mexico 87505

HOBBS OCD

MAR 20 2015

RECEIVED

Form C-102  
Revised August 1, 2011  
Submit one copy to appropriate  
District Office

X AMENDED REPORT  
(dedication outlined  
& acres changed)

WELL LOCATION AND ACREAGE DEDICATION PLAT

API Number <b>30-025-42055</b>	Pool Code <b>62340</b>	Pool Name <b>WOLFCAMP</b>
Property Code <b>30627</b>	Property Name <b>WARN STATE AC 2</b>	Well Number <b>27</b>
OGRID No. <b>873</b>	Operator Name <b>APACHE CORPORATION</b>	Elevation <b>3972'</b>

Surface Location

UL or lot No.	Section	Township	Range	Lot Idn	Feet from the	North/South line	Feet from the	East/West line	County
C	6	18-S	35-E		330	NORTH	2310	WEST	LEA

AS-DRILLED Bottom Hole Location If Different From Surface

UL or lot No.	Section	Township	Range	Lot Idn	Feet from the	North/South line	Feet from the	East/West line	County
C	6	18-S	35-E		277	NORTH	1902	WEST	LEA
Dedicated Acres <b>77.43</b>	Joint or Infill	Consolidation Code	Order No.						

NO ALLOWABLE WILL BE ASSIGNED TO THIS COMPLETION UNTIL ALL INTERESTS HAVE BEEN CONSOLIDATED OR A NON-STANDARD UNIT HAS BEEN APPROVED BY THE DIVISION

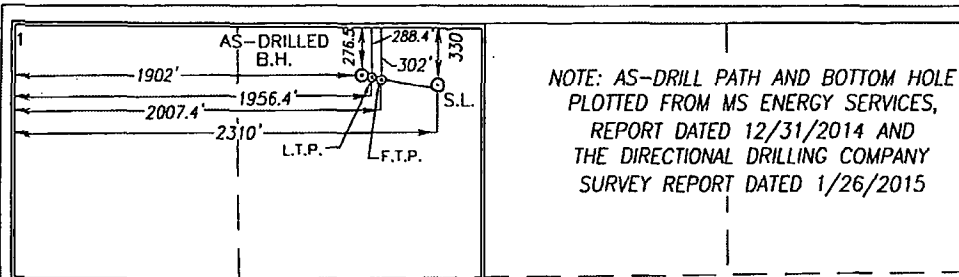

NOTE: AS-DRILL PATH AND BOTTOM HOLE  
PLOTTED FROM MS ENERGY SERVICES,  
REPORT DATED 12/31/2014 AND  
THE DIRECTIONAL DRILLING COMPANY  
SURVEY REPORT DATED 1/26/2015

2	AS-DRILLED BOTTOM HOLE LOCATION NAD 27 NME Y= 649707.6 N X= 756514.8 E LAT.=32.783356° N LONG.=103.498691° E LAT.=32°47'00" N LONG.=103°29'55" E	LAST TAKE POINT NAD 27 NME Y= 649695.8 N X= 756569.2 E LAT.=32.783322° N LONG.=103.498514° W LAT.=32°47'00" N LONG.=103°29'55" W	FIRST TAKE POINT NAD 27 NME Y= 649682.3 N X= 756620.4 E LAT.=32.783284° N LONG.=103.498348° W LAT.=32°47'00" N LONG.=103°29'54" W	GEODETIC COORDINATES SURFACE LOCATION NAD 27 NME Y=649655.0 N X=756923.2 E LAT.=32.783203° N LONG.=103.497363° W LAT.=32°47'00" N LONG.=103°29'51" W
3	AS-DRILLED BOTTOM HOLE LOCATION NAD 83 NME Y= 649772.6 N X= 797693.8 E LAT.=32.783480° N LONG.=103.499187° E LAT.=32°47'01" N LONG.=103°29'57" E	LAST TAKE POINT NAD 83 NME Y= 649760.8 N X= 797748.2 E LAT.=32.783446° N LONG.=103.499010° W LAT.=32°47'00" N LONG.=103°29'56" W	FIRST TAKE POINT NAD 83 NME Y= 649747.3 N X= 797799.4 E LAT.=32.783408° N LONG.=103.498844° W LAT.=32°47'00" N LONG.=103°29'56" W	GEODETIC COORDINATES SURFACE LOCATION NAD 83 NME Y=649720.1 N X=798102.2 E LAT.=32.783326° N LONG.=103.497859° W LAT.=32°47'00" N LONG.=103°29'52" W
4				

OPERATOR CERTIFICATION

I hereby certify that the information herein is true and complete to the best of my knowledge and belief, and that this organization either owns a working interest or unleased mineral interest in the land including the proposed bottom hole location or has a right to drill this well at this location pursuant to a contract with an owner of such mineral or working interest, or to a voluntary pooling agreement or a compulsory pooling order heretofore entered by the division.

*Michelle Cooper* 3-3-15  
Signature Date  
*Michelle Cooper*  
Printed Name  
*michelle.cooper@apachecorp.com*  
E-mail Address

SURVEYOR CERTIFICATION

I hereby certify that the well location shown on this plat was plotted from field notes of actual surveys made by me or under my supervision, and that the same is true and correct to the best of my belief.

JUNE 24, 2014

Date of Survey  
Signature & Seal of Professional Surveyor

*Ronald J. Eidson*  
3239  
Certificate Number  
Ronald J. Eidson 12641  
3239

LSL REL. 15.13.0187 JWSC W.O.: 15.13.0312

MAP 26 2015 AM